

B.M. #60: TIE SPIKE SET IN 20" OAK; 129.02' RIGHT OF STA. 885+19.67 -L-, EL. 174.61

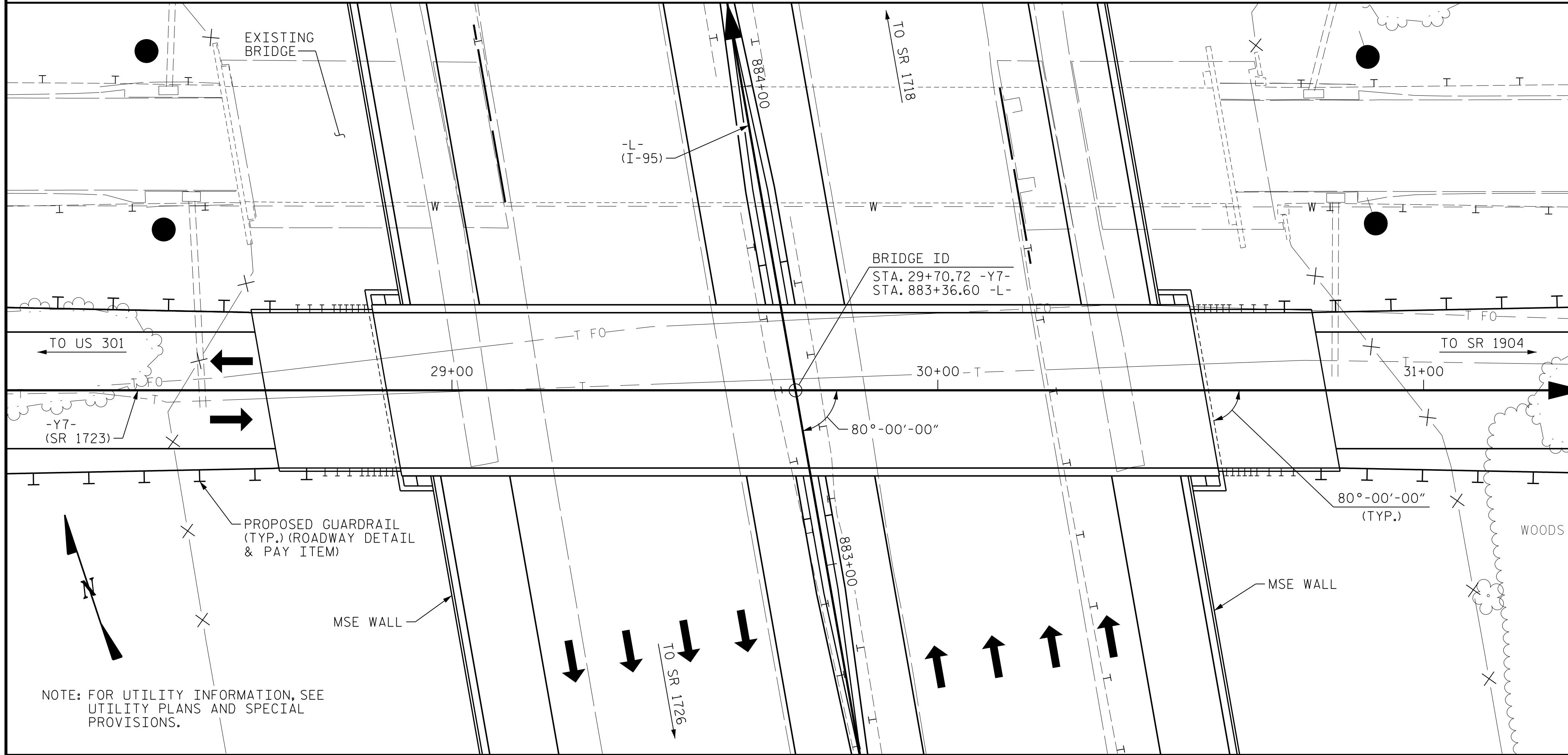

LOCATION SKETCH

NOTES:

- ASSUMED LIVE LOAD = HL 93 OR ALTERNATE LOADING.
- THIS BRIDGE HAS BEEN DESIGNED IN ACCORDANCE WITH THE AASHTO LRFD BRIDGE DESIGN SPECIFICATIONS.
- THIS BRIDGE IS LOCATED IN SEISMIC ZONE 2.
- FOR OTHER DESIGN DATA AND GENERAL NOTES, SEE SHEET SN.
- FOR EROSION CONTROL MEASURES, SEE EROSION CONTROL PLANS.
- NEEDLE BEAMS WILL NOT BE ALLOWED UNLESS OTHERWISE CALLED FOR ON THE PLANS OR APPROVED BY THE ENGINEER.
- REMOVABLE FORMS MAY BE USED IN LIEU OF METAL STAY-IN-PLACE FORMS IN ACCORDANCE WITH ARTICLE 420-3 OF THE STANDARD SPECIFICATIONS.
- ALL FALSEWORK AND FORMS SHALL REMAIN IN PLACE UNTIL THE ENTIRE UNIT IS CAST AND CURED. CONTRACTOR SHALL BE RESPONSIBLE FOR MODIFICATIONS IN THE LINK SLAB REGION.
- FOR MAINTENANCE AND PROTECTION OF TRAFFIC BENEATH PROPOSED STRUCTURE, SEE SPECIAL PROVISIONS.
- FOR LIMITS OF TEMPORARY SHORING FOR MAINTENANCE OF TRAFFIC, SEE TRAFFIC CONTROL PLANS. FOR PAY ITEM FOR TEMPORARY SHORING FOR MAINTENANCE OF TRAFFIC, SEE ROADWAY PLANS.
- THE SUBSTRUCTURE OF THE EXISTING BRIDGE INDICATED ON THE PLANS IS FROM THE BEST INFORMATION AVAILABLE. THIS INFORMATION IS SHOWN FOR THE CONVENIENCE OF THE CONTRACTOR. THE CONTRACTOR SHALL HAVE NO CLAIM WHATSOEVER AGAINST THE DEPARTMENT OF TRANSPORTATION FOR ANY DELAYS OR ADDITIONAL COST INCURRED BASED ON DIFFERENCES BETWEEN THE EXISTING BRIDGE SUBSTRUCTURE SHOWN ON THE PLANS AND THE ACTUAL CONDITIONS AT THE PROJECT SITE.
- AFTER SERVING AS A TEMPORARY STRUCTURE, THE EXISTING STRUCTURE CONSISTING OF 4 SPANS (2 @ 52'-6" AND 2 @ 55'-0") REINFORCED CONCRETE DECK WITH CLEAR ROADWAY OF 24'-0" WIDE WITH CHAIN LINK FENCE; ON REINFORCED PRESTRESSED CONCRETE GIRDERS AND REINFORCED CONCRETE CORED SLAB UNITS; ON REINFORCED CONCRETE END BENTS AND BENTS AND LOCATED AT 50 FT. NORTH OF THE PROPOSED STRUCTURE SHALL BE REMOVED. THE EXISTING BRIDGE IS PRESENTLY NOT POSTED FOR LOAD LIMIT. SHOULD THE STRUCTURAL INTEGRITY OF THE BRIDGE DETERIORATE DURING THE CONSTRUCTION OF THE PROPOSED BRIDGE, A LOAD LIMIT MAY BE POSTED AND MAY BE REDUCED AS FOUND NECESSARY DURING THE LIFE OF THE PROJECT.
- FOR ASBESTOS ASSESSMENT FOR BRIDGE DEMOLITION AND RENOVATION ACTIVITIES, SEE SPECIAL PROVISIONS.
- FOR SUBMITTAL OF WORKING DRAWINGS, SEE SPECIAL PROVISIONS.
- FOR FALSEWORK AND FORMWORK, SEE SPECIAL PROVISIONS.
- FOR CRANE SAFETY, SEE SPECIAL PROVISIONS.
- FOR GROUT FOR STRUCTURES, SEE SPECIAL PROVISIONS.
- FOR FOUNDATION NOTES, SEE "PILE FOUNDATION TABLES" SHEET.

THE ELEVATIONS AND CLEARANCES SHOWN ON THE PLANS AT THE POINTS OF MINIMUM VERTICAL CLEARANCE ARE FROM THE BEST INFORMATION AVAILABLE. PRIOR TO BEGINNING BRIDGE CONSTRUCTION, VERIFY THE ELEVATIONS ON THE EXISTING PAVEMENT AND CHECK THE CLEARANCE. REPORT ANY VARIATIONS TO THE ENGINEER. ANY PLAN REVISIONS NECESSARY TO ACHIEVE THE REQUIRED MINIMUM VERTICAL CLEARANCE WILL BE PROVIDED BY THE DEPARTMENT.

FOR MSE RETAINING WALLS, SEE GEOTECHNICAL PROVISIONS.

TOTAL BILL OF MATERIAL

	REMOVAL OF EXISTING STRUCTURE AT STA. 29+70.72 -Y7-	ASBESTOS ASSESSMENT	FOUNDATION EXCAVATION FOR BENT 1	PDA TESTING	REINFORCED CONCRETE DECK SLAB	GROOVING BRIDGE FLOORS	CLASS A CONCRETE	BRIDGE APPROACH SLABS	REINFORCING STEEL	SPIRAL COLUMN REINFORCING STEEL
	LUMP SUM	LUMP SUM	LUMP SUM	EACH	SQ. FT.	SQ. FT.	CU. YDS.	LUMP SUM	LBS.	LBS.
SUPERSTRUCTURE	LUMP SUM				5,993	6,292				
END BENT 1							28.8	LUMP SUM	3,567	
BENT 1			LUMP SUM				55.4		10,184	1,723
END BENT 2							28.7	LUMP SUM	3,567	
TOTAL	LUMP SUM	LUMP SUM	LUMP SUM	1	5,993	6,292	112.9	LUMP SUM	17,318	1,723

TOTAL BILL OF MATERIAL

	54" PRESTRESSED CONCRETE GIRDERS	PILE DRIVING EQUIPMENT SETUP FOR HP 12 X 53 STEEL PILES	PILE DRIVING EQUIPMENT SETUP FOR HP 14 X 73 STEEL PILES	HP 12 X 53 STEEL PILES	HP 14 X 73 STEEL PILES	PILE REDRIVES	CONCRETE BARRIER RAIL	84" CHAIN LINK FENCE	4" SLOPE PROTECTION	ELASTOMERIC BEARINGS	
	LIN. FT.	EACH	EACH	NO.	LIN. FT.	NO.	LIN. FT.	EACH	LIN. FT.	SO. YDS.	LUMP SUM
SUPERSTRUCTURE	669.08						336.62		328.00		LUMP SUM
END BENT 1		6		6	540.0					14	
BENT 1			15			15	1200.0				
END BENT 2		6		6	570.0					14	
TOTAL	669.08	12	15	12	1110.0	15	1200.0	14	336.62	328.00	28

PROJECT NO. I-5987B
ROBESON COUNTY
 STATION: 29+70.72 -Y7-
883+36.60 -L-
 SHEET 2 OF 2

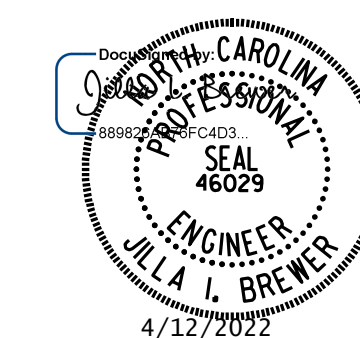

STATE OF NORTH CAROLINA
 DEPARTMENT OF TRANSPORTATION
 RALEIGH
GENERAL DRAWING
 FOR BRIDGE ON SR 1723
 (PARKTON TOBEMORY ROAD)
 OVER I-95 BETWEEN
 US 301 & SR 1904

**DOCUMENT NOT CONSIDERED FINAL
 UNLESS ALL SIGNATURES COMPLETED**

MI ENGINEERING
 1011 SCHAUB DRIVE, SUITE 100
 RALEIGH, NC 27606
 (919) 851-6606
 FIRM PE NUMBER: P-0671

REVISIONS						SHEET NO.
NO.	BY:	DATE:	NO.	BY:	DATE:	
1			3			S10-2 TOTAL SHEETS 33
2			4			

DRAWN BY: B.E. LANNING DATE: 07/2021
 CHECKED BY: J.I. BREWER DATE: 11/2021
 DESIGN ENGINEER OF RECORD: J.I. BREWER DATE: 03/2022

4/12/2022 3:31:38 PM User: blanning
 Filename: N:\NC Bridges\20003 I-5987A&B I-95\I5987B\Structures\410_003_I5987B_SMU_G002_T00167.dgn