

BILL OF MATERIAL - STAGE I						BILL OF MATERIAL - STAGE II						BILL OF MATERIAL - STAGE III								
APPROACH SLAB AT EB 1						APPROACH SLAB AT EB 1						APPROACH SLAB AT EB 1								
BAR	NO.	SIZE	TYPE	LENGTH	WEIGHT	BAR	NO.	SIZE	TYPE	LENGTH	WEIGHT	BAR	NO.	SIZE	TYPE	LENGTH	WEIGHT			
*A1	50	#4	STR	21'-1"	704	*A3	25	#4	STR	40'-0"	668	*A5	75	#4	STR	27'-10"	1394			
A2	52	#4	STR	20'-11"	727	A4	26	#4	STR	40'-0"	695	A6	78	#4	STR	27'-7"	1437			
*B1	74	#5	STR	23'-10"	1840	*B1	74	#5	STR	23'-10"	1840	*B1	147	#5	STR	23'-10"	3654			
B2	74	#6	STR	24'-8"	2742	B2	74	#6	STR	24'-8"	2742	B2	147	#6	STR	24'-8"	5446			
*B3	10	#4	STR	24'-8"	165	*J1	40	#4	1	1'-5"	38	*B3	10	#4	STR	24'-8"	165			
*J1	40	#4	1	1'-5"	38	*J1	40	#4	1	1'-5"	38	*J1	79	#4	1	1'-5"	75			
*D1	17	#6	STR	3'-0"	77	*D1	17	#6	STR	3'-0"	77									
REINFORCING STEEL					LBS.	3469	REINFORCING STEEL					LBS.	3437	REINFORCING STEEL					LBS.	6883
*EPOXY COATED REINFORCING STEEL					LBS.	2824	*EPOXY COATED REINFORCING STEEL					LBS.	2623	*EPOXY COATED REINFORCING STEEL					LBS.	5228
CLASS AA CONCRETE					C. Y.	43.7	CLASS AA CONCRETE					C. Y.	40.3	CLASS AA CONCRETE					C. Y.	83.0
APPROACH SLAB AT EB 2						APPROACH SLAB AT EB 2						APPROACH SLAB AT EB 2								
BAR	NO.	SIZE	TYPE	LENGTH	WEIGHT	BAR	NO.	SIZE	TYPE	LENGTH	WEIGHT	BAR	NO.	SIZE	TYPE	LENGTH	WEIGHT			
*A1	50	#4	STR	21'-1"	704	*A3	25	#4	STR	40'-0"	668	*A5	75	#4	STR	27'-10"	1394			
A2	52	#4	STR	20'-11"	727	A4	26	#4	STR	40'-0"	695	A6	78	#4	STR	27'-7"	1437			
*B1	74	#5	STR	23'-10"	1840	*B1	74	#5	STR	23'-10"	1840	*B1	147	#5	STR	23'-10"	3654			
B2	74	#6	STR	24'-8"	2742	B2	74	#6	STR	24'-8"	2742	B2	147	#6	STR	24'-8"	5446			
*B3	10	#4	STR	24'-8"	165	*J1	40	#4	1	1'-5"	38	*B3	10	#4	STR	24'-8"	165			
*J1	40	#4	1	1'-5"	38	*J1	40	#4	1	1'-5"	38	*J1	79	#4	1	1'-5"	75			
*D1	17	#6	STR	3'-0"	77	*D1	17	#6	STR	3'-0"	77									
REINFORCING STEEL					LBS.	3469	REINFORCING STEEL					LBS.	3437	REINFORCING STEEL					LBS.	6883
*EPOXY COATED REINFORCING STEEL					LBS.	2824	*EPOXY COATED REINFORCING STEEL					LBS.	2623	*EPOXY COATED REINFORCING STEEL					LBS.	5228
CLASS AA CONCRETE					C. Y.	43.7	CLASS AA CONCRETE					C. Y.	40.3	CLASS AA CONCRETE					C. Y.	83.0

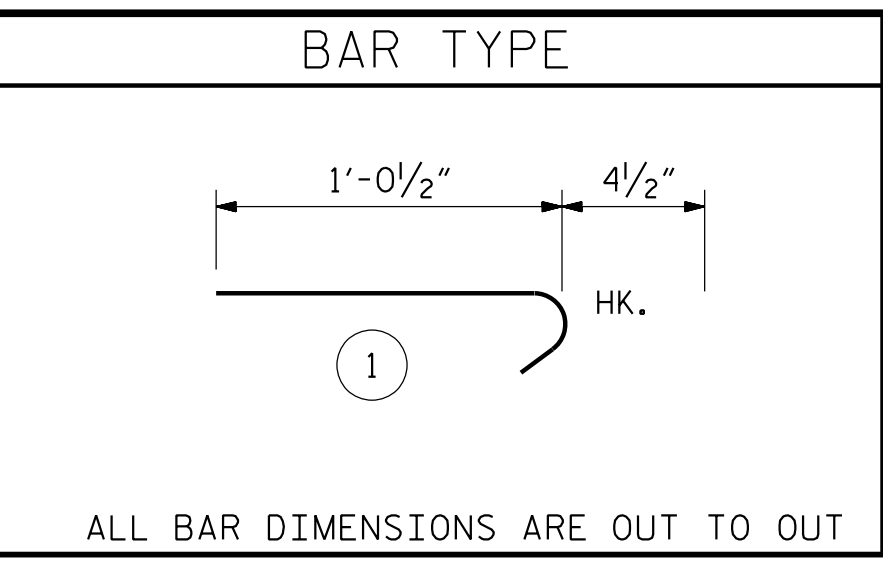

THE QUANTITY OF #4 J1 BARS ON THE BILL OF MATERIAL IS BASED ON 1'-0" CENTERS. J1 BARS SHALL BE PLACED AT EACH VERTICAL STUD ANCHOR BOLT. IN THE EVENT THAT THE NUMBER OF VERTICAL STUD ANCHORS EXCEEDS THE NUMBER OF J1 BARS SPECIFIED, ADDITIONAL J1 BARS WILL NOT BE REQUIRED.

SPLICE LENGTHS

BAR SIZE	EPOXY COATED	UNCOATED
#4	1'-11"	1'-7"
#5	2'-5"	2'-0"
#6	3'-7"	2'-5"

NOTES

- FOR BRIDGE APPROACH FILL INCLUDING GEOTEXTILE, 6" Ø DRAINAGE PIPE, AND SELECT MATERIAL BACKFILL, SEE ROADWAY PLANS.
- GEOTEXTILE SHALL BE TYPE 1 IN ACCORDANCE WITH THE STANDARD SPECIFICATIONS SECTION 1056.
- SELECT MATERIAL BACKFILL (CLASS V OR CLASS VI) SHALL BE IN ACCORDANCE WITH STANDARD SPECIFICATIONS SECTION 1016.
- SELECT MATERIAL BACKFILL IS TO BE CONTINUOUS ALONG FILL FACE OF BACKWALL FROM OUTSIDE EDGE TO OUTSIDE EDGE OF APPROACH SLAB.
- APPROACH SLAB SHALL NOT BE CONSTRUCTED PRIOR TO COMPLETION OF THE BRIDGE DECK.
- FOR THE 6" Ø DRAINAGE PIPE OUTLET(S), SEE ROADWAY STANDARD DRAWINGS.
- AREA BETWEEN THE WINGWALL AND APPROACH SLAB SHALL BE GRADED TO DRAIN THE WATER AWAY FROM THE FILL FACE OF THE BRIDGE AND SHALL BE PAVED. SEE ROADWAY PLANS.
- FOR EXPANSION JOINT SEALS, SEE SPECIAL PROVISIONS.

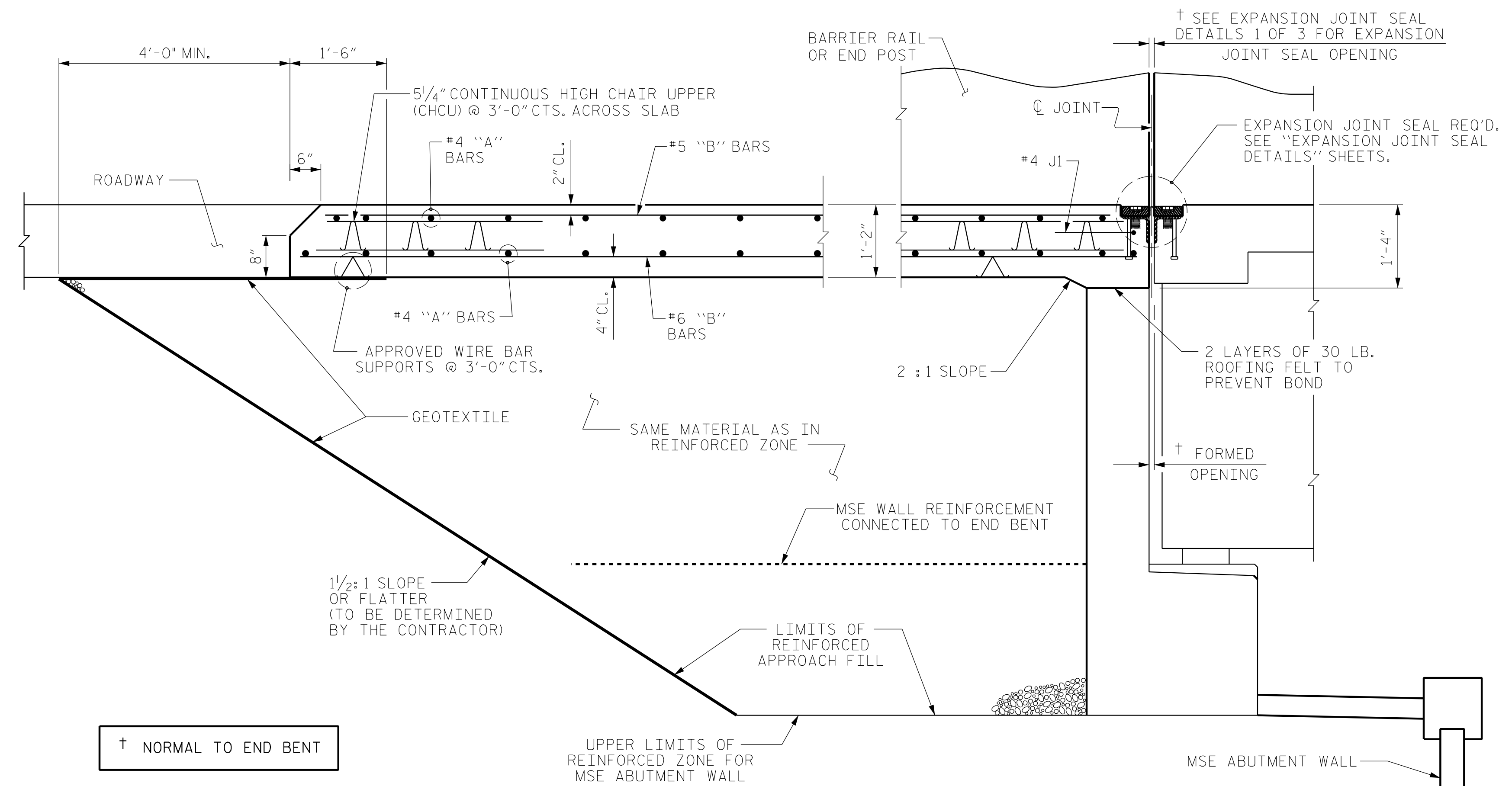
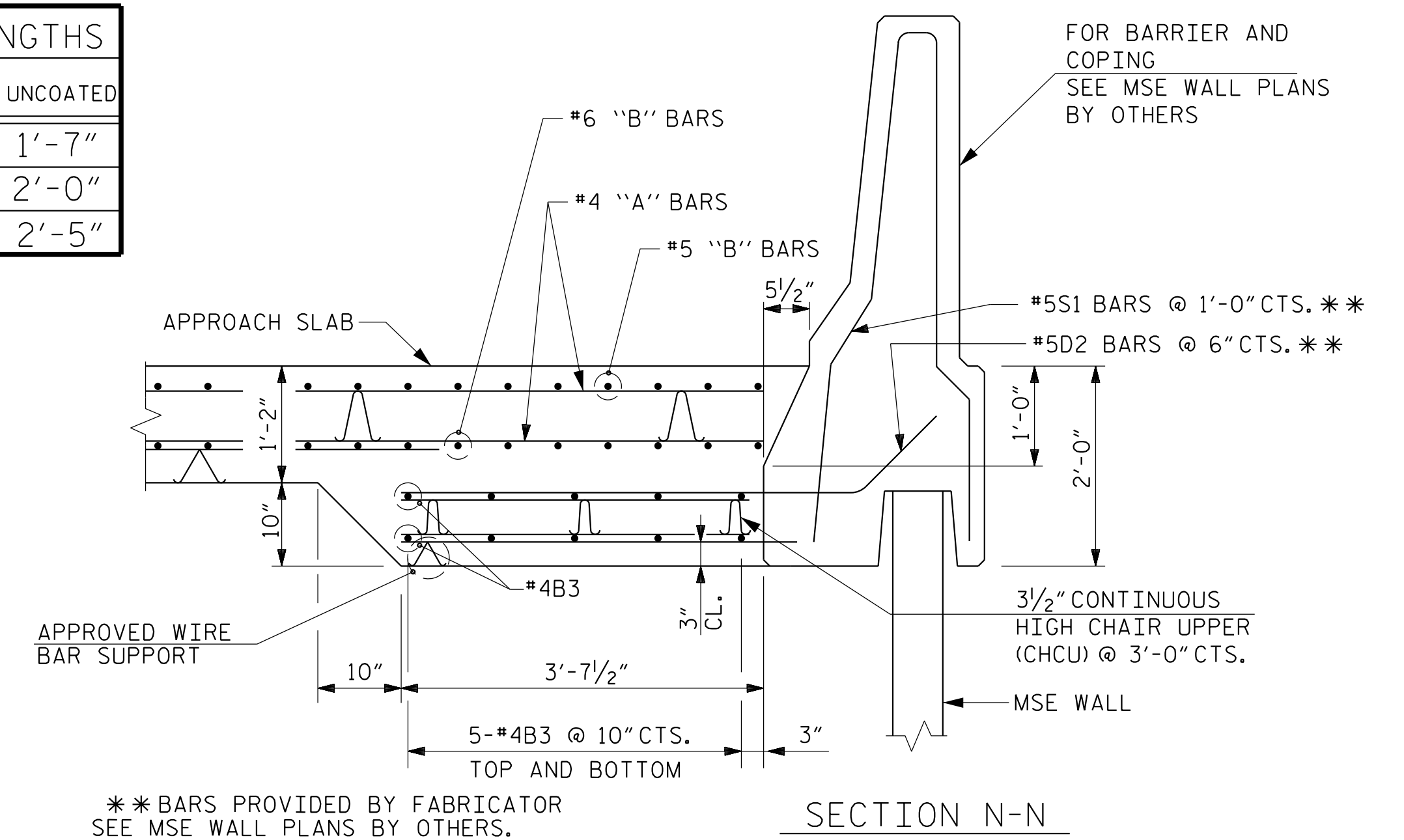

SECTION THRU SLAB
(TYPE III - REINFORCED APPROACH FILL)

PROJECT NO. I-5987B
ROBESON COUNTY
STATION: 617+12.20 -L- POT

SHEET 3 OF 4

STATE OF NORTH CAROLINA
DEPARTMENT OF TRANSPORTATION
RALEIGH

BRIDGE APPROACH SLAB FOR FLEXIBLE PAVEMENT

REVISIONS						SHEET NO.
NO.	BY:	DATE:	NO.	BY:	DATE:	TOTAL SHEETS
1			3			56-52
2			4			53

PLANS PREPARED BY:

NV5
NV5 ENGINEERS & CONSULTANTS, INC.
3300 REGENCY PARKWAY, SUITE 100
CARY, NC 27518
P: 919.851.1912 www.NV5.com
NC License # F-1333

4/22/2022

DRAWN BY : W.B. ALLEN DATE : 12/21
CHECKED BY : M.D. METZGER DATE : 12/21
DESIGN ENGINEER OF RECORD: L. K. AUSTIN DATE : 01/22

4/20/2022 10:47 AM G:\Project\2019\2019\7\03\CLIENT\Structures\I-5987B\I-5 - NC 2019\987B_SML\A53_77059.dgn