

5/14/99

PROJECT REFERENCE NO. 1-5987B SHEET NO. EC-90/CONST.44

RW SHEET NO. ROADSIDE ENVIRONMENTAL PROJECT ENGINEER

LEVEL III CERTIFIED BY: MATTHEW HARVEY, PE CERTIFICATION NUMBER: 3487 ISSUED: MARCH 15, 2022

Prepared in the Office of: MOTT MACDONALD 1223 Jones Franklin Rd. Raleigh, N.C. 27606 License No. 143777 Bui: 919 851 8077 Fax: 919 851 9107

NOTE: ALL EROSION CONTROL DEVICES SHOWN ARE LOCATED WITHIN EXISTING RW OR EASEMENT.

NOTE: CONTRACTOR SHALL MAINTAIN ALL DEVICES AS PROJECT IS BROUGHT UP TO GRADE.

NOTE: CONTRACTOR SHALL PROVIDE INLET PROTECTION FOR PARTIALLY INSTALLED STORM DRAINS. THIS MEASURE SHOULD BE INSTALLED AT THE END OF EACH WORKING DAY.

NOTE: INSTALL MATTING FOR EROSION CONTROL IN ALL PROPOSED DITCH LINES EXCEPT WHERE PERMANENT LINERS ARE SPECIFIED ON THE PLANS OR DIRECTED OTHERWISE BY THE ENGINEER.

FINAL EROSION CONTROL FOR CONSTRUCTION SHEET 44

NOTE: CONTRACTOR SHALL PROVIDE GROUND COVER ON EXPOSED SLOPES IN ACCORDANCE WITH THE "SOIL STABILIZATION TIMEFRAMES", SEE EC-3.

NOTE: UTILIZE FABRIC INSERT INLET PROTECTION DEVICES IN LIEU OF ROCK INLET SEDIMENT TRAPS TYPE-C, AS DIRECTED, TO AVOID IMPOUNDMENT OF RUNOFF IN ROADWAY OPEN TO TRAFFIC.



256 FAYE E. MCRAINEY REAVES DB 519 PG 355 PB 26 PG 23

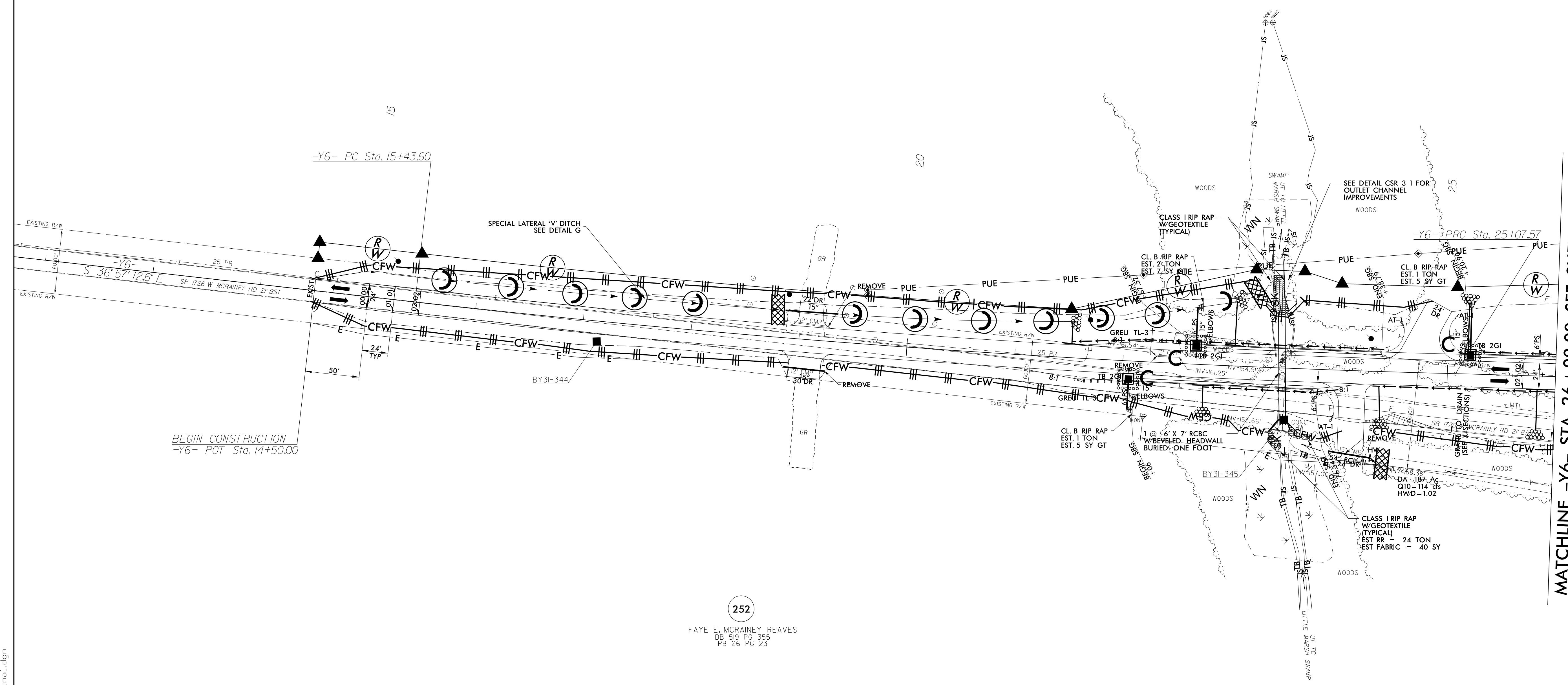

3/14/2022 E:\egston\_control\15987b\_EC\_PSH\_44\_f.mxd Mott MacDonald

252 FAYE E. MCRAINEY REAVES DB 519 PG 355 PB 26 PG 23

-Y6-

PI Sta 20+25.89	PI Sta 26+92.85
$\Delta = 4' 58' 32.9''$ (LT)	$\Delta = 1' 54' 45.5''$ (RT)
$D = 0' 30' 58.2''$	$D = 0' 30' 58.2''$
$L = 963.97'$	$L = 370.54'$
$T = 482.29'$	$T = 185.29'$
$R = 11,100.00'$	$R = 11,100.00'$
$SE = NC$	$SE = NC$

MATCHLINE -Y6- STA. 26 + 00.00 SEE SHEET NO. 25