

LEVEL III CERTIFIED BY: MATTHEW HARVEY, PE CERTIFICATION NUMBER: 3487 ISSUED: MARCH 15, 2022

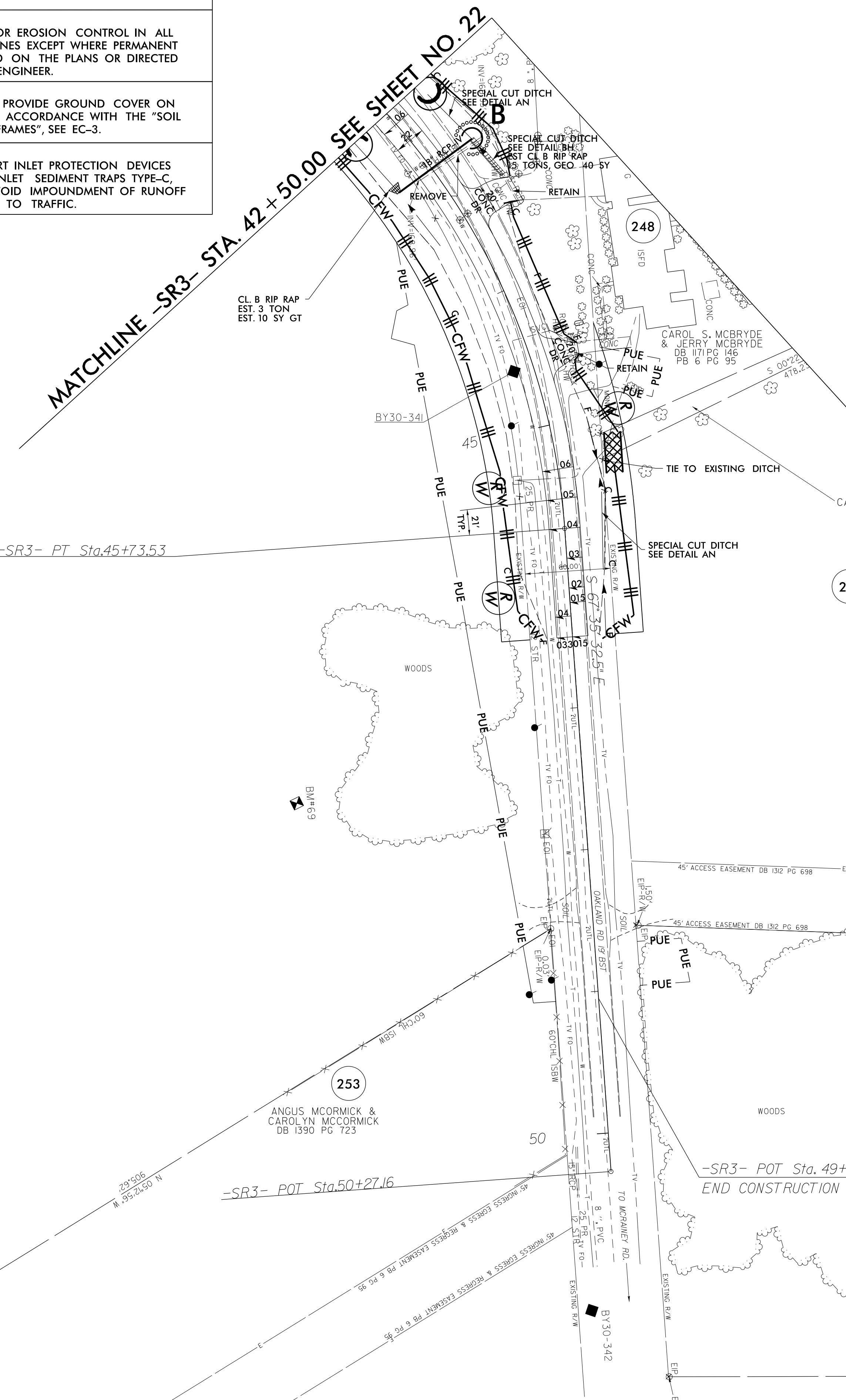

- NOTE: ALL EROSION CONTROL DEVICES SHOWN ARE LOCATED WITHIN EXISTING RW OR EASEMENT.
- NOTE: CONTRACTOR SHALL MAINTAIN ALL DEVICES AS PROJECT IS BROUGHT UP TO GRADE.
- NOTE: CONTRACTOR SHALL PROVIDE INLET PROTECTION FOR PARTIALLY INSTALLED STORM DRAINS. THIS MEASURE SHOULD BE INSTALLED AT THE END OF EACH WORKING DAY.
- NOTE: INSTALL MATTING FOR EROSION CONTROL IN ALL PROPOSED DITCH LINES EXCEPT WHERE PERMANENT LINERS ARE SPECIFIED ON THE PLANS OR DIRECTED OTHERWISE BY THE ENGINEER.
- FINAL EROSION CONTROL FOR CONSTRUCTION SHEET 43
- NOTE: CONTRACTOR SHALL PROVIDE GROUND COVER ON EXPOSED SLOPES IN ACCORDANCE WITH THE "SOIL STABILIZATION TIMEFRAMES", SEE EC-3.
- NOTE: UTILIZE FABRIC INSERT INLET PROTECTION DEVICES IN LIEU OF ROCK INLET SEDIMENT TRAPS TYPE-C, AS DIRECTED, TO AVOID IMPOUNDMENT OF RUNOFF IN ROADWAY OPEN TO TRAFFIC.



-SR3-  
 PI STA. 43+01.14  
 $\Delta = 81^{\circ} 52' 36.4''$  (RT)  
 $D = 11^{\circ} 48' 48.8''$   
 $L = 693.07'$   
 $T = 420.69'$   
 $R = 485.00'$   
 $SE = 0.06$   
 $RO = \text{SEE PLANS}$

242  
 MARY ANN REGAN  
 DB 507 PG 150  
 PB 6 PG 95

253  
 ANGUS MCCORMICK &  
 CAROLYN MCCORMICK  
 DB 1390 PG 723

250  
 CAROL S. MCBRYDE &  
 JERRY MCBRYDE  
 DB 1292 PG 138  
 PB 6 PG 95

251  
 FAYE E. MCRANEY REAVES  
 DB 519 PG 355  
 PB 26 PG 23

254  
 BRENDA JOYCE &  
 JIMMY MAULDIN  
 DB 874 PG 528



REVISIONS