

5/14/2022

3/14/2022
E:\Erosion_Control\15987B_EC_PSH_33_f.mxd
Mott MacDonald

NOTE: ALL EROSION CONTROL DEVICES SHOWN ARE LOCATED WITHIN EXISTING RW OR EASEMENT.

NOTE: CONTRACTOR SHALL PROVIDE INLET PROTECTION FOR PARTIALLY INSTALLED STORM DRAINS. THIS MEASURE SHOULD BE INSTALLED AT THE END OF EACH WORKING DAY.

FINAL EROSION CONTROL FOR CONSTRUCTION SHEET 33

NOTE: CONTRACTOR SHALL MAINTAIN ALL DEVICES AS PROJECT IS BROUGHT UP TO GRADE.

NOTE: INSTALL MATTING FOR EROSION CONTROL IN ALL PROPOSED DITCH LINES EXCEPT WHERE PERMANENT LINERS ARE SPECIFIED ON THE PLANS OR DIRECTED OTHERWISE BY THE ENGINEER.

NOTE: CONTRACTOR SHALL PROVIDE GROUND COVER ON EXPOSED SLOPES IN ACCORDANCE WITH THE "SOIL STABILIZATION TIMEFRAMES", SEE EC-3.

NOTE: UTILIZE FABRIC INSERT INLET PROTECTION DEVICES IN LIEU OF ROCK INLET SEDIMENT TRAPS TYPE-C, AS DIRECTED, TO AVOID IMPOUNDMENT OF RUNOFF IN ROADWAY OPEN TO TRAFFIC.

NAD 83/2011

PROJECT REFERENCE NO.	SHEET NO.
1-5897B	EC-79/CONST.33
RW SHEET NO.	
ROADSIDE ENVIRONMENTAL PROJECT ENGINEER	
LEVEL III CERTIFIED BY: MATTHEW HARVEY, PE CERTIFICATION NUMBER: 3487 ISSUED: MARCH 15, 2022	

Prepared in the Office of:

M M
MOTT MACDONALD

PO Box 700
Fuquay-Varina, NC 27526
www.mottmac.com/americas

ETHERILL ENGINEERING

1223 Jones Franklin Rd.
Raleigh, N.C. 27606
License No. 64377
Box: 919 851 8877
Fax: 919 851 8107

MATCHLINE -L- STA. 844 + 00.00 SEE SHEET NO. 32

MATCHLINE -L- STA. 856 + 00.00 SEE SHEET NO. 34

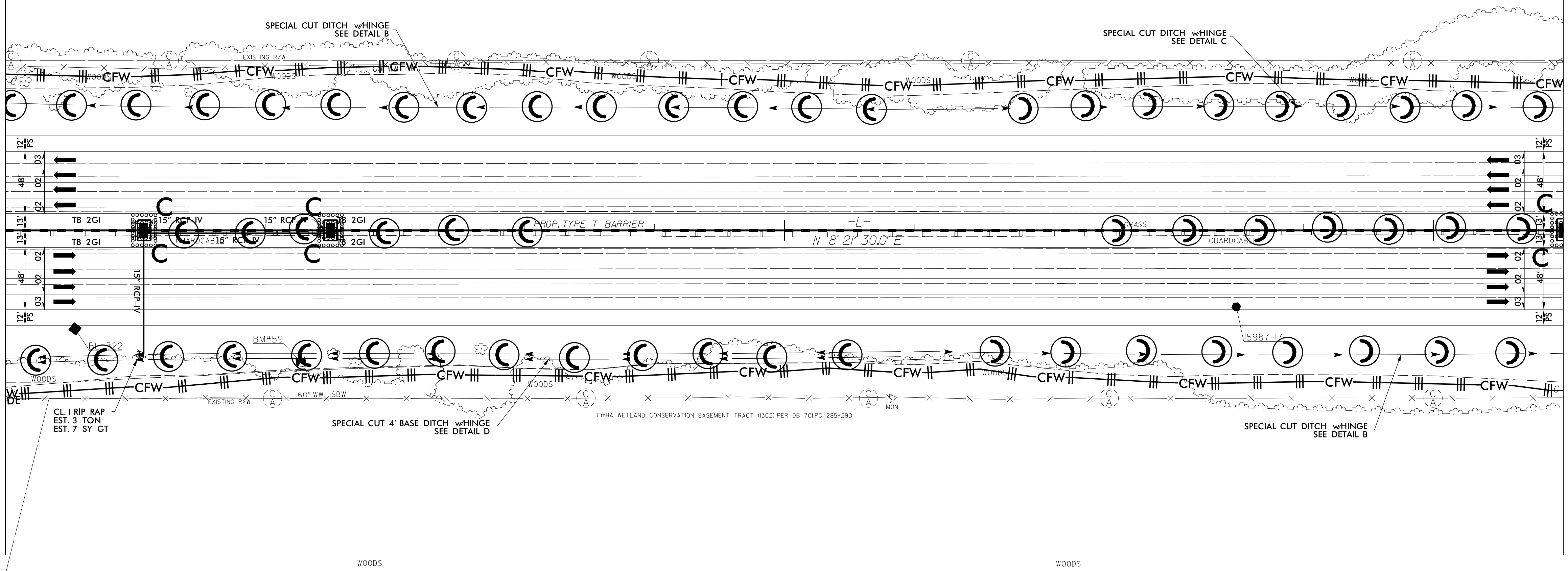

260

JAMES BRITT & RUTH
DB 710 PG 196