

5/14/2022

3/14/2022
E:\Erosion_Control\15987B_EC_PSH_23.dgn
Matt MacDonald

MATCHLINE -L- STA. 734 + 00.00 SEE SHEET NO. 22

MATCHLINE -L- STA. 746 + 00.00 SEE SHEET NO. 24

-L-
 PTA 727+38.59 PIs Sta 736+59.98
 $\Delta = 1^{\circ} 39' 04.3" (LT)$ $\Theta_s = 0^{\circ} 29' 58.8"$
 $D = 0^{\circ} 39' 58.4"$ $L_s = 150.00'$
 $L = 1748.82'$ $LT = 100.00'$
 $T = 877.44'$ $ST = 50.00'$
 $R = 8,600.00'$
 $SE = 0.03$

246 NO CLAIM
 MICHAEL JAMES CALKIN
 DB 2021 PG 773
 PB 6 PG 95

249 NO CLAIM
 REM BILLY RAY &
 EMMA JANE LOCKLEAR
 DB 1111 PG 521



- NOTE: ALL EROSION CONTROL DEVICES SHOWN ARE LOCATED WITHIN EXISTING RW OR EASEMENT.
- NOTE: CONTRACTOR SHALL MAINTAIN ALL DEVICES AS PROJECT IS BROUGHT UP TO GRADE.
- NOTE: CONTRACTOR SHALL PROVIDE INLET PROTECTION FOR PARTIALLY INSTALLED STORM DRAINS. THIS MEASURE SHOULD BE INSTALLED AT THE END OF EACH WORKING DAY.
- NOTE: INSTALL MATTING FOR EROSION CONTROL IN ALL PROPOSED DITCH LINES EXCEPT WHERE PERMANENT LINERS ARE SPECIFIED ON THE PLANS OR DIRECTED OTHERWISE BY THE ENGINEER.
- NOTE: UTILIZE FABRIC INSERT INLET PROTECTION DEVICES IN LIEU OF ROCK INLET SEDIMENT TRAPS TYPE-C, AS DIRECTED, TO AVOID IMPOUNDMENT OF RUNOFF IN ROADWAY OPEN TO TRAFFIC.
- NOTE: CONTRACTOR SHALL PROVIDE GROUND COVER ON EXPOSED SLOPES IN ACCORDANCE WITH THE "SOIL STABILIZATION TIMEFRAMES", SEE EC-3.
- FINAL EROSION CONTROL FOR CONSTRUCTION SHEET 23

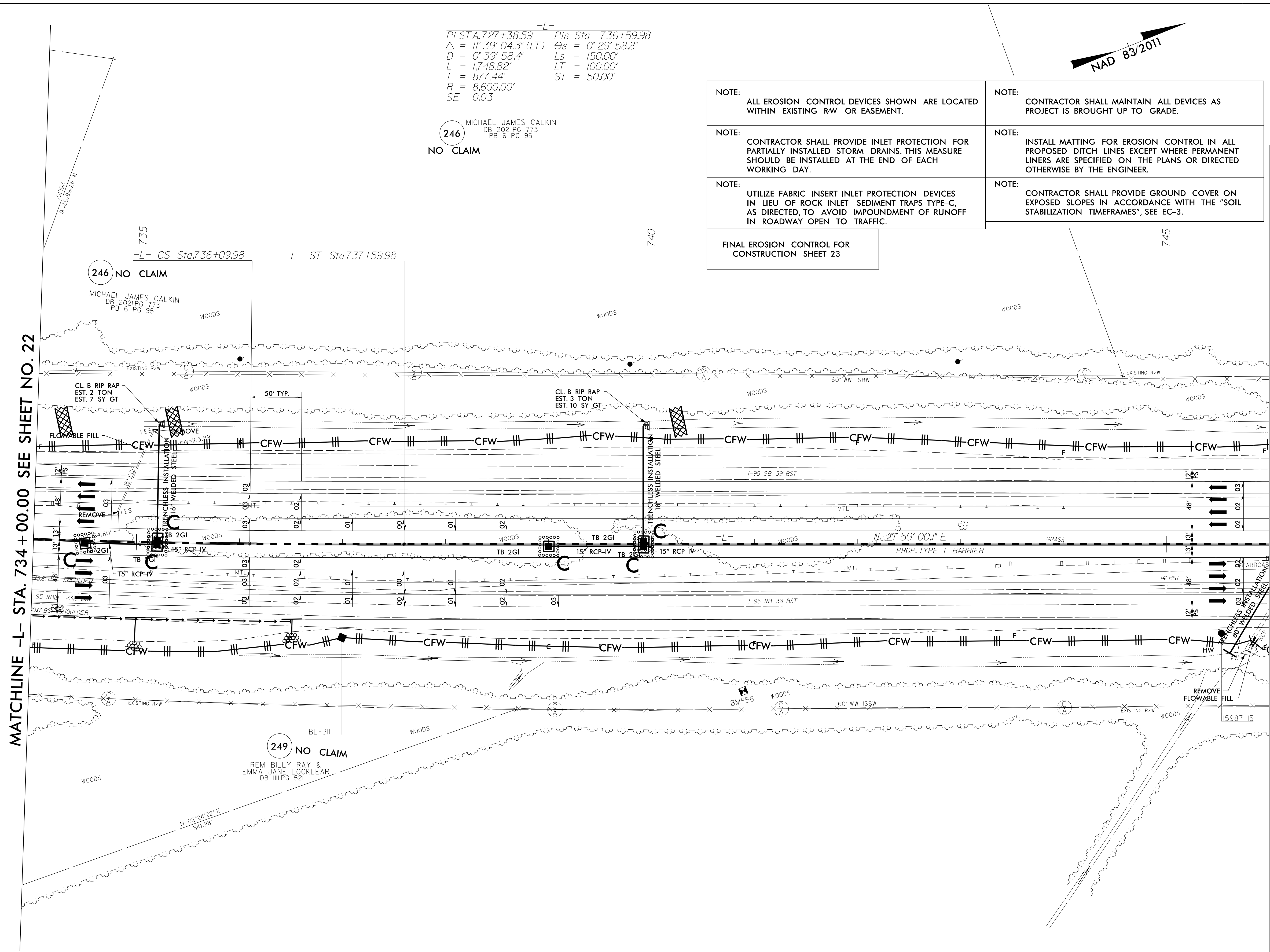

251

FAYE E. MCRAINEY REAVES
 DB 519 PG 355
 PB 26 PG 23

PROJECT REFERENCE NO.	SHEET NO.
1-5987B	EC-69/CONST.23
RW SHEET NO.	
ROADSIDE ENVIRONMENTAL PROJECT ENGINEER	
LEVEL III CERTIFIED BY: MATTHEW HARVEY, PE CERTIFICATION NUMBER: 3487 ISSUED: MARCH 15, 2022	
1223 Jones Franklin Rd. Raleigh, N.C. 27606 License No. F-0377 Bus: 919 851 8077 Fax: 919 851 8107	
TRANSPORTATION PLANNING/DESIGN - BRIDGE/STRUCTURE DESIGN CIVIL/SITE DESIGN - GIS/GPS - CONSTRUCTION OBSERVATION	