

REVISIONS

NOTE: ALL EROSION CONTROL DEVICES SHOWN ARE LOCATED WITHIN EXISTING RW OR EASEMENT.	NOTE: CONTRACTOR SHALL MAINTAIN ALL DEVICES AS PROJECT IS BROUGHT UP TO GRADE.
NOTE: CONTRACTOR SHALL PROVIDE INLET PROTECTION FOR PARTIALLY INSTALLED STORM DRAINS THIS MEASURE SHOULD BE INSTALLED AT THE END OF EACH WORKING DAY.	NOTE: INSTALL MATING FOR EROSION CONTROL IN ALL PROPOSED DITCH LINES EXCEPT WHERE PERMANENT LINERS ARE SPECIFIED ON THE PLANS OR DIRECTED OTHERWISE BY THE ENGINEER.
NOTE: UTILIZE FABRIC INLET PROTECTION DEVICES IN LIEU OF ROCK INLET SEDIMENT TRAPS TYPE-C, AS DIRECTED TO AVOID IMPONDMENT OF RUNOFF IN ROADWAY OPEN TO TRAFFIC.	NOTE: CONTRACTOR SHALL PROVIDE GROUND COVER ON EXPOSED SLOPES IN ACCORDANCE WITH THE 'SOIL STABILIZATION TIMBERFRAMES'; SEE EC-3.
FINAL EROSION CONTROL FOR CONSTRUCTION SHEET 20	

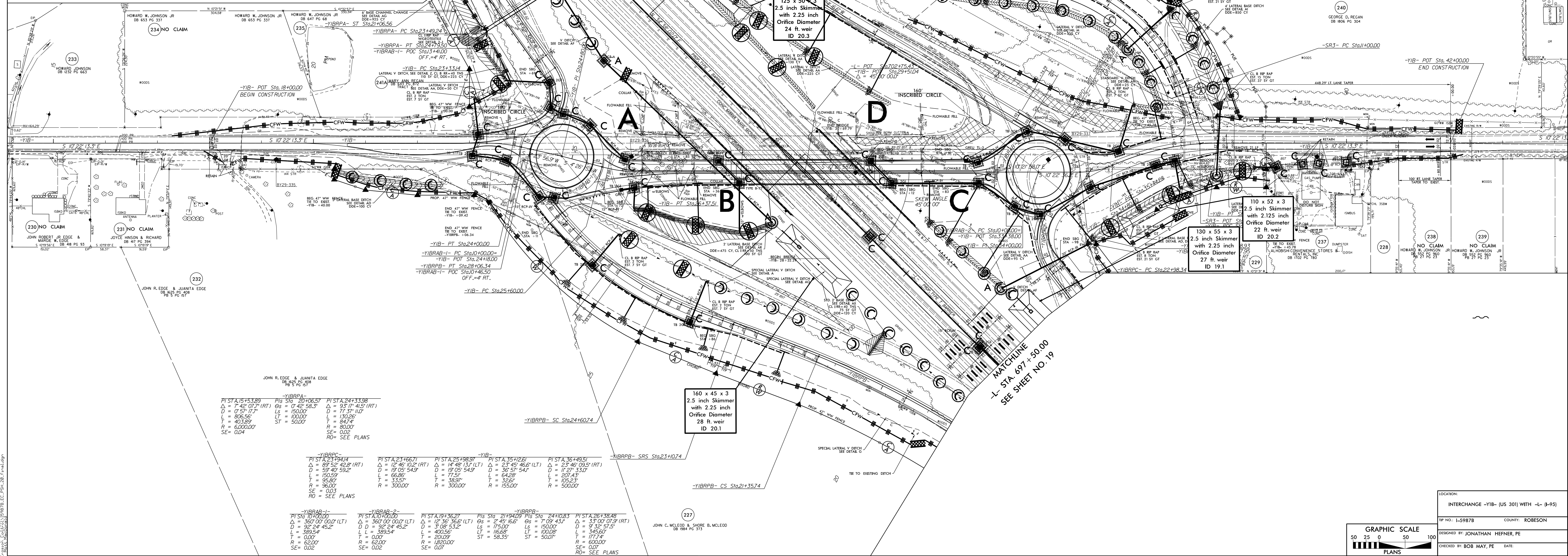

YIBRPA-1 PIST A: 15+53.89 $\Delta = 7.42' 07.2" (RT)$ $D = 0' 57' 17"$ $L = 806.56'$ $T = 403.89'$ $R = 60000.00'$ $SE = 0.04$	YIBRPA-2 PIS SIG: 20+06.57 $\Delta = 0.42' 56.3"$ $LS = 1600.00'$ $ST = 5000'$ $SE = 0.02$ $RO = SEE PLANS$	YIBRPA-3 PIST A: 24+33.98 $\Delta = 53' 11' 41.9" (RT)$ $D = 71' 37' 11.0"$ $L = 1302.96'$ $T = 847.4'$ $R = 80000.00'$ $SE = 0.02$ $RO = SEE PLANS$
YIBRPA-4 PIST A: 23+94.74 $\Delta = 89' 52' 42.8" (RT)$ $D = 59' 40' 59.2"$ $L = 1509.59'$ $T = 96.80'$ $R = 96.00'$ $SE = 0.03$ $RO = SEE PLANS$	YIBRPA-5 PIST A: 23+66.71 $\Delta = 12' 48' 13.1" (LT)$ $D = 15' 05' 54.8"$ $L = 66.86'$ $T = 35.53'$ $R = 3000.00'$ $SE = 0.07$	YIBRPA-6 PIST A: 25+98.97 $\Delta = 14' 48' 13.1" (LT)$ $D = 31' 05' 54.8"$ $L = 54.28'$ $T = 32.66'$ $R = 165.00'$ $SE = 0.07$
YIBRPA-7 PIST A: 26+138.48 $\Delta = 33' 00' 07.9" (RT)$ $D = 9' 32' 51.5"$ $L = 345.62'$ $T = 177.74'$ $R = 6000.00'$ $SE = 0.07$ $RO = SEE PLANS$	YIBRPA-8 PIST A: 24+100.00 $\Delta = 360' 00' 00.0" (LT)$ $D = 32' 24' 45.2"$ $L = 389.54'$ $T = 0.00'$ $R = 62.00'$ $SE = 0.02$	YIBRPA-9 PIST A: 24+100.00 $\Delta = 360' 00' 00.0" (LT)$ $D = 32' 24' 45.2"$ $L = 389.54'$ $T = 0.00'$ $R = 62.00'$ $SE = 0.02$

DATE: 3/16/2022

PROJECT REFERENCE NO.: EC-66/CONV-20
 SHEET NO.: 1-5987B
 ROADSIDE ENVIRONMENTAL PROJECT ENGINEER
 LEVEL III CERTIFIED BY: MATTHEW HARVEY, PE
 CERTIFICATION NUMBER: 3487
 ISSUED: MARCH 15, 2022

1223 AVON FAIRBANKS
 RANFA, N.C. 27056
 PHONE: 919.433.7271
 FAX: 919.951.8077
 TRANSPORTATION PLANNING/DESIGN + INFRASTRUCTURE DESIGN
 CONSULTING ENGINEERS + ARCHITECTS

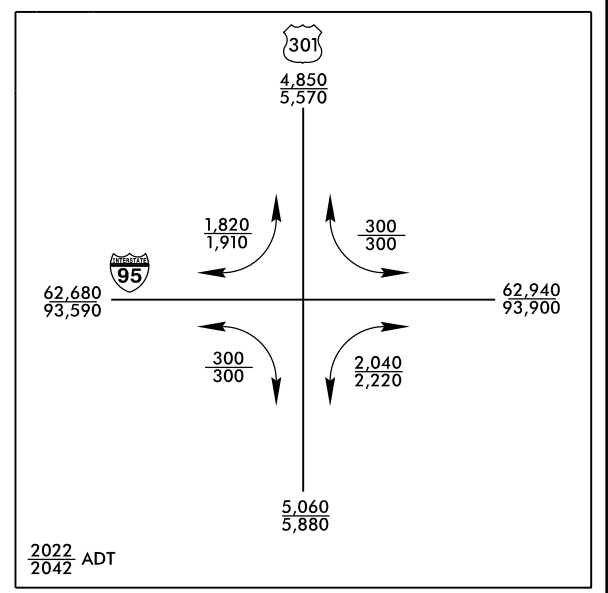

LOCATION: INTERCHANGE -YIB- (US 301) WITH -L- (I-95)
 TWP NO.: I-5987B COUNTY: ROBESON
 DESIGNED BY: JONATHAN HEFFNER, PE
 CHECKED BY: BOB MAY, PE DATE: