

5/14/2022

E:\gston_Central\15987B-EC.PSH-19-f.inel.dgn
Matt MacDonald

-L-
 Pls Sta 675+53.35 PI STA.685+01.00 Pls Sta 694+27.86
 $\Theta_s = 1^{\circ} 35' 29.6''$ $\Delta = 21^{\circ} 44' 41.8''$ (RT) $\Theta_s = 1^{\circ} 35' 29.6''$
 $L_s = 250.00'$ $D = 1^{\circ} 16' 23.7''$ $L_s = 250.00'$
 $LT = 166.67'$ $L = 1,707.84'$ $LT = 166.67'$
 $ST = 83.34'$ $T = 864.32'$ $ST = 83.34'$
 $R = 4,500.00'$ $R = 4,500.00'$
 $SE = 0.05$
 $RO = 250.00'$

-YIBRPB-
 Pls Sta 16+76.86 PI STA.19+36.27
 $\Theta_s = 2^{\circ} 45' 16.6''$ $\Delta = 12^{\circ} 36' 36.6''$ (LT)
 $L_s = 175.00'$ $D = 3^{\circ} 08' 53.2''$
 $LT = 116.68'$ $L = 400.56'$
 $ST = 58.35'$ $T = 201.09'$
 $R = 1,820.00'$
 $SE = 0.07$



PROJECT REFERENCE NO.	SHEET NO.
1-5987B	EC-65/CONST.19
RW SHEET NO.	
ROADSIDE ENVIRONMENTAL PROJECT ENGINEER	
LEVEL III CERTIFIED BY: MATTHEW HARVEY, PE CERTIFICATION NUMBER: 3487 ISSUED: MARCH 15, 2022	

ETHERILL ENGINEERING
 1223 Jones Franklin Rd.
 Raleigh, N.C. 27606
 License No. F-0377
 Bus: 919 851 8077
 Fax: 919 851 8107

TRANSPORTATION PLANNING/DESIGN - BRIDGE/STRUCTURE DESIGN
 CIVIL/SITE DESIGN - GIS/GPS - CONSTRUCTION OBSERVATION

- NOTE:** ALL EROSION CONTROL DEVICES SHOWN ARE LOCATED WITHIN EXISTING RW OR EASEMENT.
- NOTE:** CONTRACTOR SHALL MAINTAIN ALL DEVICES AS PROJECT IS BROUGHT UP TO GRADE.
- NOTE:** CONTRACTOR SHALL PROVIDE INLET PROTECTION FOR PARTIALLY INSTALLED STORM DRAINS. THIS MEASURE SHOULD BE INSTALLED AT THE END OF EACH WORKING DAY.
- NOTE:** INSTALL MATTING FOR EROSION CONTROL IN ALL PROPOSED DITCH LINES EXCEPT WHERE PERMANENT LINERS ARE SPECIFIED ON THE PLANS OR DIRECTED OTHERWISE BY THE ENGINEER.
- NOTE:** UTILIZE FABRIC INSERT INLET PROTECTION DEVICES IN LIEU OF ROCK INLET SEDIMENT TRAPS TYPE-C, AS DIRECTED, TO AVOID IMPOUNDMENT OF RUNOFF IN ROADWAY OPEN TO TRAFFIC.
- NOTE:** CONTRACTOR SHALL PROVIDE GROUND COVER ON EXPOSED SLOPES IN ACCORDANCE WITH THE "SOIL STABILIZATION TIMEFRAMES", SEE EC-3.
- FINAL EROSION CONTROL FOR CONSTRUCTION SHEET 19

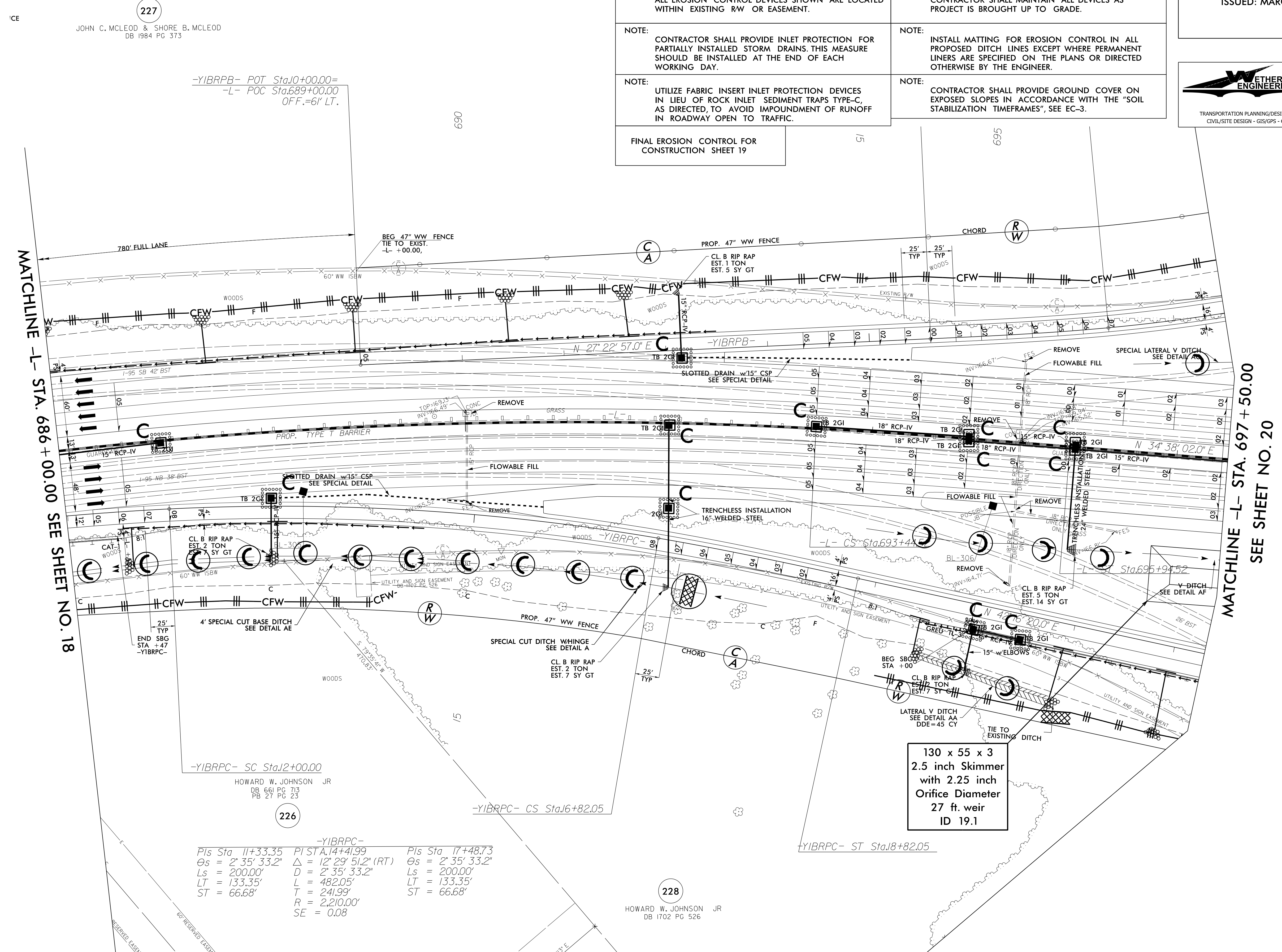

MATCHLINE -L- STA. 686 + 00.00 SEE SHEET NO. 18

MATCHLINE -L- STA. 697 + 50.00 SEE SHEET NO. 20

227
 JOHN C. MCLEOD & SHORE B. MCLEOD
 DB 1984 PG 373

226
 HOWARD W. JOHNSON JR
 DB 66 PG 713
 PB 27 PG 23

228
 HOWARD W. JOHNSON JR
 DB 1702 PG 526

130 x 55 x 3
 2.5 inch Skimmer
 with 2.25 inch
 Orifice Diameter
 27 ft. weir
 ID 19.1

-YIBRPC-
 Pls Sta 11+33.35 PI STA.14+41.99 Pls Sta 17+48.73
 $\Theta_s = 2^{\circ} 35' 33.2''$ $\Delta = 12^{\circ} 29' 51.2''$ (RT) $\Theta_s = 2^{\circ} 35' 33.2''$
 $L_s = 200.00'$ $D = 2^{\circ} 35' 33.2''$ $L_s = 200.00'$
 $LT = 133.35'$ $L = 482.05'$ $LT = 133.35'$
 $ST = 66.68'$ $T = 241.99'$ $ST = 66.68'$
 $R = 2,210.00'$
 $SE = 0.08$