

5/14/99

CLEARING AND GRUBBING  
EROSION CONTROL FOR  
CONSTRUCTION SHEET 27

NOTE:  
PLACE TEMPORARY ROCK SEDIMENT DAMS TYPE - B  
AND TEMPORARY ROCK SILT CHECKS TYPE - A AT  
DRAINAGE OUTLETS.

NOTE:  
PERIMETER EROSION CONTROL MEASURES SHALL BE  
INSTALLED DURING CLEARING AND GRUBBING PHASE.

NOTE:  
CONTRACTOR SHALL PROVIDE GROUND COVER ON  
EXPOSED SLOPES IN ACCORDANCE WITH THE "SOIL  
STABILIZATION TIMEFRAMES", SEE EC-3.

NOTE:  
PRIOR TO INSTALLATION OF EROSION CONTROL DEVICES,  
CONTRACTOR SHALL VERIFY BOUNDARIES OF JURISDICTIONAL  
AREAS AND DELINEATE WITH SAFETY FENCE OR FLAGGING.

NOTE:  
ALL EROSION CONTROL DEVICES SHOWN ARE LOCATED  
WITHIN EXISTING RW OR EASEMENT.

PROJECT REFERENCE NO. SHEET NO.  
1-5897B EC-28/CONST.27  
RW SHEET NO.  
ROADSIDE ENVIRONMENTAL PROJECT ENGINEER

LEVEL III CERTIFIED BY:  
MATTHEW HARVEY, PE  
CERTIFICATION NUMBER: 3487  
ISSUED: MARCH 15, 2022

Prepared in the  
Office of:  
**M**  
MOTT  
MACDONALD  
PO Box 700  
Fuquay-Varina, NC 27526  
www.mottmac.com/americas

**M**  
ETHERILL  
ENGINEERING  
1223 Jones Franklin Rd.  
Raleigh, N.C. 27606  
License No. F-4377  
Bus: 919.951.8077  
Fax: 919.951.9107

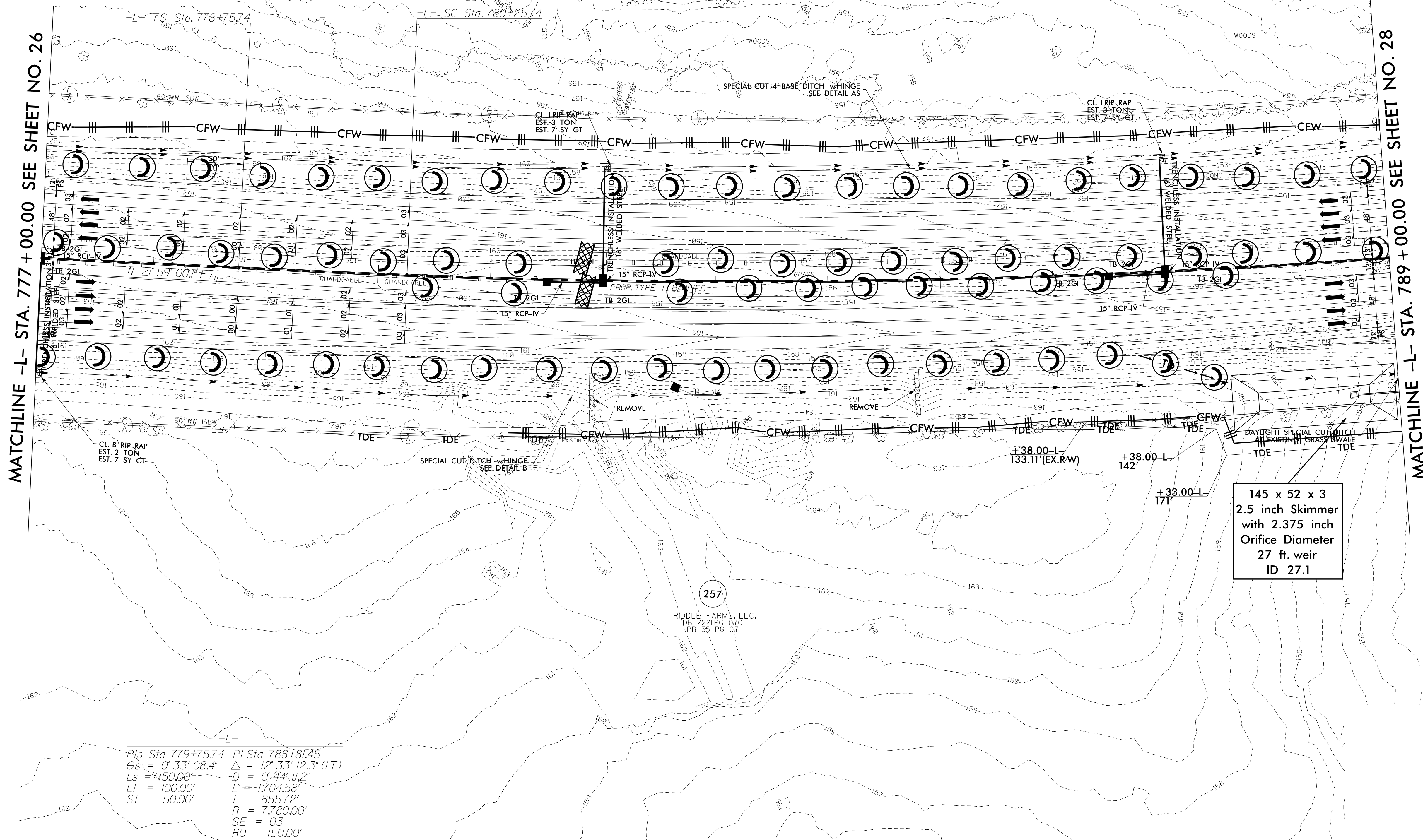

PI Sta 779+75.74	PI Sta 788+81.45
$\theta_s = 0^\circ 33' 08.4''$	$\Delta = 12^\circ 33' 12.3''$ (LT)
$L_s = 150.00'$	$D = 0' 44' 11.2''$
$LT = 100.00'$	$L = 1704.58'$
$ST = 50.00'$	$T = 855.72'$
	$R = 7780.00'$
	$SE = 03$
	$RO = 150.00'$

3/14/2022  
Erosion\_Control\15897B\_EC\_PSH\_27.CG.dgn  
Mott MacDonald