

5/14/22

PROJECT REFERENCE NO.	SHEET NO.
I-5987B	EC-16/CONST.15
RW SHEET NO.	
ROADSIDE ENVIRONMENTAL PROJECT ENGINEER	
LEVEL III CERTIFIED BY: ELENI M. RIGGS, PE CERTIFICATION NUMBER: 3056 ISSUED: MARCH 15, 2022	
Prepared in the Office of:	M MOTT MACDONALD 7621 Purfoy Rd, Suite 115 Fuquay-Varina, NC 27526 www.mottmac.com/americas
CLEARING AND GRUBBING EROSION CONTROL FOR CONSTRUCTION SHEET 15	

NAD 83/2011

MATCHLINE -L- STA. 640 + 00.00 SEE SHEET NO. 14

MATCHLINE -L- STA. 650 + 00.00 SEE SHEET NO. 16

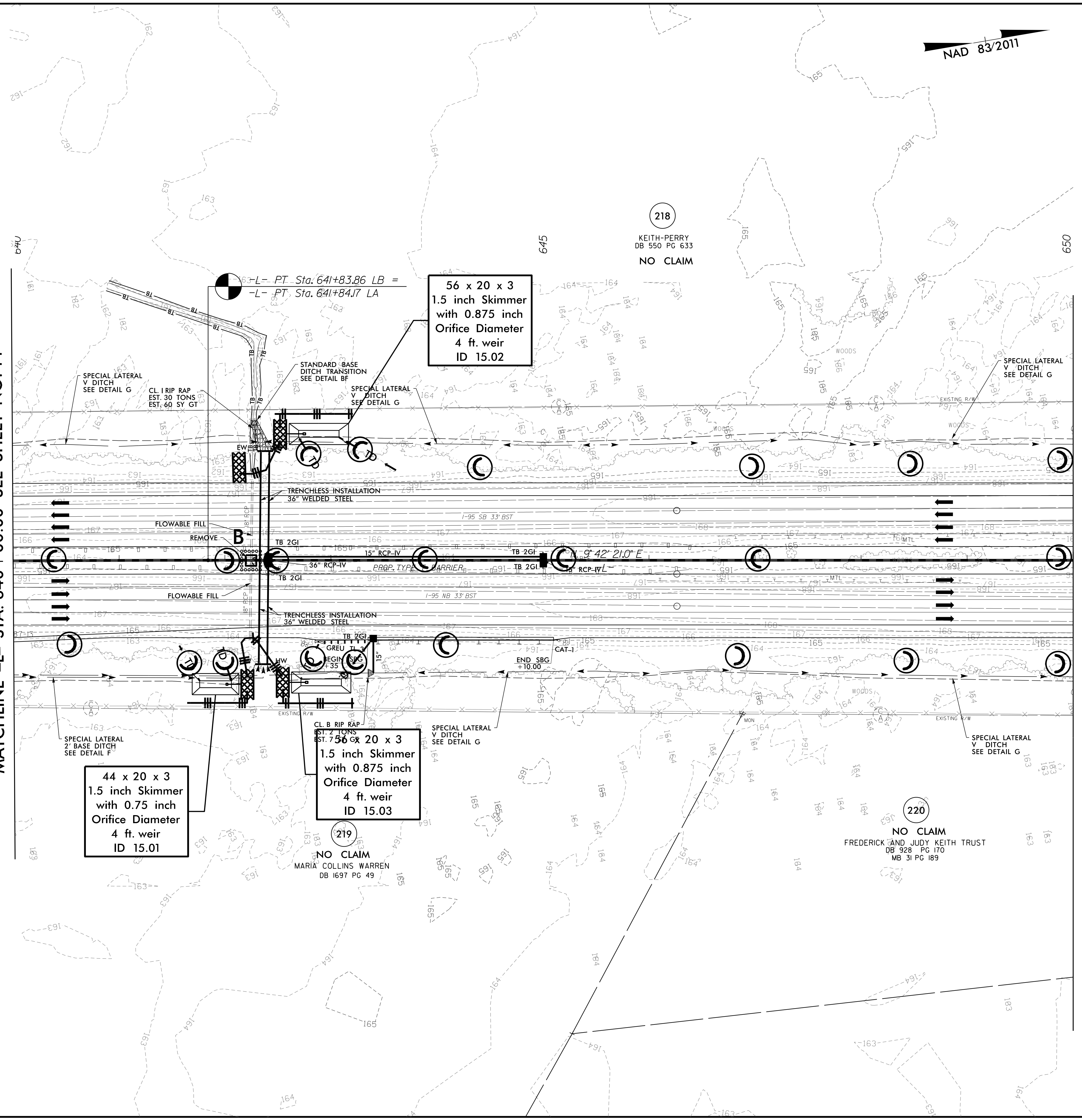

218
KEITH-PERRY
DB 550 PG 633
NO CLAIM

219
NO CLAIM
MARIA COLLINS WARREN
DB 1697 PG 49

220
NO CLAIM
FREDERICK AND JUDY KEITH TRUST
DB 928 PG 170
MB 31 PG 189

- NOTE: PLACE TEMPORARY ROCK SEDIMENT DAMS TYPE - B AND TEMPORARY ROCK SILT CHECKS TYPE - A AT DRAINAGE OUTLETS.
- NOTE: ALL EROSION CONTROL DEVICES SHOWN ARE LOCATED WITHIN EXISTING RW OR EASEMENT.
- NOTE: PERIMETER EROSION CONTROL MEASURES SHALL BE INSTALLED DURING CLEARING AND GRUBBING PHASE.
- NOTE: CONTRACTOR SHALL PROVIDE GROUND COVER ON EXPOSED SLOPES IN ACCORDANCE WITH THE "SOIL STABILIZATION TIMEFRAMES", SEE EC-3.
- NOTE: PRIOR TO INSTALLATION OF EROSION CONTROL DEVICES, CONTRACTOR SHALL VERIFY BOUNDARIES OF JURISDICTIONAL AREAS AND DELINEATE WITH SAFETY FENCE OR FLAGGING.

R:\E-co\3\14\2022\15987b-ec\esh16.ec.dgn