

5/14/2022

3/14/2022
MOTT MACDONALD

CONSTRUCTION SEQUENCE STA. 20+33 -Y5RPA-

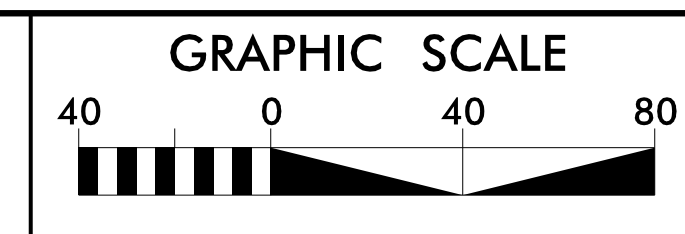
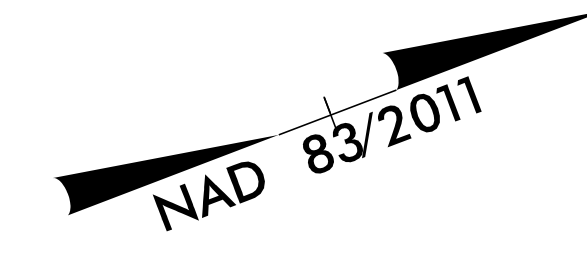

PROJECT REFERENCE NO.	SHEET NO.
1-5987B	EC-13A/CONST13
RW SHEET NO.	
ROADSIDE ENVIRONMENTAL PROJECT ENGINEER	
LEVEL III CERTIFIED BY: ELENI M. RIGGS, PE CERTIFICATION NUMBER: 3056 ISSUED: MARCH 15, 2022	

Prepared in the Office of:

M MOTT MACDONALD

7621 Purfoy Road, Suite 115
Fuquay-Varina, NC 27526
(919) 552-2253
www.mottmac.com
NC License No. F-0669

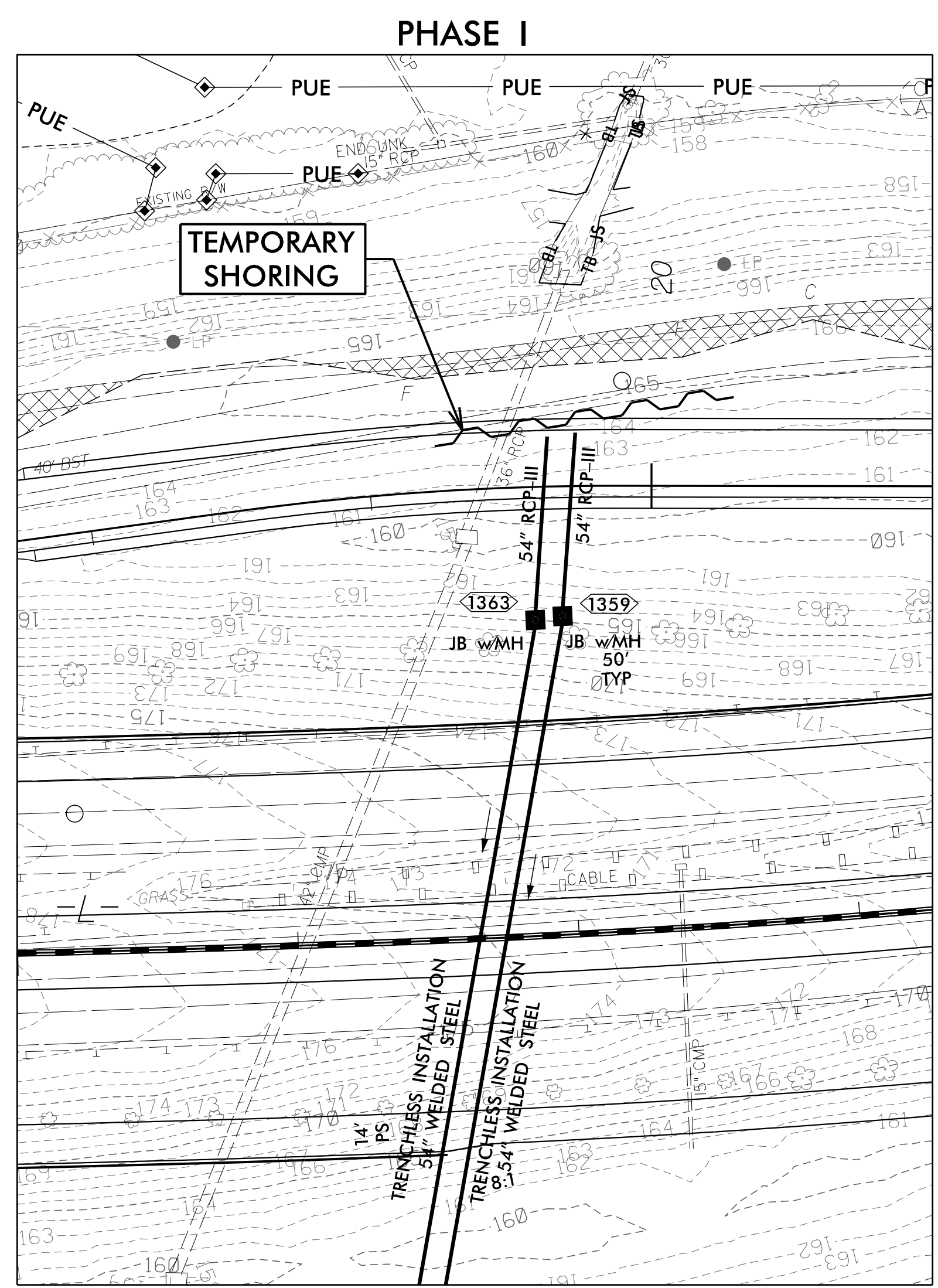

- 1.) UTILIZE SPECIAL STILLING BASIN(S) AS NEEDED THROUGHOUT PIPE CONSTRUCTION/INSTALLATION.
- 2.) MAINTAIN TRAFFIC ON THE EXISTING RAMP AND MAINTAIN FLOW IN THE EXISTING 36" RCP.
- 3.) INSTALL (2) @ 54" TRENCHLESS INSTALLATION WELDED STEEL PIPES UNDER -L- AND -Y5RPD- AND BOTH JUNCTION BOXES (STR. #1359 AND #1363).
- 4.) INSTALL TEMPORARY SHORING ACCORDING TO TMP STAGING PLANS.
- 5.) INSTALL APPROXIMATELY 64 LF OF BOTH PROPOSED 54" RCP-III INCLUDING TIES TO THE JUNCTION BOXES.
- 6.) CONSTRUCT PROPOSED -Y5RPA-, AS DETAILED IN THE TMP STAGING PLANS.

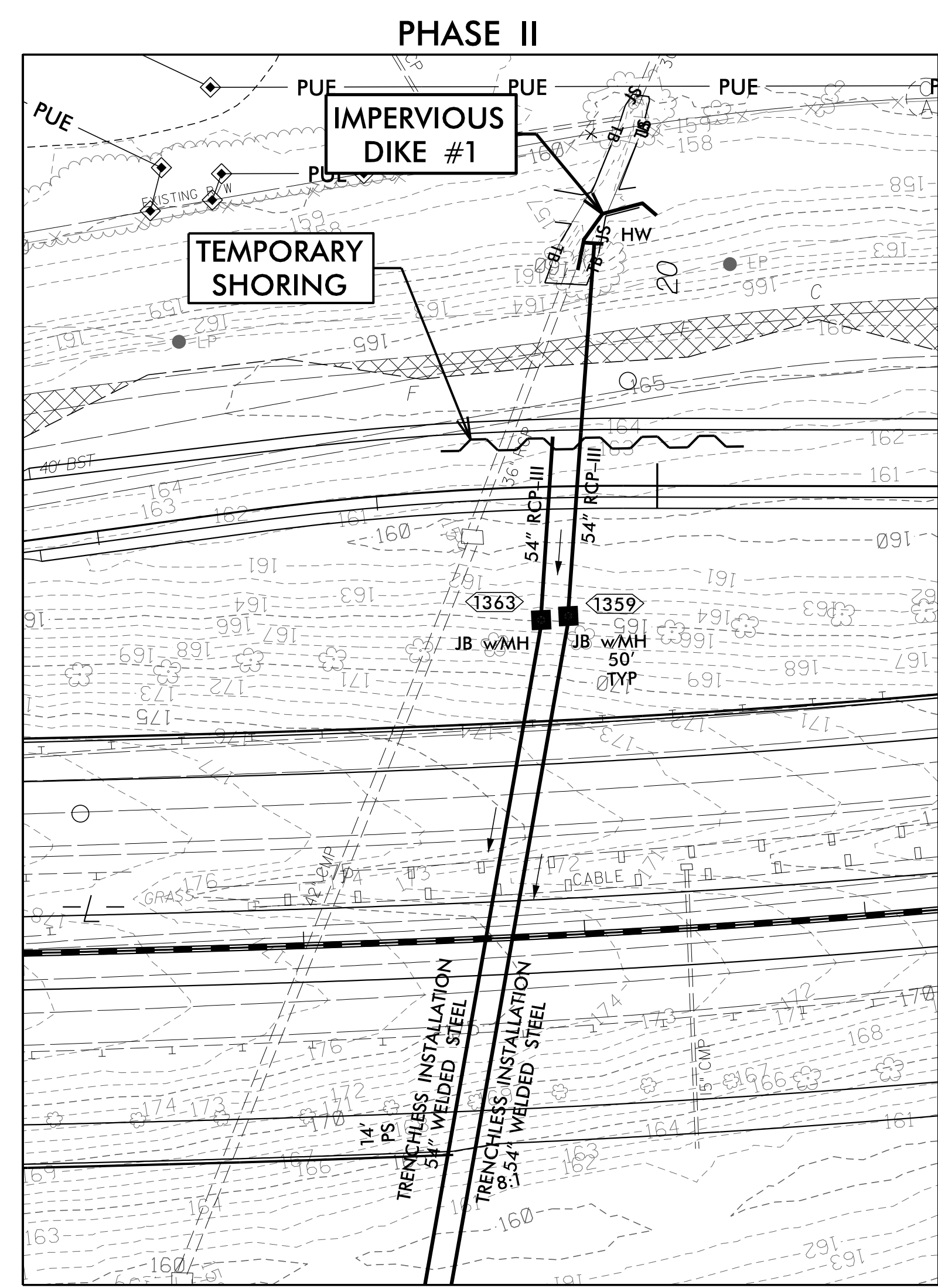

- 1.) INSTALL TEMPORARY SHORING ACCORDING TO TMP STAGING PLANS.
- 2.) INSTALL IMPERVIOUS DIKE #1.
- 3.) INSTALL THE REMAINING PORTION OF THE NORTHERN PROPOSED 54" RCP-III, INCLUDING HEADWALL.
- 4.) REMOVE IMPERVIOUS DIKE #1.

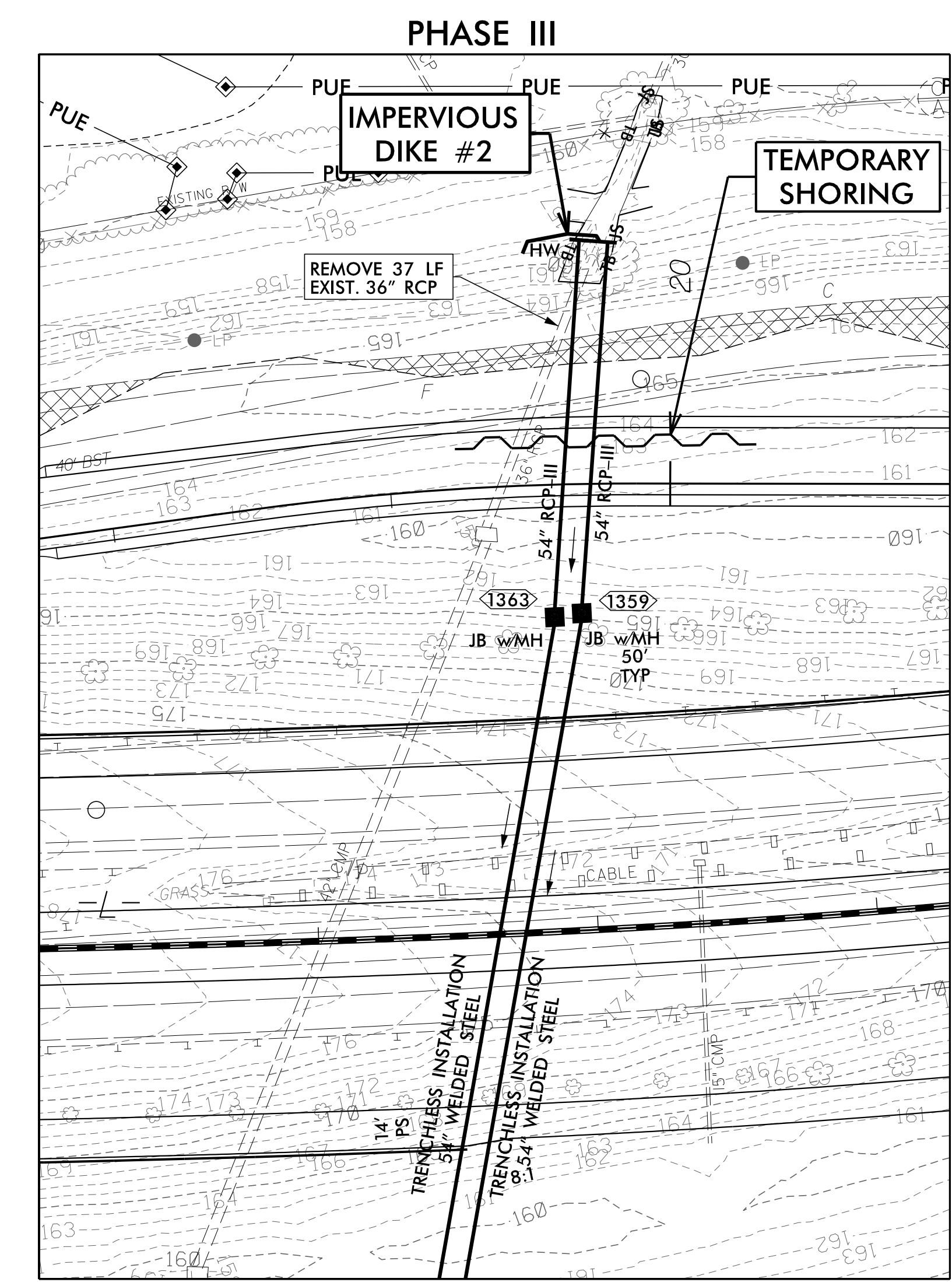

- 1.) INSTALL IMPERVIOUS DIKE #2 AND DIRECT FLOW INTO THE NEWLY INSTALLED 54" RCP-III
- 2.) REMOVE APPROXIMATELY 37 LF OF EXISTING 36" RCP.
- 3.) INSTALL THE REMAINING PORTION OF THE SOUTHERN PROPOSED 54" RCP-III AND TIE HEADWALL TO THE PORTION CONSTRUCTED IN PHASE II.
- 4.) REMOVE IMPERVIOUS DIKE #2, ALLOWING FLOW INTO BOTH 54" RCP-III. REMOVE ANY REMAINING SPECIAL STILLING BASIN(S).
- 5.) REMOVE PAVEMENT FROM EXISTING RAMP AND OPEN THE FULL WIDTH OF NEWLY CONSTRUCTED -Y5RPA- TO TRAFFIC.