

**I-95 SOUTHBOUND NOTE:**  
**ALL ADVANCE SIGNS FOR EXIT 33 SHALL BE COVERED WHILE RAMP IS CLOSED**

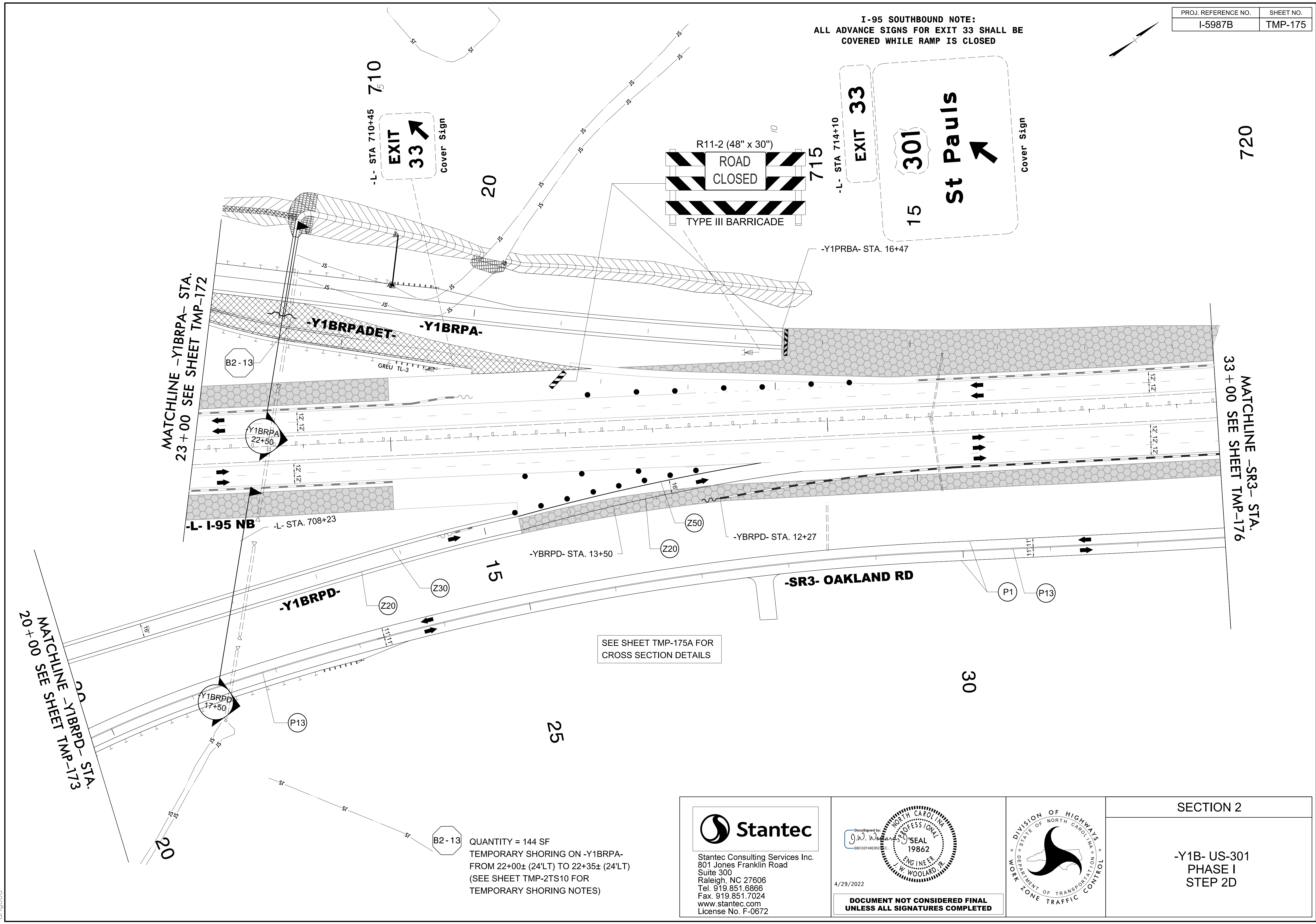

4/21/2022  
 U:\Traffic\Transportation Management Plan\TCP\PLAN SHEETS\I-5987B\_TMP\_175\_PHASE 1\_STEP 2D.dgn  
 angood

MATCHLINE -Y1BRPD- STA. 20+00 SEE SHEET TMP-173

MATCHLINE -Y1BRPA- STA. 23+00 SEE SHEET TMP-172

MATCHLINE -SR3- STA. 33+00 SEE SHEET TMP-176

022

B2-13 QUANTITY = 144 SF  
 TEMPORARY SHORING ON -Y1BRPA-  
 FROM 22+00± (24'LT) TO 22+35± (24'LT)  
 (SEE SHEET TMP-2TS10 FOR  
 TEMPORARY SHORING NOTES)

SEE SHEET TMP-175A FOR  
 CROSS SECTION DETAILS

**Stantec**  
 Stantec Consulting Services Inc.  
 801 Jones Franklin Road  
 Suite 300  
 Raleigh, NC 27606  
 Tel. 919.851.6866  
 Fax. 919.851.7024  
 www.stantec.com  
 License No. F-0672

DocuSigned by  
 J.W. Woolard  
 PROFESSIONAL  
 SEAL  
 19862  
 ENGINEER  
 J.W. WOOLARD, JR.  
 4/29/2022  
**DOCUMENT NOT CONSIDERED FINAL  
 UNLESS ALL SIGNATURES COMPLETED**

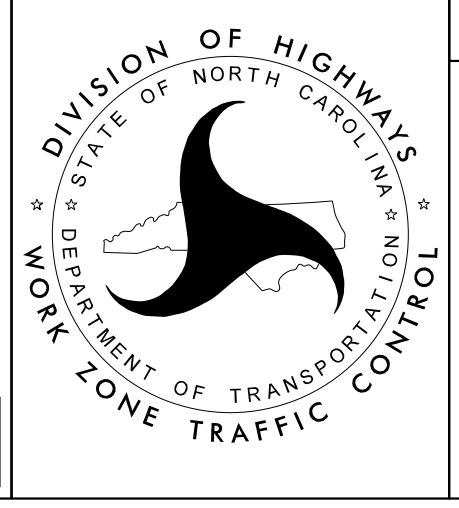

SECTION 2  
 -Y1B- US-301  
 PHASE I  
 STEP 2D