

PLANS PREPARED FOR THE NCDOT BY:
M MOTT MACDONALD I & E, LLC
 1101 HAYNES STREET, SUITE 101
 RALEIGH, NC 27604
M MOTT MACDONALD NC LICENSE NO. F-0669

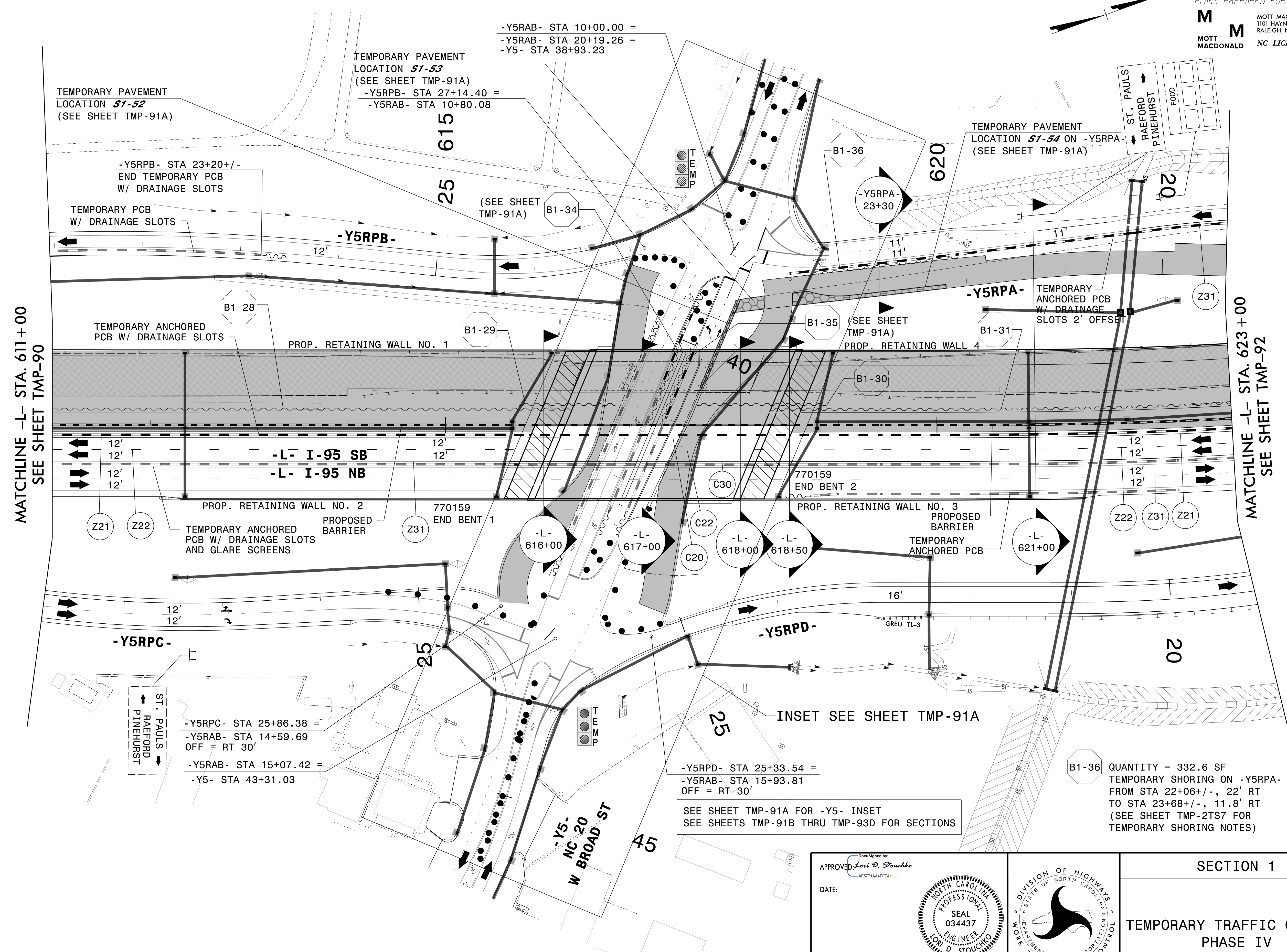

MATCHLINE -L- STA. 611+00
SEE SHEET TMP-90

MATCHLINE -L- STA. 623+00
SEE SHEET TMP-92

-Y5RPC- STA 25+86.38 =
 -Y5RAB- STA 14+59.69
 OFF = RT 30'
 -Y5RAB- STA 15+07.42 =
 -Y5- STA 43+31.03

-Y5RAB- STA 10+00.00 =
 -Y5RAB- STA 20+19.26 =
 -Y5- STA 38+93.23

TEMPORARY PAVEMENT
 LOCATION **S1-53**
 (SEE SHEET TMP-91A)
 -Y5RPB- STA 27+14.40 =
 -Y5RAB- STA 10+80.08

TEMPORARY PAVEMENT
 LOCATION **S1-54** ON -Y5RPA-
 (SEE SHEET TMP-91A)

-Y5RPD- STA 25+33.54 =
 -Y5RAB- STA 15+93.81
 OFF = RT 30'

SEE SHEET TMP-91A FOR -Y5- INSET
 SEE SHEETS TMP-91B THRU TMP-93D FOR SECTIONS

B1-36 QUANTITY = 332.6 SF
 TEMPORARY SHORING ON -Y5RPA-
 FROM STA 22+06+/-, 22' RT
 TO STA 23+68+/-, 11.8' RT
 (SEE SHEET TMP-2TS7 FOR
 TEMPORARY SHORING NOTES)

3/29/2022
 G:\50100191\NV5_1-5987B\TrafficControl\Tc\200_425_1-5987B-TMP-91_Phase IV Step L14.dgn
 User:ST086227

APPROVED: *Lori D. Stouchko*
 DATE: _____
 PROFESSIONAL SEAL
 034437
 ENGINEER
 LORI D. STOUCHKO

DOCUMENT NOT CONSIDERED FINAL
 UNLESS ALL SIGNATURES COMPLETED

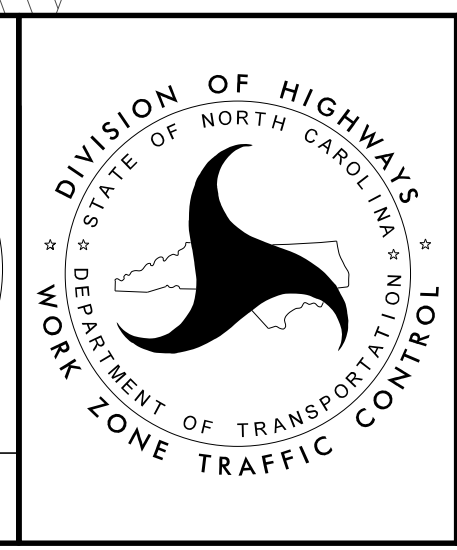

SECTION 1
 TEMPORARY TRAFFIC CONTROL
 PHASE IV