

PLANS PREPARED FOR THE NCDOT BY:

M MOTT MACDONALD I & E, LLC
1101 HAYNES STREET, SUITE 101
RALEIGH, NC 27604
NC LICENSE NO. F-0669

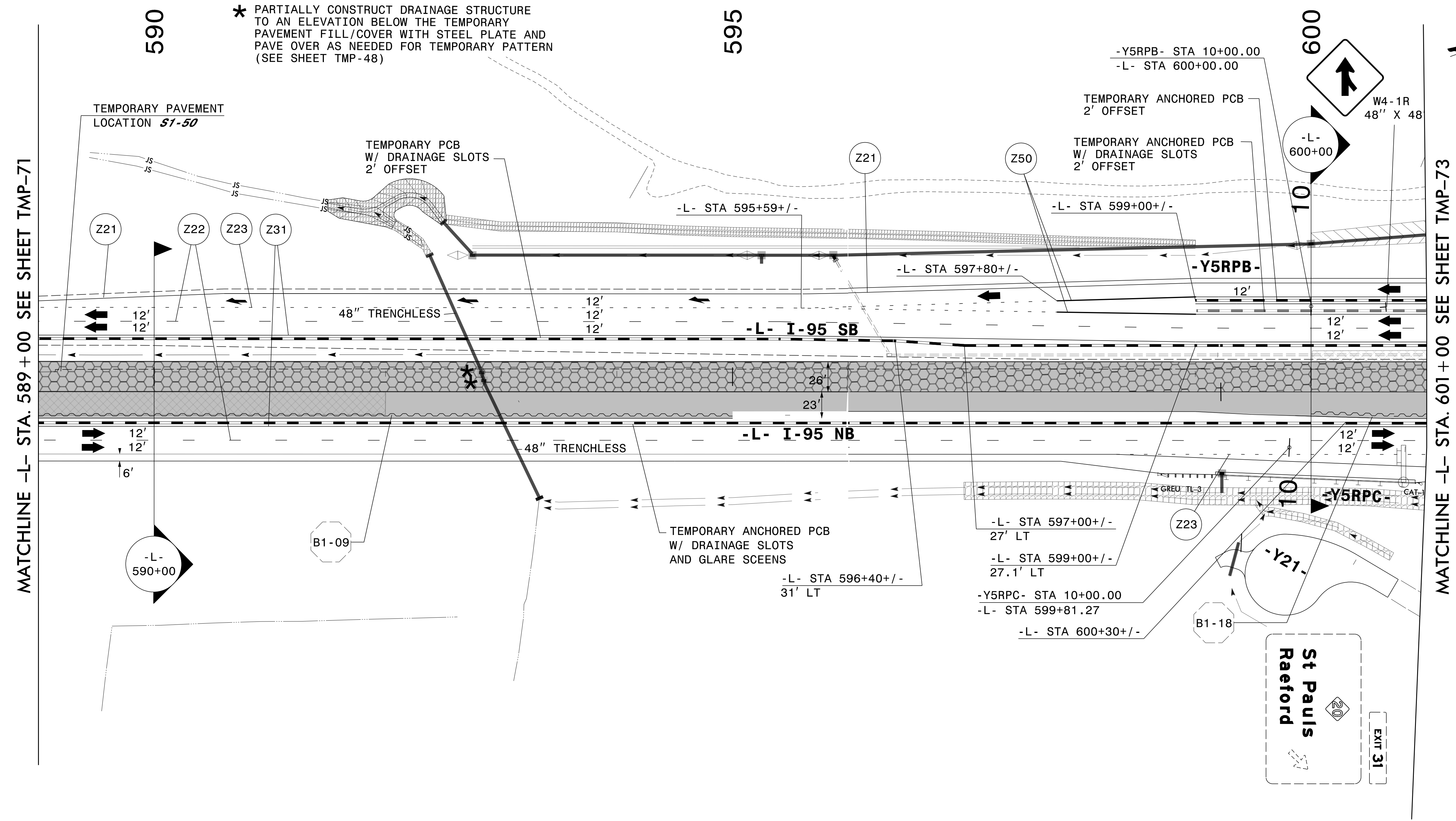

* PARTIALLY CONSTRUCT DRAINAGE STRUCTURE TO AN ELEVATION BELOW THE TEMPORARY PAVEMENT FILL/COVER WITH STEEL PLATE AND PAVE OVER AS NEEDED FOR TEMPORARY PATTERN (SEE SHEET TMP-48)

TEMPORARY PAVEMENT LOCATION S1-50

TEMPORARY PCB W/ DRAINAGE SLOTS 2' OFFSET

TEMPORARY ANCHORED PCB 2' OFFSET

TEMPORARY ANCHORED PCB W/ DRAINAGE SLOTS 2' OFFSET

-L- STA 595+59+/-

-L- STA 599+00+/-

-L- STA 597+80+/-

-Y5RBP-

-L- I-95 SB

-L- I-95 NB

48" TRENCHLESS

TEMPORARY ANCHORED PCB W/ DRAINAGE SLOTS AND GLARE SCREENS

-L- STA 596+40+/- 31' LT

-L- STA 597+00+/- 27' LT

-L- STA 599+00+/- 27.1' LT

-Y5RPC- STA 10+00.00

-L- STA 599+81.27

-L- STA 600+30+/-

MATCHLINE -L- STA. 589 + 00 SEE SHEET TMP-71

MATCHLINE -L- STA. 601 + 00 SEE SHEET TMP-73

TEMPORARY PAVEMENT LOCATION S1-50 FOR TEMPORARY ENTRANCE RAMP ON -L- FROM STA 587+61+/- TO STA 605+30+/- FOR TEMPORARY TRAFFIC PATTERN (45773 SF)

SEE SHEET TMP-72A FOR SECTIONS

3/29/2022 G:\50100191\NV5_1-5987B\TrafficControl\Top\200_359_1-5987B-TMP-72_Phase III.dgn User:ST086227

DocuSigned by:
APPROVED: *Lori D. Stouchko*
AF571AAAF411

DATE: _____

DOCUMENT NOT CONSIDERED FINAL UNLESS ALL SIGNATURES COMPLETED

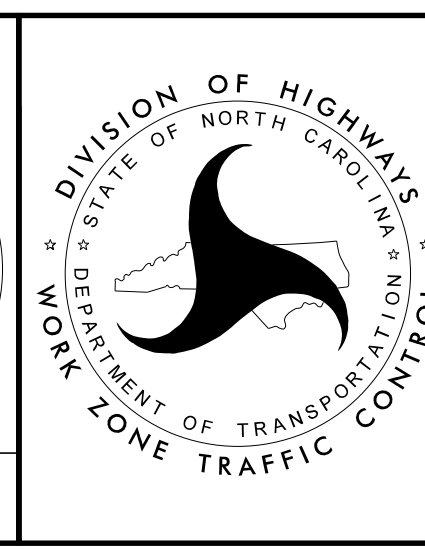

SECTION 1

TEMPORARY TRAFFIC CONTROL PHASE III