

PLANS PREPARED FOR THE NCDOT BY:

M MOTT MACDONALD I & E, LLC
 1101 HAYNES STREET, SUITE 101
 RALEIGH, NC 27604
M MOTT MACDONALD NC LICENSE NO. F-0669

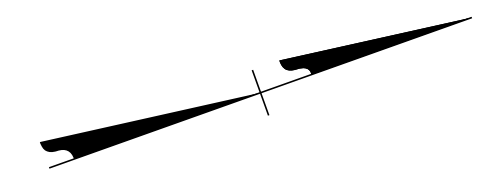

MATCHLINE -L- STA. 601+00 SEE SHEET TMP-44

MATCHLINE -L- STA. 611+00 SEE SHEET TMP-46

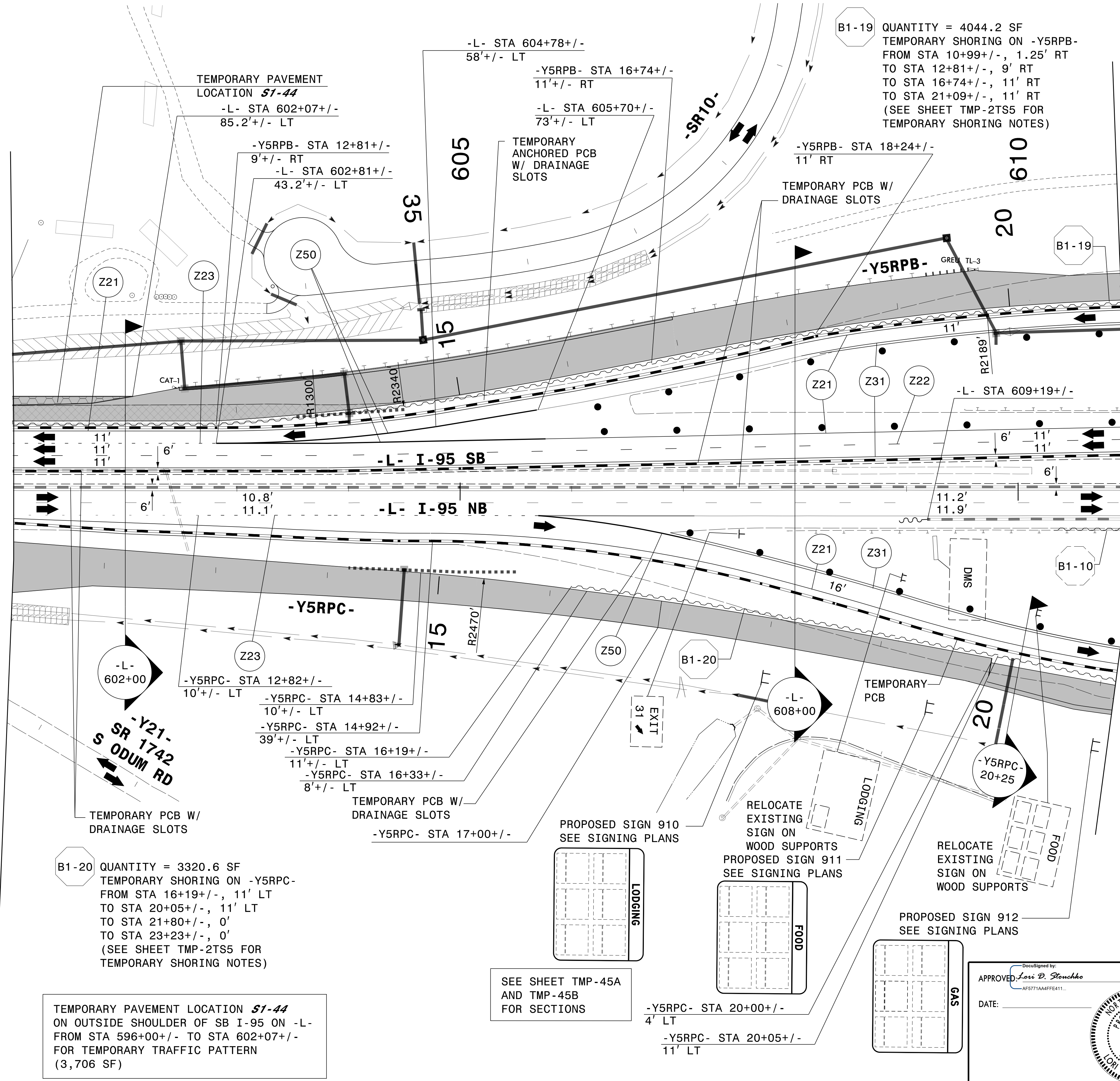

B1-20 QUANTITY = 3320.6 SF
 TEMPORARY SHORING ON -Y5RPC-
 FROM STA 16+19+/-, 11' LT
 TO STA 20+05+/-, 11' LT
 TO STA 21+80+/-, 0'
 TO STA 23+23+/-, 0'
 (SEE SHEET TMP-2TS5 FOR
 TEMPORARY SHORING NOTES)

TEMPORARY PAVEMENT LOCATION **S1-44**
 ON OUTSIDE SHOULDER OF SB I-95 ON -L-
 FROM STA 596+00+/- TO STA 602+07+/-
 FOR TEMPORARY TRAFFIC PATTERN
 (3,706 SF)

SEE SHEET TMP-45A
 AND TMP-45B
 FOR SECTIONS

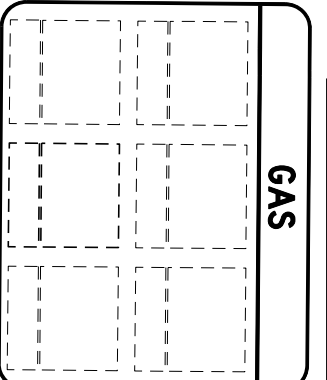
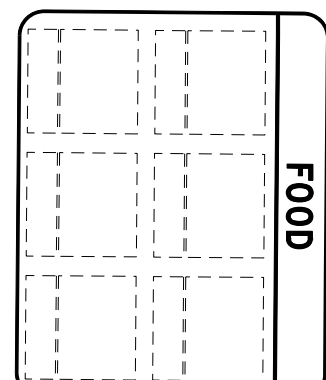
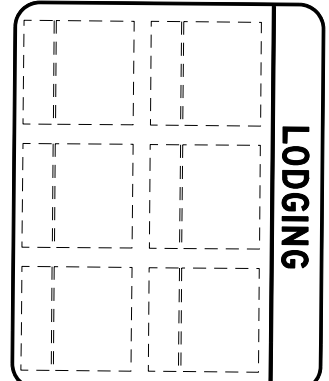

DocuSigned by:
APPROVED *Lois D. Stouchko*
 AF571AAAF411

DATE: _____

**DOCUMENT NOT CONSIDERED FINAL
 UNLESS ALL SIGNATURES COMPLETED**

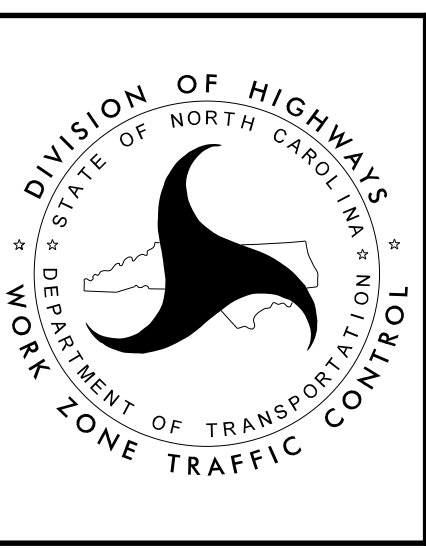

SECTION 1

**TEMPORARY TRAFFIC CONTROL
 PHASE II**

3/28/2022
 G:\50100191\NV5_1-5987B\TrafficControl\Top\200_255_1-5987B-TMP-45_Phase II.dgn
 User:ST086227