

NOTE: THE WORK SHOWN IN I-5987B PHASE I AND PHASE II ARE TO BE COORDINATED WITH WORK SHOWN IN I-5987A PHASE I

TEMPORARY PAVEMENT LOCATION **S1-40**  
 ON OUTSIDE SHOULDER OF NB I-95 ON -L- FROM STA 495+00+/- TO STA 561+00+/- FOR TEMPORARY TRAFFIC PATTERN (112,310 SF)

TEMPORARY PAVEMENT LOCATION **S1-42**  
 ON OUTSIDE SHOULDER OF SB I-95 ON -L- FROM STA 495+00+/- TO STA 518+00+/- FOR TEMPORARY TRAFFIC PATTERN (32,957 SF)

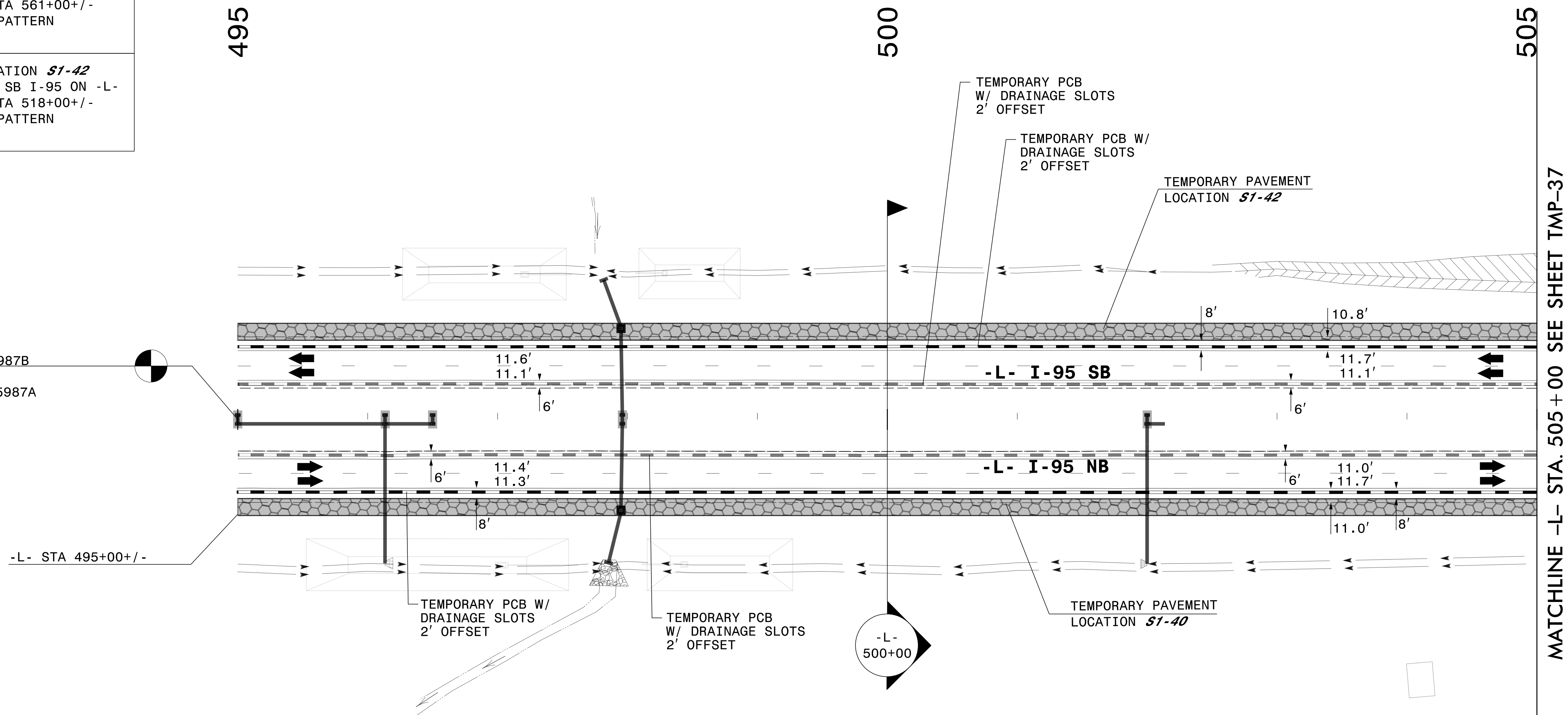

BEGIN TIP PROJECT I-5987B  
 -L- STA 495+00.00  
 TIE TO TIP PROJECT I-5987A  
 -L- STA 495+00.00

-L- STA 495+00+/-

-L- 500+00

MATCHLINE -L- STA. 505+00 SEE SHEET TMP-37

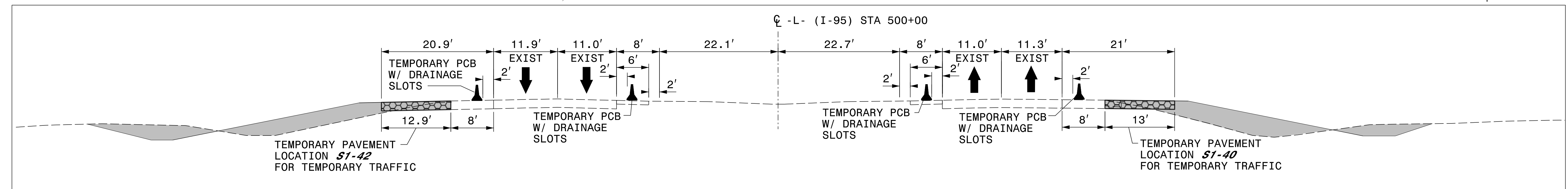

3/28/2022 G:\50100191\NV5\_I-5987B\TrafficControl\Twp\200\_22\I-5987B\_TMP-36\_Phase II\_4.dgn User:ST086227

APPROVED: *Lois D. Stouckio*  
 DATE: \_\_\_\_\_

DocuSigned by:  
 Lois D. Stouckio  
 AF571AAAF411

PROFESSIONAL SEAL  
 034437  
 ENGINEER  
 LOIS D. STOUCKIO

DOCUMENT NOT CONSIDERED FINAL  
 UNLESS ALL SIGNATURES COMPLETED

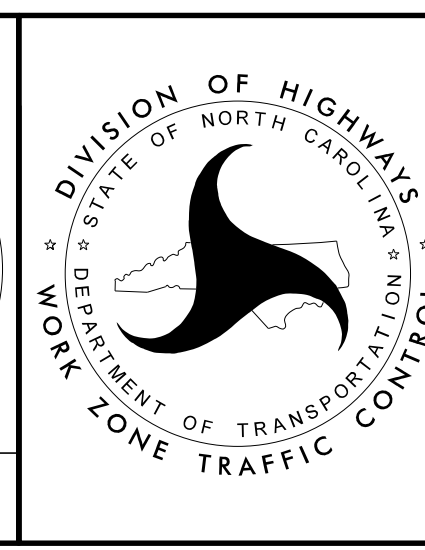

SECTION 1

TEMPORARY TRAFFIC CONTROL  
 PHASE II