

PLANS PREPARED FOR THE NCDOT BY:

M MOTT MACDONALD I & E, LLC
 1101 HAYNES STREET, SUITE 101
 RALEIGH, NC 27604
M MOTT MACDONALD NC LICENSE NO. F-0669

TEMPORARY PAVEMENT LOCATION **S1-30**
 ON INSIDE SHOULDER OF NB I-95 ON -L-
 FROM STA 552+38+/- TO STA 553+68+/-
 FOR TEMPORARY TRAFFIC PATTERN
 (875 SF)

TEMPORARY PAVEMENT LOCATION **S1-32**
 INSIDE SHOULDER OF SB I-95 ON -L-
 FROM STA 512+27+/- TO STA 581+10+/-
 FOR TEMPORARY TRAFFIC PATTERN
 (65,415 SF)

TEMPORARY PAVEMENT LOCATION **S1-33**
 ON INSIDE SHOULDER OF NB I-95 ON -L-
 FROM STA 553+68+/- TO STA 574+50+/-
 FOR TEMPORARY TRAFFIC PATTERN
 (23,771 SF)

* PARTIALLY CONSTRUCT DRAINAGE STRUCTURE
 TO AN ELEVATION BELOW THE TEMPORARY
 PAVEMENT FILL/COVER WITH STEEL PLATE AND
 PAVE OVER AS NEEDED FOR TEMPORARY PATTERN
 (SEE SHEET TMP-41)

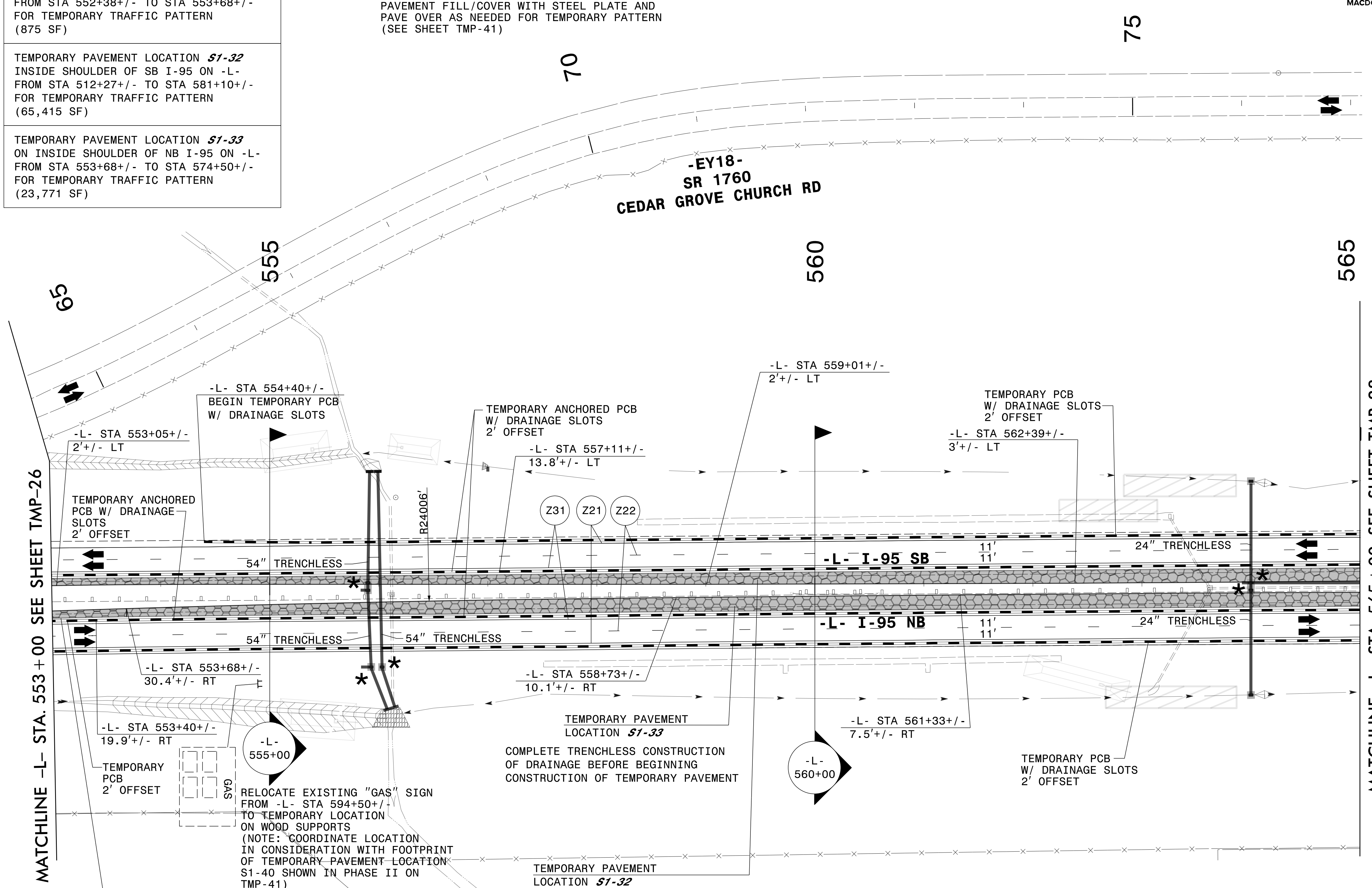

MATCHLINE -L- STA. 553+00 SEE SHEET TMP-26

MATCHLINE -L- STA. 565+00 SEE SHEET TMP-28

TEMPORARY PAVEMENT LOCATION **S1-30**
 COMPLETE TRENCHLESS CONSTRUCTION
 OF DRAINAGE BEFORE BEGINNING
 CONSTRUCTION OF TEMPORARY PAVEMENT

TEMPORARY PAVEMENT LOCATION **S1-32**
 COMPLETE TRENCHLESS CONSTRUCTION
 OF DRAINAGE BEFORE BEGINNING
 CONSTRUCTION OF TEMPORARY PAVEMENT

SEE SHEET TMP-27A
 FOR SECTIONS

DocuSigned by:
 APPROVED: *Levi D. Stouckho*
 AF571AAAF6411

DATE: _____

SEAL
 034437
 ENGINEER
 LEVI D. STOUCKHO

DOCUMENT NOT CONSIDERED FINAL
 UNLESS ALL SIGNATURES COMPLETED

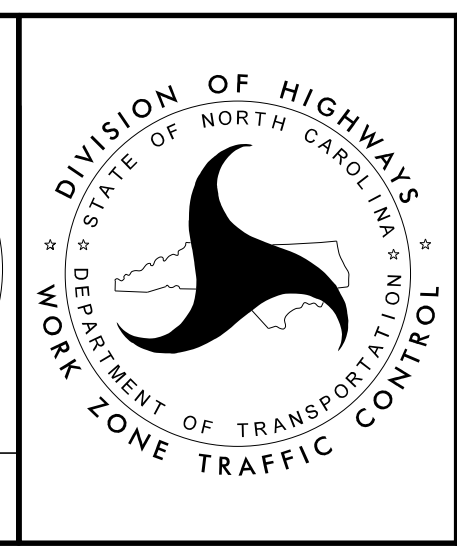

SECTION 1

TEMPORARY TRAFFIC CONTROL
 PHASE I, STEP 3

3/28/2022
 G:\50100191\NV5_1-5987B\TrafficControl\Twp\200_18LI-5987B_TMP-27_Phase 1_Step 3_9.dgn
 User:ST086227