

TEMPORARY PAVEMENT LOCATION 51-3 ON OUTSIDE SHOULDER ON SB I-95 ON -L- FROM STA 538+47+/- TO STA 585+42+/- FOR TEMPORARY TRAFFIC PATTERN (36,899 SF)	TEMPORARY PAVEMENT LOCATION 51-6 ON OUTSIDE SHOULDER OF NB I-95 ON -L- FROM STA 548+49+/- TO STA 578+02+/- FOR TEMPORARY TRAFFIC PATTERN (23,603 SF)	TEMPORARY PAVEMENT LOCATION 51-9 ON INSIDE SHOULDER OF NB I-95 ON -L- FROM STA 574+50+/- TO STA 582+41+/- FOR TEMPORARY TRAFFIC PATTERN (6,143 SF)	TEMPORARY PAVEMENT LOCATION 51-11 OUTSIDE SHOULDER OF NB I-95 ON -L- FROM STA 584+16+/- TO STA 585+42+/- FOR THE PLACEMENT OF TEMPORARY PCB (264 SF)	TEMPORARY PAVEMENT LOCATION 51-13 ON INSIDE SHOULDER OF SB I-95 ON -L- FROM STA 588+47+/- TO STA 610+67+/- FOR TEMPORARY TRAFFIC PATTERN (19,612 SF)
TEMPORARY PAVEMENT LOCATION 51-5 ON OUTSIDE SHOULDER ON SB I-95 ON -L- FROM STA 574+80+/- TO STA 581+39+/- FOR TEMPORARY TRAFFIC PATTERN (2447 SF)	TEMPORARY PAVEMENT LOCATION 51-8 ON OUTSIDE SHOULDER OF NB I-95 ON -L- FROM STA 561+00+/- TO STA 578+02+/- FOR PLACEMENT OF TEMPORARY PCB (6,040 SF)	TEMPORARY PAVEMENT LOCATION 51-10 ON INSIDE SHOULDER OF SB I-95 ON -L- FROM STA 573+35+/- TO STA 585+42+/- FOR TEMPORARY TRAFFIC PATTERN (7,843 SF)	TEMPORARY PAVEMENT LOCATION 51-12 ON INSIDE SHOULDER SB I-95 ON -L- FROM STA 586+91+/- TO STA 614+00+/- FOR TEMPORARY TRAFFIC PATTERN (21,628 SF)	TEMPORARY PAVEMENT LOCATION 51-14 ON OUTSIDE SHOULDER SB I-95 ON -L- FROM STA 587+60+/- TO STA 595+98+/- FOR TEMPORARY TRAFFIC PATTERN (9,957 SF)

PROJ. REFERENCE NO. I-5987B SHEET NO. TMP-11
 PLANS PREPARED FOR THE NCDOT BY:
M MOTT MACDONALD I & E, LLC
 1101 HAYNES STREET, SUITE 101
 RALEIGH, NC 27604
M MOTT MACDONALD NC LICENSE NO. F-0669

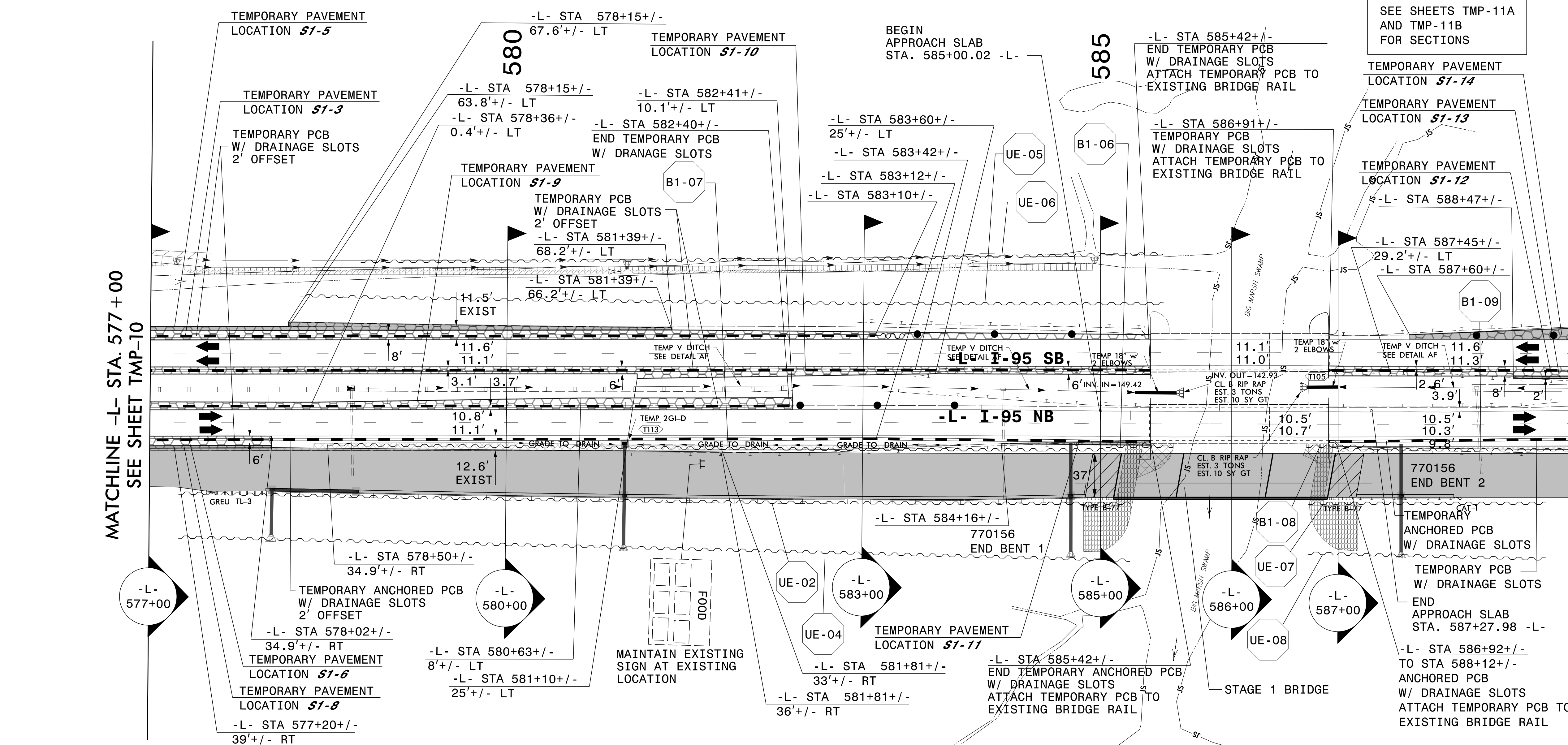

- B1-06 QUANTITY = 250.3 SF TEMPORARY SHORING ON -L- FROM STA 585+04.50+/-, 30' RT TO STA 585+61+/-, 30' RT (SEE SHEET TMP-2TS2 FOR TEMPORARY SHORING NOTES)
- B1-07 QUANTITY = 1975.8 SF TEMPORARY SHORING ON -L- FROM STA 578+50+/-, 34.9' RT TO STA 581+81+/-, 33' RT TO STA 585+17.5+/-, 33' RT (SEE SHEET TMP-2TS3 FOR TEMPORARY SHORING NOTES)
- UE-02 QUANTITY = 175 SF TEMPORARY SHORING ON -L- FROM STA 577+25+/-, 78' RT TO STA 585+25+/-, 78' RT (SEE SHEET TMP-2TS15 FOR TEMPORARY SHORING NOTES)
- UE-04 QUANTITY = 5040 SF TEMPORARY SHORING ON -L- FROM STA 577+25+/-, 115' TO 126' RT TO STA 585+25+/-, 115' TO 126' RT (SEE SHEET TMP-2TS15 FOR TEMPORARY SHORING NOTES)
- UE-07 QUANTITY = 1240 SF TEMPORARY SHORING ON -L- STA 586+75+/-, 78' RT TO STA 588+75+/-, 78' RT (SEE SHEET TMP-2TS16 FOR TEMPORARY SHORING NOTES)
- UE-08 QUANTITY = 1280 SF TEMPORARY SHORING ON -L- FROM STA 586+75+/-, 120' TO 125' RT TO STA 588+75+/-, 120' TO 125' RT (SEE SHEET TMP-2TS16 FOR TEMPORARY SHORING NOTES)
- B1-08 QUANTITY = 188.2 SF TEMPORARY SHORING ON -L- FROM STA 586+74+/-, 30' RT TO STA 587+15+/-, 30' RT (SEE SHEET TMP-2TS3 FOR TEMPORARY SHORING NOTES)
- B1-09 QUANTITY = 2586.9 SF TEMPORARY SHORING ON -L- FROM STA 586+98+/-, 33' RT TO STA 594+50+/-, 33' RT (SEE SHEET TMP-2S3 FOR TEMPORARY SHORING NOTES)
- UE-05 QUANTITY = 6406 SF TEMPORARY SHORING ON -L- FROM STA 578+25+/-, 90' LT TO STA 585+53+/-, 90' LT (SEE SHEET TMP-2TS15 FOR TEMPORARY SHORING NOTES)
- UE-06 QUANTITY = 4000 SF TEMPORARY SHORING ON -L- FROM STA 578+75+/-, 120' TO 132' LT TO STA 585+53+/-, 120' TO 132' LT (SEE SHEET TMP-2TS15 FOR TEMPORARY SHORING NOTES)

SECTION 1

TEMPORARY TRAFFIC CONTROL PHASE I

APPROVED: *Lois D. Stouckho*
AF5711AAFF411

DATE: _____

PROFESSIONAL ENGINEER
 SEAL 034437
 LOIS D. STOUCKHO

DIVISION OF HIGHWAYS
 NORTH CAROLINA
 DEPARTMENT OF TRANSPORTATION
 WORK ZONE TRAFFIC CONTROL

DOCUMENT NOT CONSIDERED FINAL UNLESS ALL SIGNATURES COMPLETED

4/8/2022 G:\50100191\NV5_1-5987B\TrafficControl\Top\200_12LI-5987B_TMP-11_Phase I.dgn User:ST086227