



TEMPORARY PAVEMENT LOCATION **S1-1**  
 ON INSIDE SHOULDER OF SB I-95 ON -L-  
 FROM STA 495+00+/- TO STA 510+31+/-  
 FOR THE PLACEMENT OF TEMPORARY PCB  
 (9,178 SF)

TEMPORARY PAVEMENT LOCATION **S1-39**  
 ON OUTSIDE SHOULDER OF NB I-95 ON -L-  
 FROM STA 495+00+/- TO STA 548+49+/-  
 FOR TEMPORARY TRAFFIC PATTERN  
 (42,728 SF)

TEMPORARY PAVEMENT LOCATION **S1-41**  
 ON OUTSIDE SHOULDER OF SB I-95 ON -L-  
 FROM STA 495+00+/- TO STA 515+21+/-  
 FOR TEMPORARY TRAFFIC PATTERN  
 (16,117 SF)

495

500

505

BEGIN TIP PROJECT I-5987B  
 -L- STA 495+00.00  
 TIE TO TIP PROJECT I-5987A  
 -L- STA 495+00.00

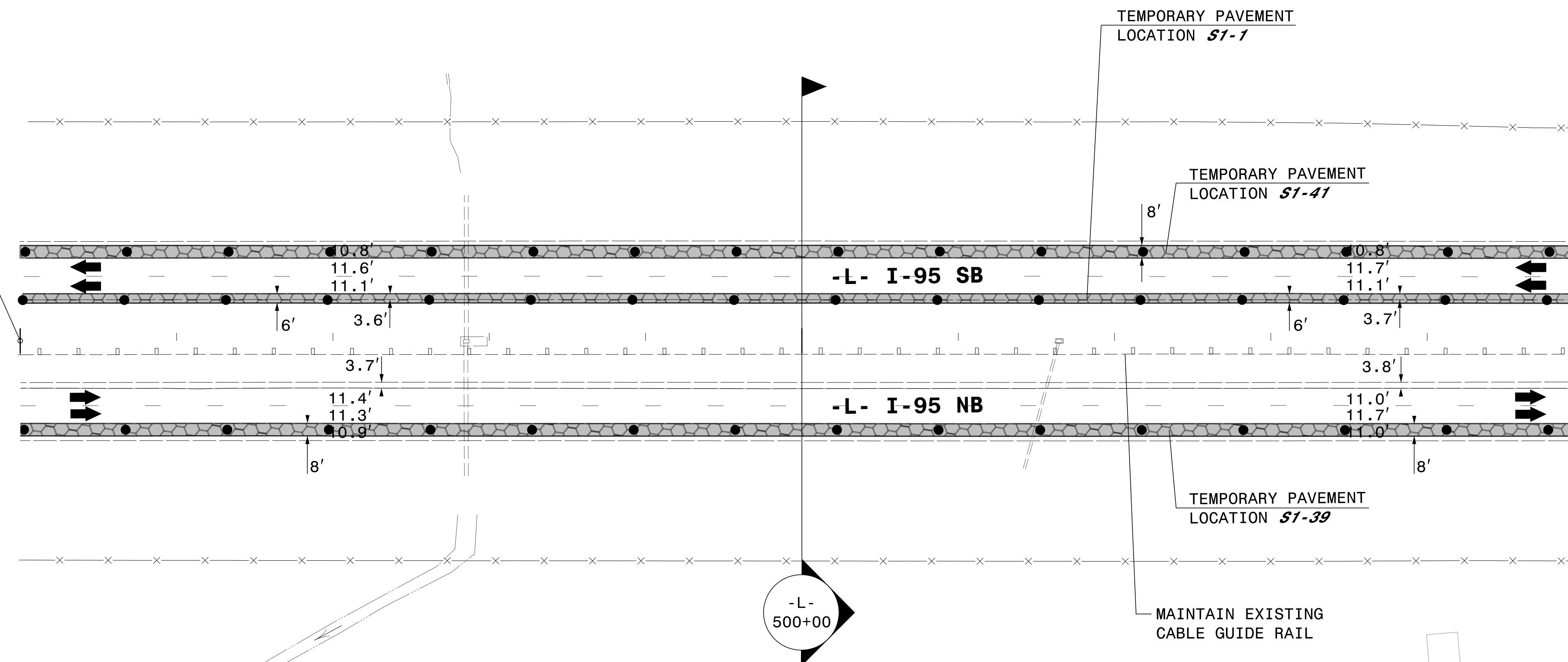

MATCHLINE -L- STA. 505 + 00 SEE SHEET TMP-5

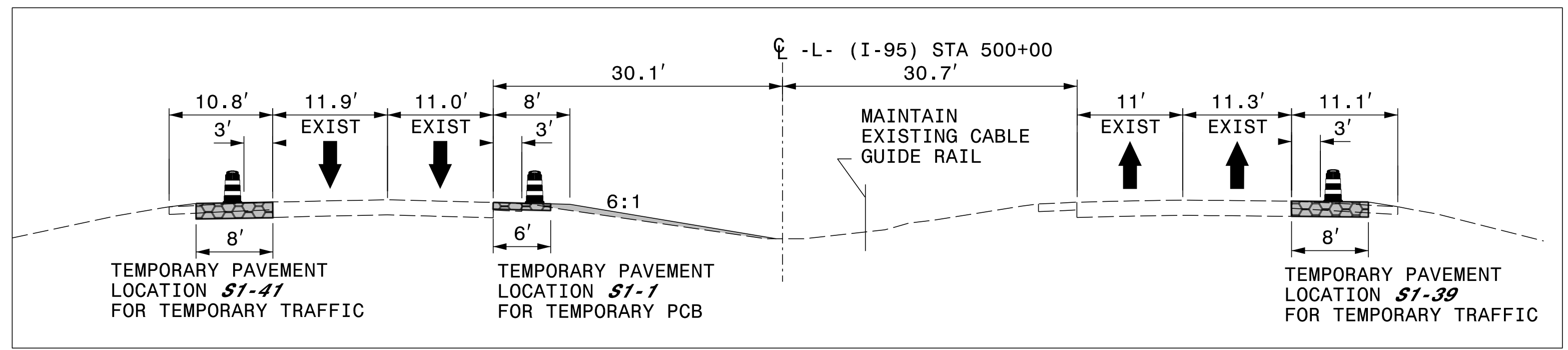

3/28/2022  
 G:\50100191\NV5\_1-5987B\TrafficControl\Tpc\200\_095\_1-5987B-TMP-4\_Phase 1.dgn  
 User:ST086227

APPROVED: *Lori D. Stouchko*  
AF5711AAFF411

DATE: \_\_\_\_\_

**DOCUMENT NOT CONSIDERED FINAL  
 UNLESS ALL SIGNATURES COMPLETED**

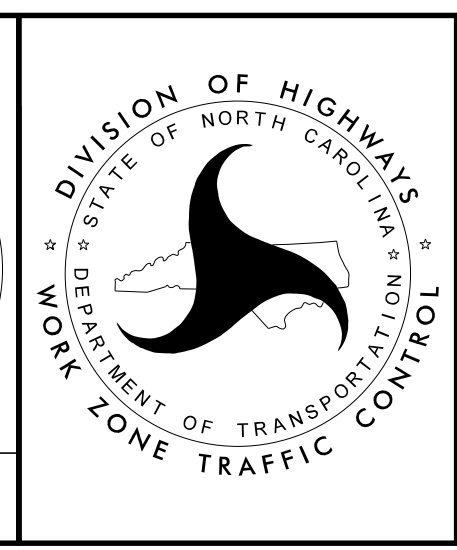

SECTION 1

TEMPORARY TRAFFIC CONTROL  
 PHASE I