

5/14/98
5/5/2002
R:\10000000\15987B\rdm\psh_38.dgn

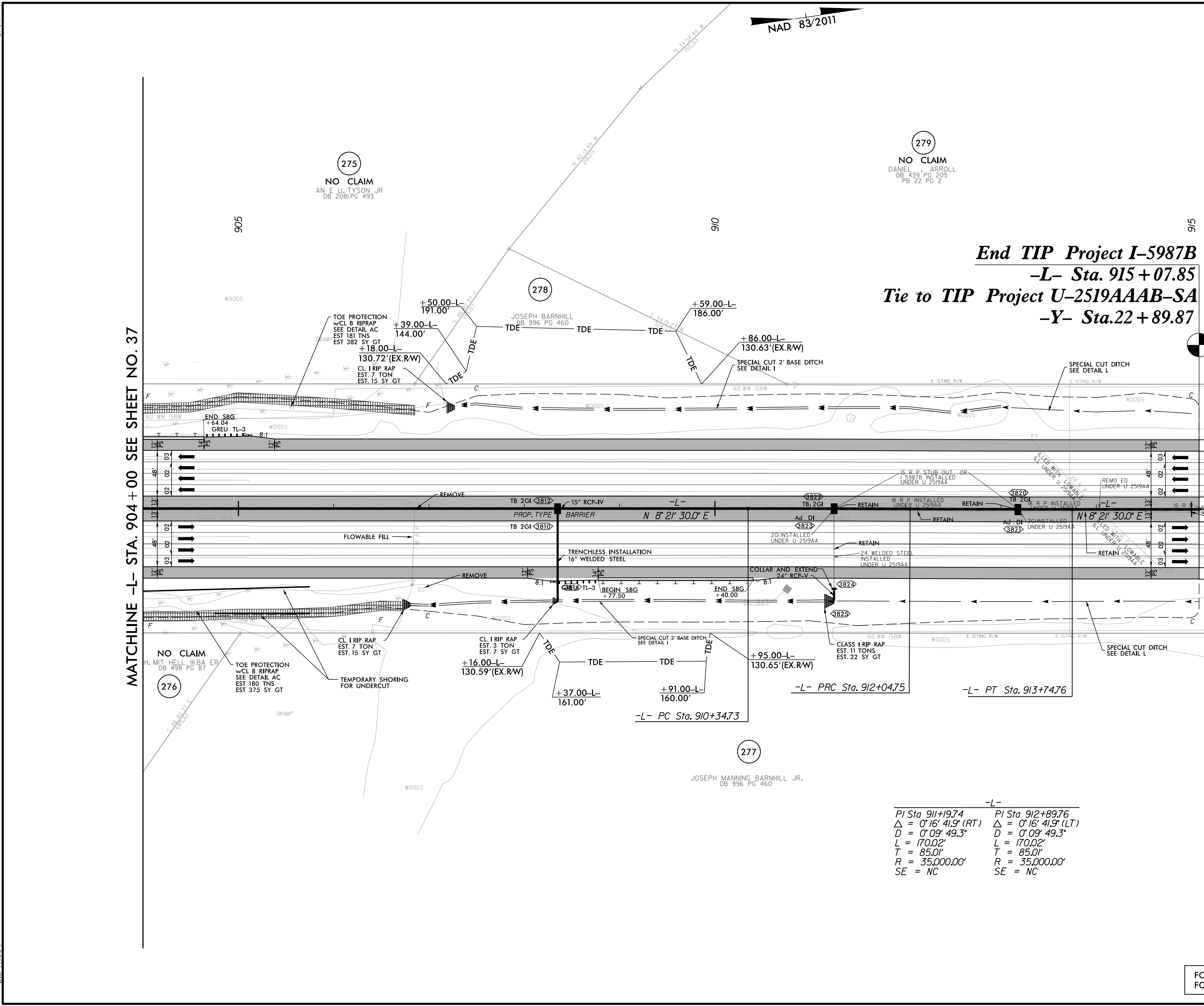

PROJECT REFERENCE NO. I-5987B	SHEET NO. 38
ROADWAY DESIGN ENGINEER MOTT MACDONALD I & E, LLC DANIEL ARROLL DB 439 PG 205 PB 22 PG 2	HYDRAULICS ENGINEER WETHERILL ENGINEERING, LLC LICENSE NO. P-6377
DOCUMENT NOT CONSIDERED FINAL UNLESS ALL SIGNATURES COMPLETED	
Prepared in the Office of: MOTT MACDONALD	PO Box 700 Fayetteville, NC 27326 www.mottmac.com
1223 West Fourth St. Fayetteville, NC 27326 Phone: 781-467-7777 Fax: 781-467-8157	

End TIP Project I-5987B
-L- Sta. 915+07.85
Tie to TIP Project U-2519AAAB-SA
-Y- Sta. 22+89.87

FINAL LAYER OF PAVEMENT FOR ENTIRE I-95 SBL AND A PORTION OF I-95 NBL ON U-2519AAAB PROJECT WILL BE INCLUDED IN THIS CONTRACT. SEE SHEET 28-17 THRU 28-20 FOR LIMITS OF PAVING.

MATCHLINE -L- STA. 904+00 SEE SHEET NO. 37

-L-	
PI Sta 911+9.74	PI Sta 912+89.76
$\Delta = 0' 16' 41.9" (RT)$	$\Delta = 0' 16' 41.9" (LT)$
$D = 0' 09' 49.3"$	$D = 0' 09' 49.3"$
$L = 170.02'$	$L = 170.02'$
$T = 85.01'$	$T = 85.01'$
$R = 35,000.00'$	$R = 35,000.00'$
SE = NC	SE = NC

LEGEND

PROPOSED PAVED SHOULDER

FOR -L- PROFILE, SEE SHEET 83
 FOR DITCH DETAILS, SEE SHEETS 2D-1 THRU 2D-3