

5/14/2022

RA\Ford\2022\05\15987b_rdy_esh_35.dgn

NAD 83/2011

PROJECT REFERENCE NO. 1-5987B		SHEET NO. 35	
RW SHEET NO.			
ROADWAY DESIGN ENGINEER		HYDRAULICS ENGINEER	
MOTT MACDONALD I & E, LLC LICENSE NO. F-0669		WETHERILL ENGINEERING, LLC LICENSE NO. F-0377	
<p>DOCUMENT NOT CONSIDERED FINAL UNLESS ALL SIGNATURES COMPLETED</p> <p>Prepared in the Office of: M</p> <p>MOTT MACDONALD I & E, LLC Fuquay-Varina, NC 27526 www.mottmac.com/americas</p> <p>WETHERILL ENGINEERING 1223 Jones Franklin Rd. Raleigh, N.C. 27606 License No. F-0377 Bus: 919 851 8077 Fax: 919 851 8107</p>			

MATCHLINE -L- STA. 868 + 00.00 SEE SHEET NO. 34

MATCHLINE -L- STA. 880 + 00.00 SEE SHEET NO. 36

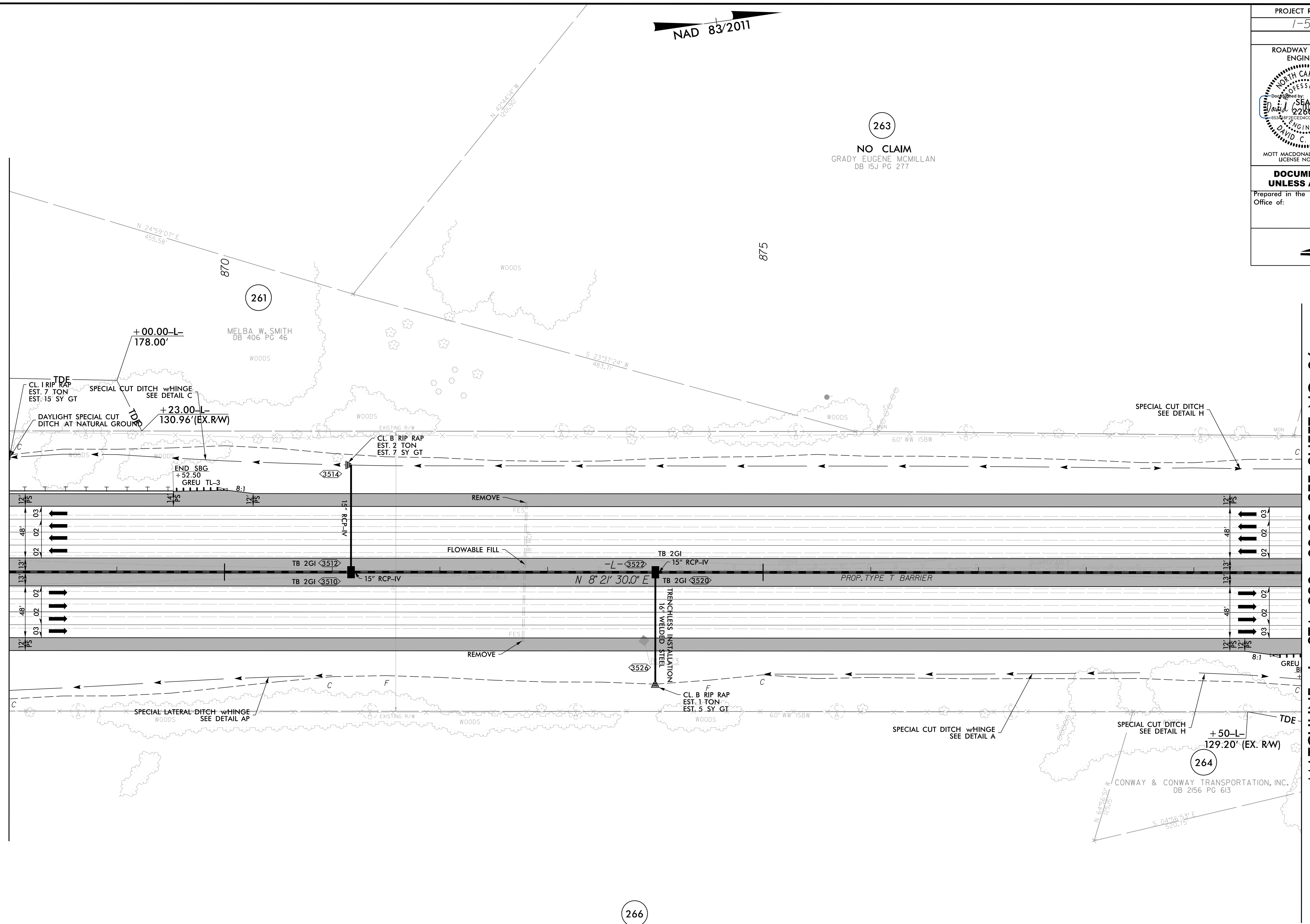

266
EDNA F. M. MARTIN
DB 12L PG 225

LEGEND

PROPOSED PAVED SHOULDER

FOR -L- PROFILE, SEE SHEET 80
FOR DITCH DETAILS, SEE SHEETS 2D-1 THRU 2D-3