

5/14/99
 4/28/2022
 R:\P\4/28/2022\5987b_rdy_psh_19.dgn
 W:\1984\1984.dgn

-L-
 Pls Sta 675+53.35 PI STA.685+01.00 Pls Sta 694+27.86
 $\theta_s = 1^{\circ} 35' 29.6''$ $\Delta = 21^{\circ} 44' 41.8''$ (RT) $\theta_s = 1^{\circ} 35' 29.6''$
 $L_s = 250.00'$ $D = 1^{\circ} 16' 23.7''$ $L_s = 250.00'$
 $LT = 166.67'$ $L = 1,707.84'$ $LT = 166.67'$
 $ST = 83.34'$ $T = 864.32'$ $ST = 83.34'$
 $R = 4,500.00'$
 $SE = 0.05$
 $RO = 250.00'$

-YIBRPB-
 Pls Sta 16+76.86 PI STA.19+36.27
 $\theta_s = 2^{\circ} 45' 16.6''$ $\Delta = 12^{\circ} 36' 36.6''$ (LT)
 $L_s = 175.00'$ $D = 3^{\circ} 08' 53.2''$
 $LT = 116.68'$ $L = 400.56'$
 $ST = 58.35'$ $T = 201.09'$
 $R = 1,820.00'$
 $SE = 0.07$

-YIBRPB- POT Sta.10+00.00=
 -L- POC Sta.689+00.00
 OFF.=61' LT.

-YIBRPC- SC Sta.12+00.00
 HOWARD W. JOHNSON JR
 DB 661 PG 713
 PB 27 PG 23

-YIBRPC-
 Pls Sta 11+33.35 PI STA.14+41.99 Pls Sta 17+48.73
 $\theta_s = 2^{\circ} 35' 33.2''$ $\Delta = 12^{\circ} 29' 51.2''$ (RT) $\theta_s = 2^{\circ} 35' 33.2''$
 $L_s = 200.00'$ $D = 2^{\circ} 35' 33.2''$ $L_s = 200.00'$
 $LT = 133.35'$ $L = 482.05'$ $LT = 133.35'$
 $ST = 66.68'$ $T = 241.99'$ $ST = 66.68'$
 $R = 2,210.00'$
 $SE = 0.08$

-YIBRPC- ST Sta.18+82.05
 HOWARD W. JOHNSON JR
 DB 1702 PG 526

| | |
|--|---------------------------------------|
| PROJECT REFERENCE NO. 1-5987B | SHEET NO. 19 |
| ROADWAY DESIGN ENGINEER SEAL 12/11/16 | HYDRAULICS ENGINEER SEAL 3/9/77 |
| DOCUMENT NOT CONSIDERED FINAL UNLESS ALL SIGNATURES COMPLETED | |
| | |
| TRANSPORTATION PLANNING/DESIGN - BRIDGE/STRUCTURE DESIGN CIVIL/SITE DESIGN - GIS/GPS - CONSTRUCTION OBSERVATION | |

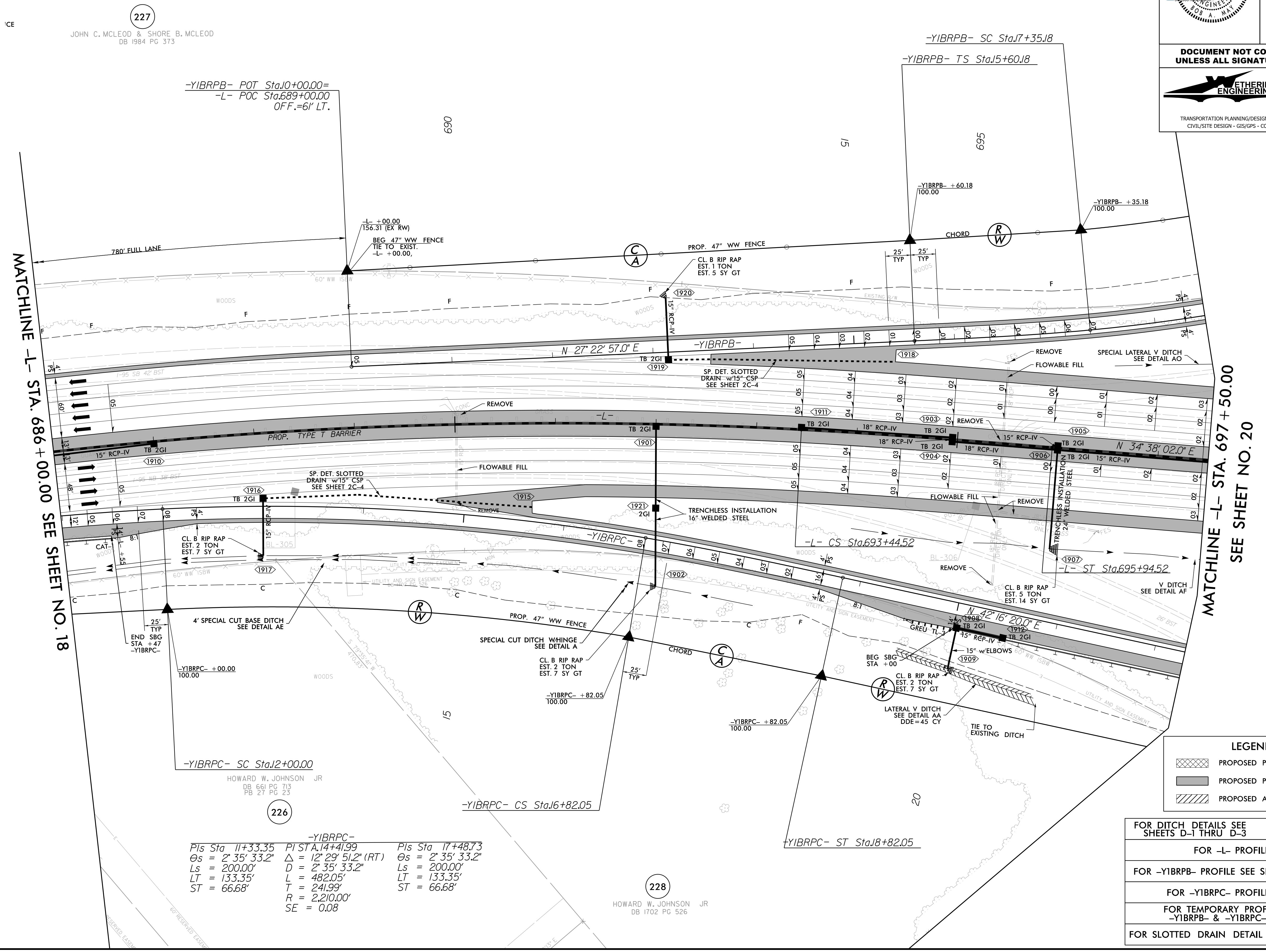

LEGEND

- PROPOSED PAVEMENT REMOVAL
- PROPOSED PAVED SHOULDER
- PROPOSED APPROACH SLAB

- FOR DITCH DETAILS SEE SHEETS D-1 THRU D-3
- FOR -L- PROFILE SEE SHEET 64
- FOR -YIBRPB- PROFILE SEE SHEETS 92 & 93
- FOR -YIBRPC- PROFILE SEE SHEET 93
- FOR TEMPORARY PROFILE FOR RAMPS -YIBRPB- & -YIBRPC- SEE SHEET 105
- FOR SLOTTED DRAIN DETAIL SEE SHEET 2C-?

MATCHLINE -L- STA. 686 + 00.00 SEE SHEET NO. 18

MATCHLINE -L- STA. 697 + 50.00
 SEE SHEET NO. 20

