

5/14/99
1/21/2022
R:\P\04\15987b_rdy_psh_14.dgn

PROJECT REFERENCE NO. 1-5987B	SHEET NO. 14
RW SHEET NO.	
ROADWAY DESIGN ENGINEER DAVID C. WALKER NORTH CAROLINA PROFESSIONAL ENGINEER LICENSE NO. 22608	HYDRAULICS ENGINEER DAVID C. WALKER NORTH CAROLINA PROFESSIONAL ENGINEER LICENSE NO. 22608
MOTT MACDONALD 1 & E, LLC LICENSE NO. F-0669	
<p>DOCUMENT NOT CONSIDERED FINAL UNLESS ALL SIGNATURES COMPLETED</p> <p>Prepared in the Office of: M 7621 Purfoy Rd, Suite 115 Fuquay-Varina, NC 27526 MOTT MACDONALD www.mottmac.com/americas</p>	

NAD 83/2011

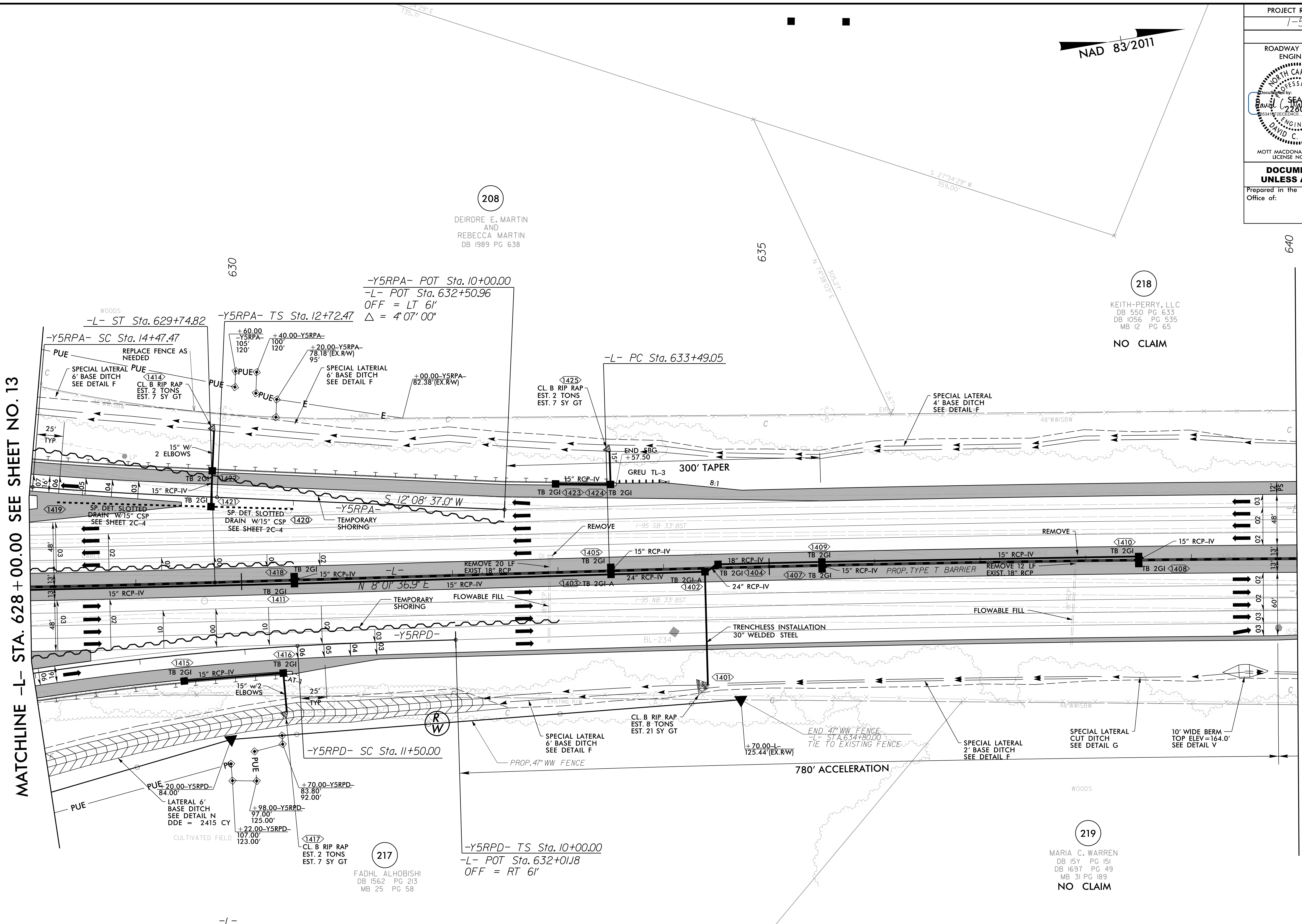

208
DEIRDRE E. MARTIN AND REBECCA MARTIN DB 1989 PG 638

218
KEITH-PERRY, LLC DB 550 PG 633 DB 1056 PG 535 MB 12 PG 65
NO CLAIM

217
FADHL ALHOBISHI DB 1562 PG 213 MB 25 PG 59

219
MARIA C. WARREN DB 159 PG 151 DB 1697 PG 49 MB 31 PG 189
NO CLAIM

MATCHLINE -L- STA. 628 + 00.00 SEE SHEET NO. 13

MATCHLINE -L- STA. 640 + 00.00 SEE SHEET NO. 15

-L-
Pls Sta 627+74.84 PI Sta 637+66.64
Os = 2° 22' 26.9" Δ = 1° 40' 44.1" (RT)
Ls = 300.00' D = 0° 12' 03.7"
LT = 200.02' L = 835.12'
ST = 100.02' T = 417.59'
R = 28,500.00'

-Y5RPA-
Pls Sta 13+89.15 PI Sta 15+26.94
Os = 2° 17' 59.0" Δ = 4° 10' 31.6" (RT)
Ls = 175.00' D = 2° 37' 41.7"
LT = 116.68' L = 158.87'
ST = 58.34' T = 79.47'
R = 2,180.00'

-Y5RPD-
Pls Sta 11+00.00 PI Sta 12+81.31
Os = 1° 35' 08.4" Δ = 5° 32' 52.3" (LT)
Ls = 150.00' D = 2° 06' 51.2"
LT = 100.00' L = 262.41'
ST = 50.00' T = 131.31'
R = 2,710.00'

LEGEND

PROPOSED PAVED SHOULDER

FOR -L- PROFILE, SEE SHEET 59
FOR -Y5RPA- PROFILE, SEE SHEET 86
FOR -Y5RPD- PROFILE, SEE SHEET 89
FOR DITCH DETAILS, SEE SHEETS 2D-1 THRU 2D-3
FOR SLOTTED DRAIN DETAIL SEE SHEET 2C-4