

SURVEY CONTROL SHEET B-4593

W/EXISTING CENTERLINE ALIGNMENTS PRIOR TO CONSTRUCTION

EXISTING ALIGNMENTS

EL POINT	N	E	BEARING	DIST	DELTA	D	L	T	R
POT	501839.346	2680634.769							
LINE			S 45°02'49.0" E	200.35					
PC	501697.793	2680776.554							
CURVE			S 52°58'31.4" E	435.05	15°51'24.7"(LT)	03°37'59.6"	436.44	219.62	1577.00
PT	501435.824	2681123.888							
LINE			S 60°54'13.7" E	727.08					
PC	501082.263	2681759.211							
CURVE			S 62°17'59.0" E	383.01	02°47'30.5"(LT)	00°43'43.8"	383.05	191.56	7861.33
PT	500904.221	2682098.328							
LINE			S 63°41'44.2" E	658.50					
PC	500612.414	2682688.639							
CURVE			S 56°24'35.9" E	382.30	14°34'16.6"(RT)	03°48'04.3"	383.33	192.71	1507.31
PT	500400.907	2683007.103							
LINE			S 49°07'27.6" E	494.07					
POT	500077.581	2683380.682							



EY POINT	N	E	BEARING	DIST
POT	500780.432	2683181.734		
LINE			S 34°22'32.3" W	405.50
POT	500445.747	2682952.779		

EY1 POINT	N	E	BEARING	DIST
POT	500329.698	2683089.380		
LINE			S 22°58'08.1" E	429.94
POT	499933.846	2683257.156		

BENCHMARKS

.....
 BM1 ELEVATION - 5.85
 N 500252 E 2682858
 RR SPIKE SET IN 20" HARDWOOD

BASELINE

BL POINT	DESC.	NORTH	EAST	ELEVATION
COON1	NCGS COON 1984	501389.8380	2681113.8660	6.52
1	BL-1	501097.7390	2681774.6430	3.76
SWAMP1	NCGS SWAMP 1984	500731.2200	2682491.0900	9.54
2	BL-2	500509.1510	2682946.1260	4.85
3	BL-3	500099.7730	2683380.0520	4.52

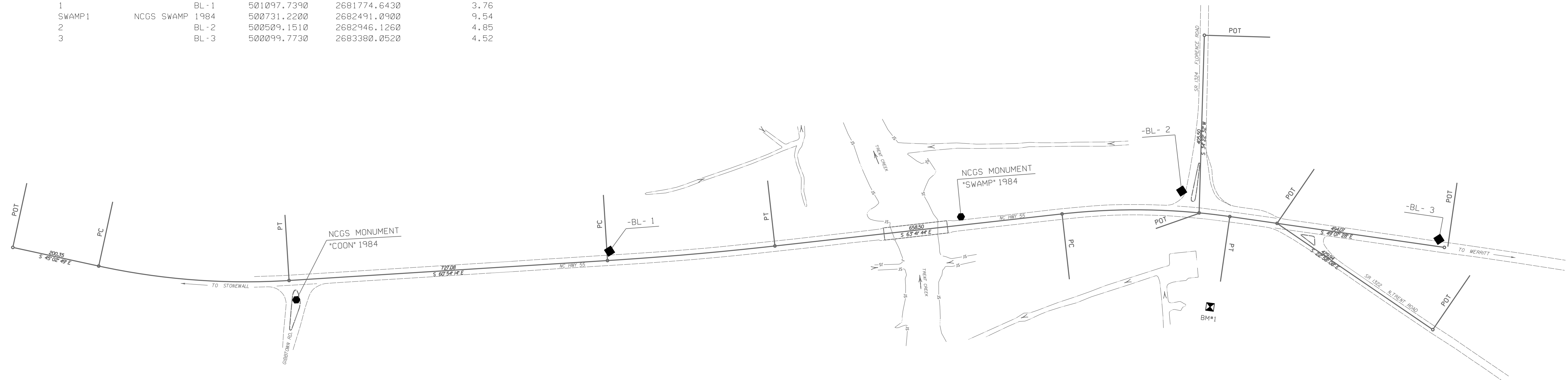

DATUM DESCRIPTION

THE LOCALIZED COORDINATE SYSTEM DEVELOPED FOR THIS PROJECT IS BASED ON THE STATE PLANE COORDINATES ESTABLISHED BY NCGS FOR MONUMENT "SWAMP 1984"
 WITH NAD 83/NA 2011 STATE PLANE GRID COORDINATES OF
 NORTHING: 500731.2200(±) EASTING: 2682491.0900(±)
 ELEVATION: 9.54(±)
 THE AVERAGE COMBINED GRID FACTOR USED ON THIS PROJECT
 (GROUND TO GRID) IS: 0.99988128
 THE N.C. LAMBERT GRID BEARING AND
 LOCALIZED HORIZONTAL GROUND DISTANCE FROM
 "SWAMP 1984" TO -L- STATION IS
 ALL LINEAR DIMENSIONS ARE LOCALIZED HORIZONTAL DISTANCES
 VERTICAL DATUM USED IS NAVD 88

NOTES:

- IF FURTHER INFORMATION REGARDING PROJECT CONTROL IS NEEDED, PLEASE CONTACT THE LOCATION AND SURVEYS UNIT.
- PROJECT CONTROL WAS ESTABLISHED USING GNSS, THE GLOBAL NAVIGATION SATELLITE SYSTEM.