

STATE	STATE PROJECT REFERENCE NO.	SHEET NO.	TOTAL SHEETS
N.C.	U-6223	RW01	11

STATE OF NORTH CAROLINA
DIVISION OF HIGHWAYS

SURVEY CONTROL, EXISTING CENTERLINES,
RIGHT OF WAY, EASEMENTS AND PROPERTY TIES

JOHNSTON COUNTY

TIP PROJECT: U-6223

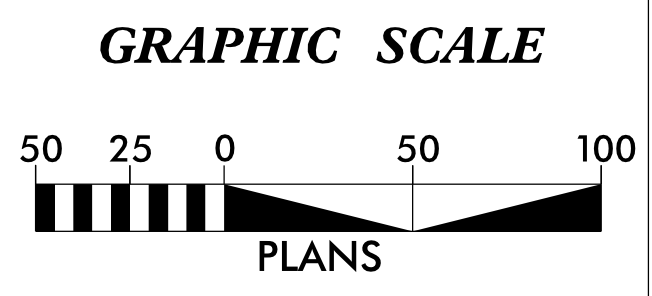
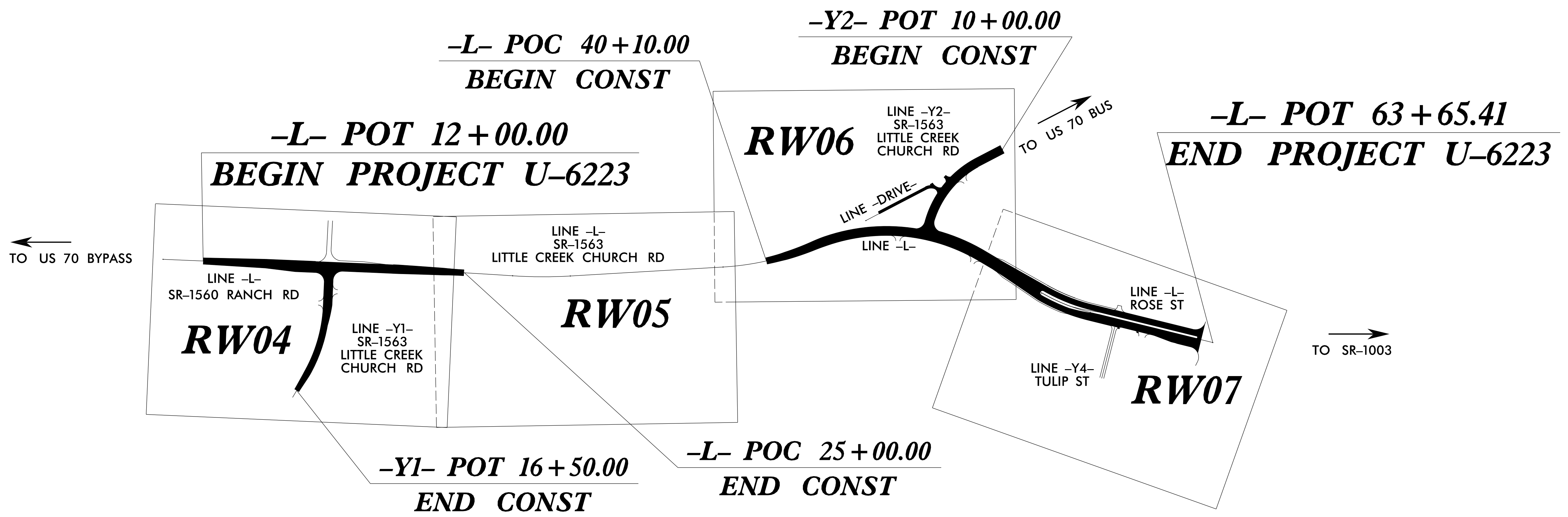
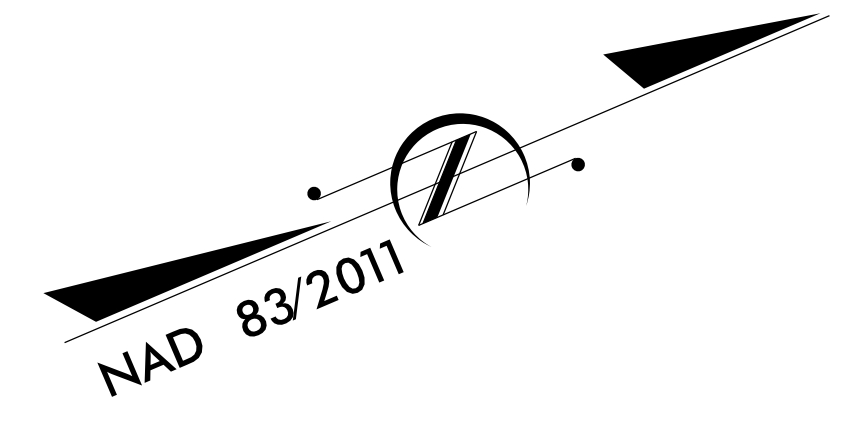

DATUM DESCRIPTION

THE LOCALIZED COORDINATE SYSTEM DEVELOPED FOR THIS PROJECT IS BASED ON THE STATE PLANE COORDINATES ESTABLISHED BY NCDOT FOR PHOTOGRAMMETRY PANEL "P-12" WITH NAD 83/NSRS 2011 STATE PLANE GRID COORDINATES OF NORTHING: 982,858.240(ft) EASTING: 2,163,046.164(ft) ELEVATION: 300.645(ft)

THE AVERAGE COMBINED GRID FACTOR USED ON THIS PROJECT (GROUND TO GRID) IS: 0.9998846823

THE N.C. LAMBERT GRID BEARING AND LOCALIZED HORIZONTAL GROUND DISTANCE FROM "P-12" TO -L- STATION 10+00.00 IS S 27-38°16.5' E 514.26(ft)

ALL LINEAR DIMENSIONS ARE LOCALIZED HORIZONTAL DISTANCES VERTICAL DATUM USED IS NAVD 88

Prepared in the Office of:

JoynerKeeny, PLLC
1051 N. Winstead Avenue
Rocky Mount, NC 27804
252-977-3124
North Carolina Firm Number P-0551

2018 STANDARD SPECIFICATIONS

RIGHT OF WAY DATE: 03/22/2021	LETTING DATE: 07/19/2022
---	------------------------------------

PROFESSIONAL LAND SURVEYOR

DocuSigned by:
Stephen Wolfe
202007191040446

27 July 2021

Signature: _____ Date: _____

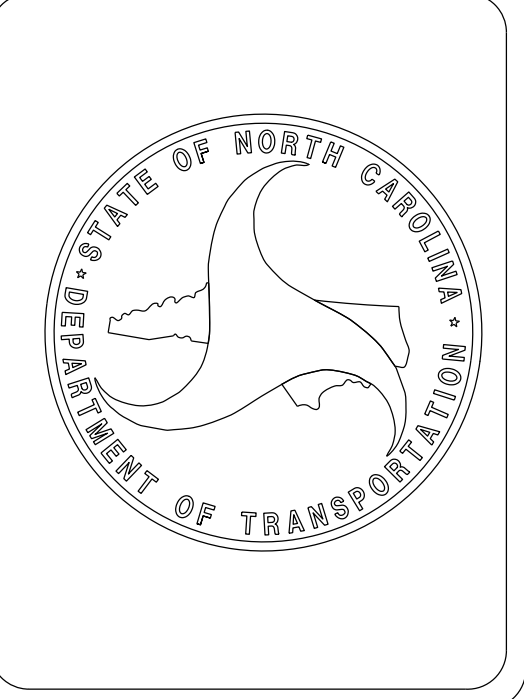

22-JUL-2021 15:59
Z:\CAD\2020\2009065C_NCDOT_U6223_ROW_Johnston\SURVEY\DELIVERABLES\TO BE SENT\GOOD FINAL FILES\U6223_Is_rw01.dgn
F:\p\thress AT JKA-021