

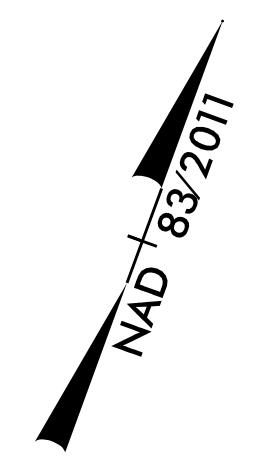

# -RW1-

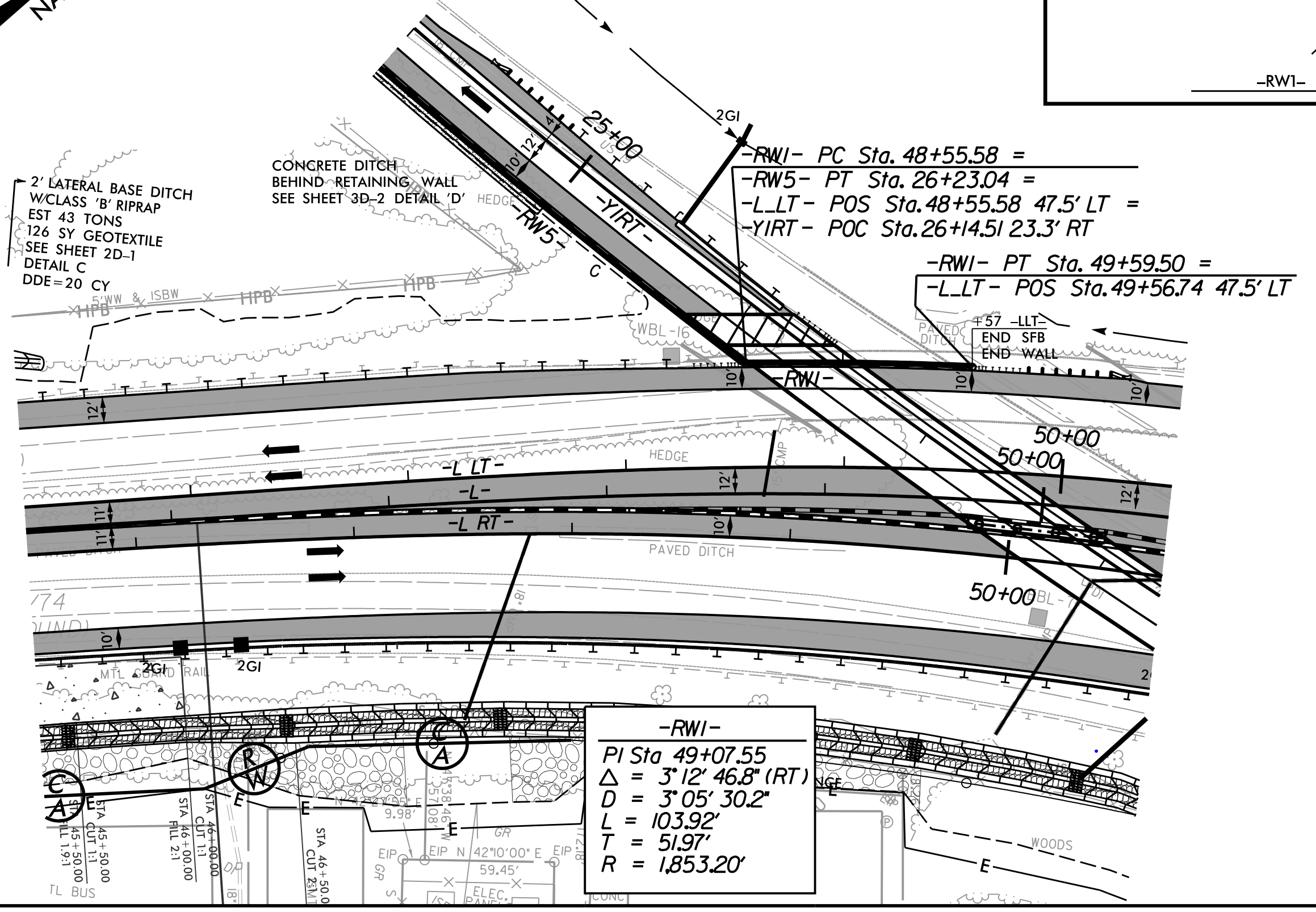
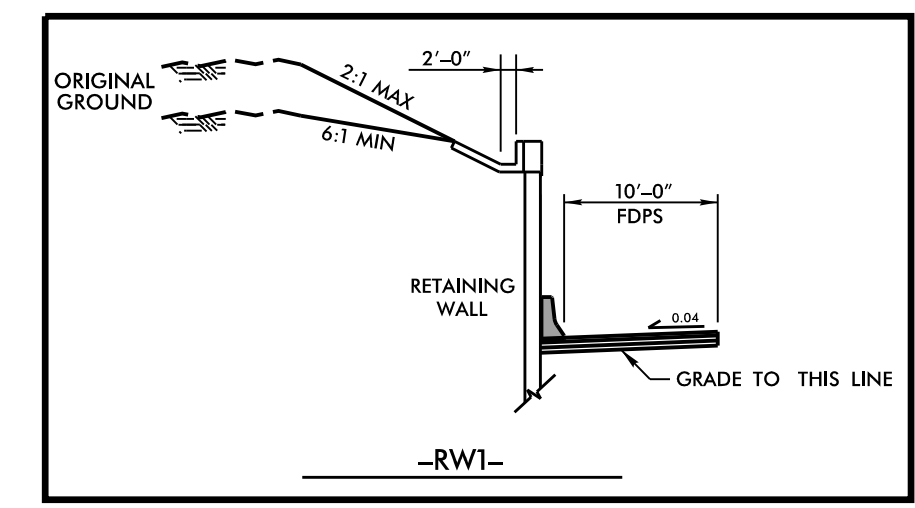

# -RW2-

**HDR** HDR Engineering, Inc. of the Carolinas  
555 Fayetteville St, Suite 900 Raleigh, N.C. 27601  
N.C.B.E.L.S. License Number: F-0116

PROJECT REFERENCE NO. <b>B-3186 / B-5898</b>	SHEET NO. <b>W-02</b>
ROADWAY DESIGN ENGINEER	HYDRAULICS ENGINEER
3/31/2022	
<b>DOCUMENT NOT CONSIDERED FINAL UNLESS ALL SIGNATURES COMPLETED</b>	

-RW2- POT Sta. 55+33.39 =  
-RW3- POT Sta. 29+39.51 =  
-Y-IRT- POC Sta. 29+39.51 15.61' RT =  
-L-RT- POC Sta. 51+68.50 66' RT  
-RW2- PI Sta. 54+62.78  
-RW2- PC Sta. 52+60.98 =  
-Y-IRT- POC Sta. 32+05.00 17.3' LT

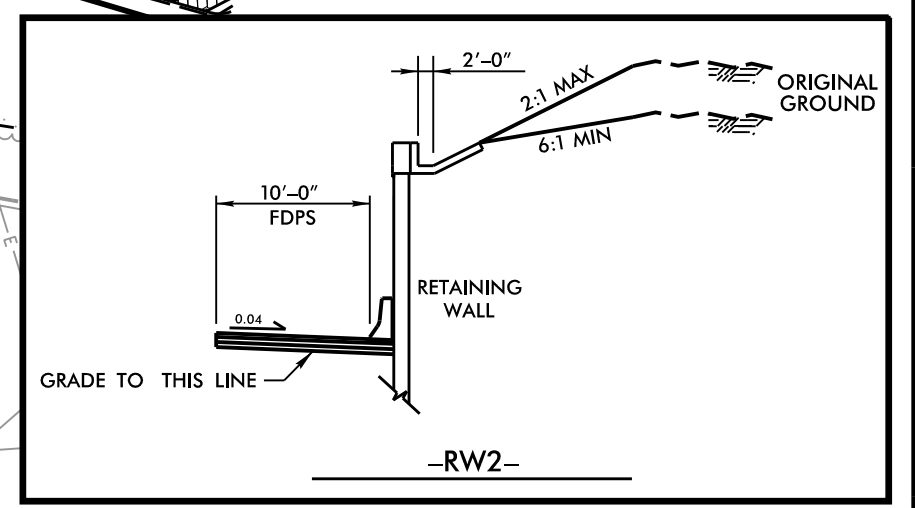
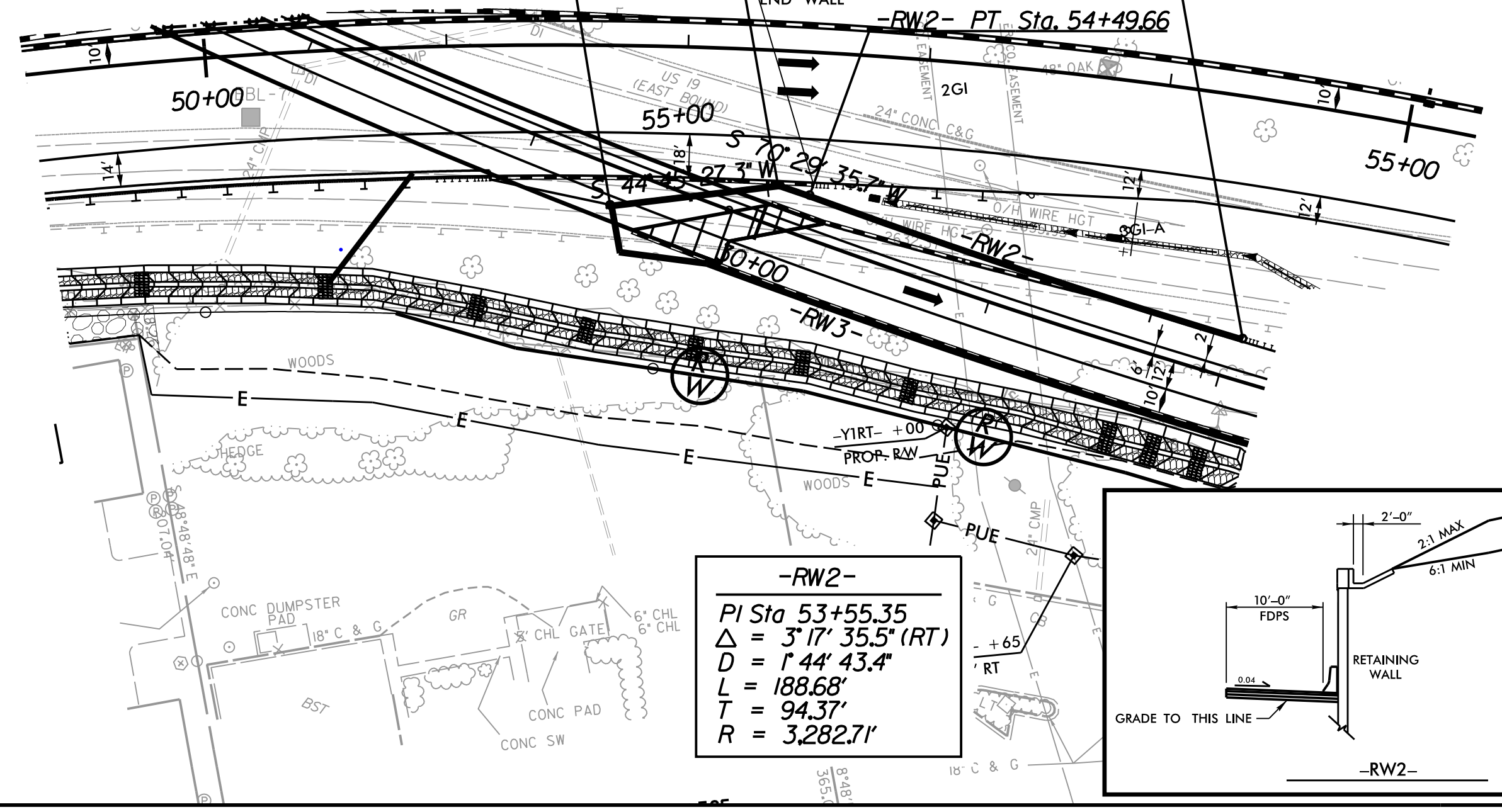

REVISIONS

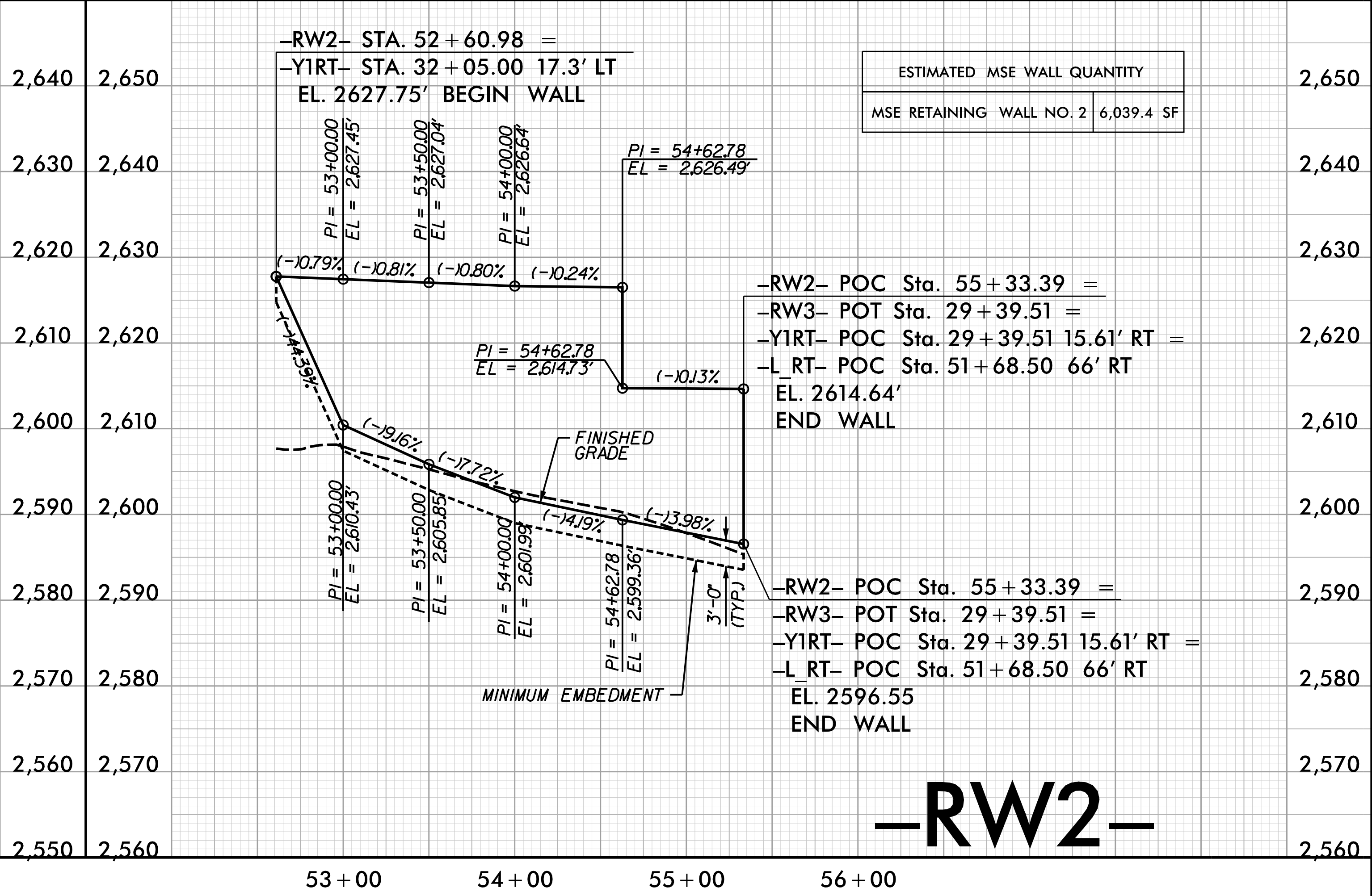
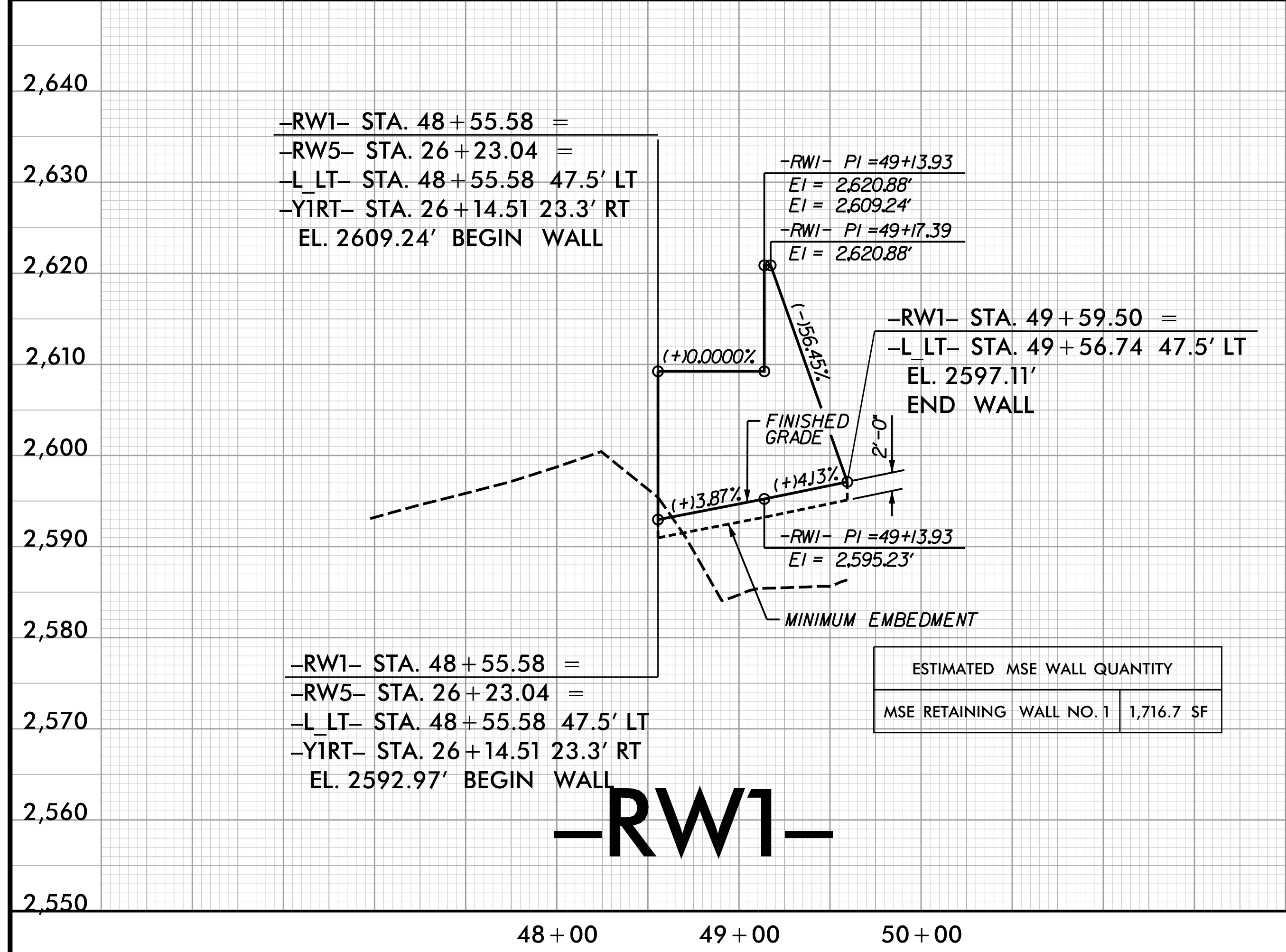

# -RW2-

PLOT DRIVER: NCDOT\_color\_eng\_50.plt  
USER: PETERSON  
DATE: 3/31/2022  
TIME: 12:13:10 PM  
FILE: \