

NOTES

FOR STRUCTURAL STEEL NOTES AND DETAILS, SEE "SUPERSTRUCTURE STRUCTURAL STEEL DETAILS" SHEETS.

FOR ELASTOMERIC BEARING AND SOLE PLATE DETAILS, SEE "SUPERSTRUCTURE ELASTOMERIC BEARING DETAILS" SHEET.

PROPOSED BEARING TO BEARING LENGTH FOR SPAN A IS 3" LESS THAN EXISTING BEARING TO BEARING LENGTH. THE PROPOSED CENTERLINE OF BEARING AT END BENT 1 IS SET TOWARDS THE SPAN BY 3" ALONG THE CENTERLINE OF BEAM.

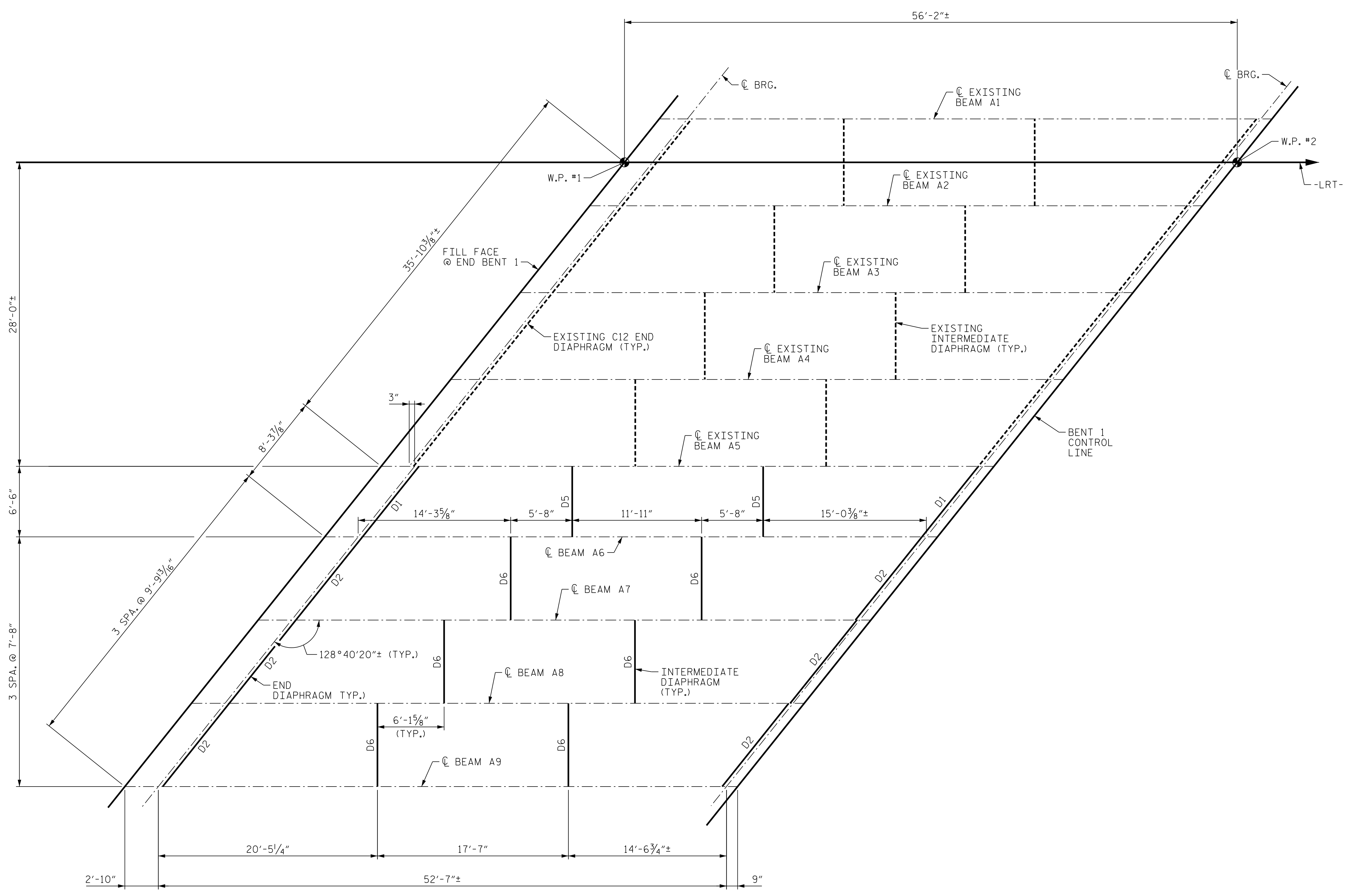

FRAMING PLAN SPAN A

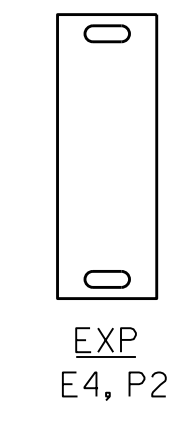
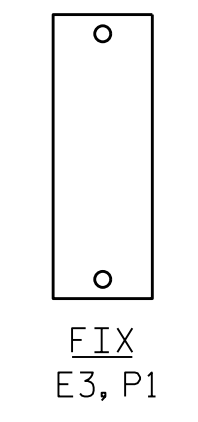

PROJECT NO. B-3186/B-5898
HAYWOOD COUNTY
 STATION: 68+65.75± -L-RT-

SHEET 1 OF 3

STATE OF NORTH CAROLINA
 DEPARTMENT OF TRANSPORTATION
 RALEIGH

**SUPERSTRUCTURE
 FRAMING PLAN
 SPAN A**

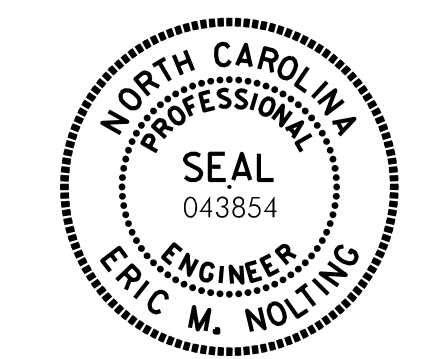

Eric Nolting 1/25/2022

PLOT DRIVER: NCDOT_STRUCTURE_DEFAULT_PLOTTER.plt PENTABLE: NCDOT_STRUCTURE_DEFAULT_PEN.tbl
 USER: PETERSON DATE: 1/24/2022 TIME: 2:37:15 PM
 FILE: ... \404.065.B58983186.SMU.FP.014.430107.dgn

DES BY: S. RAVINDRAN	DATE: 05/21	DWG BY: M. SELLS	DATE: 05/21
DES CHK: E. NOLTING	DATE: 06/21	CHK BY: E. NOLTING	DATE: 06/21

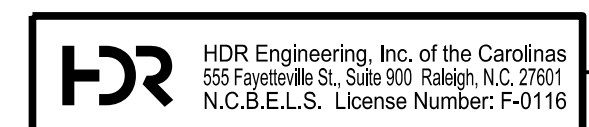

DOCUMENT NOT CONSIDERED FINAL
 UNLESS ALL SIGNATURES COMPLETED

REVISIONS					
NO.	BY:	DATE:	NO.	BY:	DATE:
1	--	--	3	--	--
2	--	--	4	--	--

SHEET NO. S03R-14
 TOTAL SHEETS 61