

**CONCRETE POURING SEQUENCE AND LAYOUT FOR COMPUTING AREA OF REINFORCED CONCRETE DECK SLAB**  
(SQ. FT. = 4,638)

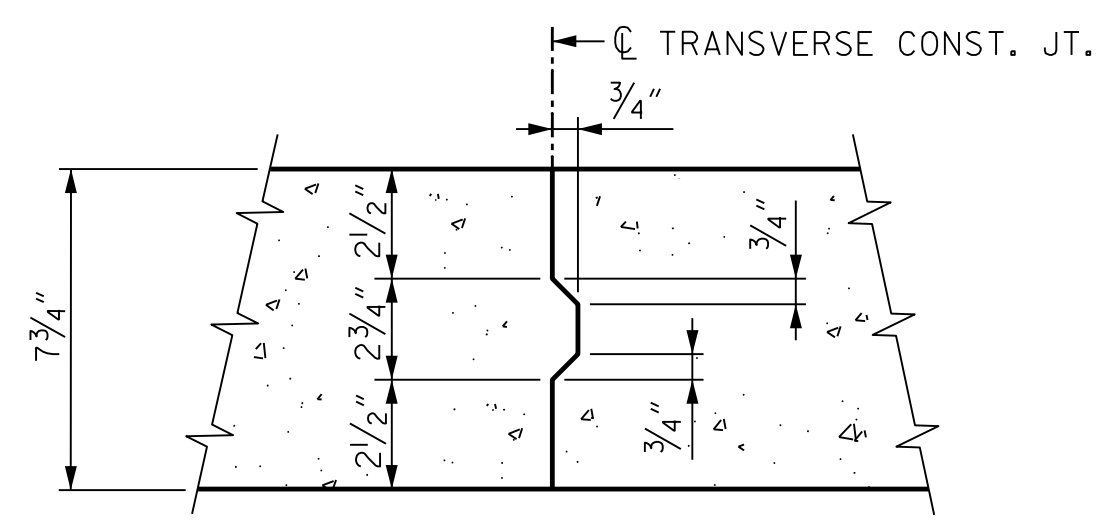

**TRANSVERSE CONSTRUCTION JOINT**  
(REINFORCING STEEL IN SLAB NOT SHOWN)  
(LONGITUDINAL REINFORCING STEEL SHALL BE CONTINUOUS THROUGH JOINT)

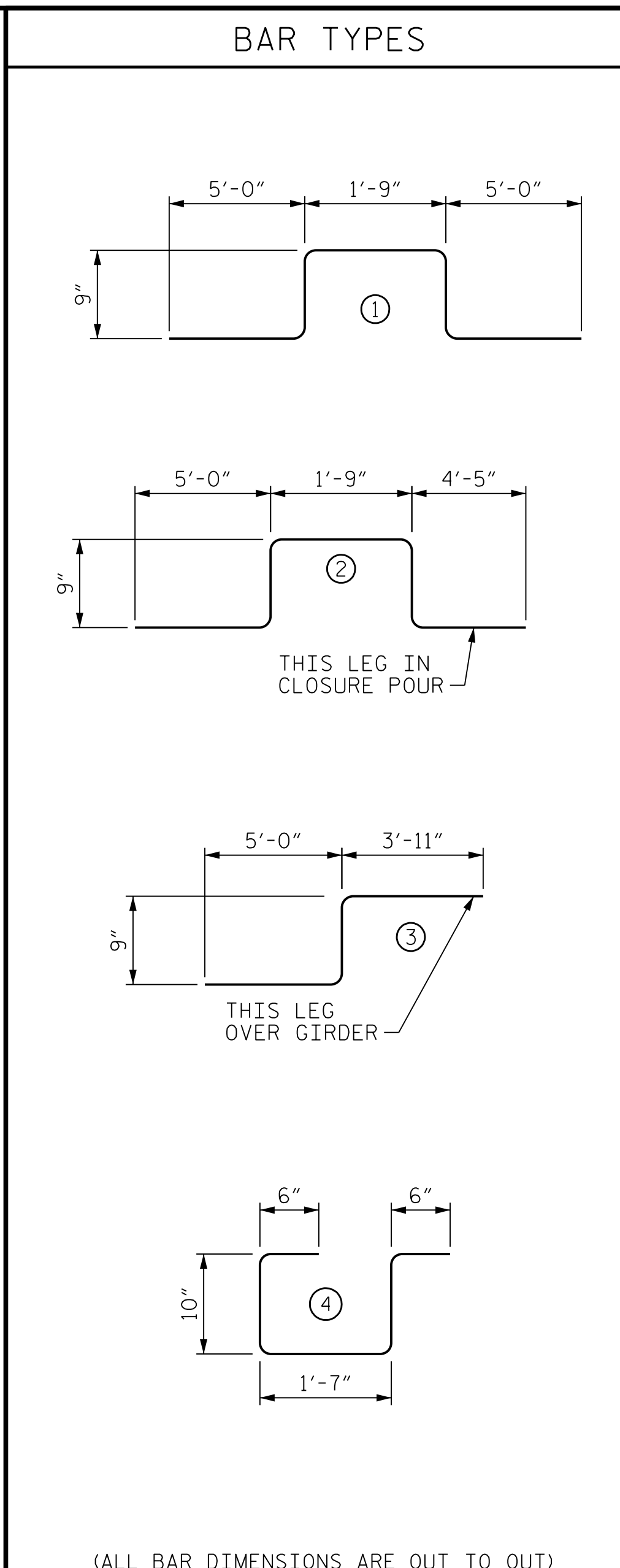

(ALL BAR DIMENSIONS ARE OUT TO OUT)

BAR TYPES						BILL OF MATERIAL					
BAR	NO.	SIZE	TYPE	LENGTH	WEIGHT	BAR	NO.	SIZE	TYPE	LENGTH	WEIGHT
* A1	274	#5	STR	26'-3"	7502	A111	2	#5	STR	19'-8"	42
* A2	2	#5	STR	25'-10"	54	A112	2	#5	STR	19'-0"	40
* A3	2	#5	STR	25'-2"	53	A113	2	#5	STR	18'-4"	39
* A4	2	#5	STR	24'-6"	52	A114	2	#5	STR	17'-7"	37
* A5	2	#5	STR	23'-10"	50	A115	2	#5	STR	16'-11"	36
* A6	2	#5	STR	23'-1"	49	A116	2	#5	STR	16'-3"	34
* A7	2	#5	STR	22'-5"	47	A117	2	#5	STR	15'-6"	33
* A8	2	#5	STR	21'-9"	46	A118	2	#5	STR	14'-10"	31
* A9	2	#5	STR	21'-1"	44	A119	2	#5	STR	14'-2"	30
* A10	2	#5	STR	20'-4"	43	A120	2	#5	STR	13'-6"	29
* A11	2	#5	STR	19'-8"	42	A121	2	#5	STR	12'-9"	27
* A12	2	#5	STR	19'-0"	40	A122	2	#5	STR	12'-1"	26
* A13	2	#5	STR	18'-4"	39	A123	2	#5	STR	11'-5"	24
* A14	2	#5	STR	17'-7"	37	A124	2	#5	STR	10'-9"	23
* A15	2	#5	STR	16'-11"	36	A125	2	#5	STR	10'-0"	21
* A16	2	#5	STR	16'-3"	34	A126	2	#5	STR	9'-4"	20
* A17	2	#5	STR	15'-6"	33	A127	2	#5	STR	8'-8"	19
* A18	2	#5	STR	14'-10"	31	A128	2	#5	STR	8'-0"	17
* A19	2	#5	STR	14'-2"	30	A129	2	#5	STR	7'-3"	16
* A20	2	#5	STR	13'-6"	29	A130	2	#5	STR	6'-7"	14
* A21	2	#5	STR	12'-9"	27	A131	2	#5	STR	5'-11"	13
* A22	2	#5	STR	12'-1"	26	A132	2	#5	STR	5'-2"	11
* A23	2	#5	STR	11'-5"	24	A133	2	#5	STR	4'-6"	10
* A24	2	#5	STR	10'-9"	23	A134	2	#5	STR	3'-10"	8
* A25	2	#5	STR	10'-0"	21	A135	2	#5	STR	3'-2"	7
* A26	2	#5	STR	9'-4"	20	A136	2	#5	STR	2'-5"	6
* A27	2	#5	STR	8'-8"	19	A137	2	#5	STR	1'-9"	4
* A28	2	#5	STR	8'-0"	17						
* A29	2	#5	STR	7'-3"	16	* B1	28	#4	STR	37'-3"	697
* A30	2	#5	STR	6'-7"	14	* B2	108	#6	STR	21'-5"	3475
* A31	2	#5	STR	5'-11"	13	* B3	56	#4	STR	24'-2"	905
* A32	2	#5	STR	5'-2"	11	* B4	28	#4	STR	38'-4"	717
* A33	2	#5	STR	4'-6"	10	B101	123	#5	STR	53'-5"	6853
* A34	2	#5	STR	3'-10"	8						
* A35	2	#5	STR	3'-2"	7	* D1	312	#5	STR	5'-5"	1763
* A36	2	#5	STR	2'-5"	6	D101	312	#5	STR	4'-7"	1492
* A37	2	#5	STR	1'-9"	4						
* A38	3	#6	STR	13'-0"	59	* G1	2	#5	STR	32'-5"	68
						* G2	2	#5	STR	6'-2"	13
A101	274	#5	STR	26'-3"	7502						
A102	2	#5	STR	25'-10"	54	* K1	8	#5	1	13'-3"	111
A103	2	#5	STR	25'-2"	53	* K2	4	#5	2	12'-8"	53
A104	2	#5	STR	24'-6"	52	* K3	4	#5	3	9'-8"	41
A105	2	#5	STR	23'-10"	50						
A106	2	#5	STR	23'-1"	49	* S1	52	#4	4	4'-3"	148
A107	2	#5	STR	22'-5"	47	REINFORCING STEEL 16,902 LB					
A108	2	#5	STR	21'-9"	46	* EPOXY COATED REINFORCING STEEL 16,607 LB					
A109	2	#5	STR	21'-1"	44	* DENOTES EPOXY COATED REINFORCING STEEL					
A110	2	#5	STR	20'-4"	43						

**SUPERSTRUCTURE REINFORCING STEEL LENGTHS ARE BASED ON THE FOLLOWING MINIMUM SPLICE LENGTHS**

BAR SIZE	SUPERSTRUCTURE EXCEPT APPROACH SLABS, PARAPET, AND BARRIER RAIL		APPROACH SLABS		PARAPET AND BARRIER RAIL
	EPOXY COATED	UNCOATED	EPOXY COATED	UNCOATED	
#4	1'-11"	1'-7"	1'-11"	1'-7"	2'-6"
#5	2'-5"	2'-0"	2'-5"	2'-0"	3'-1"
#6	2'-10"	2'-5"	3'-7"	2'-5"	3'-8"
#7	4'-2"	2'-9"			
#8	4'-9"	3'-2"			



Eric M. Nolting 1/24/2022

POUR NO.	CY
POUR 1	45.7
POUR 2	53.5
POUR 3	16.6
CLOSURE POUR	14.5
<b>TOTAL (#)</b>	<b>130.3</b>

(#) QUANTITIES FOR BARRIER RAIL ARE NOT INCLUDED

PROJECT NO. B-3186/B-5898  
HAYWOOD COUNTY  
 STATION: 68+82.30 ± -L-LT-

STATE OF NORTH CAROLINA  
 DEPARTMENT OF TRANSPORTATION  
 RALEIGH

**SUPERSTRUCTURE BILL OF MATERIAL**

REVISIONS						SHEET NO. SO3L-25
NO.	BY:	DATE:	NO.	BY:	DATE:	
1	--	--	3	--	--	TOTAL SHEETS 44
2	--	--	4	--	--	

PLOT DRIVER: NCDOT STRUCTURES DEFAULT PLOTTER.plt  
 PENTABLE: NCDOT STRUCTURES DEFAULT PEN.tbl  
 USER: PPETERSO  
 DATE: 1/24/2022  
 TIME: 1:48:12 PM  
 FILE: ... \403.120.B5898B3186.SMU.BM.025.430110.dgn

DES BY: F. CORDOVA	DATE: 05/21	DWG BY: B. PETERSON	DATE: 03/21
DES CHK: E. NOLTING	DATE: 07/21	CHK BY: E. NOLTING	DATE: 07/21

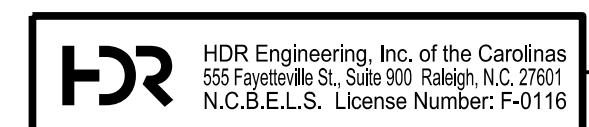

DOCUMENT NOT CONSIDERED FINAL UNLESS ALL SIGNATURES COMPLETED