

BILL OF MATERIAL					
CLOSURE POUR					
BAR	NO.	SIZE	TYPE	LENGTH	WEIGHT
*B1	24	#4	STR.	39'-10"	639
*B2	6	#6	STR.	41'-8"	376
B3	20	#5	STR.	58'-10"	1227
B4	4	#4	STR.	38'-8"	103
*J1	8	#4	1	1'-5"	8
*K5	4	#6	STR.	7'-9"	47
*K9	6	#6	STR.	3'-11"	35
*S1	10	#5	5	5'-10"	61
*S2	8	#5	5	3'-2"	26
*S3	10	#4	6	6'-1"	41
* EPOXY COATED REINFORCING STEEL					1,233 LBS.
REINFORCING STEEL					1,330 LBS.
* DENOTES EPOXY COATED REINFORCING STEEL					

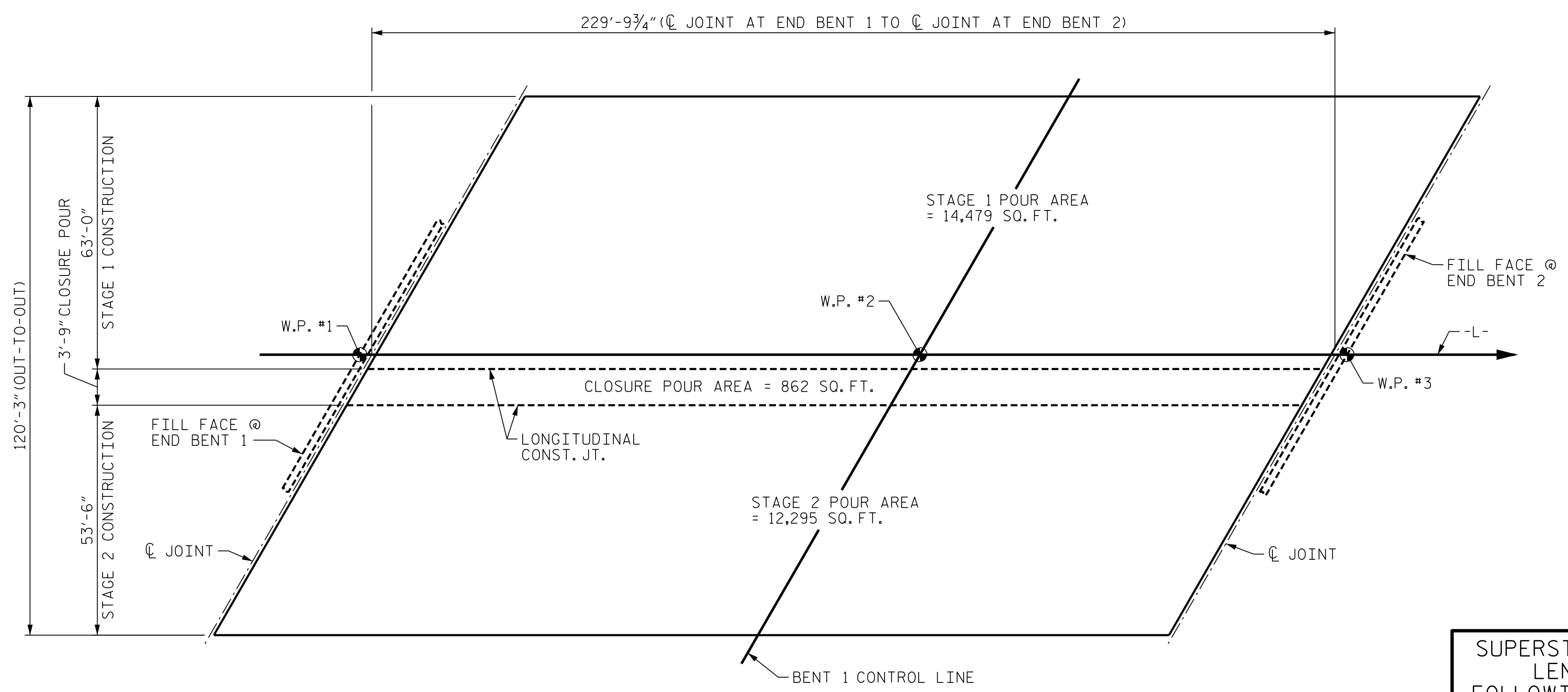
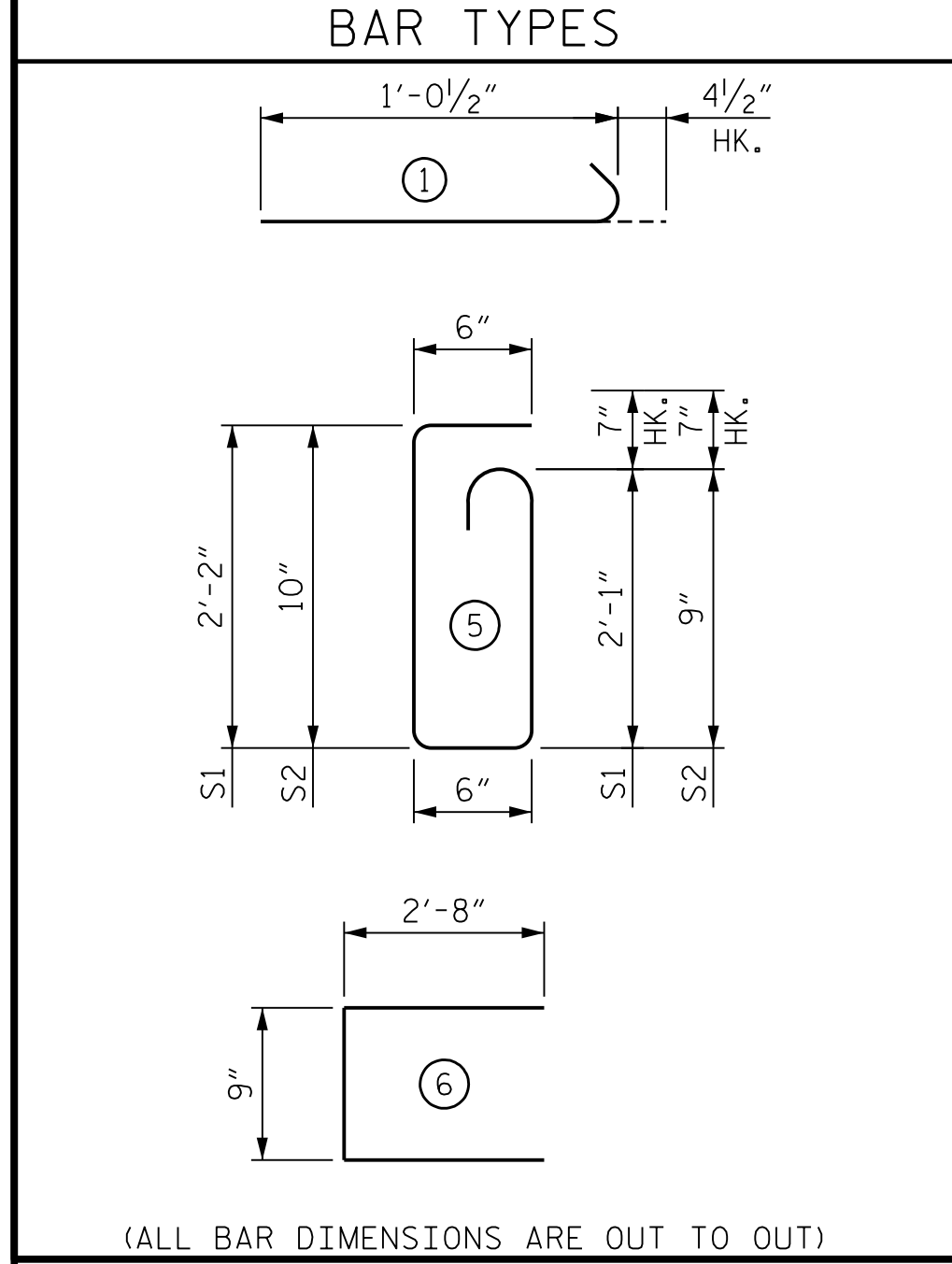

**LAYOUT FOR COMPUTING AREA REINFORCED CONCRETE DECK SLAB**  
(SQ. FT. = 27,636)

SUPERSTRUCTURE REINFORCING STEEL LENGTHS ARE BASED ON THE FOLLOWING MINIMUM SPLICE LENGTHS

BAR SIZE	SUPERSTRUCTURE EXCEPT APPROACH SLABS, PARAPET, AND BARRIER RAIL		APPROACH SLABS		PARAPET AND BARRIER RAIL
	EPOXY COATED	UNCOATED	EPOXY COATED	UNCOATED	EPOXY COATED
#4	1'-11"	1'-7"	1'-11"	1'-7"	2'-6"
#5	2'-5"	2'-0"	2'-5"	2'-0"	3'-1"
#6	2'-10"	2'-5"	3'-7"	2'-5"	3'-8"
#7	4'-2"	2'-9"			
#8	4'-9"	3'-2"			

**SUPERSTRUCTURE BILL OF MATERIAL FOR POUR VOLUMES AND GROOVING AREAS**

	CLASS AA CONCRETE					GROOVING BRIDGE FLOORS (SQ. FT.)		
	(CU. YDS.)					REINFORCED CONCRETE DECK SLAB	BRIDGE APPROACH SLABS	TOTAL
	POUR #1	POUR #2	POUR #3	POUR #4	TOTAL			
STAGE 1 CONSTRUCTION	195.6	266.9	36.0	30.5	529.0	12,750	2,726	15,476
STAGE 2 CONSTRUCTION	227.6	166.8	30.7	25.8	250.9	12,065	2,578	14,643
CLOSURE POUR	11.7	8.6	1.6	2.6	24.5	-	-	-
TOTAL **	-	-	-	-	804.4	-	-	30,119

\*\* QUANTITIES FOR CONCRETE BARRIER RAIL AND MEDIAN BARRIER NOT INCLUDED

PROJECT NO. B-3186/B-5898  
HAYWOOD COUNTY  
 STATION: 42+71.13 -L-  
 SHEET 3 OF 3

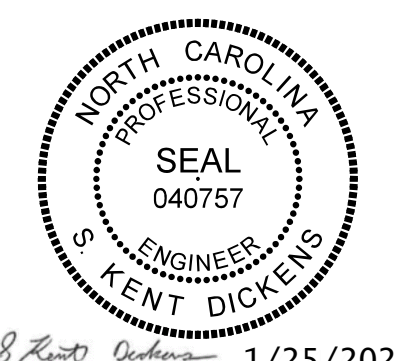

STATE OF NORTH CAROLINA  
 DEPARTMENT OF TRANSPORTATION  
 RALEIGH

**SUPERSTRUCTURE BILL OF MATERIALS**

REVISIONS						SHEET NO. S01-37
NO.	BY:	DATE:	NO.	BY:	DATE:	
1	--	--	3	--	--	TOTAL SHEETS 59
2	--	--	4	--	--	

PLOT DRIVER: NCDOT\_STRUCTURES\_DEFAULT\_PLOTTER.plt  
 USER: PETERSO  
 DATE: 1/25/2022  
 TIME: 8:31:35 AM  
 FILE: ... \401.180.B5898B3186.SMU.BM.037\_430168.dgn

DES BY: <u>H. ABU NIMEH</u>	DATE: <u>05/21</u>	DWG BY: <u>H. ABU NIMEH</u>	DATE: <u>05/21</u>
DES CHK: <u>K. DICKENS</u>	DATE: <u>05/21</u>	CHK BY: <u>L. GUALTIERI</u>	DATE: <u>07/21</u>



DOCUMENT NOT CONSIDERED FINAL UNLESS ALL SIGNATURES COMPLETED