

PROJECT REFERENCE NO. B-3186 / B-5898	SHEET NO. 5
RW SHEET NO.	
ROADWAY DESIGN ENGINEER	HYDRAULICS ENGINEER
3/17/2022	

DOCUMENT NOT CONSIDERED FINAL UNLESS ALL SIGNATURES COMPLETED

HDR HDR Engineering, Inc. of the Carolinas
555 Fayetteville St. Suite 900 Raleigh, N.C. 27601
N.C.B.E.L.S. License Number: F-0116

-L-LT-

Pls Sta 19+04.53	Pls Sta 26+73.54	Pl Sta 32+18.70
$\Theta s = 1' 41'' 40.8''$	$\Theta s = 6' 30'' 13.8''$	$\Delta = 32' 38'' 17.0'' (LT)$
$Ls = 210.00'$	$Ls = 336.00'$	$D = 3' 52'' 16.8''$
$LT = 140.01'$	$LT = 224.15'$	$L = 843.07'$
$ST = 70.01'$	$ST = 112.14'$	$T = 433.32'$
		$R = 1,480.00'$

LAKE JUNALUSKA
ASSEMBLY, INC
DB 34 PG 476

NAD 83/2011

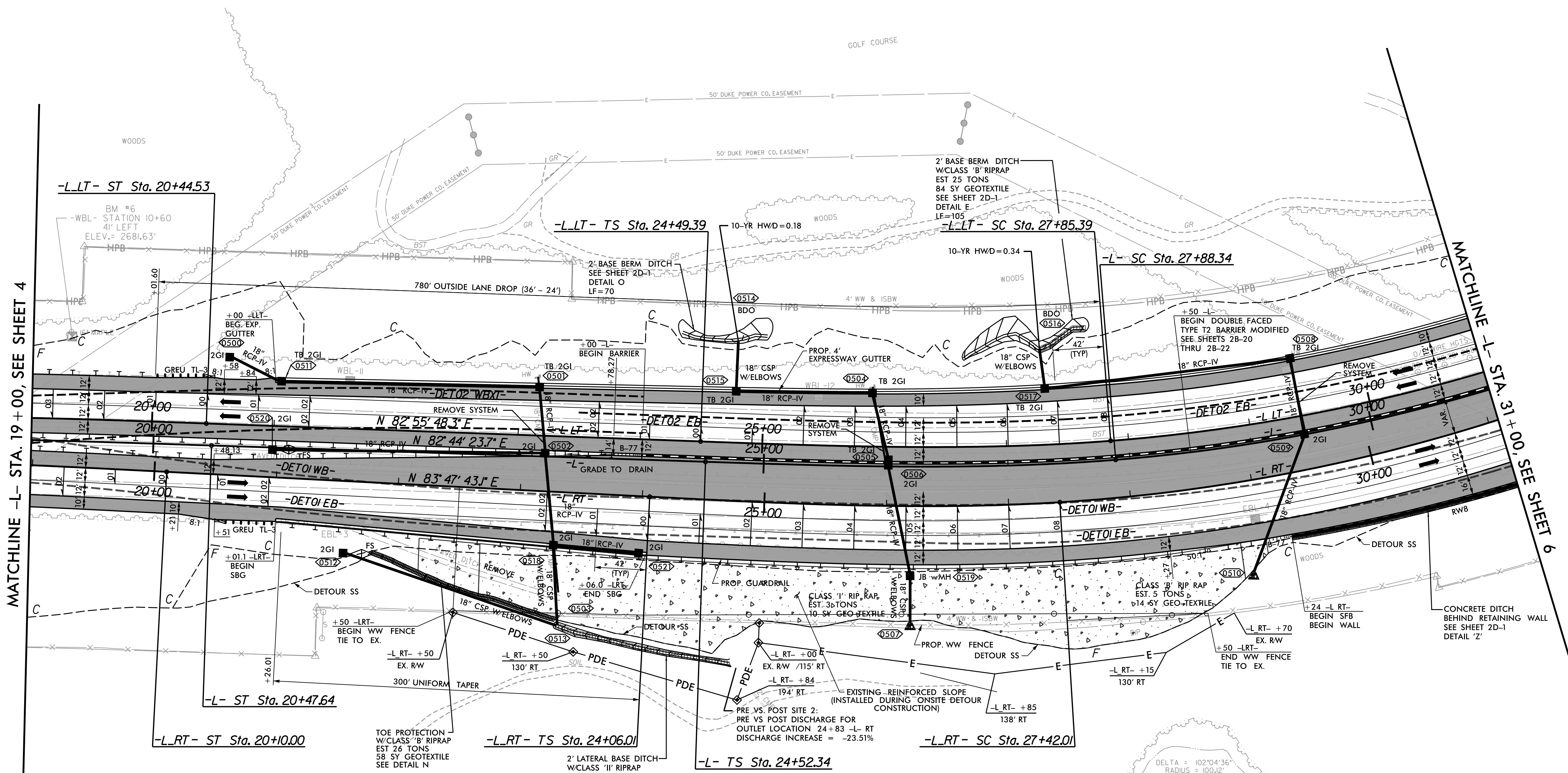

MATCHLINE -L- STA. 19+00, SEE SHEET 4

MATCHLINE -L- STA. 31+00, SEE SHEET 6

COUNTRY CLUB REAL ESTATE OF WNC, INC.
DB 915 PG 697

-L-RT-

Pls Sta 18+70.00	Pls Sta 26+30.16	Pl Sta 31+87.49
$\Theta s = 1' 31'' 16.1''$	$\Theta s = 6' 30'' 13.8''$	$\Delta = 33' 30'' 11.9'' (LT)$
$Ls = 210.00'$	$Ls = 336.00'$	$D = 3' 52'' 16.8''$
$LT = 140.01'$	$LT = 224.15'$	$L = 865.42'$
$ST = 70.00'$	$ST = 112.14'$	$T = 445.48'$
		$R = 1,480.00'$

-L-

Pls Sta 18+47.65	Pls Sta 26+76.49	Pl Sta 32+18.99
$\Theta s = 2' 12'' 13.3''$	$\Theta s = 6' 30'' 13.8''$	$\Delta = 32' 26'' 52.5'' (LT)$
$Ls = 300.00'$	$Ls = 336.00'$	$D = 3' 52'' 16.8''$
$LT = 200.02'$	$LT = 224.15'$	$L = 838.16'$
$ST = 100.01'$	$ST = 112.14'$	$T = 430.65'$
		$R = 1,480.00'$
		$SE = 0.08$
		$DS = 65mph$

SEE SHEET 2D-1 FOR DRAINAGE DITCH DETAILS
FOR -L- LT- PROFILE, SEE PROFILE SHEET 12
FOR -L- RT- PROFILE, SEE PROFILE SHEET 11 & 12

PLOT DRIVER: NCDOT_color_eng_50.plt
USER: HBARE
DATE: 3/16/2022
TIME: 1:47:33 PM
FILE: NCDOT\NCDOT-B3186_T02.c. \6.0.CAD.BTM.6.2_Work_In_Progress\B-3186-B-5898\Roadway\Pro\B3186-B5898-RDY_PSH05.dgn