

BAGGED STONE AND PIPE SHALL BE PLACED IMMEDIATELY AFTER COMPLETION OF END BENT EXCAVATION. PIPE MAY BE EITHER CONCRETE, CORRUGATED STEEL, CORRUGATED ALUMINUM ALLOY, OR CORRUGATED PLASTIC. PERFORATED PIPE WILL NOT BE ALLOWED.

BAGGED STONE SHALL REMAIN IN PLACE UNTIL THE ENGINEER DIRECTS THAT IT BE REMOVED. THE CONTRACTOR SHALL REMOVE AND DISPOSE OF SILT ACCUMULATIONS AT BAGGED STONE WHEN SO DIRECTED BY THE ENGINEER. BAGS SHALL BE REMOVED AND REPLACED WHENEVER THE ENGINEER DETERMINES THAT THEY HAVE DETERIORATED AND LOST THEIR EFFECTIVENESS.

NO SEPARATE PAYMENT WILL BE MADE FOR THIS WORK AND THE ENTIRE COST OF THIS WORK SHALL BE INCLUDED IN THE UNIT CONTRACT PRICE BID FOR THE SEVERAL PAY ITEMS.

**TEMPORARY DRAINAGE AT END BENT**

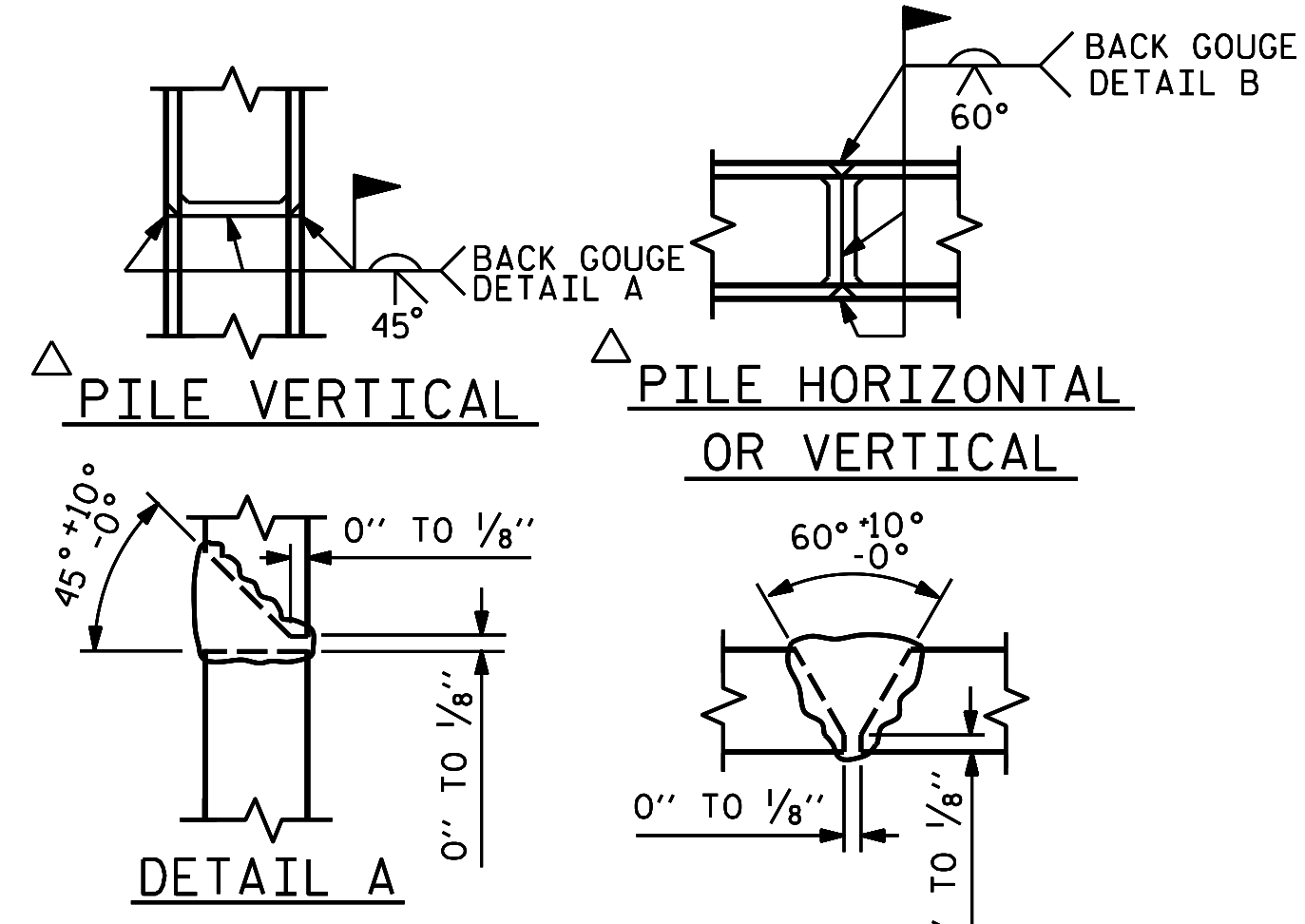

**PILE SPlice DETAILS**

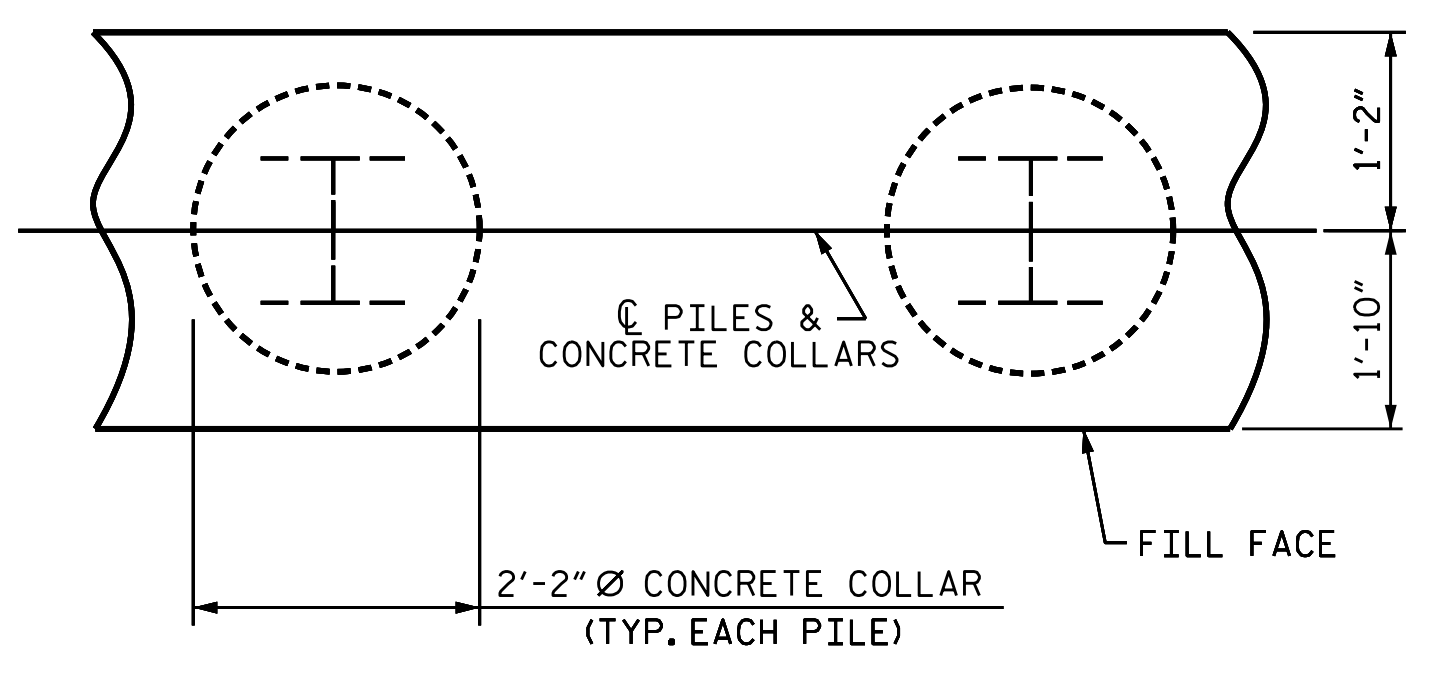

**CORROSION PROTECTION FOR STEEL PILES DETAIL**

BAR TYPES						BILL OF MATERIAL					
						END BENT #1					
BAR	NO.	SIZE	TYPE	LENGTH	WEIGHT	BAR	NO.	SIZE	TYPE	LENGTH	WEIGHT
B1	8	#9	1	42'-3"	1149	B1	8	#9	1	42'-3"	1149
B2	14	#4	STR	39'-11"	373	B2	14	#4	STR	39'-11"	373
B3	10	#4	STR	2'-8"	18	B3	10	#4	STR	2'-8"	18
B4	8	#4	STR	2'-4"	12	B4	8	#4	STR	2'-4"	12
E1	16	#5	STR	3'-6"	58	E1	16	#5	STR	3'-6"	58
H1	52	#5	2	7'-7"	411	H1	52	#5	2	7'-7"	411
K1	12	#4	STR	39'-11"	320	K1	12	#4	STR	39'-11"	320
K2	8	#4	STR	3'-0"	16	K2	8	#4	STR	3'-0"	16
S1	74	#4	3	10'-8"	527	S1	74	#4	3	10'-8"	527
S2	74	#4	4	3'-5"	169	S2	74	#4	4	3'-5"	169
S3	28	#4	5	7'-7"	142	S3	28	#4	5	7'-7"	142
U1	34	#4	6	3'-8"	83	U1	34	#4	6	3'-8"	83
U2	6	#4	6	5'-8"	23	U2	6	#4	6	5'-8"	23
V1	68	#5	STR	8'-10"	626	V1	68	#5	STR	8'-10"	626
V2	48	#5	STR	10'-6"	526	V2	48	#5	STR	10'-6"	526
						REINFORCING STEEL = 4453 LBS					
						CLASS A CONCRETE BREAKDOWN					
						POUR #1 CAP, LOWER PART OF WINGS AND COLLARS					
						C.Y. 21.6					
						POUR #2 (BACKWALL & UPPER PART OF WINGS)					
						C.Y. 11.5					
						TOTAL CLASS A CONCRETE					
						C.Y. 33.1					
						HP 14 X 73 STEEL PILES					
						NO. 7 LIN. FT. 125.0					
						PREDRILLING FOR PILES					
						LIN. FT. 20.0					
						STEEL PILE POINTS					
						NO. 7					

**NOTES**

ABUTMENT RESTRAINTS (STRAPS) ARE REQUIRED ALONG THE CAP AS SHOWN. THE 1.62 KLF LOAD PROVIDED IS A FACTORED LOAD. THE SPACING AND LENGTH OF STRAPS SHALL BE DETERMINED BY A LICENSED PROFESSIONAL ENGINEER REGISTERED IN NORTH CAROLINA AND SUBMITTED TO THE ENGINEER FOR REVIEW PRIOR TO INSTALLATION. ANY ADDITIONAL CONSTRUCTION LOADS THAT WILL APPLY LOAD TO THE STRAPS (INCLUDING BUT NOT LIMITED TO CRANE LOADS) SHALL BE INCLUDED IN THE STRAP DESIGN AND SHALL BE SUBMITTED TO THE ENGINEER PRIOR TO PLACING CONSTRUCTION LOAD ON THE APPROACH FILL.

PAYMENT FOR THE ABUTMENT RESTRAINTS (STRAPS) SHALL BE CONSIDERED INCIDENTAL TO VARIOUS PAY ITEMS.

FOR ADDITIONAL NOTES, SEE "FOUNDATION LAYOUT" SHEET.

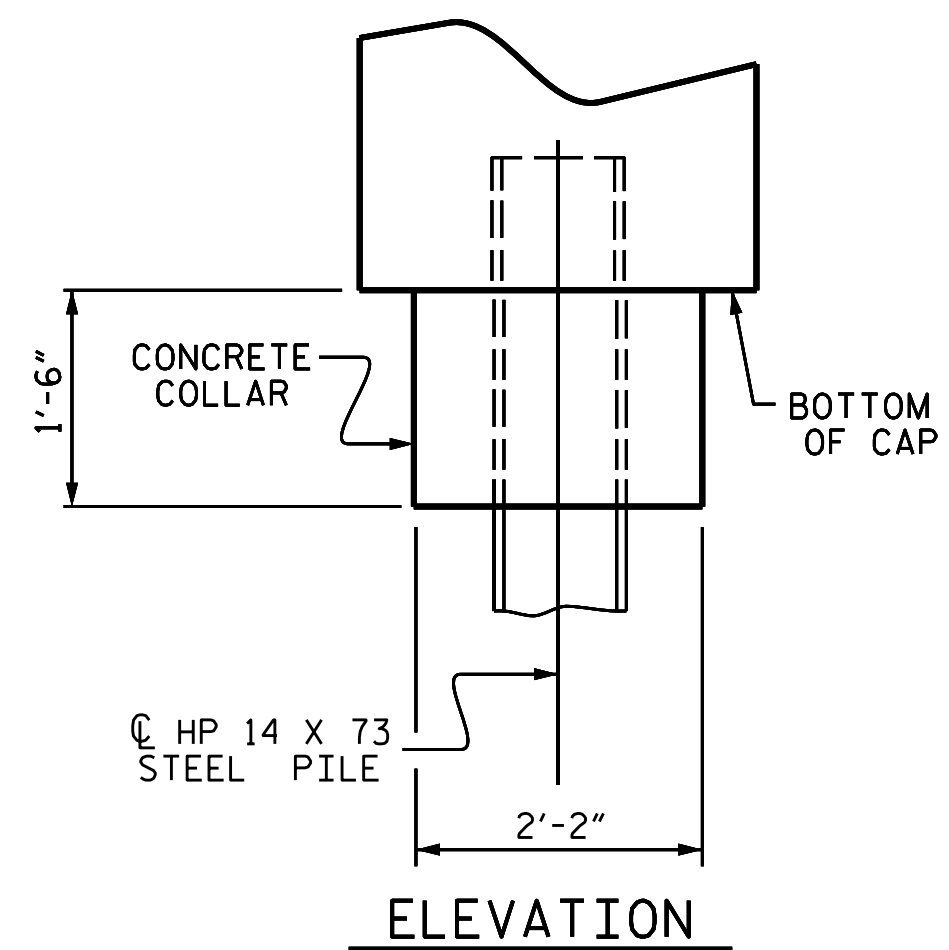

**ELEVATION**

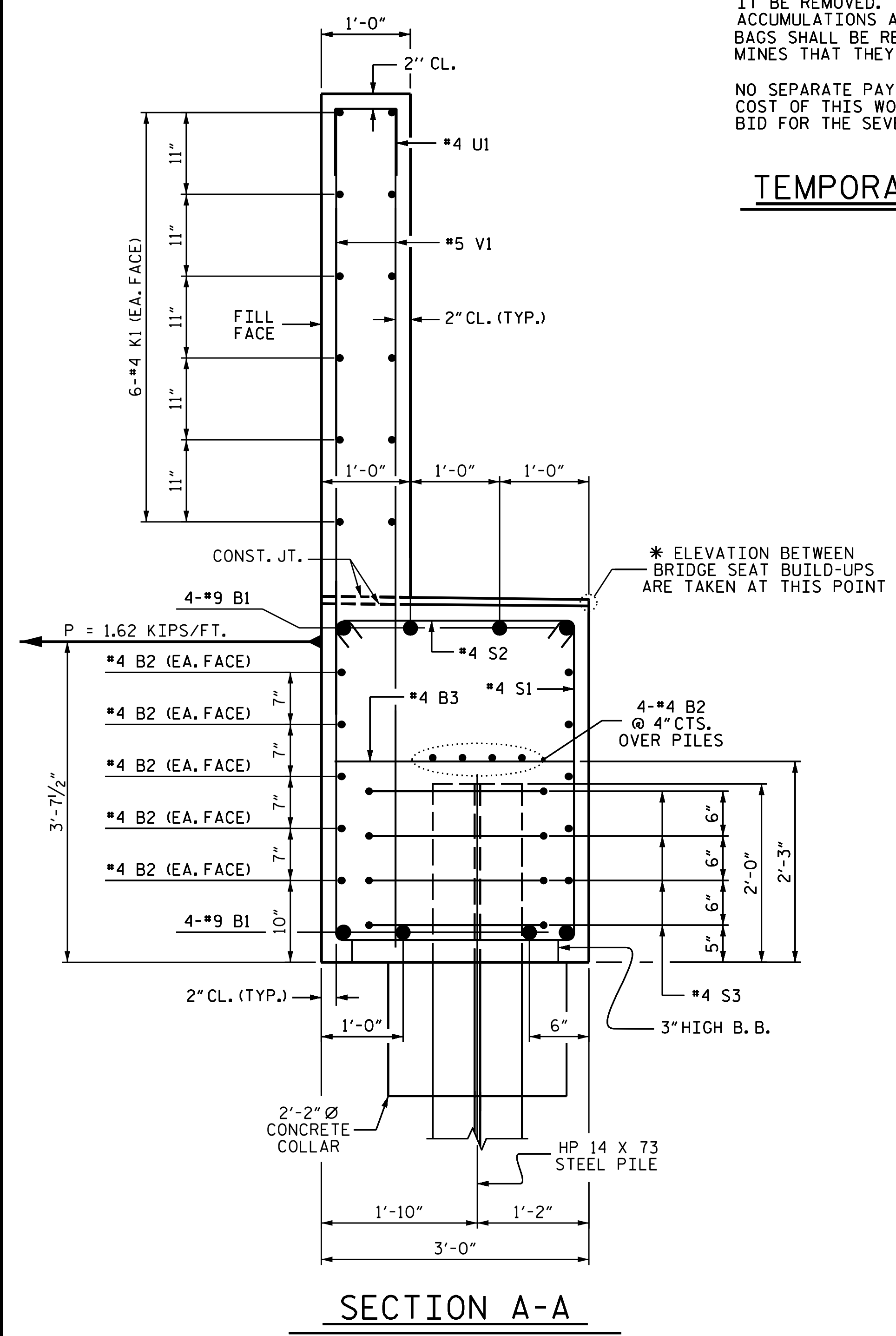

**SECTION A-A**

DRAWN BY : A. SORSENGINH DATE : 3/2021  
 CHECKED BY : M. G. SHAIKH DATE : 5/2021  
 DESIGN ENGINEER OF RECORD: A. SORSENGINH DATE : 5/2021

3/25/2022  
 I:\Structures\Final Plans OBD\401.041.B5772.SMU.E1.S20.790066.dgn  
 ksedal



PROJECT NO. B-5772  
 ROWAN COUNTY  
 STATION: 20+91.04 -EL-  
 SHEET 3 OF 3

STATE OF NORTH CAROLINA  
 DEPARTMENT OF TRANSPORTATION  
 RALEIGH  
 SUBSTRUCTURE  
 END BENT #1

REVISIONS						SHEET NO.
NO.	BY:	DATE:	NO.	BY:	DATE:	S-20
1			3			TOTAL SHEETS 25
2			4			

DOCUMENT NOT CONSIDERED FINAL UNLESS ALL SIGNATURES COMPLETED