

**This electronic collection of documents is provided  
for the convenience of the user  
and is Not a Certified Document –**

**The documents contained herein were originally issued  
and sealed by the individuals whose names and license  
numbers appear on each page, on the dates appearing  
with their signature on that page.**

**This file or an individual page  
shall not be considered a certified document.**

STATE OF NORTH CAROLINA  
DIVISION OF HIGHWAYS

**TRANSPORTATION MANAGEMENT PLAN**

**PITT COUNTY**

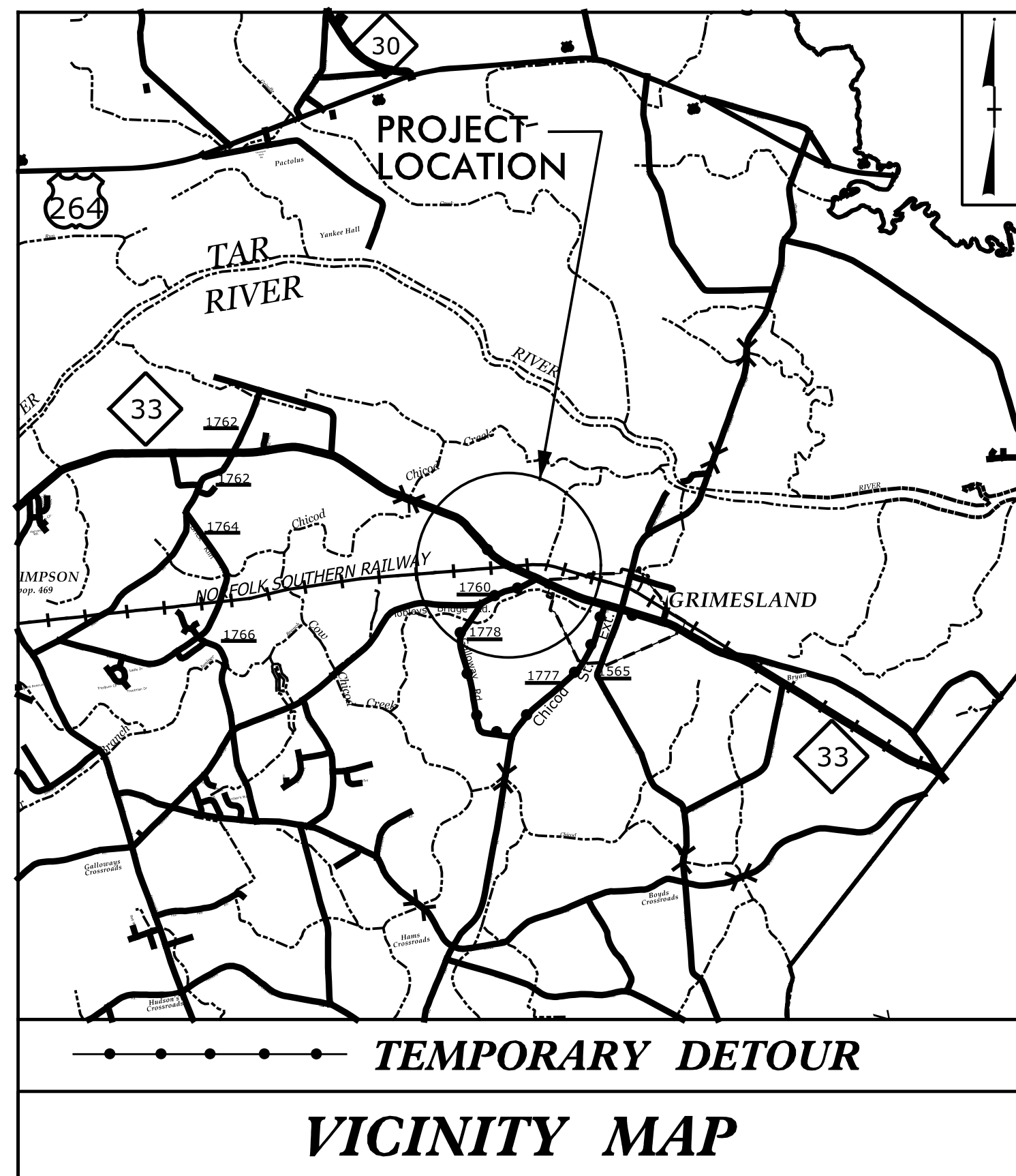
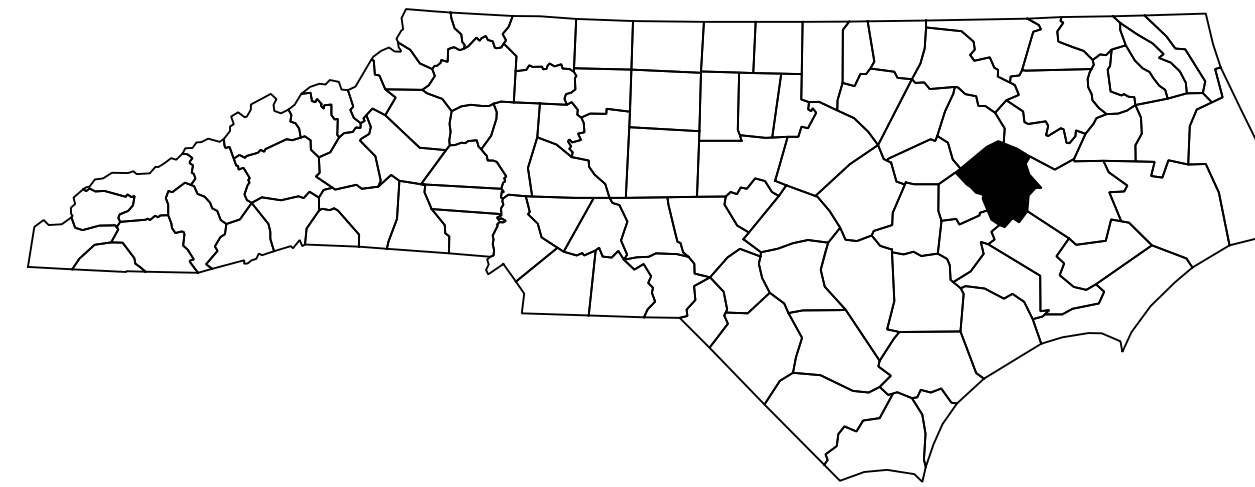

**LOCATION: BRIDGE NO. 87 OVER NORFOLK SOUTHERN RAILROAD ON NC 33**

**TYPE OF WORK: GRADING, DRAINAGE, STRUCTURE & PAVING**

**INDEX OF SHEETS**

SHEET NO.	TITLE
TMP-1	TITLE SHEET, VICINITY MAP, AND INDEX OF SHEETS
TMP-1A	LIST OF APPLICABLE ROADWAY STANDARD DRAWINGS, LEGEND, AND TEMPORARY PAVEMENT MARKING SCHEDULE
TMP-2	TRANSPORTATION OPERATIONS PLAN: (GENERAL NOTES AND LOCAL NOTES)
TMP-3	MANAGEMENT STRATEGIES AND TEMPORARY TRAFFIC CONTROL PHASING
TMP-4 THRU TMP-6	TEMPORARY TRAFFIC CONTROL PHASE I DETAILS
TMP-7 THRU TMP-9	TEMPORARY TRAFFIC CONTROL PHASE II DETAILS
TMP-10 & TMP-11	TEMPORARY TRAFFIC CONTROL OFF-SITE DETOUR & ROAD CLOSURE FOR PIPE CONSTRUCTION
TMP-12 & TMP-13	TEMPORARY TRAFFIC CONTROL OFF-SITE DETOUR & ROAD CLOSURE FOR CONCRETE REMOVAL AND REPLACE

SHEET NO.  
TMP-1

**B-5301**

**TIP PROJECT:**

DOCUMENT NOT CONSIDERED FINAL  
UNLESS ALL SIGNATURES COMPLETED

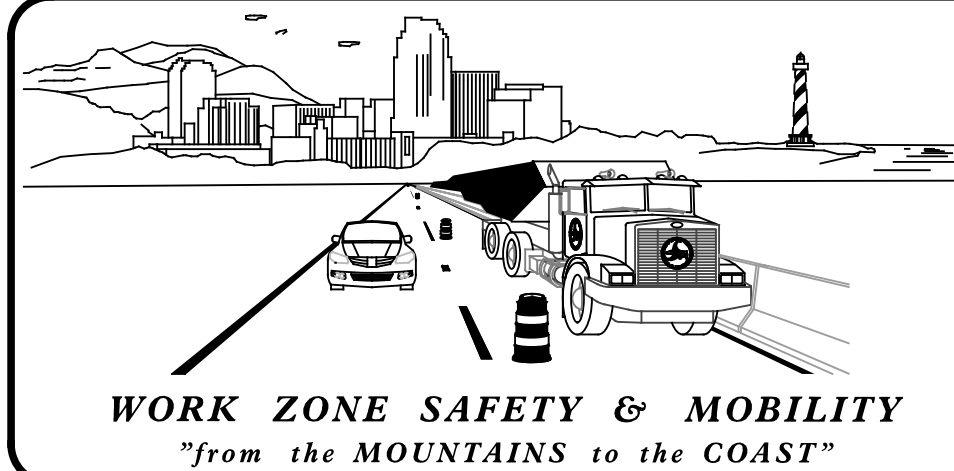

**PLANS PREPARED BY:**  
S. D. MILLER  
S. N. GREEN

**NCDOT CONTACTS:**  
J. S. KITE, P.E.  
PROJECT ENGINEER  
S. B. JENNINGS  
PROJECT DESIGN ENGINEER

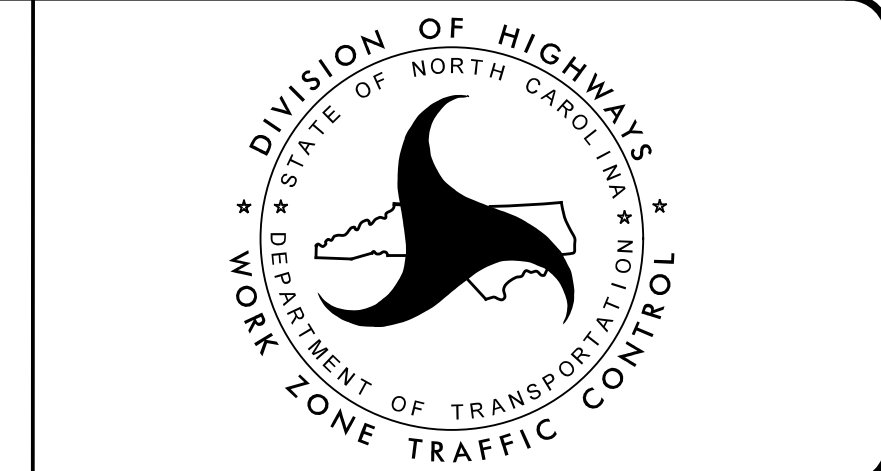

**SEPI**  
1 Glenwood Avenue  
Raleigh, NC 27603  
Tel: 919.789.9977  
Fax: 919.789.9591  
License: C-2197

**APPROVED:** \_\_\_\_\_  
**DATE:** \_\_\_\_\_  
**SEAL**

3/30/2020 X:\2014\04\003.00\_B-5301\TrafficControl\TCP\B-5301 TMP-1.dgn JBauman

# ROADWAY STANDARD DRAWINGS

THE FOLLOWING ROADWAY STANDARDS AS SHOWN IN "ROADWAY STANDARD DRAWINGS" - PROJECT SERVICES UNIT - N.C. DEPARTMENT OF TRANSPORTATION - RALEIGH, N.C., DATED JANUARY 2018 ARE APPLICABLE TO THIS PROJECT AND BY REFERENCE HEREBY ARE CONSIDERED A PART OF THESE PLANS:

STD. NO.	TITLE
1101.01	WORK ZONE ADVANCE WARNING SIGNS
1101.02	TEMPORARY LANE CLOSURES
1101.03	TEMPORARY ROAD CLOSURES
1101.04	TEMPORARY SHOULDER CLOSURES
1101.05	WORK ZONE VEHICLE ACCESSES
1101.11	TRAFFIC CONTROL DESIGN TABLES
1110.01	STATIONARY WORK ZONE SIGNS
1110.02	PORTABLE WORK ZONE SIGNS
1130.01	DRUM
1135.01	CONES
1145.01	BARRICADES - TYPE III
1150.01	FLAGGERS
1165.01	WORK VEHICLE LIGHTING SYSTEMS AND TMA DELINEATION
1180.01	SKINNY DRUMS
1205.01	PAVEMENT MARKINGS - LINE TYPES AND OFFSETS
1205.02	PAVEMENT MARKINGS - TWO LANE AND MULTILANE ROADWAYS
1205.04	PAVEMENT MARKINGS - INTERSECTIONS
1205.12	PAVEMENT MARKINGS - BRIDGES
1250.01	RAISED PAVEMENT MARKERS - INSTALLATION SPACING
1253.01	RAISED PAVEMENT MARKERS - SNOWPLOWABLE
1261.01	GUARDRAIL AND BARRIER DELINEATORS - INSTALLATION SPACING
1261.02	GUARDRAIL AND BARRIER DELINEATORS - TYPES AND MOUNTING
1262.01	GUARDRAIL END DELINEATION

# LEGEND

## GENERAL

- DIRECTION OF TRAFFIC FLOW
- DIRECTION OF PEDESTRIAN TRAFFIC FLOW
- EXIST. PVMT.
- NORTH ARROW
- PROPOSED PVMT.
- TEMP. SHORING (LOCATION PURPOSES ONLY)
- CONSTRUCTION AWAY FROM TRAFFIC
- REMOVAL
- CONSTRUCTION WITH FLAGGERS/LANE CLOSURES

## SIGNALS

- EXISTING
- PROPOSED
- TEMPORARY

## PAVEMENT MARKINGS

- EXISTING LINES
- TEMPORARY LINES

## TRAFFIC CONTROL DEVICES

- BARRICADE (TYPE III)
- CONE
- DRUM SKINNY DRUM TUBULAR MARKER
- TEMPORARY CRASH CUSHION
- FLASHING ARROW BOARD
- FLAGGER
- LAW ENFORCEMENT
- TRUCK MOUNTED ATTENUATOR (TMA)
- CHANGEABLE MESSAGE SIGN

## TEMPORARY SIGNING

- PORTABLE SIGN
- STATIONARY SIGN
- STATIONARY OR PORTABLE SIGN

## PAVEMENT MARKERS

- CRYSTAL/CRYSTAL
- CRYSTAL/RED
- YELLOW/YELLOW

## PAVEMENT MARKING SYMBOLS

- PAVEMENT MARKING SYMBOLS

## TEMPORARY PAVEMENT MARKING SCHEDULE

SYMBOL	DESCRIPTION
	PAINT (4")
P5	2 FT. - 6 FT./SP WHITE MINISKIP
P1	WHITE EDGELINE
P13	YELLOW DOUBLE CENTER
	PAINT (24")
P61	WHITE STOPBAR

3/30/2020 X:\2014\RO4\003\00\_B-5301\Traffic\TrafficControl\TCP\B-5301 TMP-1A.dgn jbauman

**SEPI**  
ENGINEERING & CONSTRUCTION

1025 Wade Avenue  
Raleigh, NC 27605  
Tel: 919-789-9977  
Fax: 919-789-9591  
License: C-2197

APPROVED: \_\_\_\_\_  
DATE: \_\_\_\_\_

SEAL

**DOCUMENT NOT CONSIDERED FINAL UNLESS ALL SIGNATURES COMPLETED**

DIVISION OF HIGHWAYS  
STATE OF NORTH CAROLINA  
DEPARTMENT OF TRANSPORTATION  
WORK ZONE TRAFFIC CONTROL

ROADWAY STANDARD DRAWINGS & LEGEND

## LOCAL NOTES

- PROVIDE ONE MONTH NOTICE TO THE ENGINEER, PITT COUNTY EMERGENCY SERVICES (252)-902-3953, AND PITT COUNTY SCHOOL OFFICIALS (252)-830-4200, PRIOR TO ROAD CLOSURE.
- COORDINATE WITH NORFOLK SOUTHERN RAILROAD FOR GIRDER HANGING AND BRIDGE REMOVAL.
- HAVE AVAILABLE (2) CMS BOARDS WITH ONSITE NOTICE, 2 WEEKS PRIOR TO ROAD CLOSURE.

## GENERAL NOTES

CHANGES MAY BE REQUIRED WHEN PHYSICAL DIMENSIONS IN THE DETAIL DRAWINGS, STANDARD DETAILS, AND ROADWAY DETAILS ARE NOT ATTAINABLE TO MEET FIELD CONDITIONS OR RESULT IN DUPLICATE OR UNDESIRED OVERLAPPING OF DEVICES. MODIFICATION MAY INCLUDE: MOVING, SUPPLEMENTING, COVERING, OR REMOVAL OF DEVICES AS DIRECTED BY THE ENGINEER.

THE FOLLOWING GENERAL NOTES APPLY AT ALL TIMES FOR THE DURATION OF THE CONSTRUCTION PROJECT EXCEPT WHEN OTHERWISE NOTED IN THE PLAN OR DIRECTED BY THE ENGINEER.

### TIME RESTRICTIONS

- A) DO NOT CLOSE OR NARROW TRAVEL LANES AS FOLLOWS:

ROAD NAME:	DAY AND TIME RESTRICTIONS
NC 33	MONDAY THRU FRIDAY 7:00 A.M. - 9:00 A.M. 4:00 P.M. - 7:00 P.M.

- B) DO NOT CLOSE OR NARROW TRAVEL LANES DURING HOLIDAYS AND SPECIAL EVENTS AS FOLLOWS:

ROAD NAME:  
NC 33

### HOLIDAY

1. FOR ANY UNEXPECTED OCCURRENCE THAT CREATES UNUSUALLY HIGH TRAFFIC VOLUMES, AS DIRECTED BY THE ENGINEER.
2. FOR NEW YEAR'S, BETWEEN THE HOURS OF 7:00 A.M. DECEMBER 31ST TO 7:00 P.M. JANUARY 2ND. IF NEW YEAR'S DAY IS ON A FRIDAY, SATURDAY, SUNDAY, OR MONDAY THEN UNTIL 7:00 P.M. THE FOLLOWING TUESDAY.
3. FOR EASTER, BETWEEN THE HOURS OF 7:00 A.M. THURSDAY AND 7:00 P.M. MONDAY.
4. FOR MEMORIAL DAY, BETWEEN THE HOURS OF 7:00 A.M. FRIDAY TO 7:00 P.M. TUESDAY.
5. FOR INDEPENDENCE DAY, BETWEEN THE HOURS OF 7:00 A.M. THE DAY BEFORE INDEPENDENCE DAY AND 7:00 P.M. THE DAY AFTER INDEPENDENCE DAY.

IF INDEPENDENCE DAY IS ON A FRIDAY, SATURDAY, SUNDAY, OR MONDAY THEN BETWEEN THE HOURS OF 7:00 A.M. THE THURSDAY BEFORE INDEPENDENCE DAY AND 7:00 P.M. THE TUESDAY AFTER INDEPENDENCE DAY.

6. FOR LABOR DAY, BETWEEN THE HOURS OF 7:00 A.M. FRIDAY AND 7:00 P.M. TUESDAY.
7. FOR THANKSGIVING DAY, BETWEEN THE HOURS OF 7:00 A.M. TUESDAY TO 7:00 P.M. MONDAY.

8. FOR CHRISTMAS, BETWEEN THE HOURS OF 7:00 A.M. THE FRIDAY BEFORE THE WEEK OF CHRISTMAS DAY AND 7:00 P.M. THE FOLLOWING TUESDAY AFTER THE WEEK OF CHRISTMAS.

- C) DO NOT CLOSE ROADS AS FOLLOWS:

ROAD NAME	DAY AND TIME RESTRICTIONS	OPERATION
NC 33	NO MORE THAN 3 CONSECUTIVE DAYS	FOR 72" PIPE INSTALL
NC 33	NO MORE THAN 1 NIGHT 8:00 PM TO 6:00 AM	CONCRETE REMOVAL AND REPLACE

### LANE AND SHOULDER CLOSURE REQUIREMENTS

- D) REMOVE LANE CLOSURE DEVICES FROM THE LANE WHEN WORK IS NOT BEING PERFORMED BEHIND THE LANE CLOSURE OR WHEN A LANE CLOSURE IS NO LONGER NEEDED OR AS DIRECTED BY THE ENGINEER.
- E) WHEN PERSONNEL AND/OR EQUIPMENT ARE WORKING WITHIN 15 FT OF AN OPEN TRAVEL LANE, CLOSE THE NEAREST OPEN SHOULDER USING ROADWAY STANDARD DRAWING NO. 1101.04 UNLESS THE WORK AREA IS PROTECTED BY BARRIER OR GUARDRAIL OR A LANE CLOSURE IS INSTALLED.

- F) WHEN PERSONNEL AND/OR EQUIPMENT ARE WORKING ON THE SHOULDER ADJACENT TO AN UNDIVIDED FACILITY AND WITHIN 5 FT OF AN OPEN TRAVEL LANE, CLOSE THE NEAREST OPEN TRAVEL LANE USING ROADWAY STANDARD DRAWING NO. 1101.02 UNLESS THE WORK AREA IS PROTECTED BY BARRIER OR GUARDRAIL.

WHEN PERSONNEL AND/OR EQUIPMENT ARE WORKING ON THE SHOULDER ADJACENT TO A DIVIDED FACILITY AND WITHIN 10 FT OF AN OPEN TRAVEL LANE, CLOSE THE NEAREST OPEN TRAVEL LANE USING ROADWAY STANDARD DRAWING NO. 1101.02 UNLESS THE WORK AREA IS PROTECTED BY BARRIER OR GUARDRAIL.

- G) WHEN PERSONNEL AND/OR EQUIPMENT ARE WORKING WITHIN A LANE OF TRAVEL OF AN UNDIVIDED OR DIVIDED FACILITY, CLOSE THE LANE ACCORDING TO THE TRAFFIC CONTROL PLANS, ROADWAY STANDARD DRAWINGS, OR AS DIRECTED BY THE ENGINEER. CONDUCT THE WORK SO THAT ALL PERSONNEL AND/OR EQUIPMENT REMAIN WITHIN THE CLOSED TRAVEL LANE.

- H) DO NOT WORK SIMULTANEOUSLY WITHIN 15 FT ON BOTH SIDES OF AN OPEN TRAVELWAY, RAMP, OR LOOP WITHIN THE SAME LOCATION UNLESS PROTECTED WITH GUARDRAIL OR BARRIER.

### PAVEMENT EDGE DROP OFF REQUIREMENTS

- I) BACKFILL AT A 6:1 SLOPE UP TO THE EDGE AND ELEVATION OF EXISTING PAVEMENT IN AREAS ADJACENT TO AN OPENED TRAVEL LANE THAT HAS AN EDGE OF PAVEMENT DROP-OFF AS FOLLOWS:

BACKFILL DROP-OFFS THAT EXCEED 2 INCHES ON ROADWAYS WITH POSTED SPEED LIMITS OF 45 MPH OR GREATER.

BACKFILL DROP-OFFS THAT EXCEED 3 INCHES ON ROADWAYS WITH POSTED SPEED LIMITS LESS THAN 45 MPH.

BACKFILL WITH SUITABLE COMPACTED MATERIAL, AS APPROVED BY THE ENGINEER, AT NO EXPENSE TO THE DEPARTMENT.

- J) DO NOT EXCEED A DIFFERENCE OF 2 INCHES IN ELEVATION BETWEEN OPEN LANES OF TRAFFIC FOR NOMINAL LIFTS OF 1.5 INCHES. INSTALL ADVANCE WARNING "UNEVEN LANES" SIGNS (W8-11) 350 FEET IN ADVANCE AND A MINIMUM OF EVERY HALF MILE THROUGHOUT THE UNEVEN AREA.

### TRAFFIC PATTERN ALTERATIONS

- K) NOTIFY THE ENGINEER ONE MONTH PRIOR TO ANY TRAFFIC PATTERN ALTERATION.

### SIGNING

- L) INSTALL ADVANCE WORK ZONE WARNING SIGNS WHEN WORK IS WITHIN 40 FT FROM THE EDGE OF TRAVEL LANE AND NO MORE THAN THREE (3) DAYS PRIOR TO THE BEGINNING OF CONSTRUCTION.
- M) PROVIDE SIGNING AND DEVICES REQUIRED TO CLOSE THE ROAD ACCORDING TO THE ROADWAY STANDARD DRAWINGS AND TRAFFIC CONTROL PLANS. PROVIDE SIGNING REQUIRED FOR THE OFF-SITE DETOUR ROUTE AS SHOWN IN THE TRAFFIC CONTROL PLANS.
- N) COVER OR REMOVE ALL SIGNS AND DEVICES REQUIRED TO CLOSE THE ROAD WHEN ROAD CLOSURE IS NOT IN OPERATION. COVER OR REMOVE ALL SIGNS REQUIRED FOR THE OFF-SITE DETOUR WHEN THE DETOUR IS NOT IN OPERATION.
- O) ENSURE ALL NECESSARY SIGNING IS IN PLACE PRIOR TO ALTERING ANY TRAFFIC PATTERN.

### TRAFFIC CONTROL DEVICES

- P) PLACE TYPE III BARRICADES, WITH "ROAD CLOSED" SIGN R11-2 ATTACHED, OF SUFFICIENT LENGTH TO CLOSE ENTIRE ROADWAY.

### PAVEMENT MARKINGS AND MARKERS

- Q) INSTALL TEMPORARY PAVEMENT MARKINGS AND TEMPORARY PAVEMENT MARKERS ON INTERIM LAYERS OF PAVEMENT AS FOLLOWS:

ROAD NAME	MARKING	MARKER
NC 33	PAINT	TEMPORARY RAISED

- R) PLACE ONE APPLICATION OF PAINT FOR TEMPORARY TRAFFIC PATTERNS. PLACE A SECOND APPLICATION OF PAINT SIX (6) MONTHS AFTER THE INITIAL APPLICATION AND EVERY SIX MONTHS AS DIRECTED BY THE ENGINEER.
- S) TIE PROPOSED PAVEMENT MARKING LINES TO EXISTING PAVEMENT MARKING LINES.
- T) REMOVE/REPLACE ANY CONFLICTING/DAMAGED PAVEMENT MARKINGS AND MARKERS BY THE END OF EACH DAY'S OPERATION.
- U) TRACE THE PROPOSED MONOLITHIC ISLAND LOCATIONS WITH PROPER COLOR PAVEMENT MARKINGS PRIOR TO INSTALLATION. PLACE (DRUMS) TO DELINEATE ANY PROPOSED MONOLITHIC ISLANDS.

### MISCELLANEOUS

- V) IN THE EVENT A TIE-IN CANNOT BE MADE IN ONE DAY'S TIME, BRING THE TIE-IN AREA TO AN APPROPRIATE ROADWAY ELEVATION AS DETERMINED BY THE ENGINEER. PLACE BLACK ON ORANGE "LOOSE GRAVEL" SIGNS (W8-7) AND BLACK ON ORANGE "PAVEMENT ENDS" SIGNS (W8-3) (1000 FEET) AND (500 FEET) RESPECTIVELY IN ADVANCE OF THE UNEVEN AREAS. USE DRUMS TO DELINEATE THE EDGE OF ROADWAY ALONG UNPAVED AREAS.

3/30/2020 X:\2014\RO14\003\00\_B-5301\TrafficControl\TCP\B-5301 TMP-IB.dgn jbauman



APPROVED: \_\_\_\_\_  
DATE: \_\_\_\_\_

SEAL

DOCUMENT NOT CONSIDERED FINAL  
UNLESS ALL SIGNATURES COMPLETED

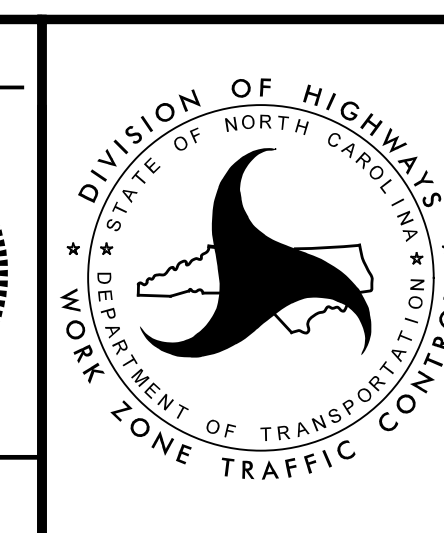

## MANAGEMENT STRATEGIES

CONTRACTOR SHALL HAVE AVAILABLE (2) CHANGEABLE MESSAGE BOARDS (CMS) TO BE UTILIZED FOR PUBLIC INFORMATION 2 WEEKS PRIOR TO THE CLOSURE OF NC 33, AS DIRECTED BY THE ENGINEER.

### PHASE I

- BEGIN CONSTRUCTION AWAY FROM TRAFFIC, INCLUDING PROPOSED DRAINAGE.
- CONSTRUCT -DR2- AND TIE-INS AND SHIFT TRAFFIC TO PROPOSED -DR2-.
- UNDER AN ICT, CLOSE -L- (NC 33), CONSTRUCT PROPOSED 72" PIPE, AND RE-OPEN TO TRAFFIC.
- AWAY FROM TRAFFIC, USING LANE CLOSURES AND ROAD CLOSURES AS NEEDED:
  - COMPLETE CONSTRUCTION OF PROPOSED ROADWAY, BRIDGE AND APPROACHES.
  - SAW CUT AREA OF CONCRETE REMOVAL.
  - UNDER AN ICT, CLOSE -L- (NC 33), REMOVE AND REPLACE CONCRETE SECTION.
  - CONSTRUCT PROPOSED ROADWAY TIE-INS.
- PLACE TEMPORARY PAVEMENT MARKINGS AND MARKERS AND SHIFT TRAFFIC TO THE PHASE II PATTERN. (TMA WILL BE REQUIRED UNTIL GUARDRAIL REMOVAL CAN BE COMPLETED).

### PHASE II

- BEGIN REMOVAL OF EXISTING BRIDGE AND ROADWAY.
- USING LANE CLOSURES, WEDGE REMAINDER OF PROJECT, PLACE TEMPORARY PAVEMENT MARKINGS AND MARKERS.
- USING LANE CLOSURES AND FLAGGERS, AS NEEDED, CONSTRUCT PROPOSED MONOLITHIC ISLAND AT -Y1-.
- COMPLETE REMOVAL OF EXISTING BRIDGE AND ROADWAY AND COMPLETE REMAINDER OF CONSTRUCTION.
- USING LANE CLOSURES, PLACE FINAL LAYER OF SURFACE COURSE AND PLACE FINAL PAVEMENT MARKINGS ACCORDING TO THE PAVEMENT MARKING PLAN.
- REMOVE ALL WORK ZONE TRAFFIC CONTROL DEVICES.

## PHASING

NOTE: THE CONTRACTOR SHALL HAVE AVAILABLE (2) CHANGEABLE MESSAGE BOARDS (CMS) TO BE UTILIZED FOR PUBLIC INFORMATION 2 WEEKS PRIOR TO THE CLOSURE OF NC 33, AS DIRECTED BY THE ENGINEER.

### PHASE I

(SEE SHEETS TMP-4 THRU TMP-6)

- STEP 1: - USING RSD 1101.01 SHEET 3 OF 3, INSTALL ADVANCE WARNING SIGNS.
- STEP 2: - AWAY FROM TRAFFIC AND USING RSD 1101.02, SHEET 1 OF 14, AS NEEDED PERFORM THE FOLLOWING:
  - BEGIN CONSTRUCTION OF PROPOSED ROADWAY, BRIDGE AND APPROACHES FROM -L- STA 15+25+/- TO STA 35+00+/-, INCLUDING PROPOSED DRAINAGE.
  - CONSTRUCT -DR2- AND TIE-INS, UP TO THE EDGE AND ELEVATION OF EXISTING AND SHIFT TRAFFIC TO PROPOSED -DR2-.

THE CONTRACTOR SHALL PERFORM PHASE I, STEP 3 IN 3 CONSECUTIVE DAYS. (SEE INTERMEDIATE CONTRACT TIMES AND LIQUIDATED DAMAGES).

- STEP 3: - USING RSD 1101.03 SHEET 1 OF 9 AND OFF-SITE DETOUR AS SHOWN ON SHEETS TMP-10 & TMP-11, CLOSE -L- (NC 33) TO TRAFFIC.
  - CONSTRUCT PROPOSED 72" PIPE, PLACE TEMPORARY PAVEMENT MARKINGS IN THE EXISTING PATTERN AND OPEN TO TRAFFIC.
- STEP 4: - AWAY FROM TRAFFIC AND USING RSD 1101.02, SHEET 1 OF 14 AND OFF-SITE DETOUR, AS NEEDED, PERFORM STEPS 4A THRU 4D.
  - STEP 4A: - COMPLETE CONSTRUCTION OF PROPOSED ROADWAY, BRIDGE AND APPROACHES FROM -L- STA 15+25+/- TO STA 35+00+/-, UP TO, BUT NOT INCLUDING THE FINAL LAYER OF SURFACE COURSE.

NOTE: TMA WILL BE REQUIRED UNTIL GUARDRAIL REMOVAL CAN BE COMPLETED.

- STEP 4B: - SAW CUT AREA OF CONCRETE PAVEMENT REMOVAL -L- STA 13+60+/-

THE CONTRACTOR SHALL PERFORM PHASE I, STEP 4C IN 1 NIGHT, BETWEEN THE HOURS OF 8:00 PM AND 6:00 AM. (SEE INTERMEDIATE CONTRACT TIMES AND LIQUIDATED DAMAGES).

- STEP 4C: - USING RSD 1101.03, SHEET 1 OF 9 AND OFF-SITE DETOUR AS SHOWN ON SHEETS TMP-12 & TMP-13. CLOSE -L- (NC 33) TO TRAFFIC.
  - REMOVAL AND REPLACE CONCRETE SECTION.
- STEP 4D: - CONSTRUCT PROPOSED ROADWAY TIE-INS FROM -L- STA 14+50+/- TO STA 15+25+/- AND FROM STA 35+00+/- TO STA 39+00+/- UP TO THE EDGE AND ELEVATION OF EXISTING.
- STEP 5: - PLACE TEMPORARY PAVEMENT MARKINGS AND MARKERS AND SHIFT TRAFFIC TO THE PHASE II PATTERN. (SEE SHEETS TMP-7 THRU TMP-9).

3/30/2020 X:\2014\RO14\003\00\_B-5301\Traffic\TrafficControl\TCP\B-5301 TMP-3.dgn jbauman

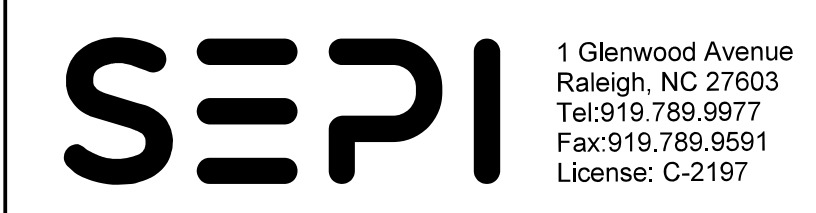

APPROVED: \_\_\_\_\_  
 DATE: \_\_\_\_\_

SEAL

**DOCUMENT NOT CONSIDERED FINAL  
UNLESS ALL SIGNATURES COMPLETED**

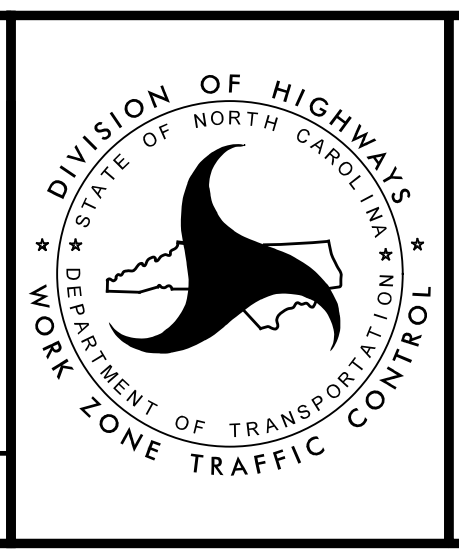

**MANAGEMENT STRATEGIES  
AND TEMPORARY  
TRAFFIC CONTROL  
PHASING**

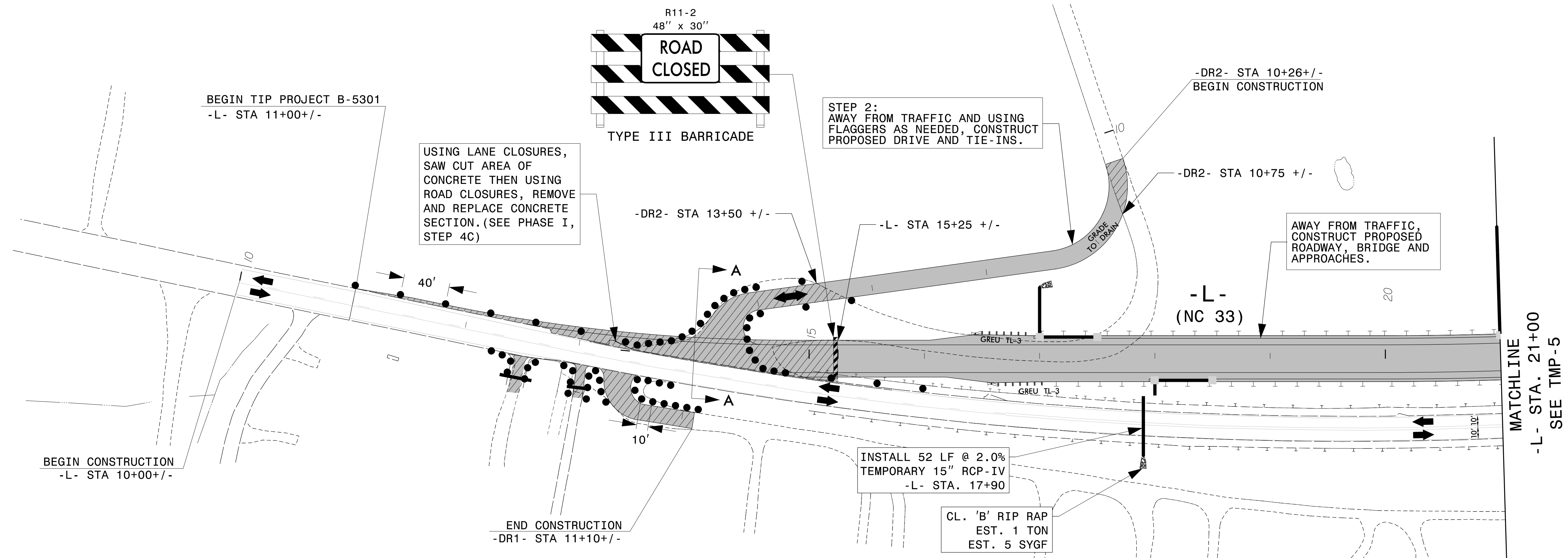
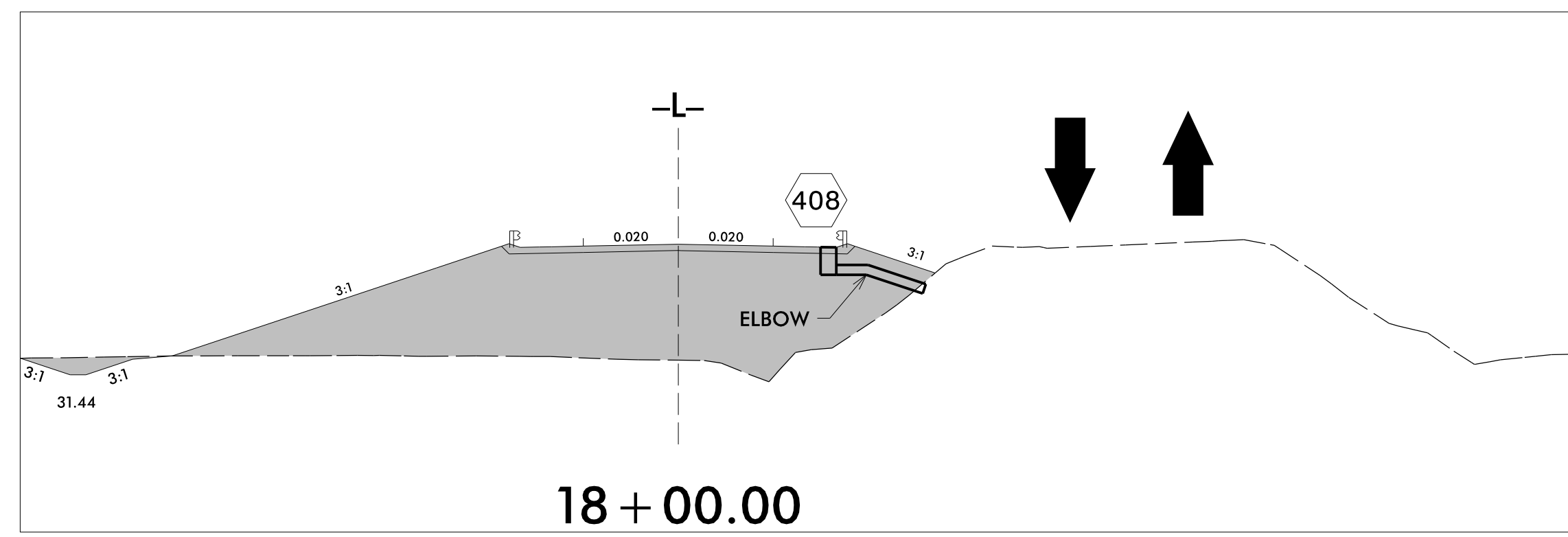
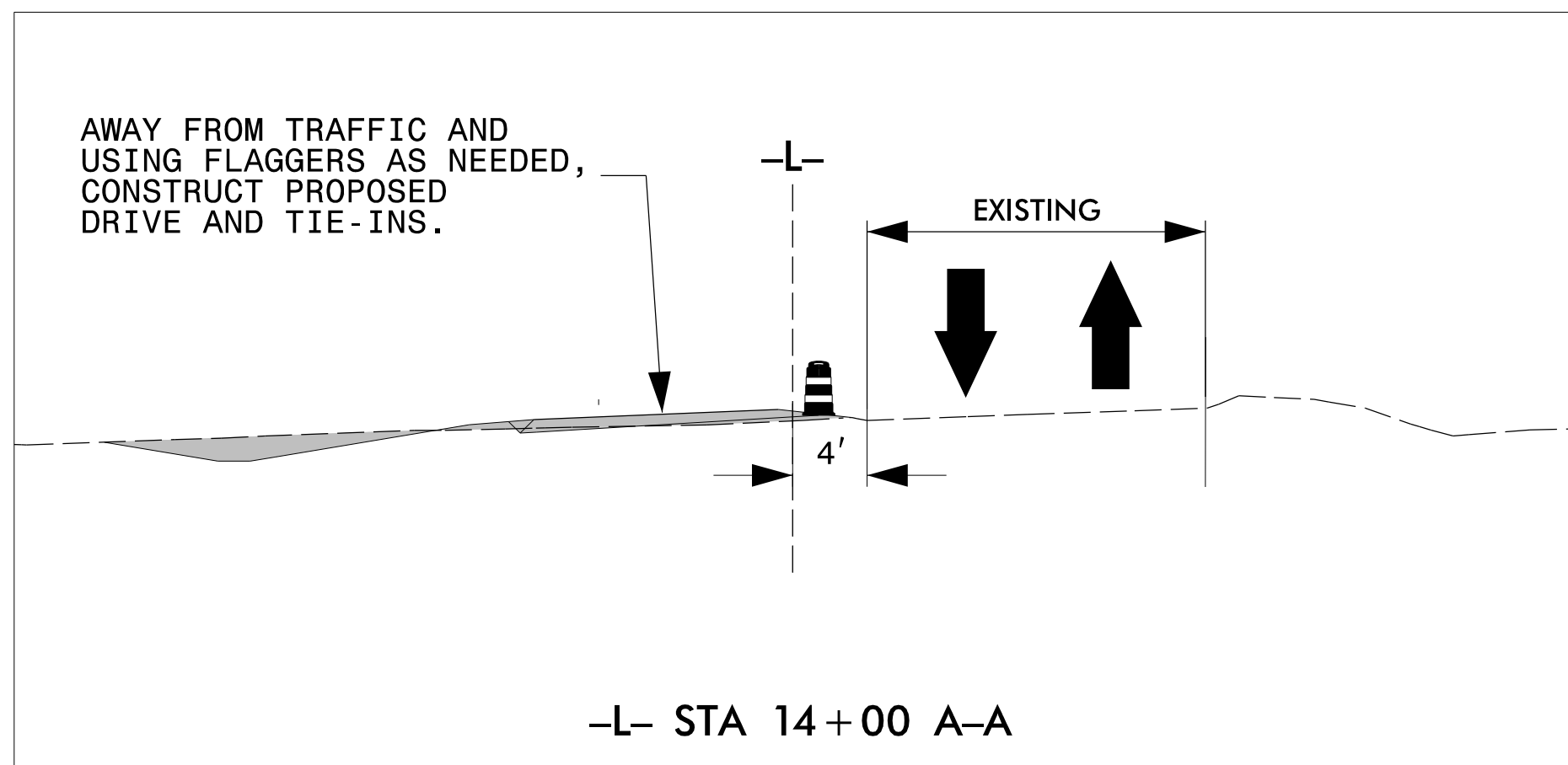

SEQUENCE FOR STORM DRAINAGE CONSTRUCTION STRUCTURES 0408, 0409, 0410

PHASE 1

1. CONSTRUCT DRAINAGE STRUCTURES 0408 AND 0410, INCLUDING APPROXIMATELY 12 LF OF PERMANENT 15" PIPE FROM 0408 TO 0409.
2. INSTALL TEMPORARY LIDS ON DRAINAGE STRUCTURES 0408 AND 0410. UTILIZE SAND BAGS AND TEMPORARY SLOPE DRAINS TO DIVERT RUNOFF FROM 0408 AND 0410 DOWN SLOPE TO LOW POINT BETWEEN EXISTING AND PROPOSED NC HIGHWAY 33.
3. INSTALL TEMPORARY 15" RCP-IV, 52 LF @ 2%, APPROXIMATE -L- STA. 17+90 TO PROVIDE RELIEF FOR RUNOFF TRAPPED BETWEEN ALIGNMENTS. INSTALL TEMPORARY PIPE UNDER TEMPORARY CLOSURE. TEMPORARY PIPE SHOULD BE INSTALLED AT APPROXIMATE ELEVATION 44.1 ON THE UPSTREAM SIDE. ELEVATION SHALL BE FIELD ADJUSTED TO ENSURE POSITIVE DRAINAGE. STABILIZE TEMPORARY OUTLET WITH AN ESTIMATED 1 TON CLASS 'B' RIP RAP AND 5 SY GEOTEXTILE FOR DRAINAGE.

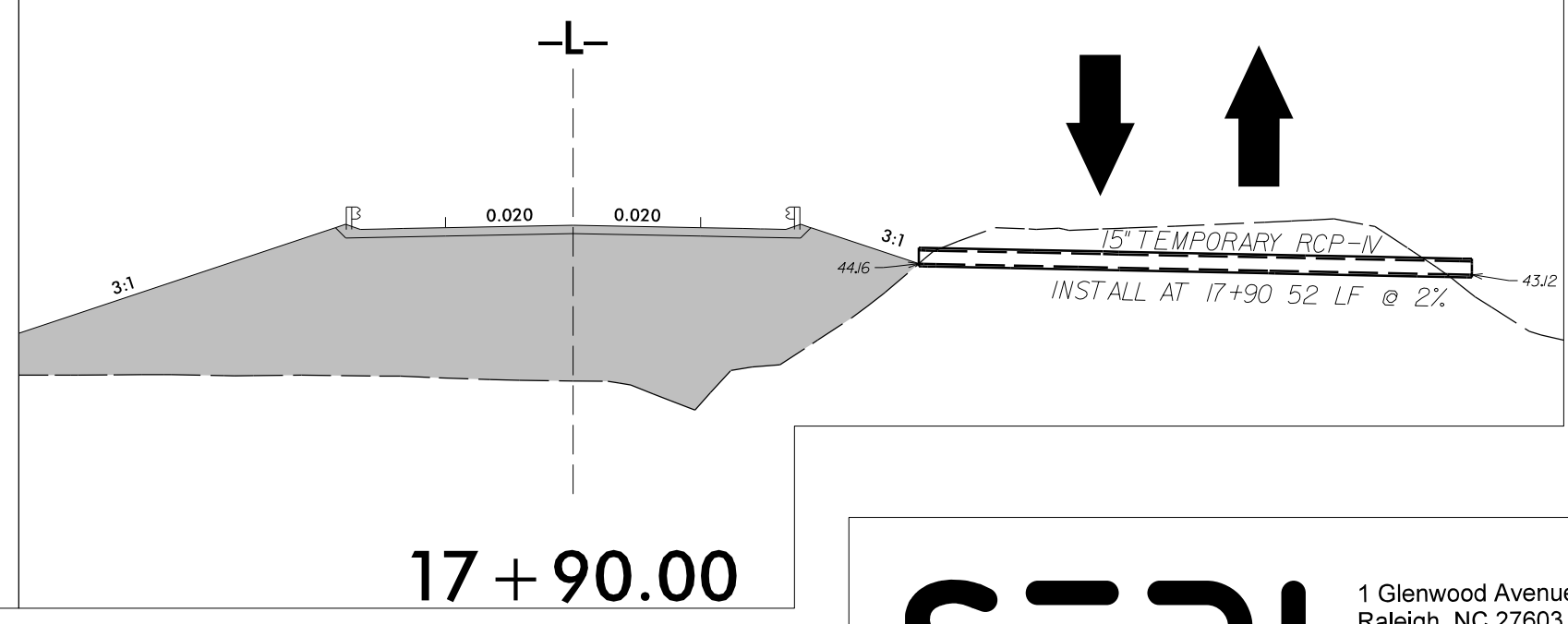

**SEPI**

1 Glenwood Avenue  
Raleigh, NC 27603  
Tel: 919.789.9977  
Fax: 919.789.9591  
License: C-2197

APPROVED: \_\_\_\_\_

DATE: \_\_\_\_\_

SEAL

DOCUMENT NOT CONSIDERED FINAL  
UNLESS ALL SIGNATURES COMPLETED

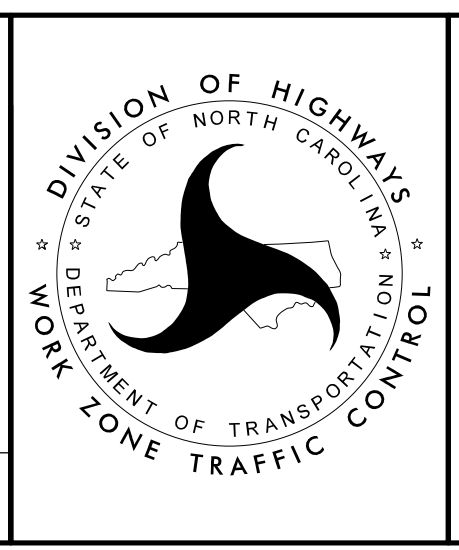

TEMPORARY  
TRAFFIC CONTROL  
PHASE I

5/12/2022  
X:\2014\04\003\00\_B-5301\TrafficControl\TCP\B-5301 TMP-4.dgn  
User:SWMiller

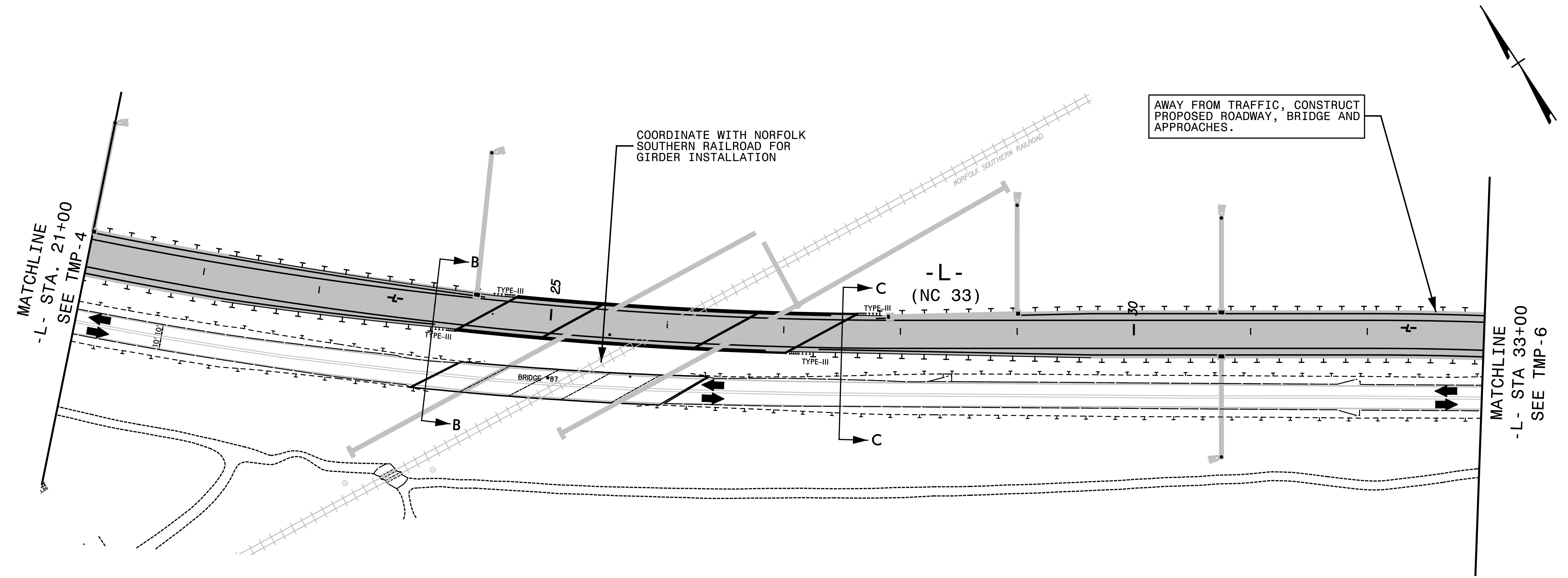
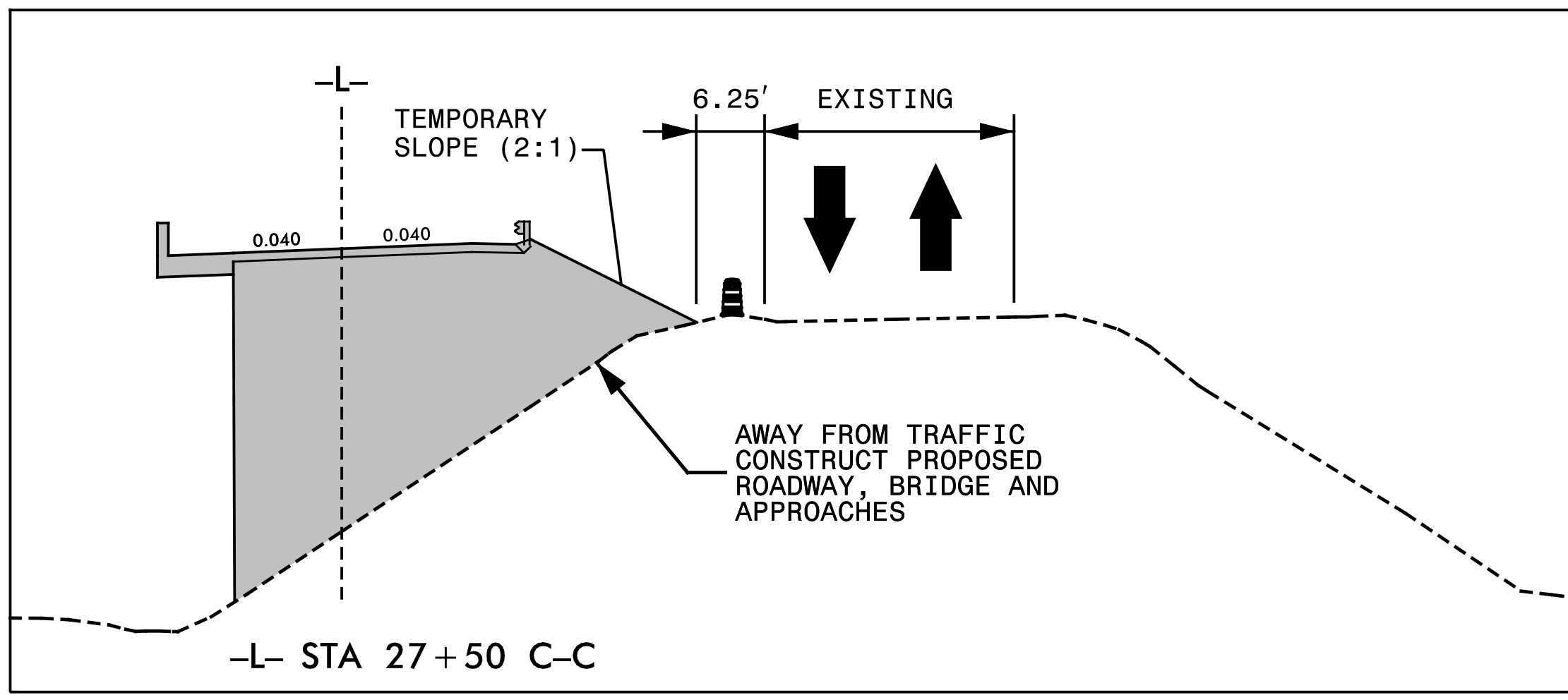
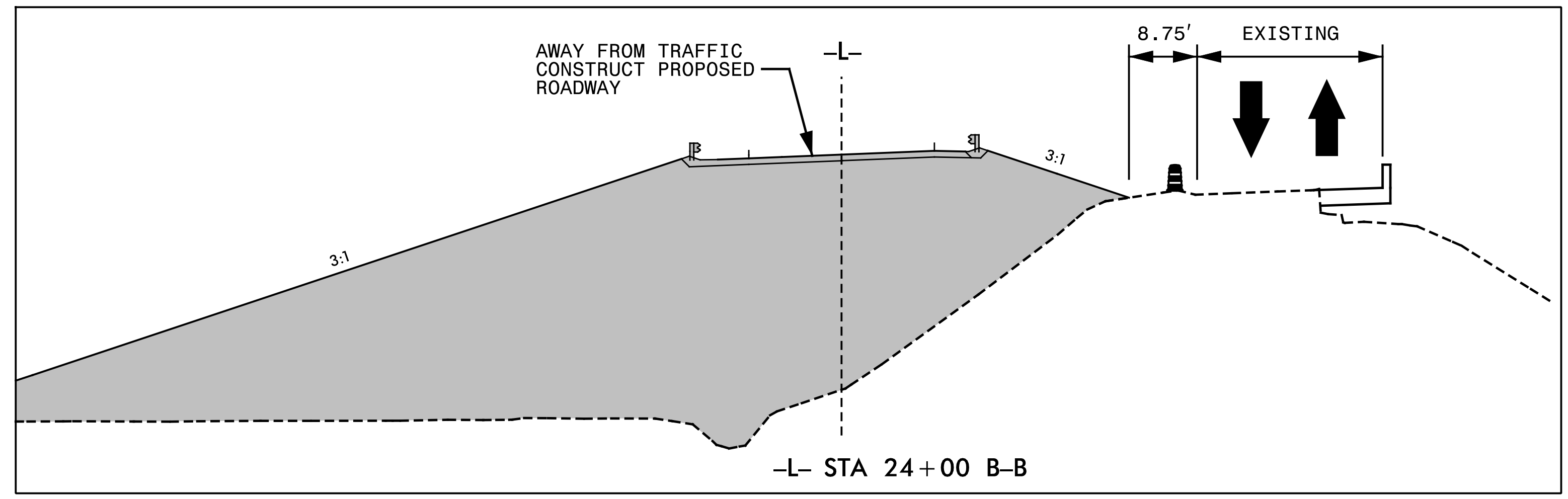

3/30/2020  
 X:\2014\04\003\00\_B-5301\Traffic\TrafficControl\TCP\_B-5301 TMP-5.dgn  
 jbauman

**SEPI**

1 Glenwood Avenue  
 Raleigh, NC 27603  
 Tel: 919.789.9977  
 Fax: 919.789.9591  
 License: C-2197

APPROVED: \_\_\_\_\_

DATE: \_\_\_\_\_

SEAL

DOCUMENT NOT CONSIDERED FINAL  
 UNLESS ALL SIGNATURES COMPLETED

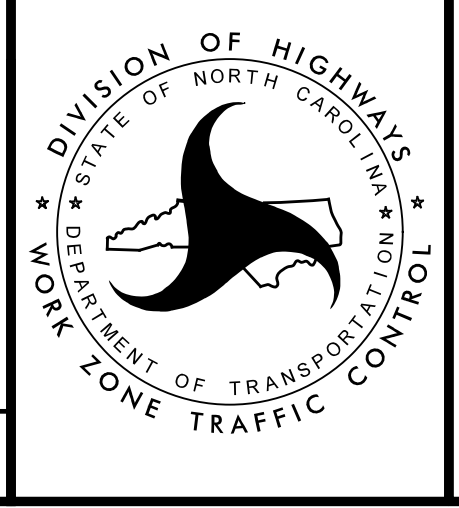

TEMPORARY  
 TRAFFIC CONTROL  
 PHASE I

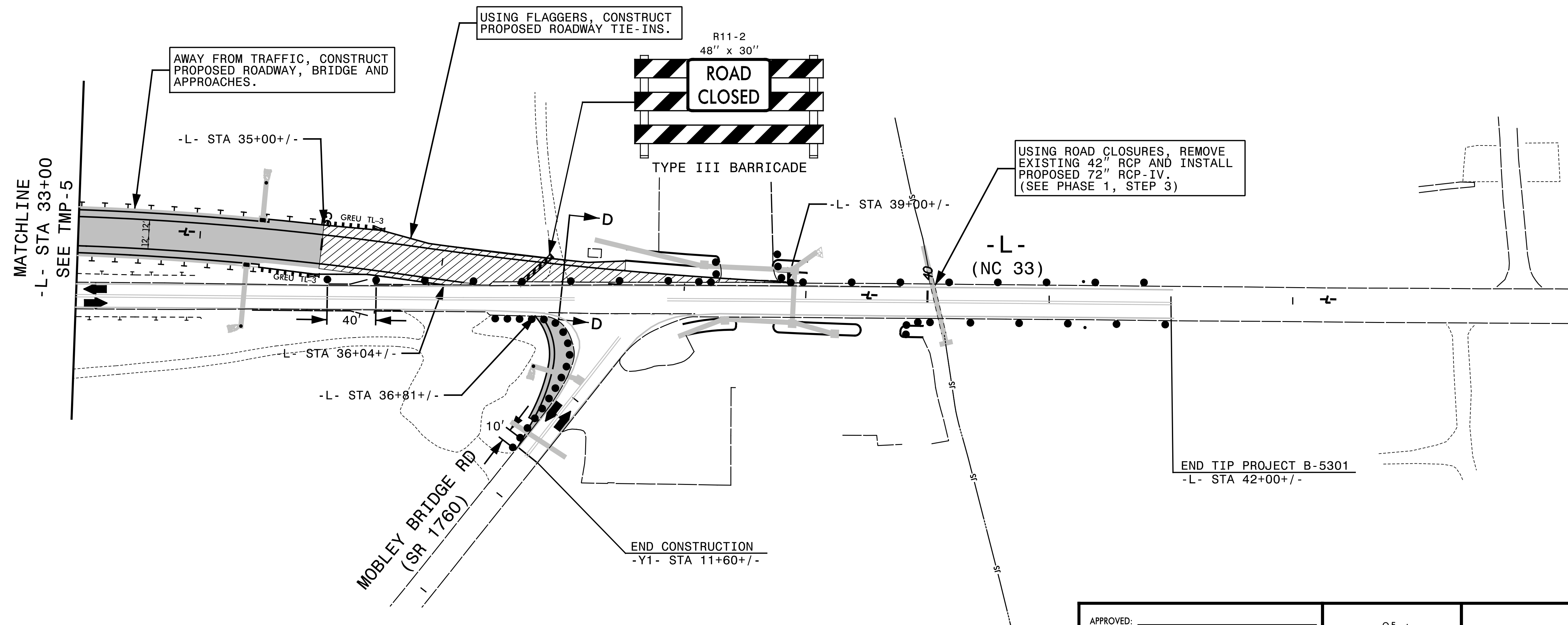
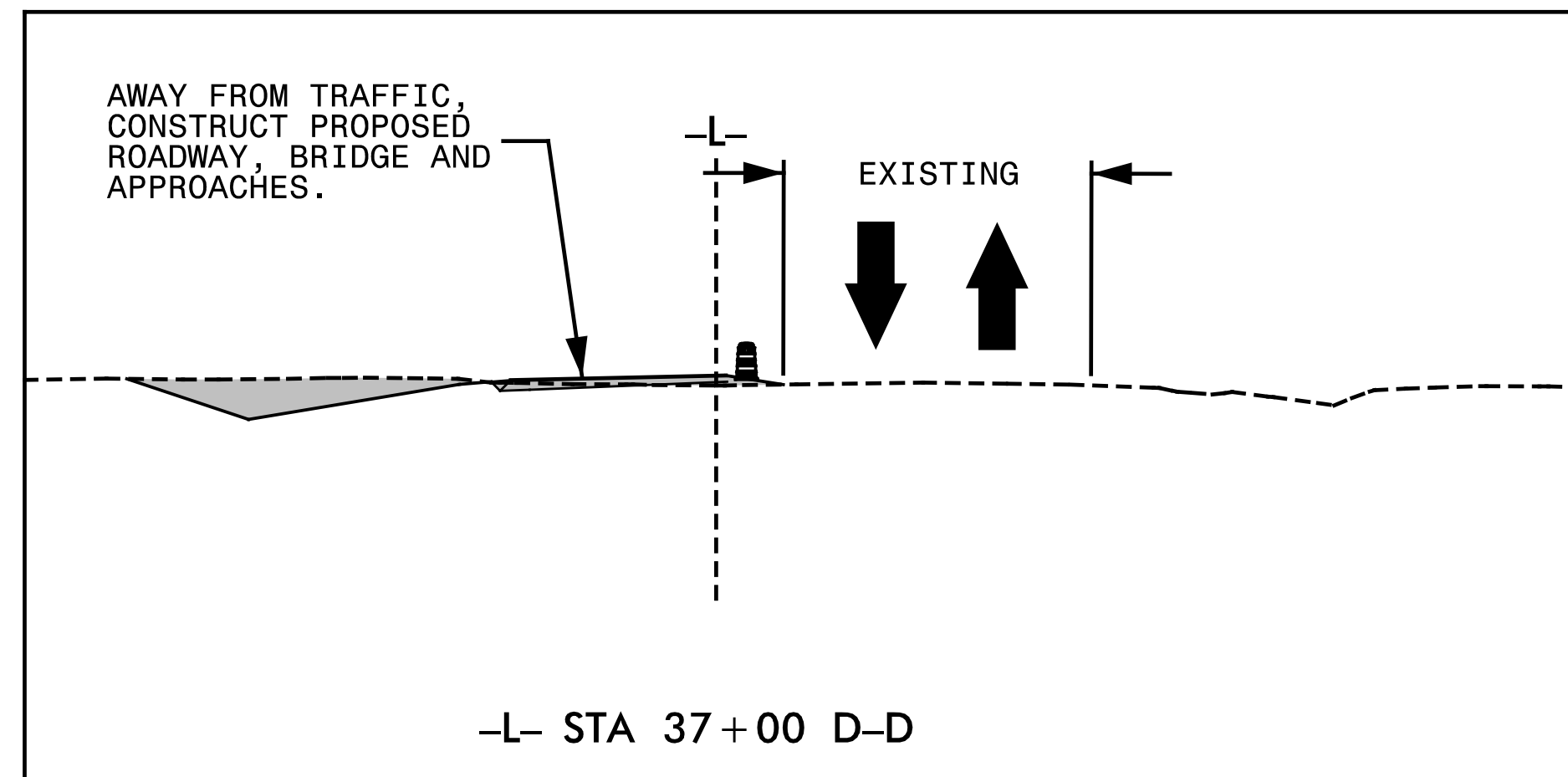

3/30/2020  
 X:\2014\04\003\00\_B-5301\Traffic\TrafficControl\TCP\B-5301 TMP-6.dgn  
 jbauman

**SEPI**  
 1 Glenwood Avenue  
 Raleigh, NC 27603  
 Tel: 919.789.9977  
 Fax: 919.789.9591  
 License: C-2197

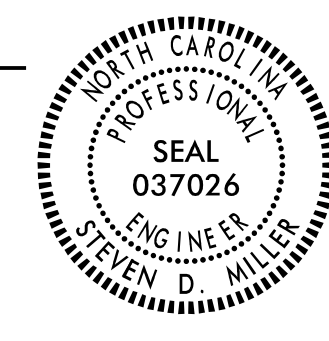
APPROVED: \_\_\_\_\_  
 DATE: \_\_\_\_\_  
 SEAL  
  
**DOCUMENT NOT CONSIDERED FINAL  
UNLESS ALL SIGNATURES COMPLETED**

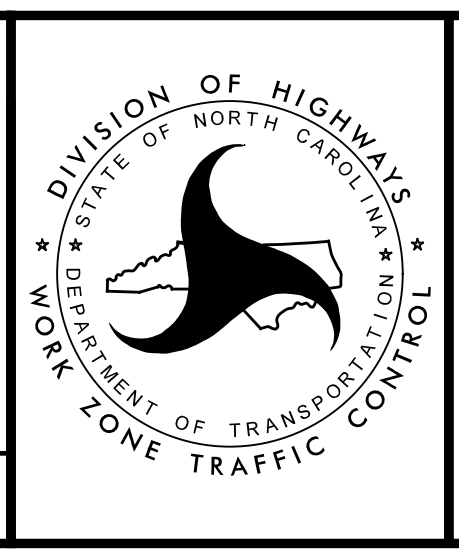

**TEMPORARY  
TRAFFIC CONTROL  
PHASE I**



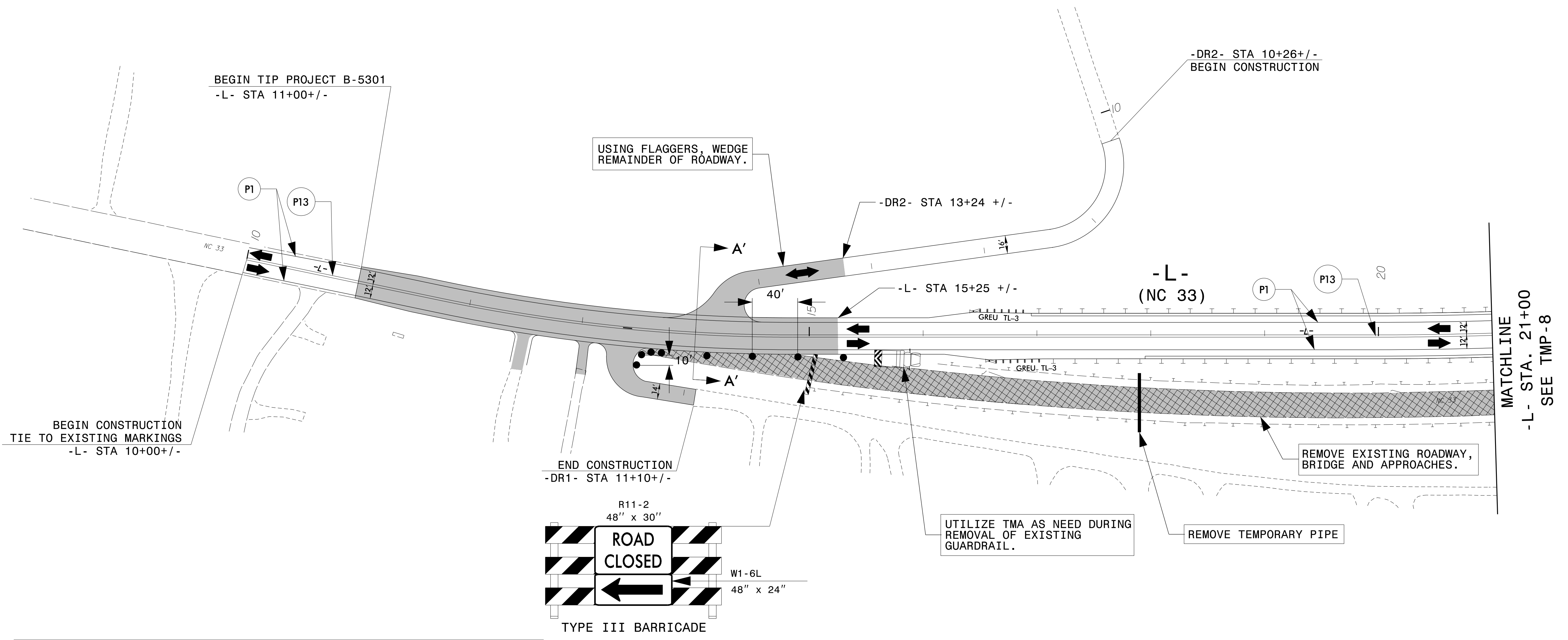
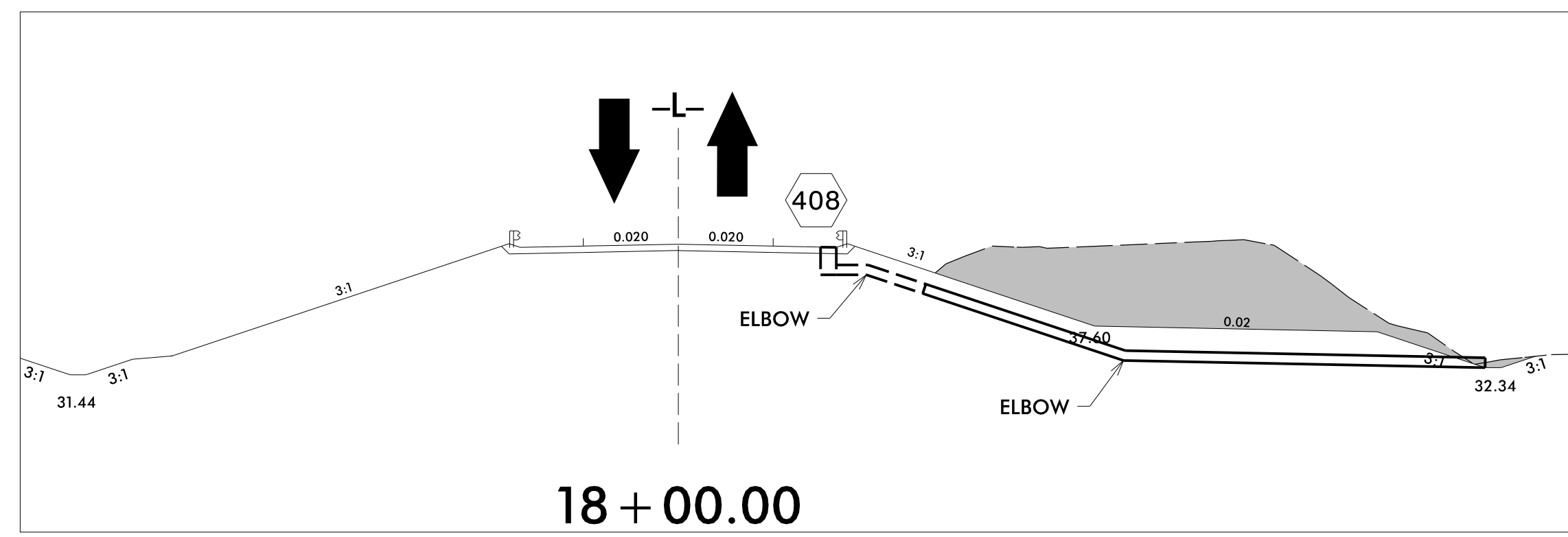
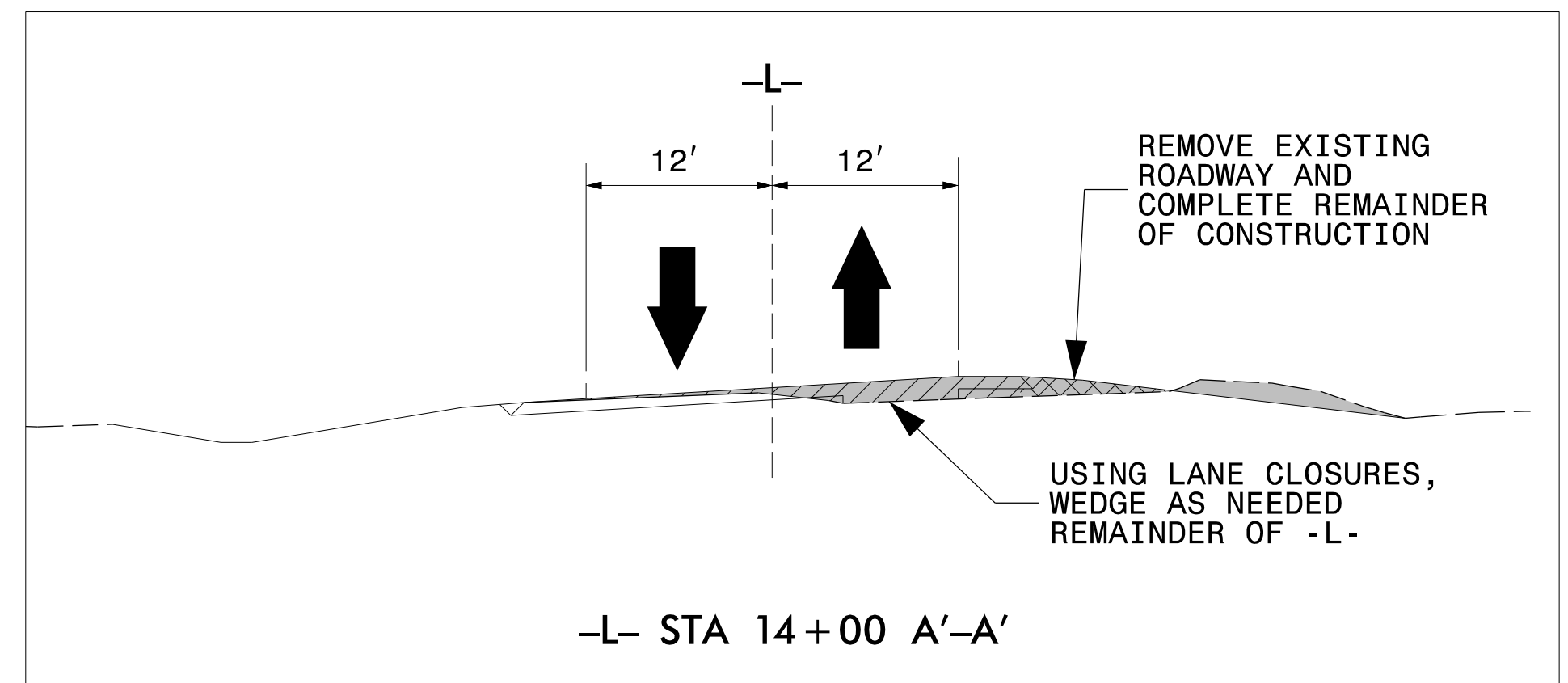

SEQUENCE FOR STORM DRAINAGE CONSTRUCTION STRUCTURES 0408, 0409, 0410

PHASE 2

1. ONCE TRAFFIC IS ON PROPOSED NC HIGHWAY 33, REMOVE EXISTING FILL PER ROADWAY PLANS AND CONSTRUCT REMAINDER OF PERMANENT 15" PIPE FROM PHASE LINE TO 0409. REMOVE TEMPORARY 15" RCP-IV WITH EXISTING HIGHWAY FILL.
2. REMOVE TEMPORARY DRAINAGE STRUCTURE LIDS, SAND BAGS, AND SLOPE DRAINS UPON COMPLETION OF PIPE FROM 0408 TO 0409, OR AT THE DIRECTION OF THE ENGINEER.

**SEPI**

1 Glenwood Avenue  
Raleigh, NC 27603  
Tel: 919.789.9977  
Fax: 919.789.9591  
License: C-2197

APPROVED: \_\_\_\_\_

DATE: \_\_\_\_\_

SEAL

DOCUMENT NOT CONSIDERED FINAL  
UNLESS ALL SIGNATURES COMPLETED

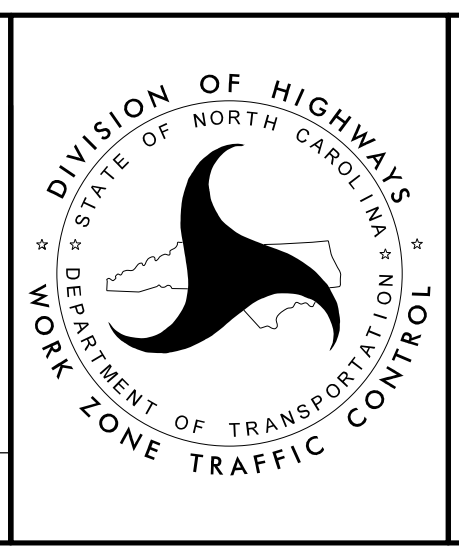

TEMPORARY TRAFFIC CONTROL PHASE II

5/12/2022 X:\2014\RO4\003\00\_B-5301\TrafficControl\TCP\_B-5301 TMP-7.dgn User:SMiller

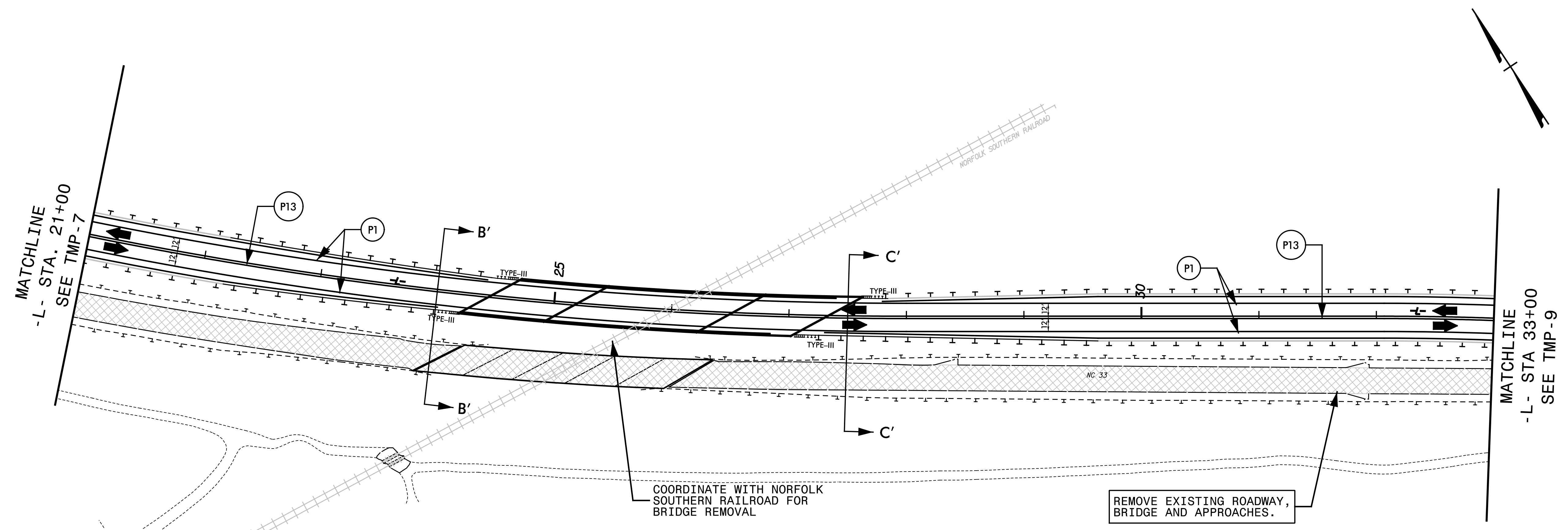
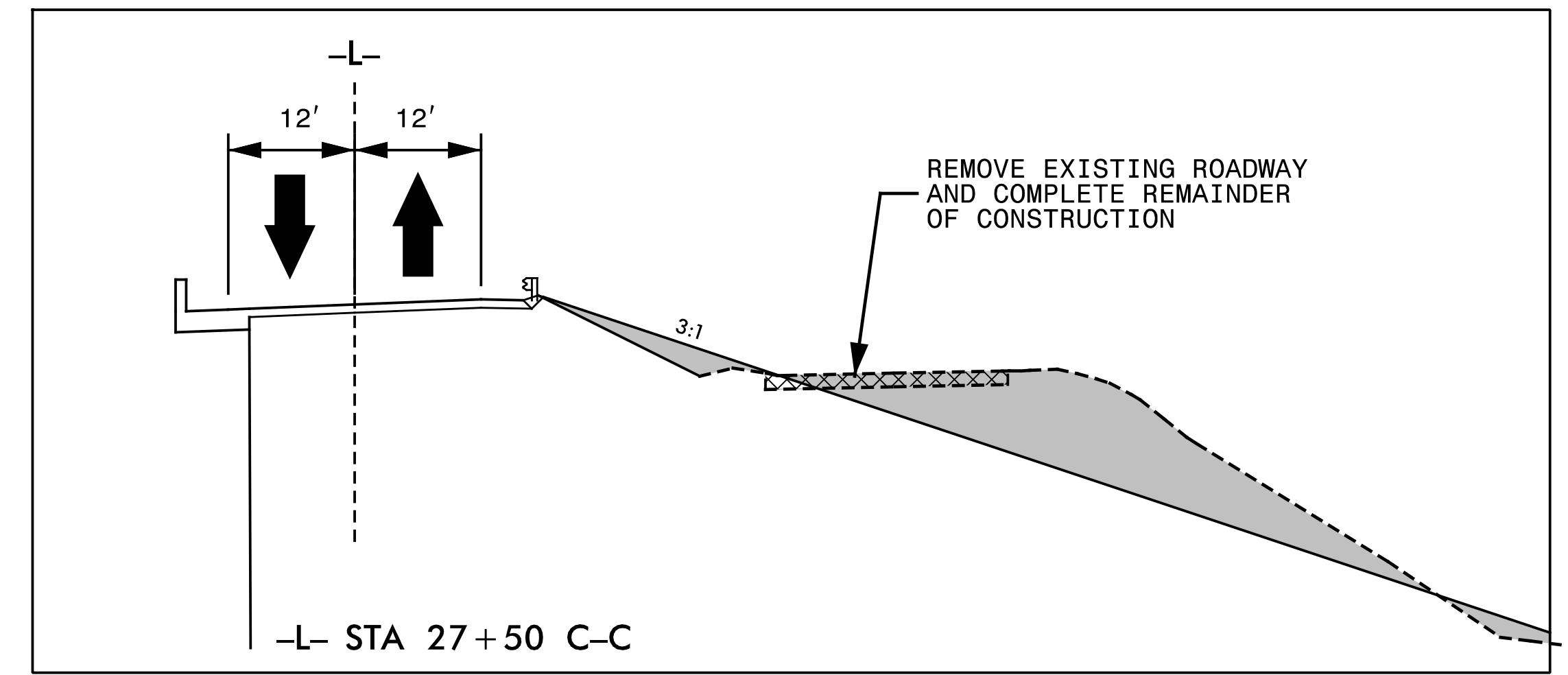
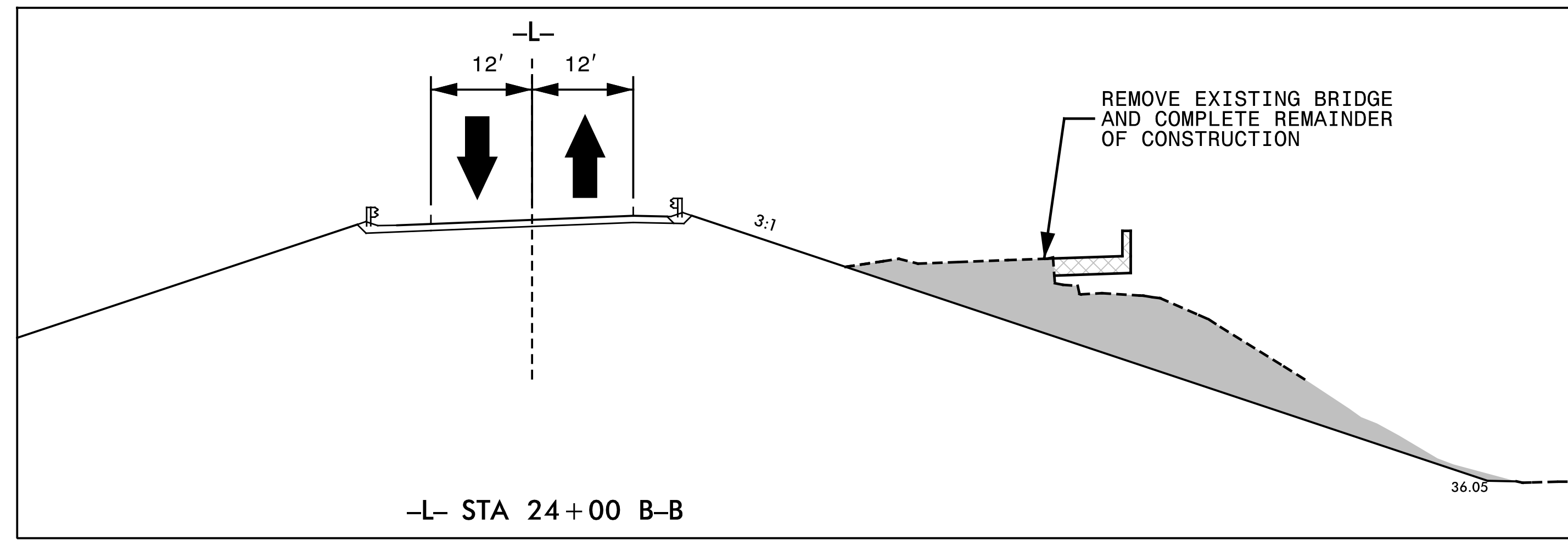

3/30/2020 X:\2014\04\003\00\_B-5301\Traffic\TrafficControl\TCP\B-5301 TMP-8.dgn jbauman

**SEPI**  
 1 Glenwood Avenue  
 Raleigh, NC 27603  
 Tel: 919.789.9977  
 Fax: 919.789.9591  
 License: C-2197

APPROVED: \_\_\_\_\_  
 DATE: \_\_\_\_\_

SEAL

**SEAL**  
 NORTH CAROLINA  
 PROFESSIONAL  
 ENGINEER  
 037026  
 STEVEN D. MILLER

**DOCUMENT NOT CONSIDERED FINAL  
 UNLESS ALL SIGNATURES COMPLETED**

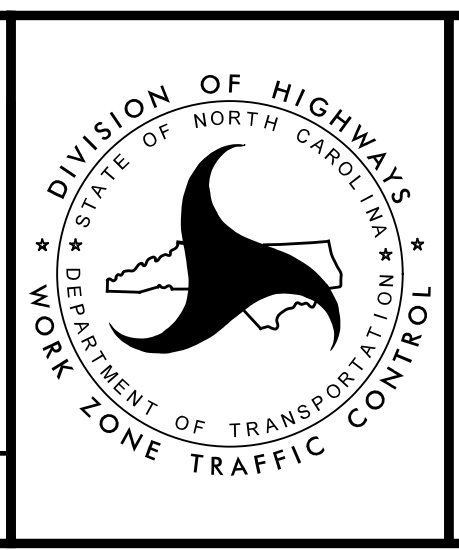

**TEMPORARY  
 TRAFFIC CONTROL  
 PHASE II**

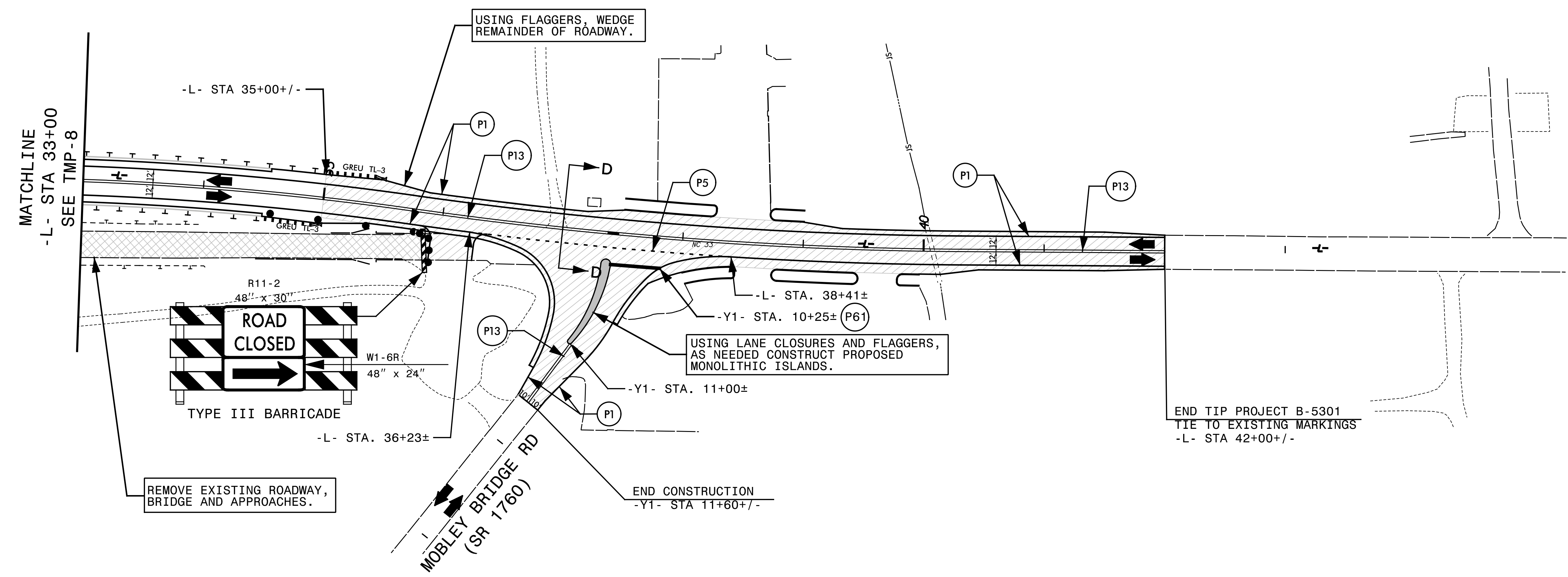
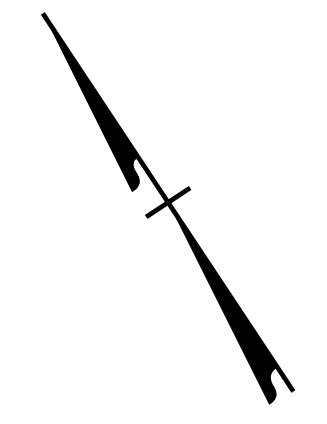
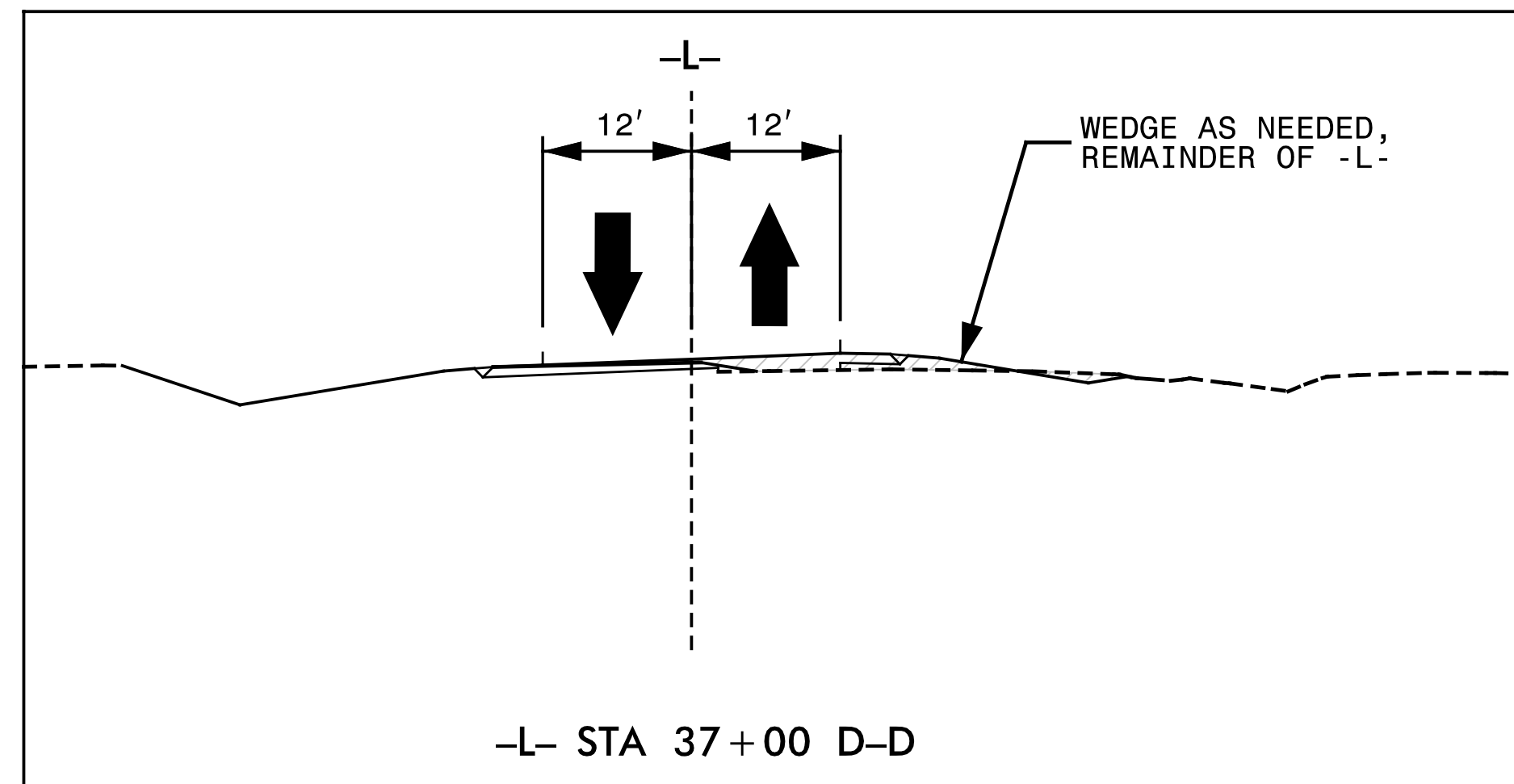

3/30/2020  
 X:\2014\04\003\00\_B-5301\TrafficControl\TCP\B-5301 TMP-9.dgn  
 jbauman

**SEPI**  
 1 Glenwood Avenue  
 Raleigh, NC 27603  
 Tel: 919.789.9977  
 Fax: 919.789.9591  
 License: C-2197

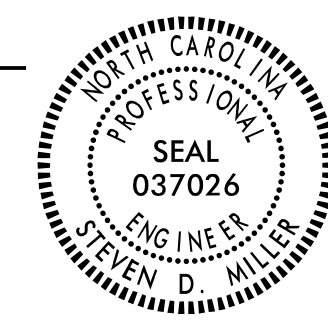
APPROVED: \_\_\_\_\_  
 DATE: \_\_\_\_\_  
 SEAL  
  
**DOCUMENT NOT CONSIDERED FINAL  
 UNLESS ALL SIGNATURES COMPLETED**

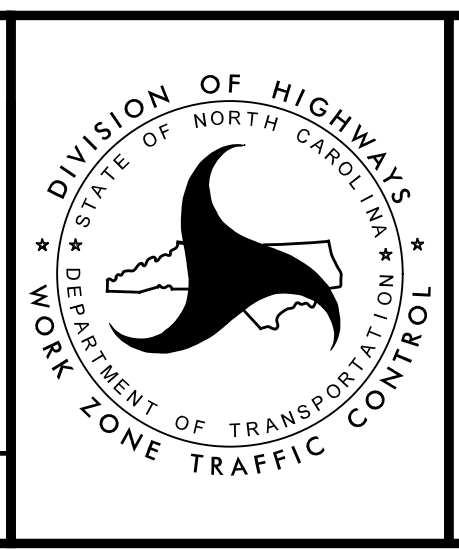

**TEMPORARY  
 TRAFFIC CONTROL  
 PHASE II**

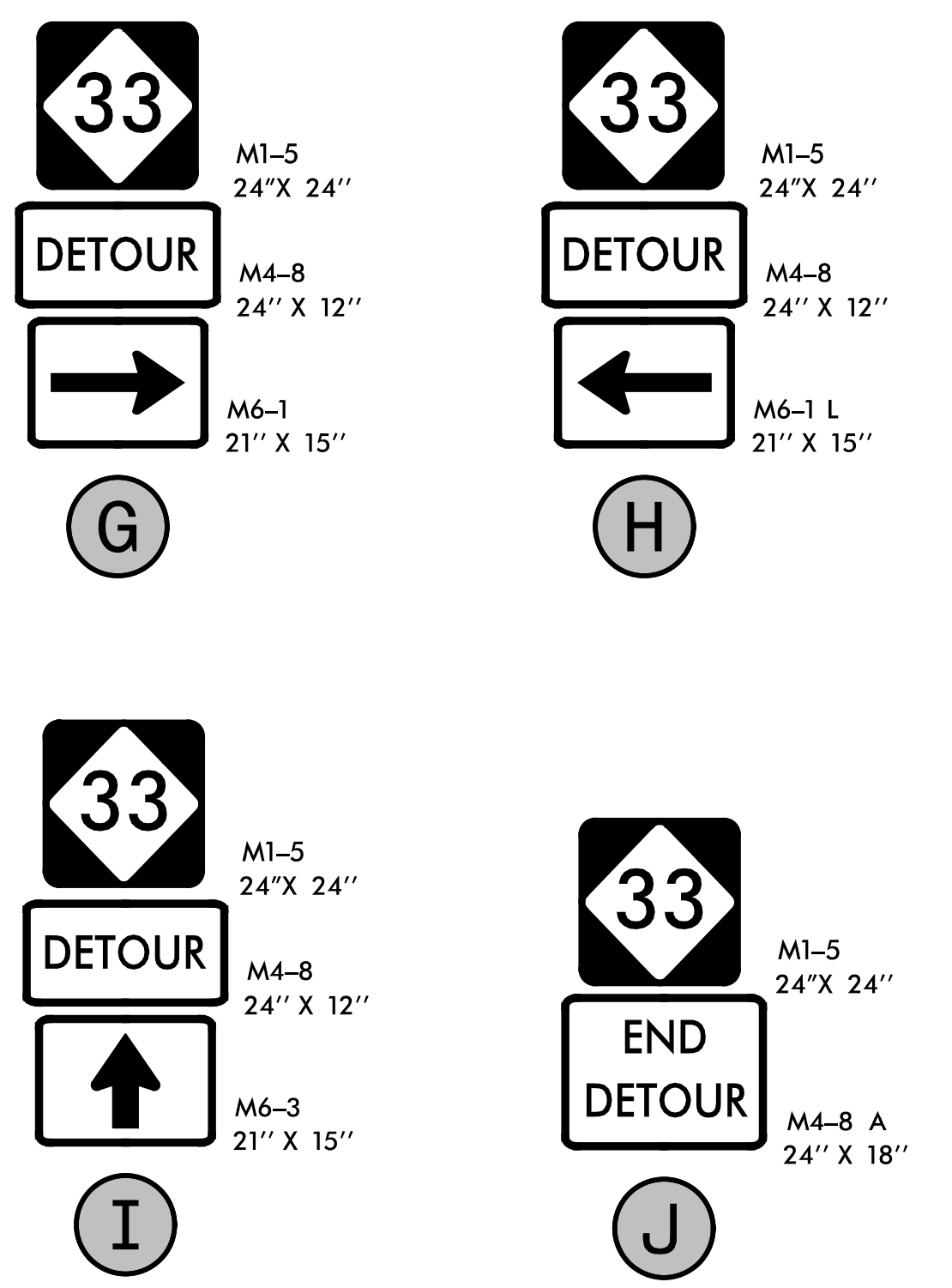
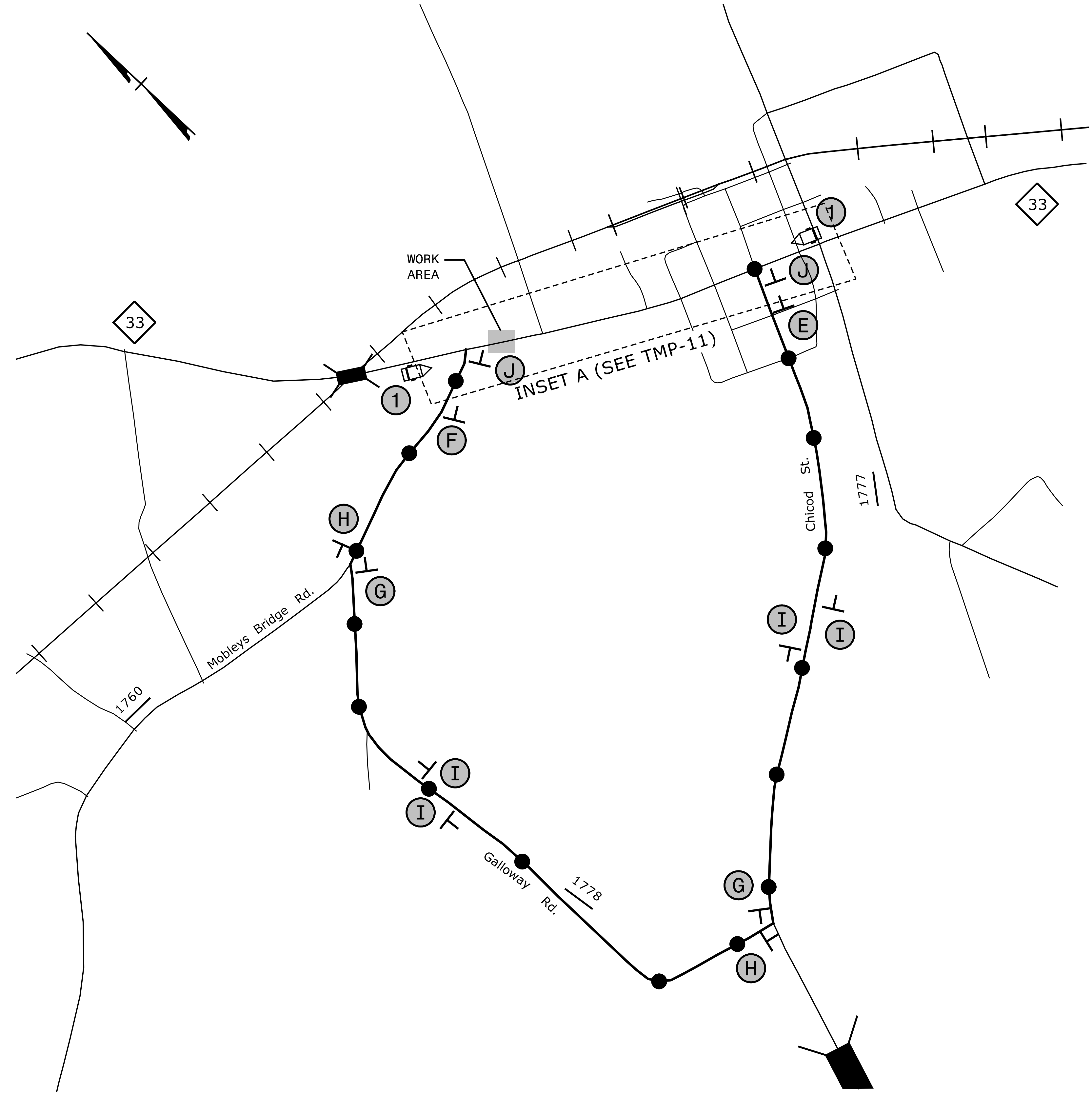

NOTES:

- THE CONTRACTOR SHALL HAVE AVAILABLE (2) CHANGEABLE MESSAGE BOARDS (CMS) TO BE UTILIZED FOR PUBLIC INFORMATION 2 WEEKS PRIOR TO THE CLOSURE OF NC 33, AS DIRECTED BY THE ENGINEER.
- SEE TMP-11 FOR ROAD CLOSURE

1	MESSAGE NO. 1	MESSAGE NO. 2	* PLACE 2 WEEKS PRIOR TO THE CLOSURE OF NC 33. LOCATION AND MESSAGE SHALL BE VERIFIED BY THE ENGINEER.
	NC 33 ROAD CLOSED	XX/XX/XX TO XX/XX/XX	
	CHANGEABLE MESSAGE SIGN		

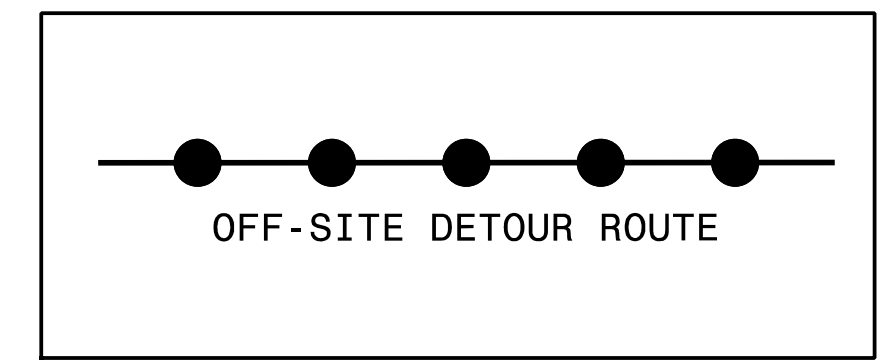

3/30/2020 X:\2014\04\003\00\_B-5301\TrafficControl\TCP\B-5301 TMP-10.dgn JBauman

**SEPI**  
 1 Glenwood Avenue  
 Raleigh, NC 27603  
 Tel: 919.789.9977  
 Fax: 919.789.9591  
 License: C-2197

APPROVED: \_\_\_\_\_  
 DATE: \_\_\_\_\_  
 SEAL

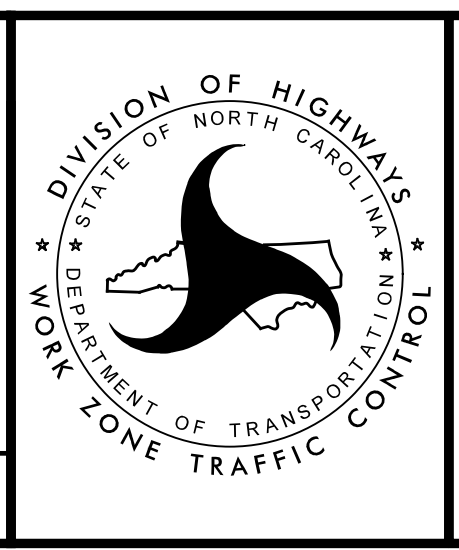

**TEMPORARY TRAFFIC CONTROL OFF-SITE DETOUR FOR PIPE CONSTRUCTION**

**DOCUMENT NOT CONSIDERED FINAL UNLESS ALL SIGNATURES COMPLETED**

INSET A

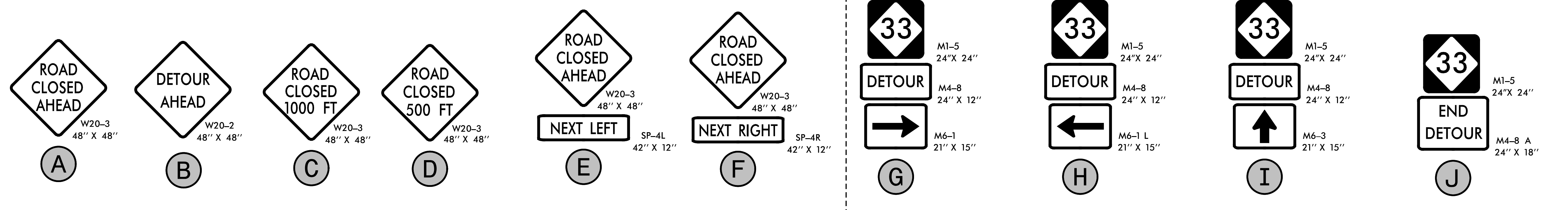
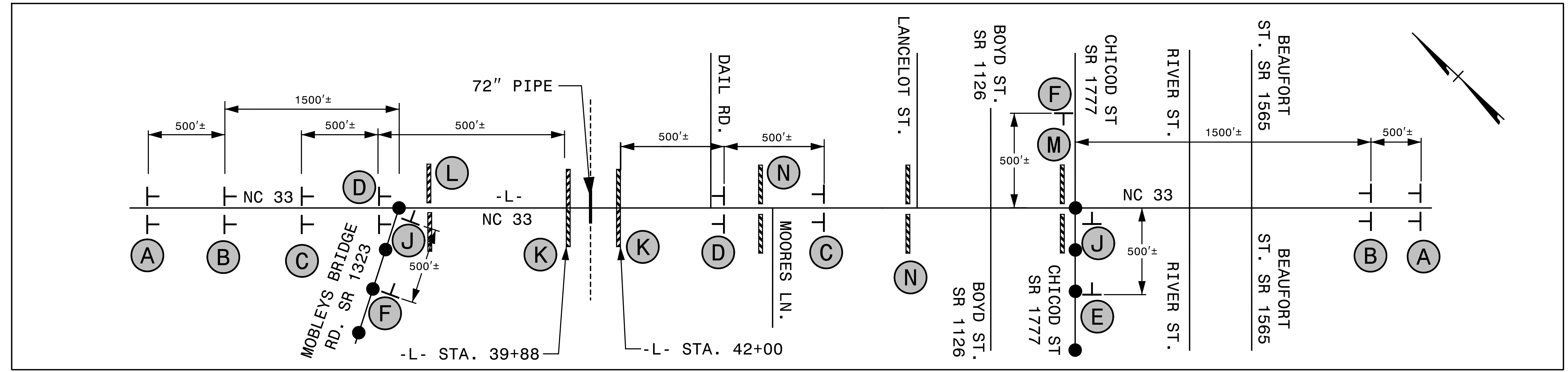

SEE SHEET TMP-10

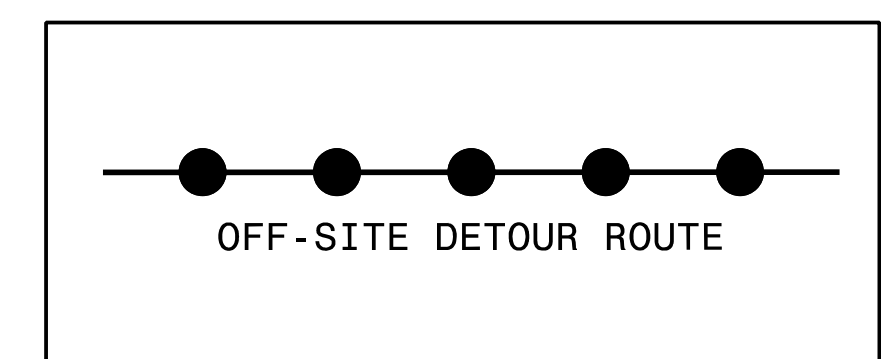
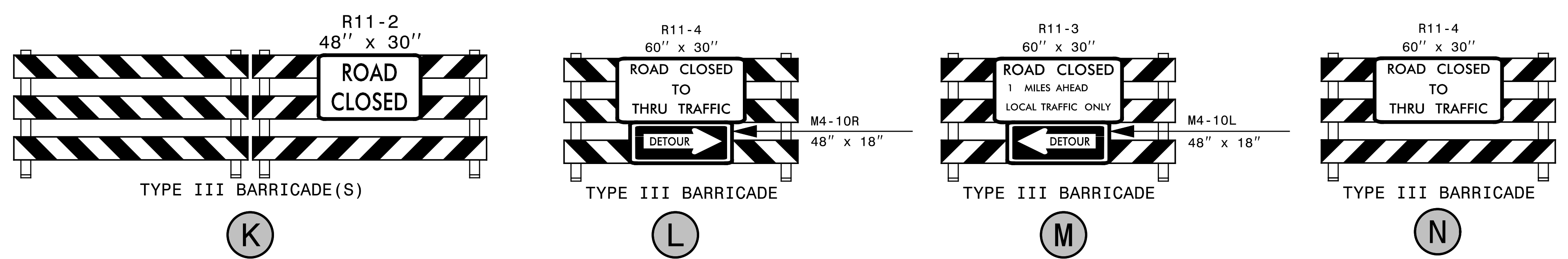

3/30/2020 X:\2014\04\003\00\_B-5301\TrafficControl\TCP\B-5301 TMP-11.dgn jbauman

**SEPI**  
 1 Glenwood Avenue  
 Raleigh, NC 27603  
 Tel: 919.789.9977  
 Fax: 919.789.9591  
 License: C-2197

APPROVED: \_\_\_\_\_  
 DATE: \_\_\_\_\_  
 SEAL

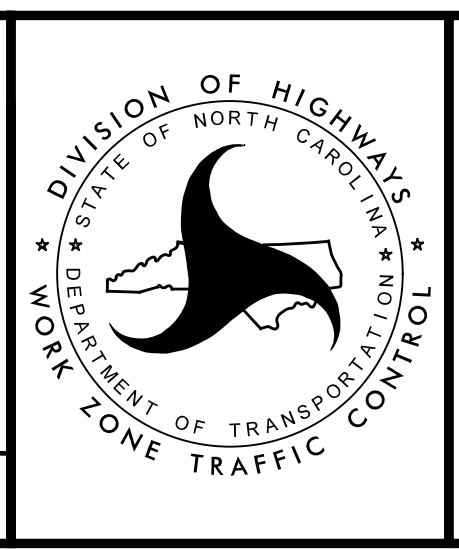

**TEMPORARY TRAFFIC CONTROL ROAD CLOSURE FOR PIPE CONSTRUCTION**

DOCUMENT NOT CONSIDERED FINAL UNLESS ALL SIGNATURES COMPLETED

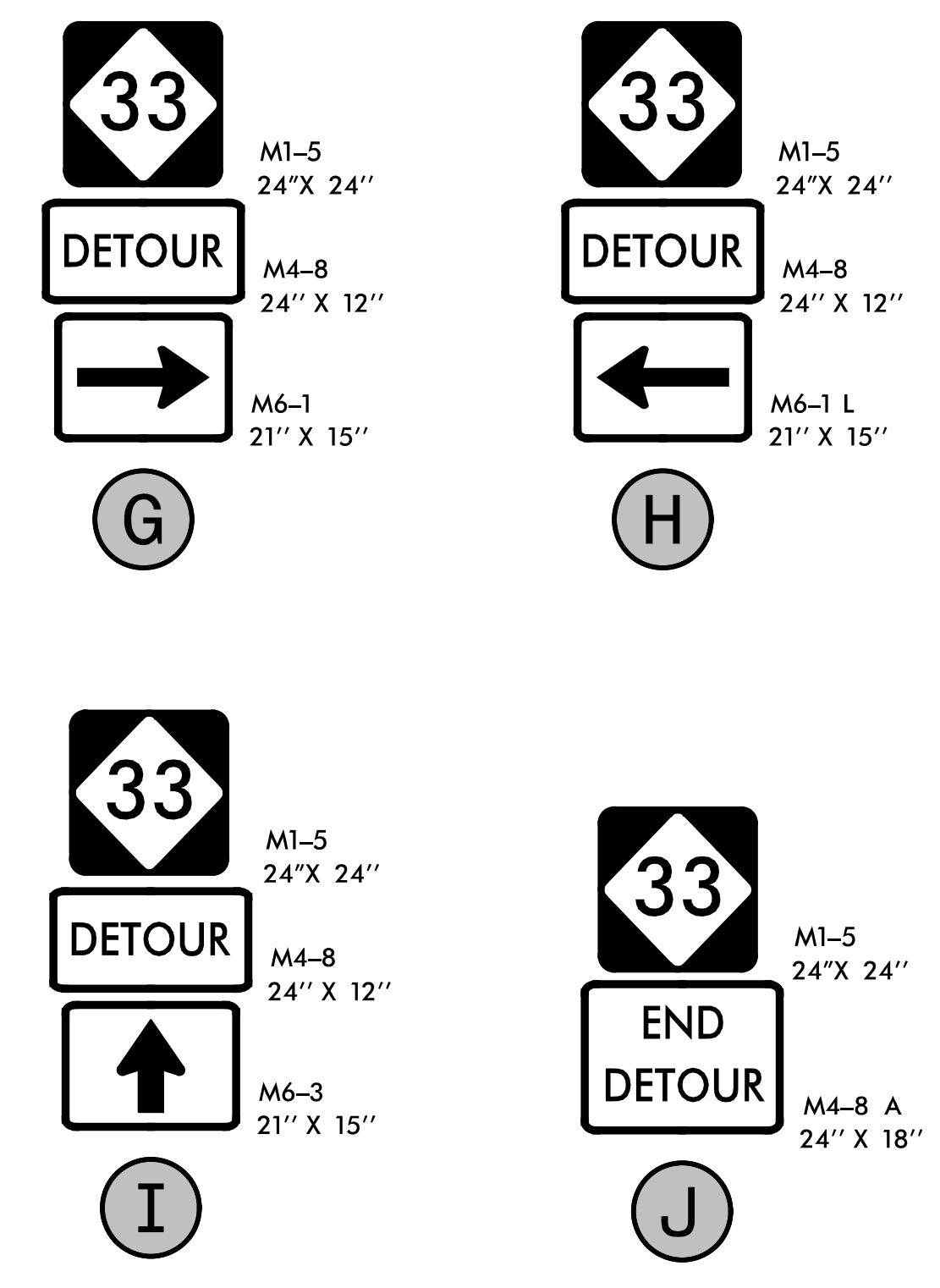
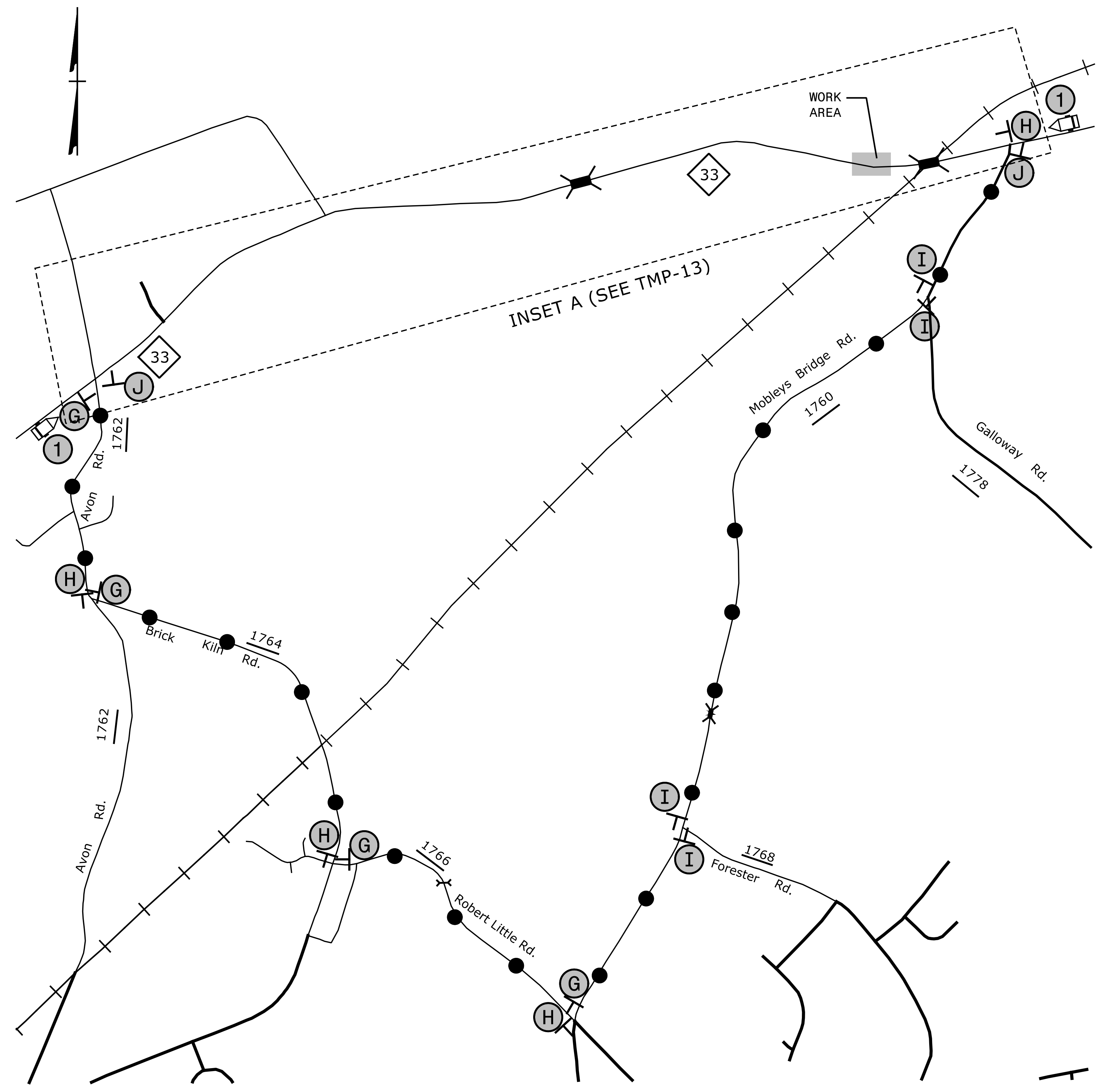

NOTES:

- THE CONTRACTOR SHALL HAVE AVAILABLE (2) CHANGEABLE MESSAGE BOARDS (CMS) TO BE UTILIZED FOR PUBLIC INFORMATION 2 WEEKS PRIOR TO THE CLOSURE OF NC 33, AS DIRECTED BY THE ENGINEER.
- SEE TMP-13 FOR ROAD CLOSURE

1	MESSAGE NO. 1	MESSAGE NO. 2	* PLACE PRIOR TO THE CLOSURE OF NC 33. LOCATION AND MESSAGE SHALL BE VERIFIED BY THE ENGINEER.
	NC 33 ROAD CLOSED	DETOUR AHEAD	
CHANGEABLE MESSAGE SIGN			

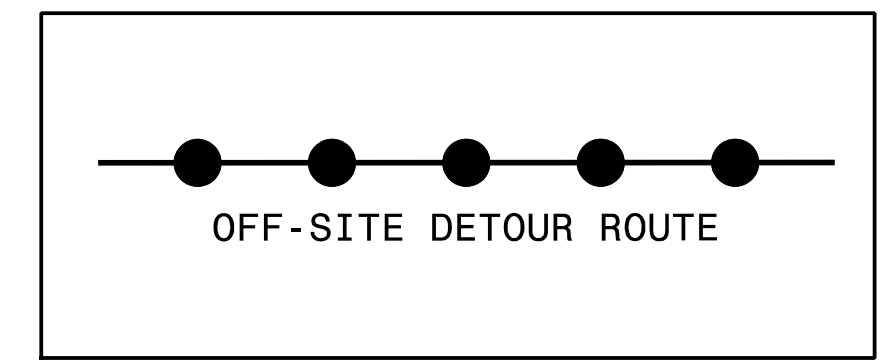

3/30/2020 X:\2014\04\003\00\_B-5301\TrafficControl\TCP\B-5301 TMP-12.dgn JBauman

**SEPI**  
 1 Glenwood Avenue  
 Raleigh, NC 27603  
 Tel: 919.789.9977  
 Fax: 919.789.9591  
 License: C-2197

APPROVED: \_\_\_\_\_  
 DATE: \_\_\_\_\_  
 SEAL

**DOCUMENT NOT CONSIDERED FINAL  
 UNLESS ALL SIGNATURES COMPLETED**

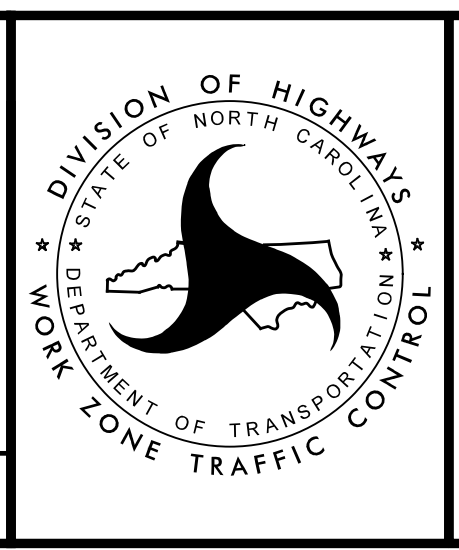

**TEMPORARY  
 TRAFFIC CONTROL  
 OFF-SITE DETOUR FOR  
 CONCRETE REMOVAL AND  
 REPLACE**

INSET A

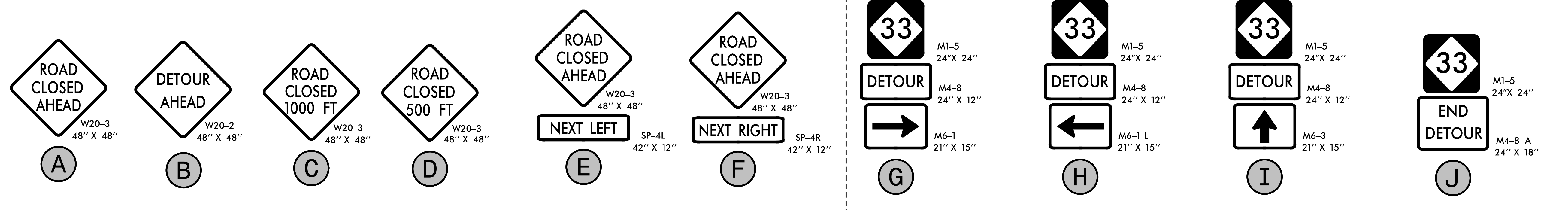
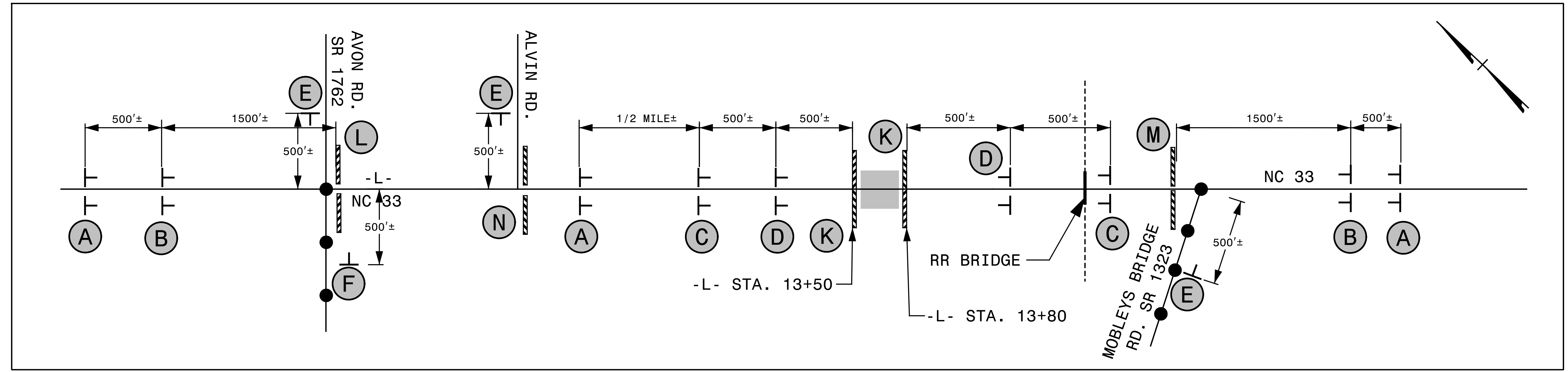

SEE SHEET TMP-12

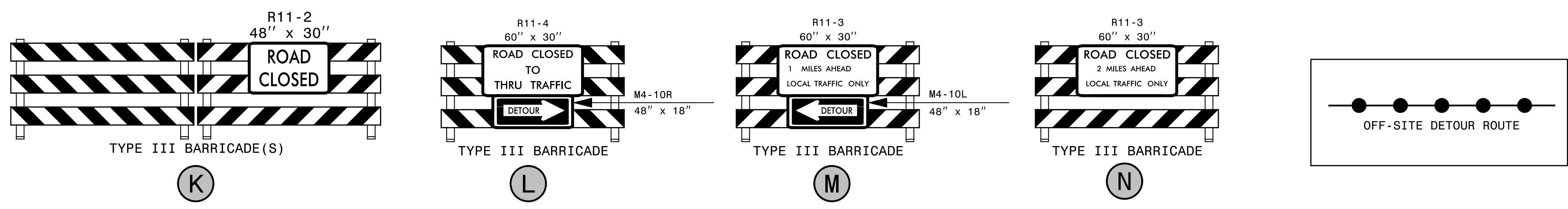

3/30/2020 X:\2014\RO14\003\00\_B-5301\TrafficControl\TCP\B-5301 TMP-13.dgn jbauman

**SEPI**  
1 Glenwood Avenue  
Raleigh, NC 27603  
Tel: 919.789.9977  
Fax: 919.789.9591  
License: C-2197

APPROVED: \_\_\_\_\_  
DATE: \_\_\_\_\_  
SEAL  
  
DOCUMENT NOT CONSIDERED FINAL  
UNLESS ALL SIGNATURES COMPLETED

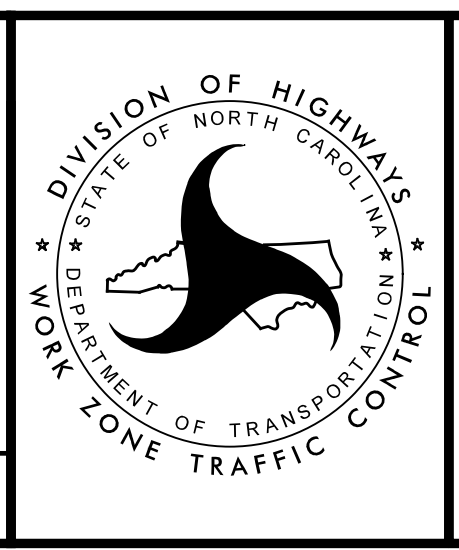

TEMPORARY  
TRAFFIC CONTROL  
ROAD CLOSURE FOR  
CONCRETE REMOVAL AND  
REPLACE