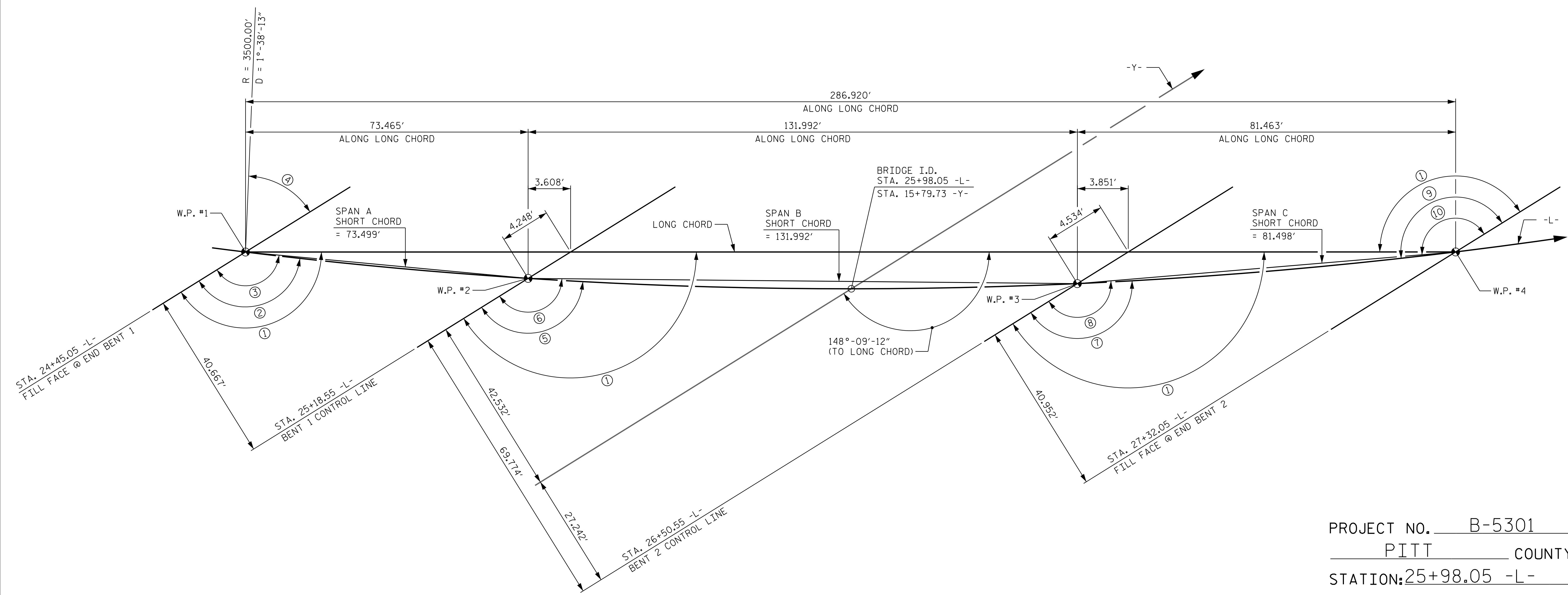

TABLE OF ANGLES			
No.	ANGLES	No.	ANGLES
1	148°-09'-12"	6	148°-05'-16"
2	145°-48'-15" (TANGENT TO CURVE)	7	149°-10'-06" (TANGENT TO CURVE)
3	146°-24'-21"	8	149°-50'-07"
4	55°-48'-15"	9	150°-30'-09" (TANGENT TO CURVE)
5	147°-00'-26" (TANGENT TO CURVE)	10	149°-50'-07"



LONG CHORD LAYOUT
ALL BENTS ARE PARALLEL

PROJECT NO. B-5301
PITT COUNTY
 STATION: 25+98.05 -L-

SHEET 3 OF 4

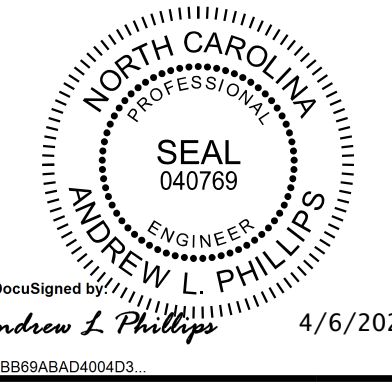

Kimley»Horn
 421 Fayetteville Street, Suite 600
 Raleigh, NC 27601-1772
 Phone (919) 677-2000
 NC LICENSE # F-0102

STATE OF NORTH CAROLINA
 DEPARTMENT OF TRANSPORTATION
 RALEIGH
GENERAL DRAWING
 FOR BRIDGE OVER
 NORFOLK SOUTHERN
 RAILROAD ON NC 33
 BETWEEN SR 1762 & SR 1760

REVISIONS						SHEET NO.
NO.	BY:	DATE:	NO.	BY:	DATE:	S-3
1			3			TOTAL SHEETS
2			4			55

**DOCUMENT NOT CONSIDERED FINAL
 UNLESS ALL SIGNATURES COMPLETED**

4/7/2020
 DRAWN BY: D. D. LOWERY DATE: 2/20
 CHECKED BY: C. I. POOLE DATE: 2/20
 DESIGN ENGINEER OF RECORD: A. L. PHILLIPS DATE: 2/20

G:\Users\andrew.phillips\My Documents\Bridges - Documents\B-5301\Coord\Drawings\401_005_B5301_SML\COI_003_730087.dgn