

09/08/99

05-JAN-2022 07:54  
S:\Units\Div03\Projects\URBAN\New Hanover Co\U5710A\Working\CONTROL SHEETS\220104 second title sheet revision\U5710A\_LS.RW01\_rev2.dgn  
midval AT LS-299896

**TIP PROJECT: U-5710A**

STATE	STATE PROJECT REFERENCE NO.	SHEET NO.	TOTAL SHEETS
N.C.	U5710A	RW01-REV	14

STATE OF NORTH CAROLINA  
DIVISION OF HIGHWAYS

SURVEY CONTROL, EXISTING CENTERLINES,  
RIGHT OF WAY, EASEMENTS AND PROPERTY TIES

**NEW HANOVER COUNTY**

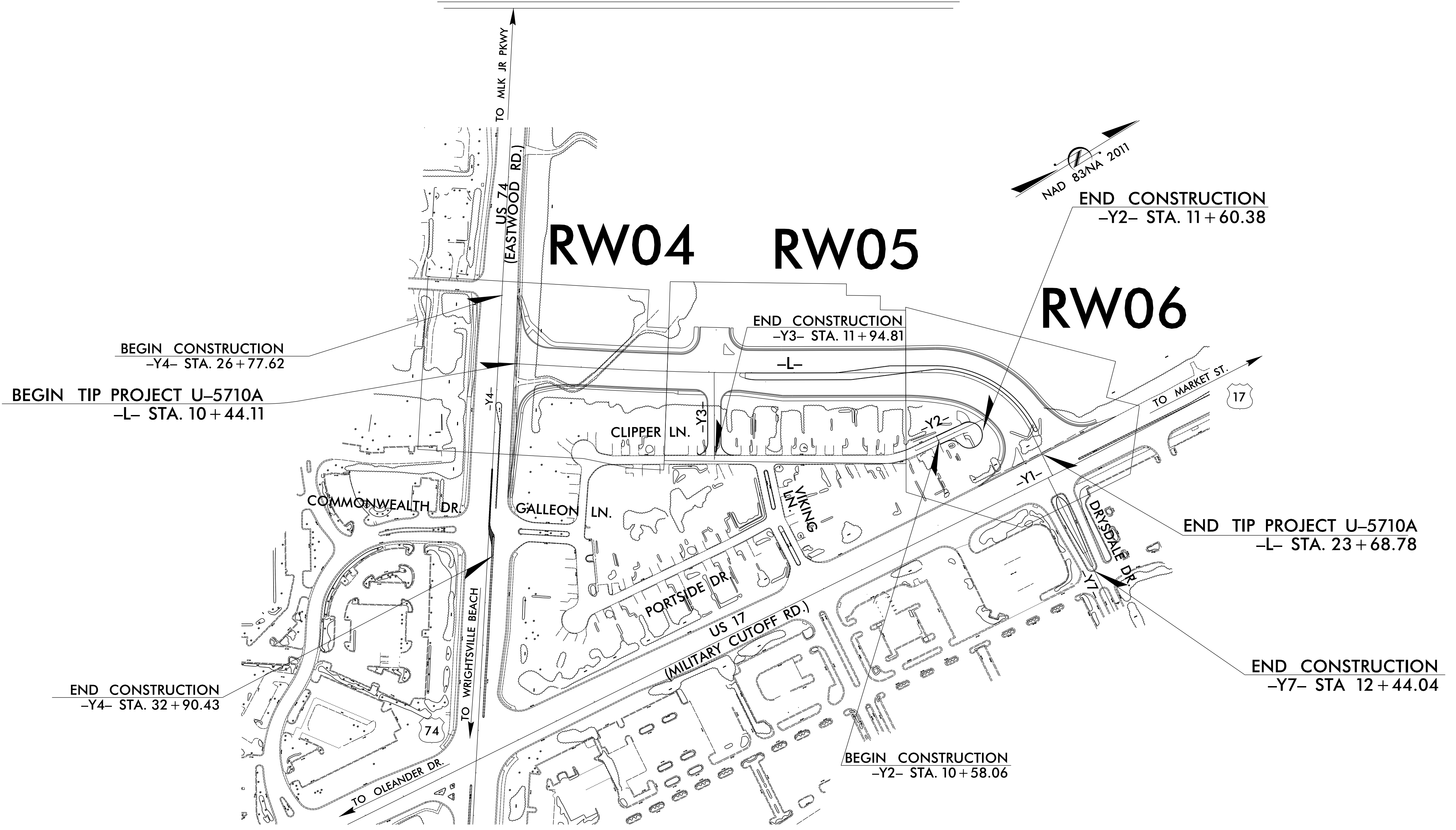

**GRAPHIC SCALE**

**PLAN SCALE**  
1" = 20'

**DATUM DESCRIPTION**

THE LOCALIZED COORDINATE SYSTEM DEVELOPED FOR THIS PROJECT IS BASED ON THE STATE PLANE COORDINATES ESTABLISHED BY NCDOT FOR GPS MONUMENT "U5710-6" WITH NAD 83/NA 2011 STATE PLANE GRID COORDINATES OF NORTHING: 177314.900(ft) EASTING: 2351770.796(ft) ELEVATION: 19.026(ft)

THE AVERAGE COMBINED GRID FACTOR USED ON THIS PROJECT (GROUND TO GRID) IS: 1.0000366380

THE N.C. LAMBERT GRID BEARING AND LOCALIZED HORIZONTAL GROUND DISTANCE FROM "U5710-6" TO -L- STATION 10+04.90 IS S 57-15.82" E 1499.67(ft)

ALL LINEAR DIMENSIONS ARE LOCALIZED HORIZONTAL DISTANCES VERTICAL DATUM USED IS NAVD88 (GEOID 12)

Prepared in the Office of:

LOCATION AND SURVEY'S UNIT  
DIVISION 3  
5510 BARBADOS BLVD, SUITE 102  
CASTLE HAYNE, NORTH CAROLINA 28429

2018 STANDARD SPECIFICATIONS

**RIGHT OF WAY DATE:**  
JANUARY 21, 2019

**LETTING DATE:**  
FEBRUARY 24, 2022

**PROFESSIONAL LAND SURVEYOR**



DocuSigned by:  
Christopher L Sawyer  
1021487

01/05/2022

Date:

