

**This electronic collection of documents is provided  
for the convenience of the user  
and is Not a Certified Document –**

**The documents contained herein were originally issued  
and sealed by the individuals whose names and license  
numbers appear on each page, on the dates appearing  
with their signature on that page.**

**This file or an individual page  
shall not be considered a certified document.**

STATE OF NORTH CAROLINA  
DIVISION OF HIGHWAYS

**NASH & EDGECOMBE COUNTIES**

LOCATION: US 64 (FUTURE I-87) FROM SR-1603 (OLD CARRIAGE RD.)  
TO SR 1225 (KINGSBORO RD.)

STATE	STATE PROJECT REFERENCE NO.	SHEET NO.	TOTAL SHEETS
N.C.	I-6046	1	
STATE PROJ. NO.	F.A. PROJ. NO.	DESCRIPTION	
47995.1.1		PE	
47995.3.1	NHPIM-0087(047)	CONST	

TIP PROJECT: I-6046

CONTRACT: C204396

TYPE OF WORK: PAVEMENT REHABILITATION.

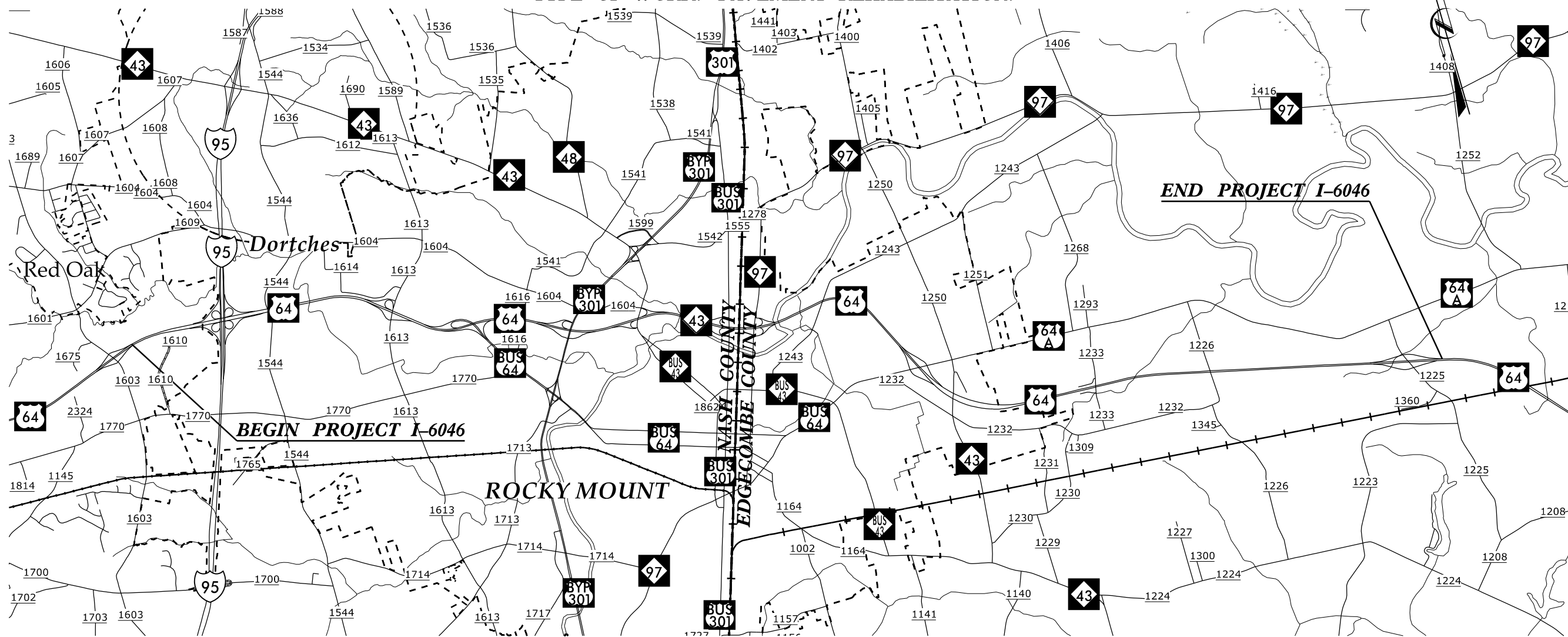

**VICINITY MAP**

**DESIGN DATA**  
ADT 2017 = 44000

**PROJECT LENGTH**

LENGTH ROADWAY (EBL) TIP PROJECT I-6046 = 14.02 MILES  
TOTAL LENGTH TIP PROJECT I-6046 = 14.02 MILES

FUNCTIONAL CLASS  
OTHER FREEWAY  
(FUTURE INTERSTATE)

Prepared in the Office of:  
**DIVISION OF HIGHWAYS**  
Division 4 DDC  
509 Ward Blvd., Wilson NC, 27895

2018 STANDARD SPECIFICATIONS  
RIGHT OF WAY DATE:  
NA  
LETTING DATE:  
JUNE 21, 2022

K.G. BOWEN, PE  
PROJECT ENGINEER  
D.R. ETHRIDGE  
PROJECT DESIGN ENGINEER

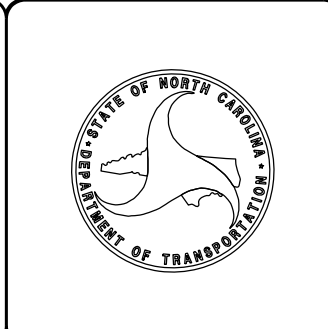

09-MAR-2022 10:16  
S:\DDC\I-6046\I-6046\_DDC4\_tsh.dgn  
\$\$\$\$\$USER\$NAME\$\$\$\$\$

# NASH COUNTY

# EDGECOMBE COUNTY

PROJECT REFERENCE NO.	SHEET NO.
I-6046 47995.3.1	2

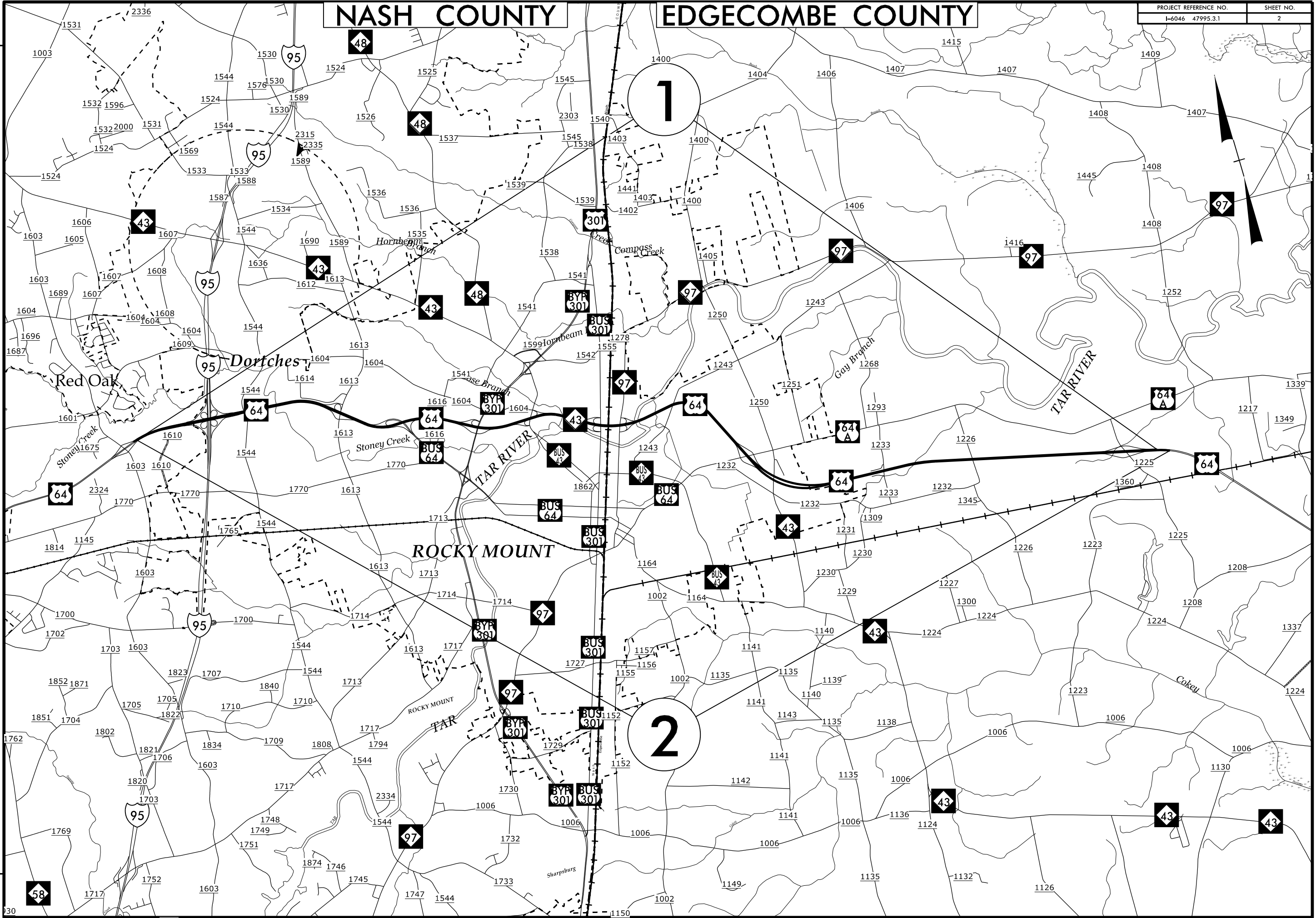

REVISIONS

03-MAR-2022 10:23  
 S:\DDC4\04\47995.3.1\DDC4\_MAPS PRINT 1.dgn  
 \$\$\$USER\$NAME\$\$\$\$

# NASH COUNTY

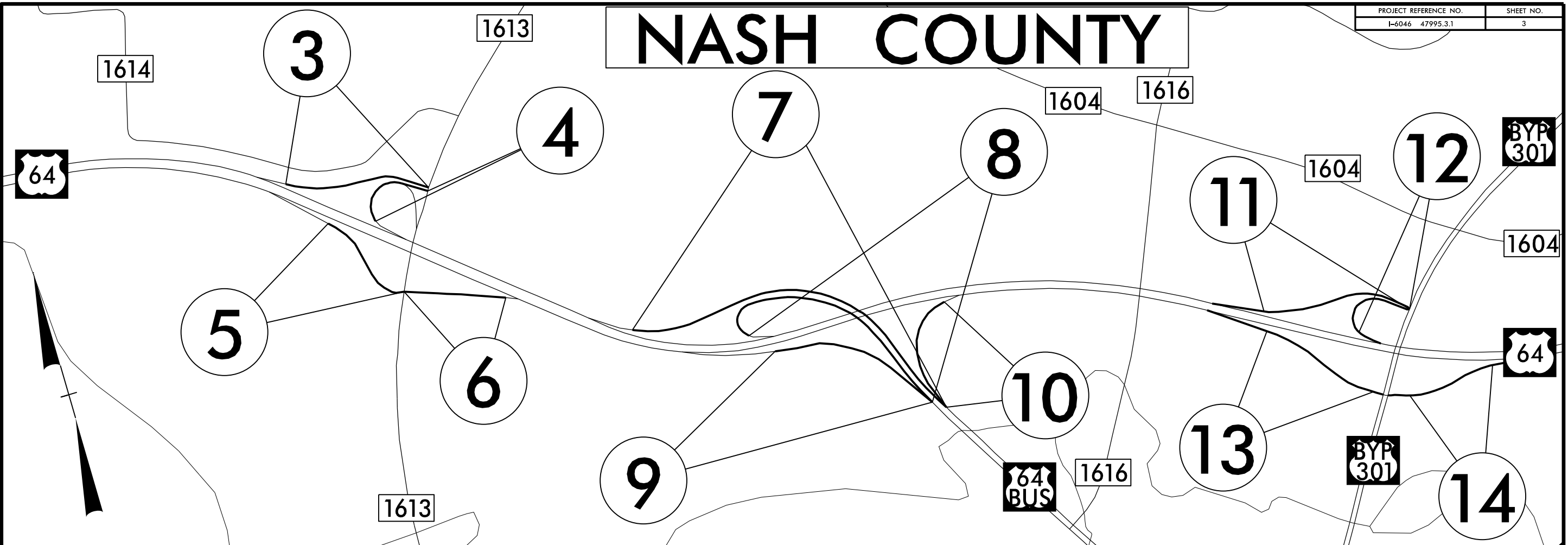

# NASH COUNTY

# EDGECOMBE COUNTY

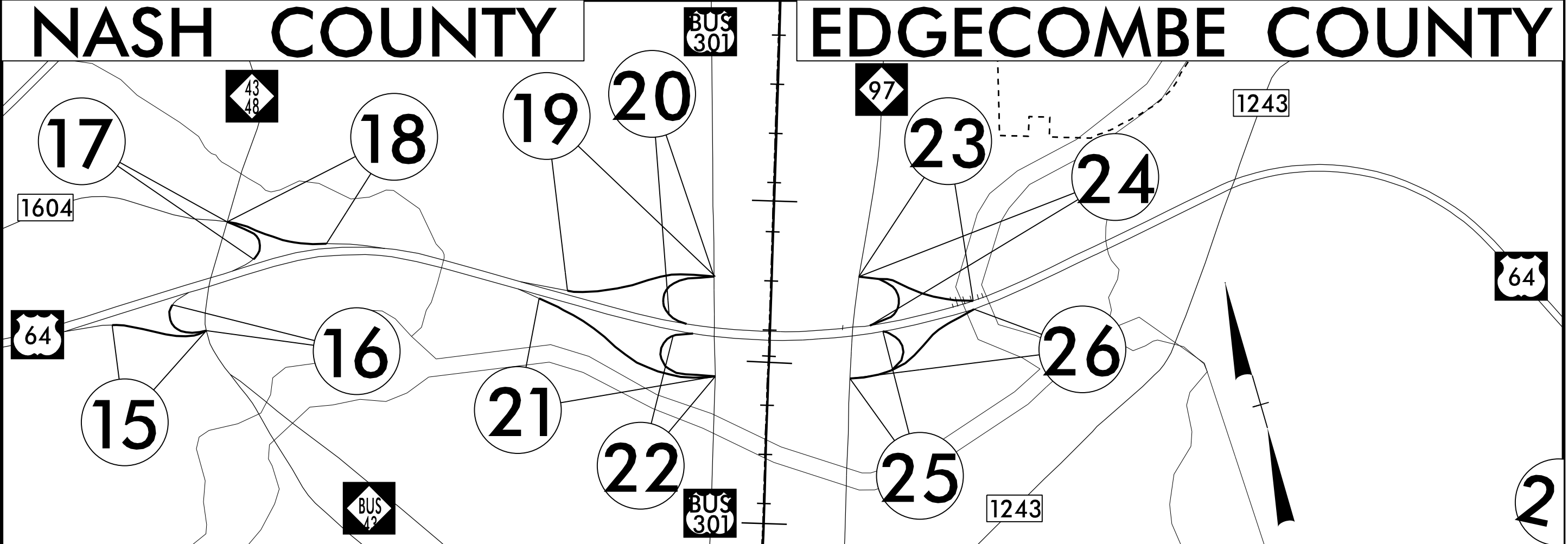

2

REVISIONS

03-MAR-2022 10:27  
S:\DCC\1404\14046\_DDC4\_MAPS\_PRINT\_2.dgn  
SSSUSER\NAMESSS

DDC4

# EDGECOMBE COUNTY

PROJECT REFERENCE NO. SHEET NO.  
I-6046 47995.3.1 4

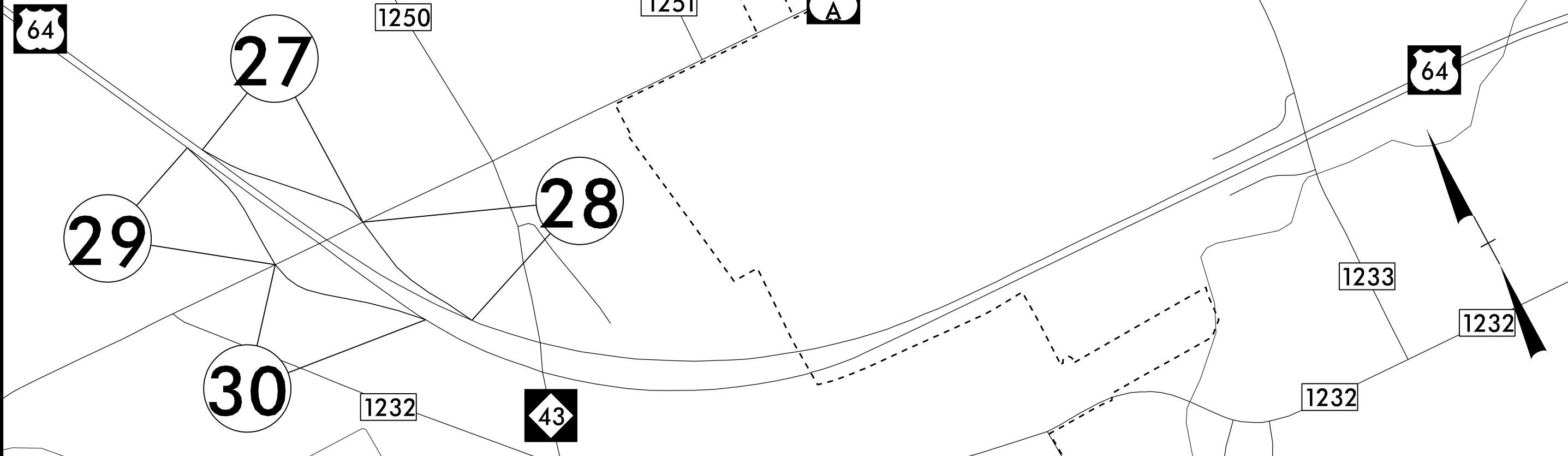

# EDGECOMBE COUNTY

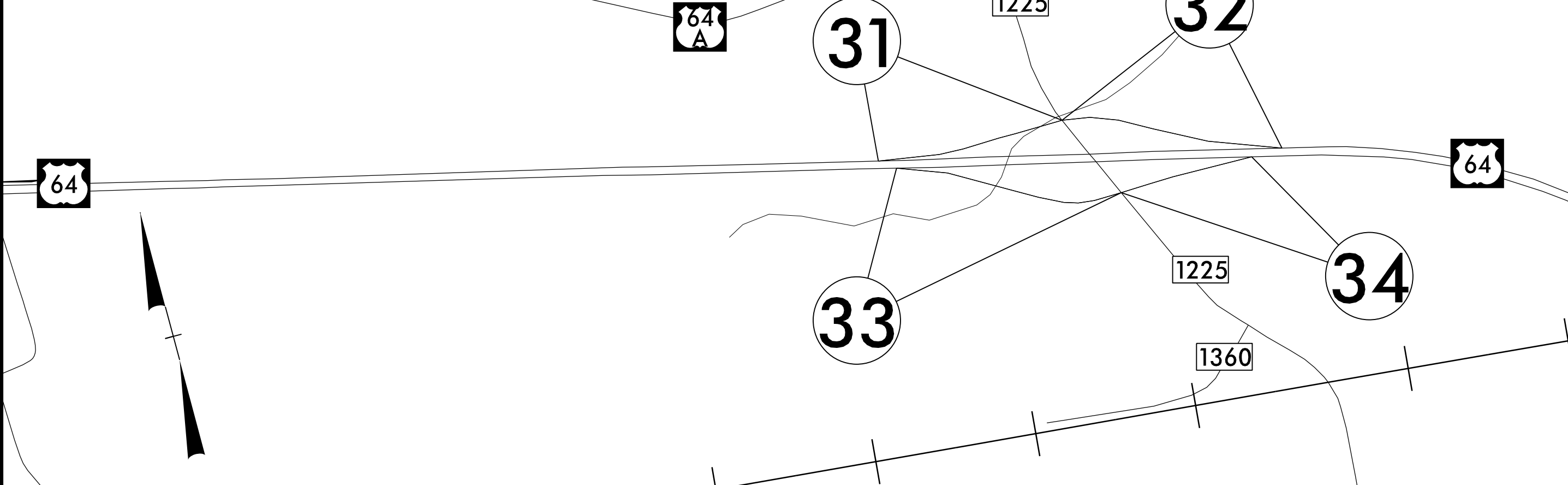

REVISIONS

09-MAR-2022 10:28  
S:\DDC4\04\1220\_46\_DDC4\_MAPS PRINT 3.dgn  
\$\$\$\$USER\$NAME\$\$\$\$

DDC4

# PAVEMENT SCHEDULE

B1	PROP. OPEN-GRADED ASPHALT FRICTION COURSE, TYPE FC-1 MOD, AT AN AVERAGE RATE OF 90 LBS. PER SQ. YARD.	F1	ASPHALT SURFACE TREATMENT, FOG SEAL	V2	MILLING ASPHALT PAVEMENT. 1.5" DEPTH.
C1	PROP. APPROX. 1.5" ASPHALT CONCRETE SURFACE COURSE, TYPE S9.5D, AT AN AVERAGE RATE OF 168 LBS. PER SQ. YARD.	T	EARTH MATERIAL.	V3	VARIABLE DEPTH MILLING ASPHALT PAVEMENT 2.25" - 6.00" DEPTH.
D1	PROP. APPROX. 2.5" ASPHALT CONCRETE INTERMEDIATE COURSE, TYPE I19.0C, AT AN AVERAGE RATE OF 285 LBS. PER SQ. YARD.	U1	EXISTING PAVEMENT.	V4	VARIABLE DEPTH MILLING ASPHALT PAVEMENT 1.50" - 5.25" DEPTH.
E1	PROP. APPROX. 5" ASPHALT CONCRETE BASE COURSE, TYPE B25.0C, AT AN AVERAGE RATE OF 570 LBS. PER SQ. YARD.	V1	MILLING ASPHALT PAVEMENT. 2.25" DEPTH.	V5	INCIDENTAL MILLING
		M	MILLED RUMBLE STRIPS (ASPHALT CONCRETE)		

NOTE: PAVEMENT EDGE SLOPES ARE 1:1 UNLESS SHOWN OTHERWISE.

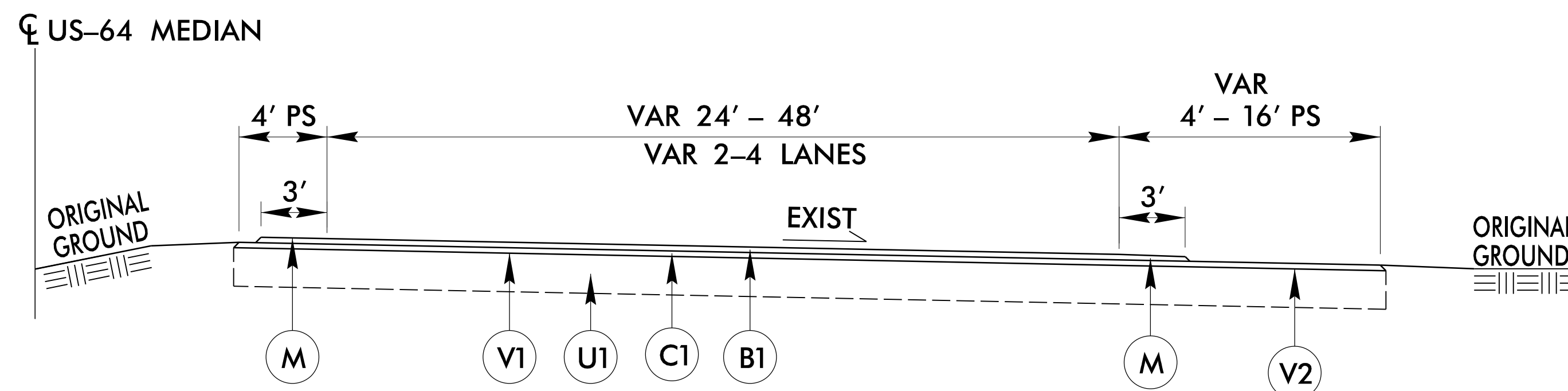

**TYPICAL SECTION NO. 1**  
US-64

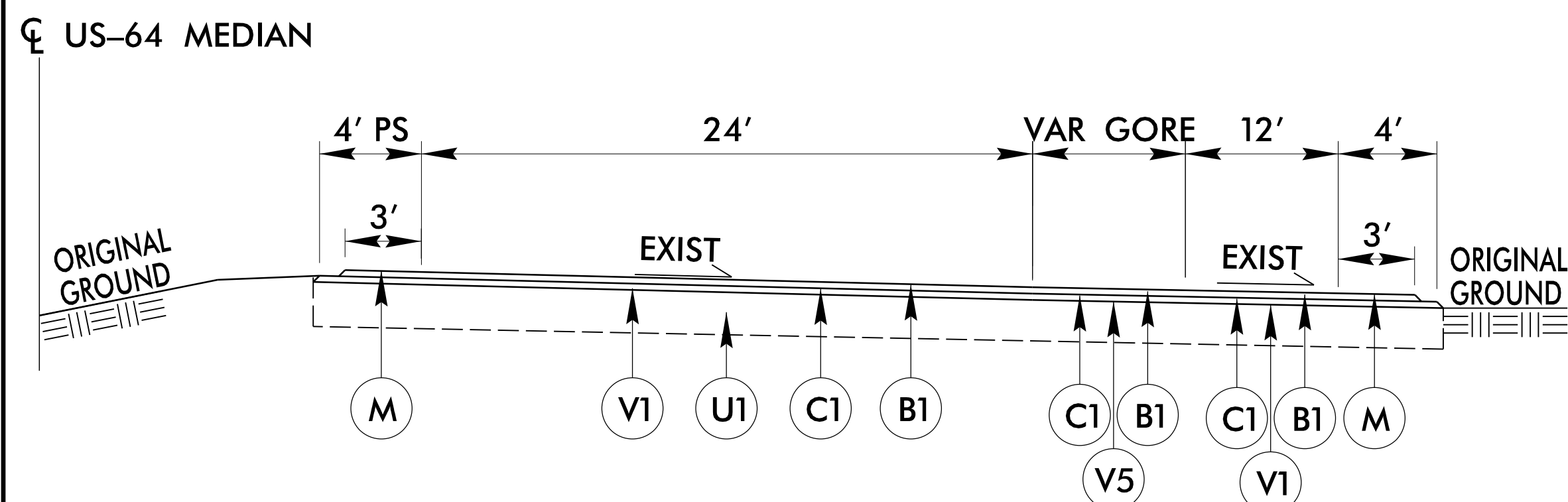

**TYPICAL SECTION NO. 2**  
US-64 @ RAMP & LOOP GORE AREA

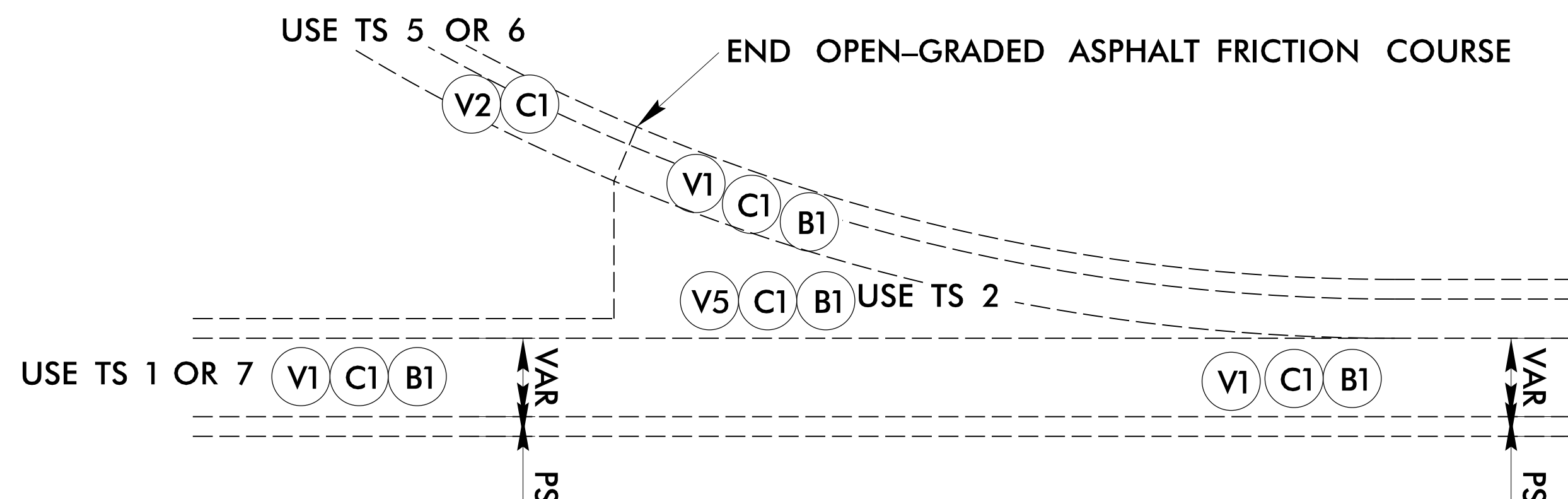

**US-64 PAVING & MILLING AT RAMP AREAS**

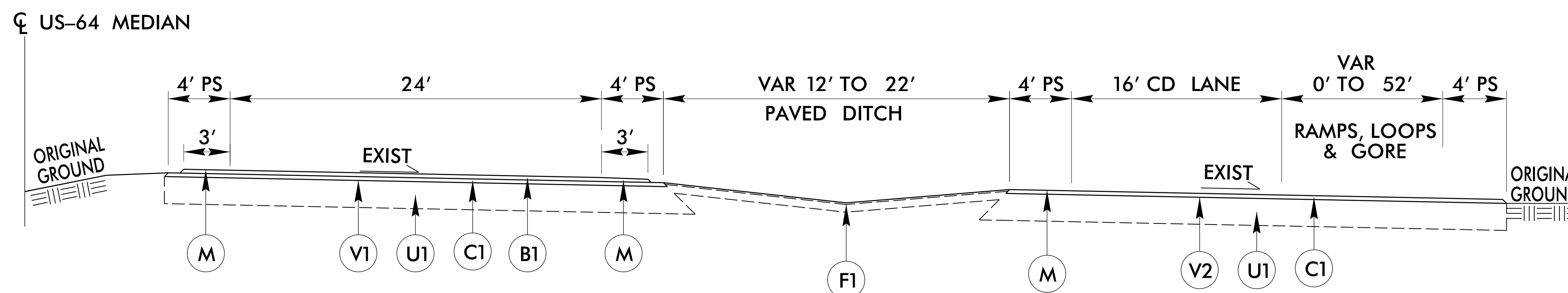

**TYPICAL SECTION NO. 3**  
US-64 @ I-95 CD LANE WITH PAVED DITCH

6/2/99

14-JUN-2022 15:41  
S:\BDC\1-6046\1-6046-dbc4\_TYP.dgn  
Division 4 DDC

PROJECT REFERENCE NO.		SHEET NO.	
I-6046 47995.3.1		6	
PAVEMENT SCHEDULE			
B1	OGAFC		
C1	1.5" S9.5D		
D1	2.5" I19.0C		
E1	5" B25.0C		
F1	FOG SEAL		
T	EARTH MATERIAL		
U1	EXIST. PAVEMENT		
V1	2.25" MILL		
V2	1.50" MILL		
V3	2.25"-6" MILL		
V4	1.5"-5.25" MILL		
V5	INCIDENTAL MILL		
M	RUMBLE STRIPS		

NOTE: PAVEMENT EDGE SLOPES ARE 1:1 UNLESS SHOWN OTHERWISE.

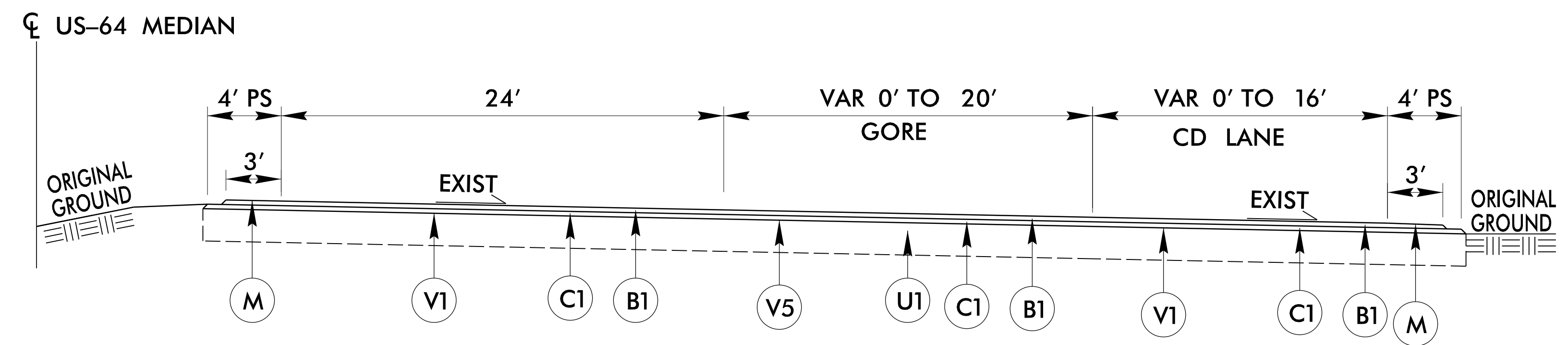

TYPICAL SECTION NO. 4  
US-64 @ I-95 CD LANE

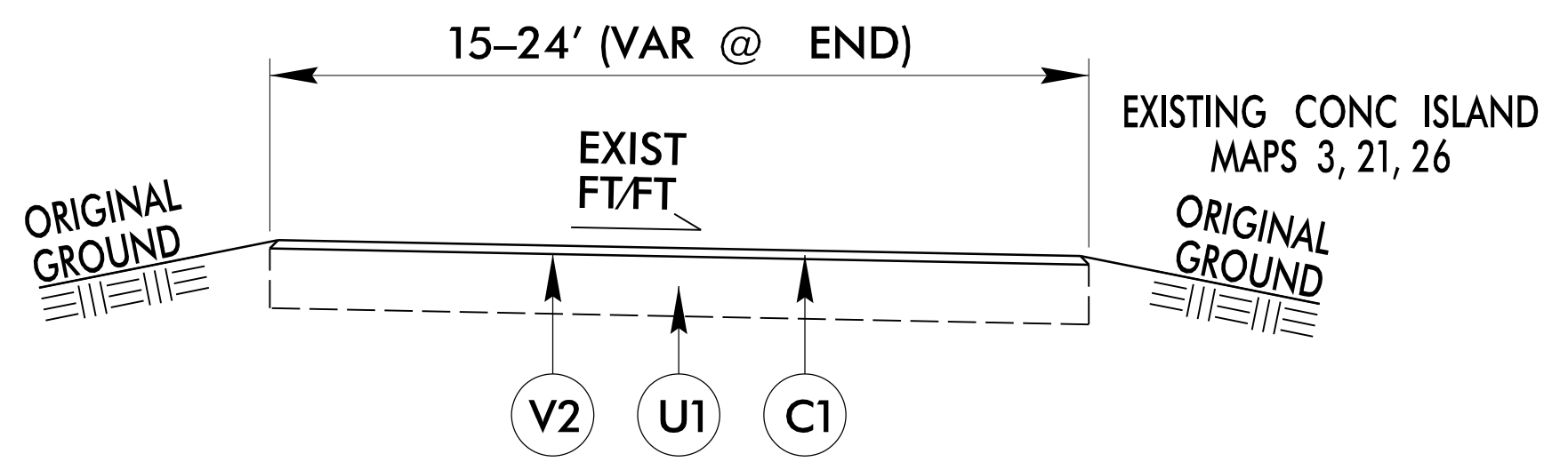

TYPICAL SECTION NO. 5  
RAMPS PAST GORE

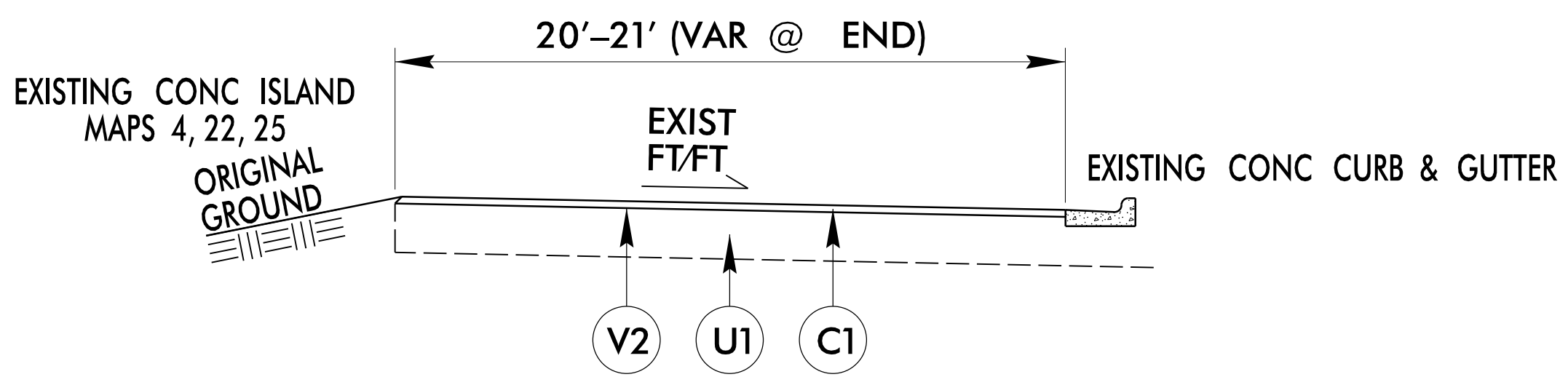

TYPICAL SECTION NO. 6  
LOOPS PAST GORE

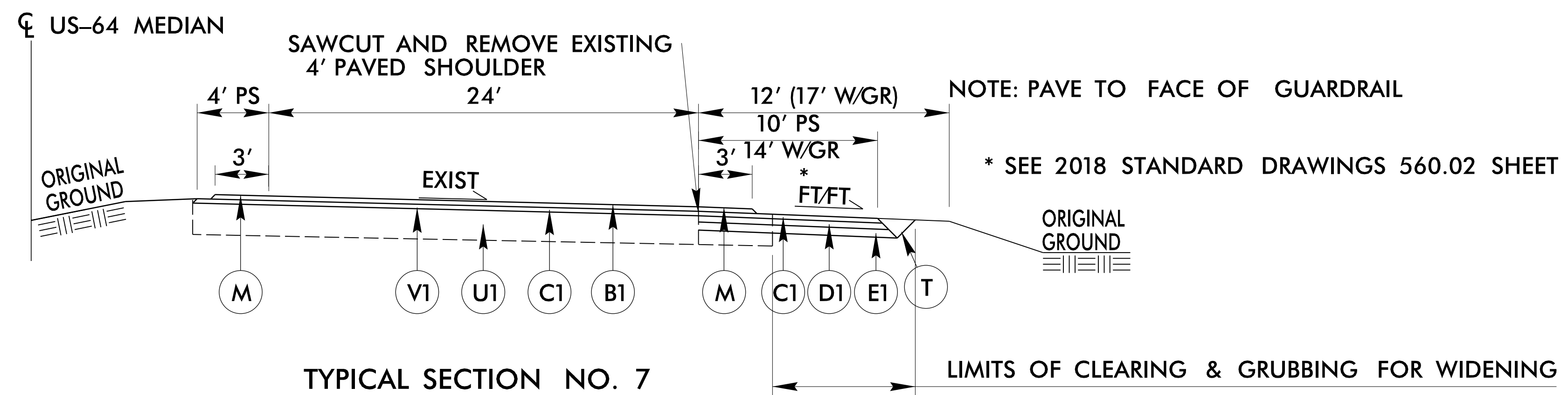

TYPICAL SECTION NO. 7  
US-64

NOTE: PAVE TO FACE OF GUARDRAIL  
\* SEE 2018 STANDARD DRAWINGS 560.02 SHEET 20F2

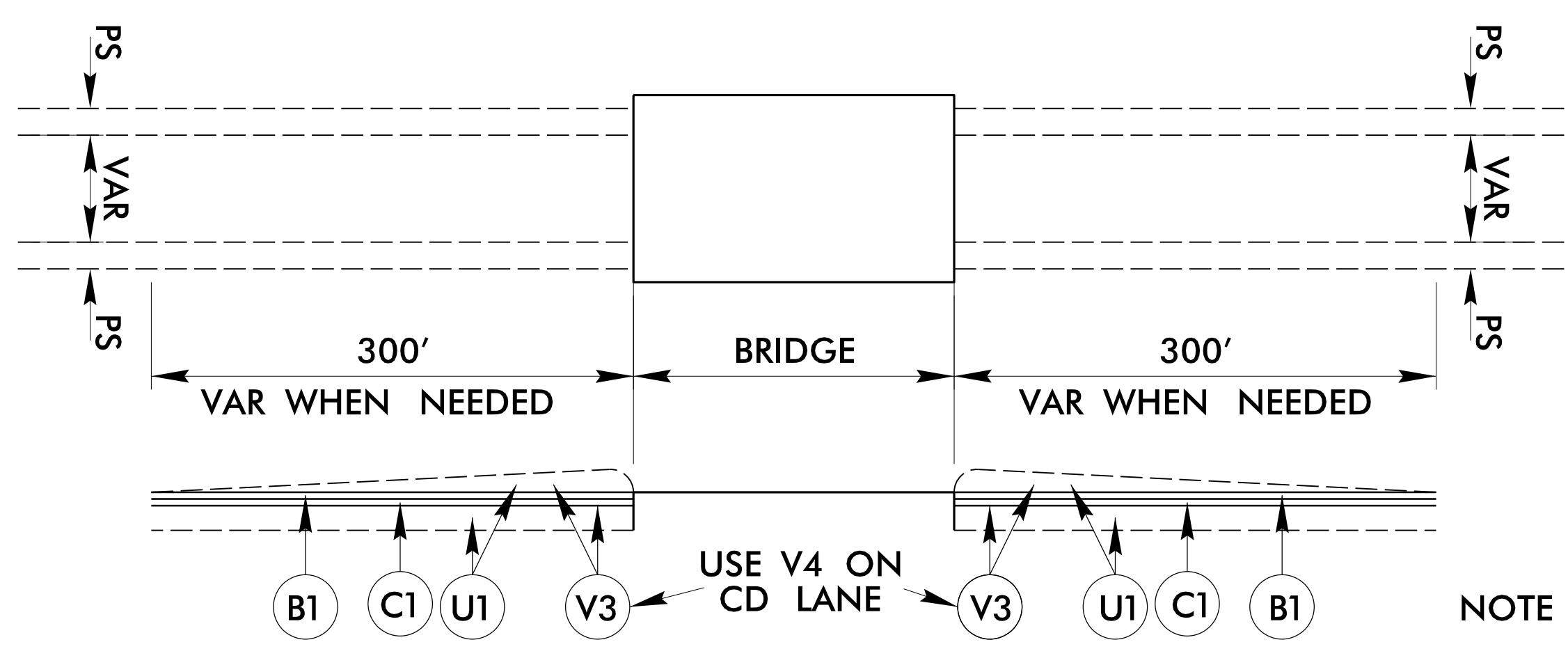

US-64 MILLING AT BRIDGES TO IMPROVE GRADE

NOTE DO NOT MILL PAVED DITCH AT CD LANES

6/2/99  
14-JUN-2022 15:42  
S:\BDC\1-6046\1-6046-1-6046-ddc4\_TYP.dgn  
Division 4 DDC

PROJECT REFERENCE NO.	SHEET NO.
I-6046 - 47995.3.1	
RWY SHEET NO.	
ROADWAY DESIGN ENGINEER	HYDRAULICS ENGINEER

# WATTLE DETAIL

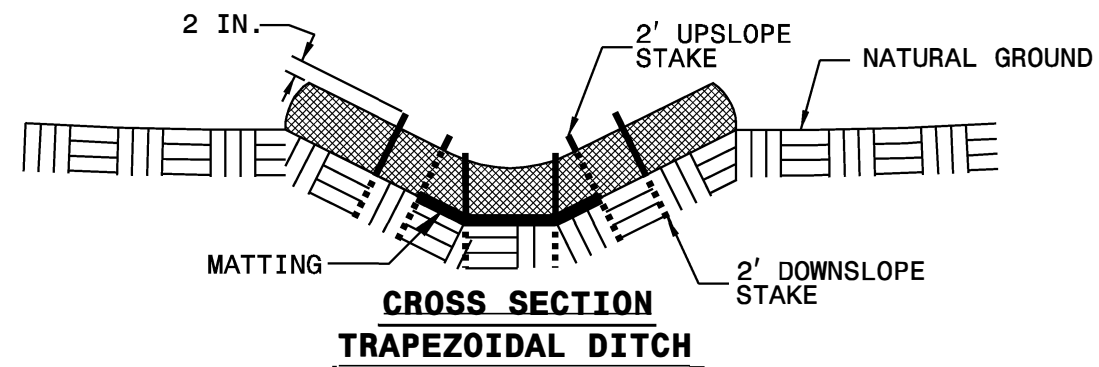
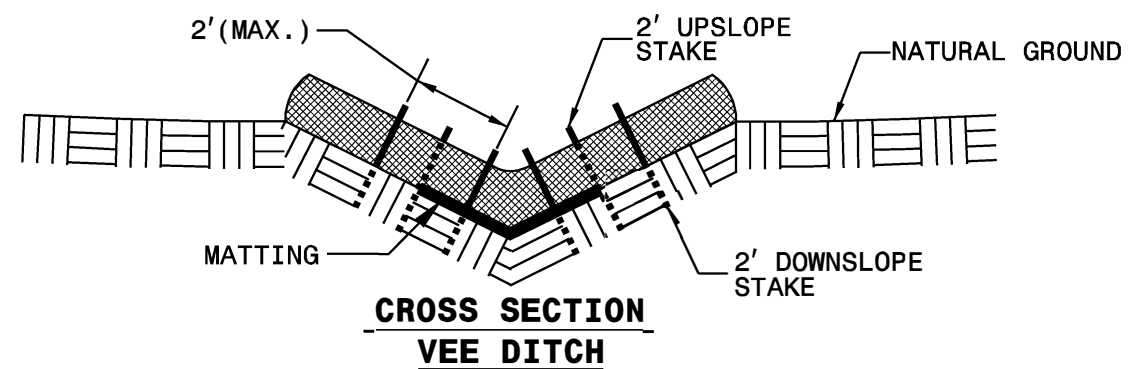
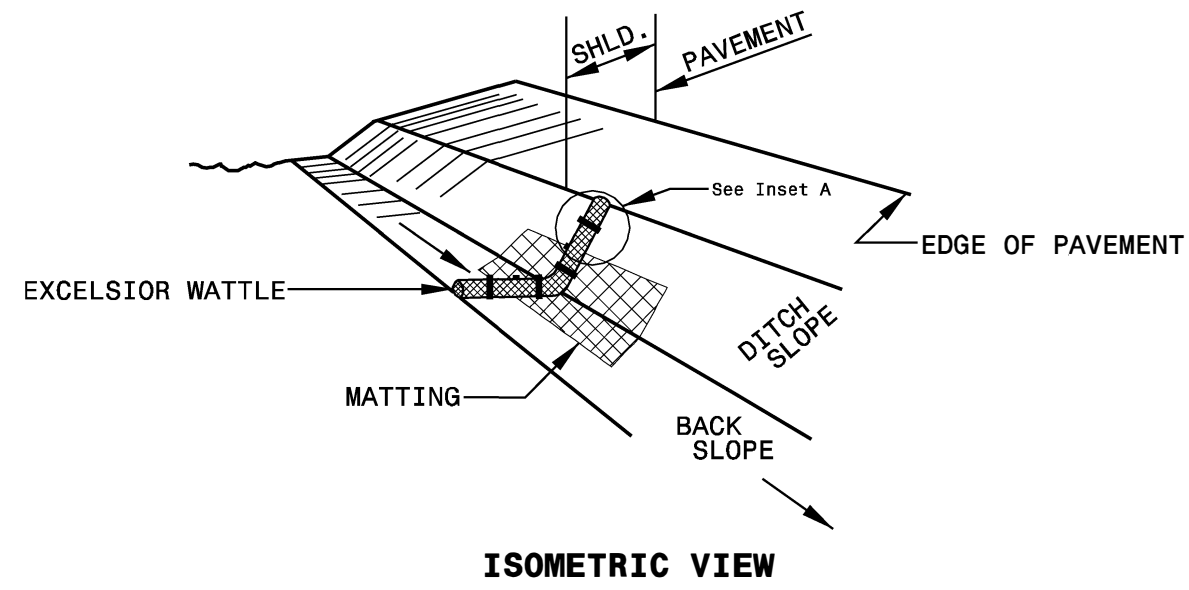

**NOTES:**

USE MINIMUM 12 IN. DIAMETER EXCELSIOR WATTLE.

USE 2 FT. WOODEN STAKES WITH A 2 IN. BY 2 IN. NOMINAL CROSS SECTION.

ONLY INSTALL WATTLE(S) TO A HEIGHT IN DITCH SO FLOW WILL NOT WASH AROUND WATTLE AND SCOUR DITCH SLOPES AND AS DIRECTED.

INSTALL A MINIMUM OF 2 UPSLOPE STAKES AND 4 DOWNSLOPE STAKES AT AN ANGLE TO WEDGE WATTLE TO BOTTOM OF DITCH.

PROVIDE STAPLES MADE OF 0.125 IN. DIAMETER STEEL WIRE FORMED INTO A U SHAPE NOT LESS THAN 12" IN LENGTH.

INSTALL STAPLES APPROXIMATELY EVERY 1 LINEAR FOOT ON BOTH SIDES OF WATTLE AND AT EACH END TO SECURE IT TO THE SOIL.

INSTALL MATTING IN ACCORDANCE WITH SECTION 1631 OF THE STANDARD SPECIFICATIONS.

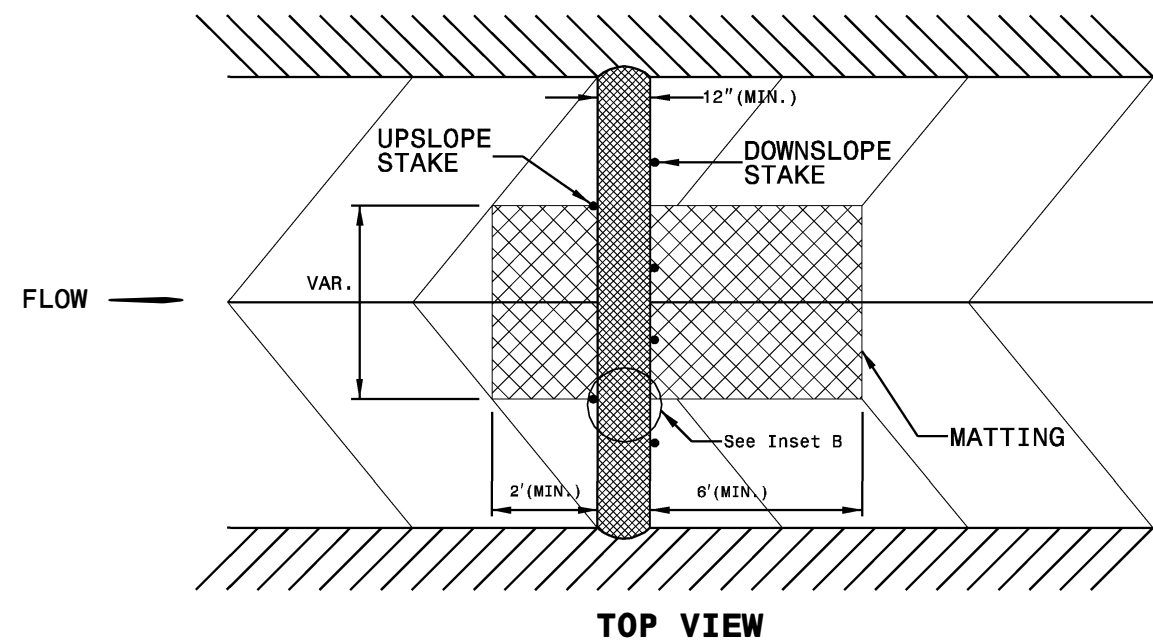
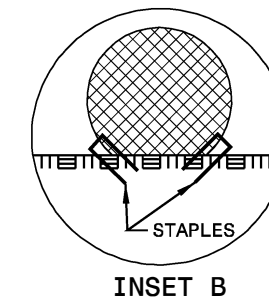
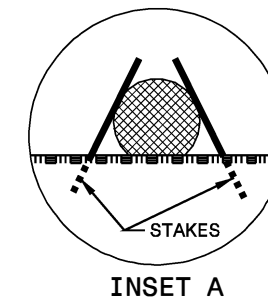



NOTES: Less than 5' - 10' undisturbed buffer from ROW, ditchline, water feature, or drainage inlet, add BMP.

BMP Options: Wattle, Silt Fence or Hardened Aggregate.

# EROSION CONTROL DETAIL

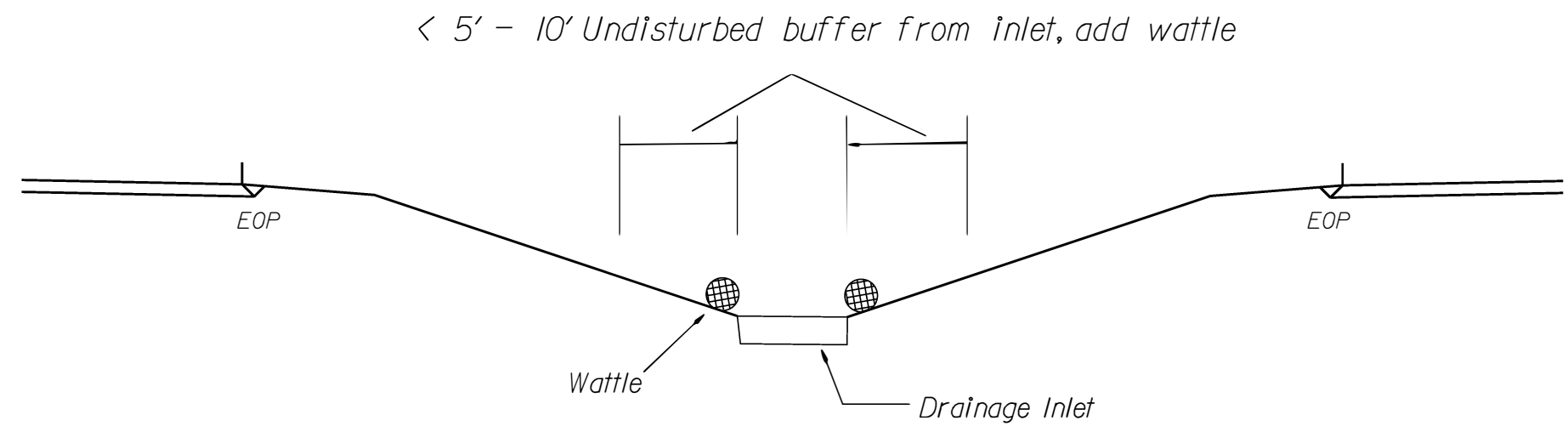
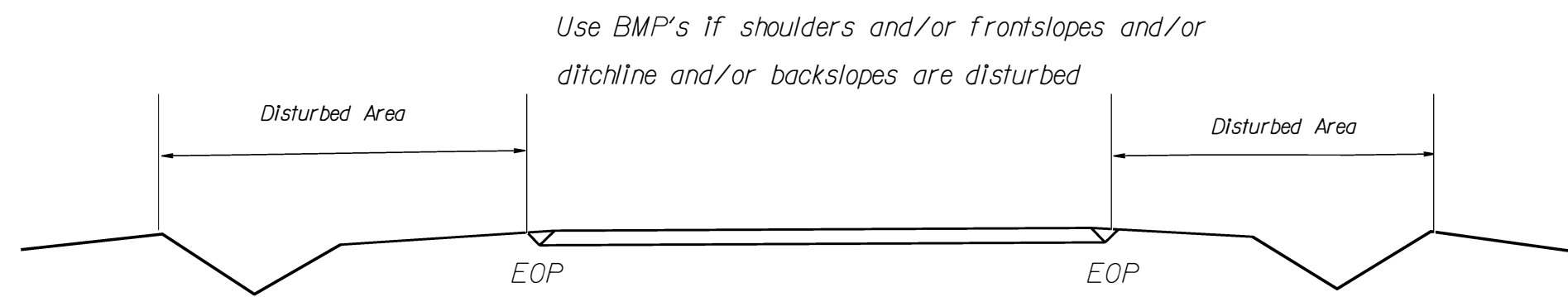
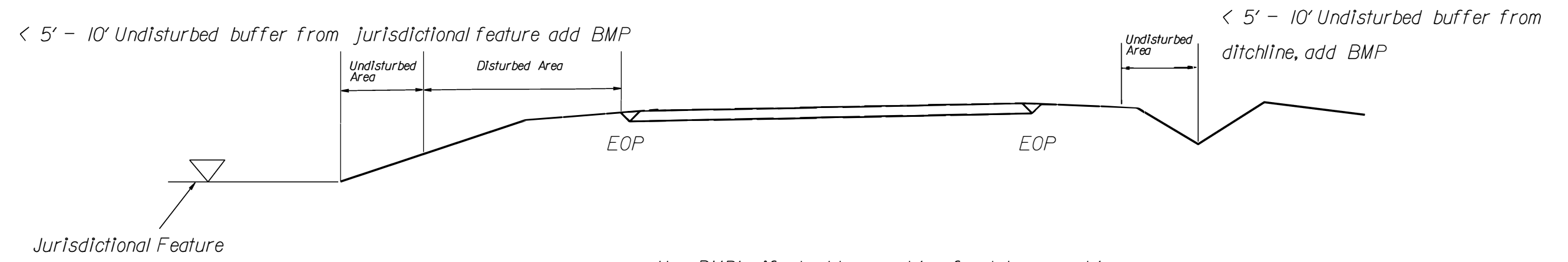
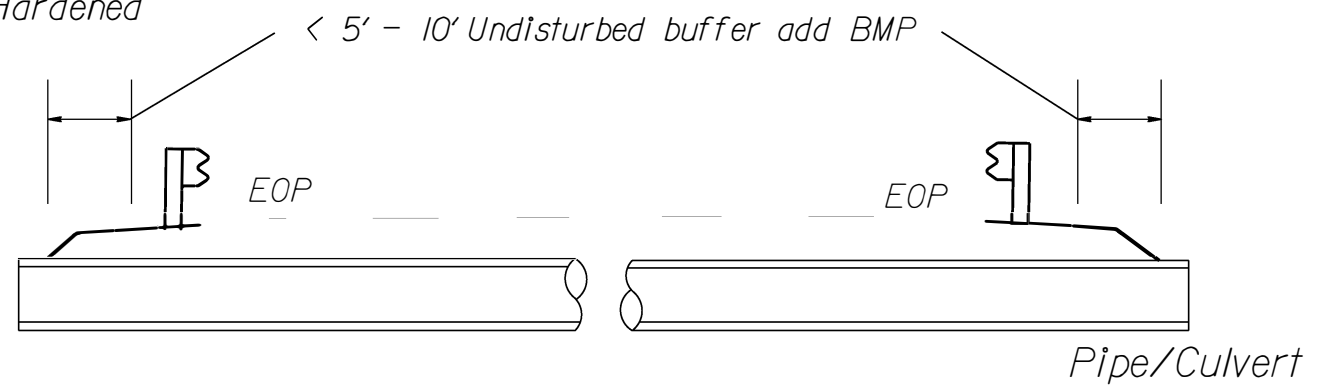

NOT TO SCALE

### High Speed Detection (≥40 mph)

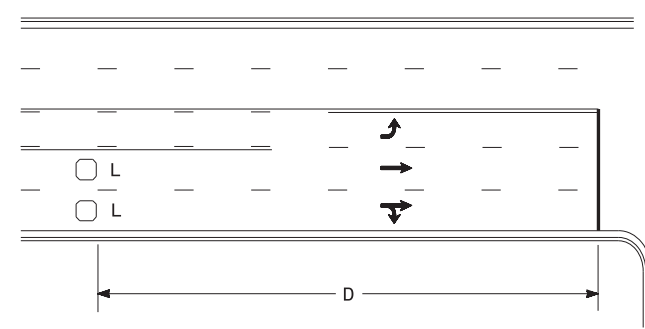

Speed Limit mph	D ft
40	250
45	300
50	355
55	420

L = 6ft X 6ft  
Wired separately

Volume Density Operation

OR

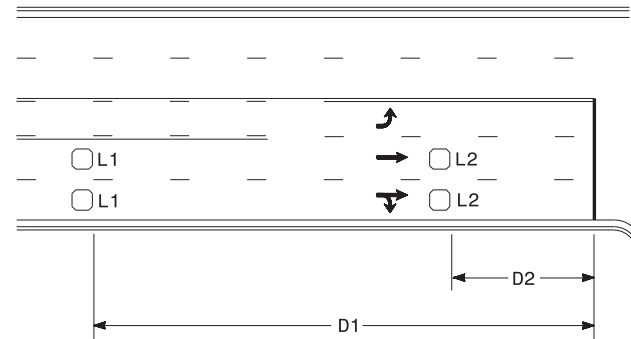

Speed Limit mph	D1 ft	D2 ft
40	250	80
45	300	90
50	355	100
55	420	110

L1 = 6ft X 6ft  
Wired in series

L2 = 6ft X 6ft  
Wired in series

"Stretch" Operation

### Low Speed Detection (≤35 mph)

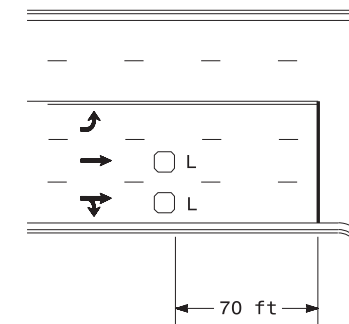

L = 6ft X 6ft  
Wired in series

OR

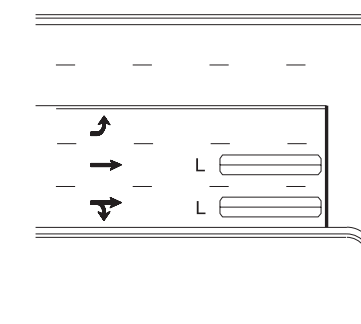

L = 6ft X 40ft  
Quadrupole loop, wired separately

### Left Turn Lane Detection

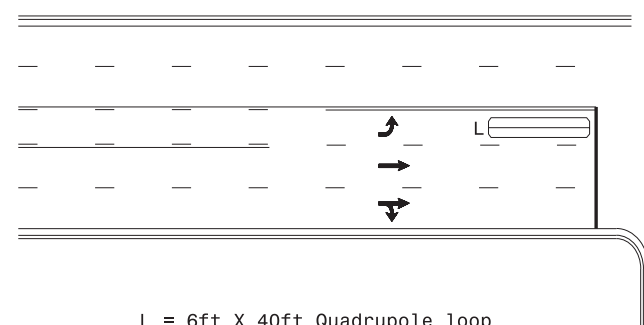

L = 6ft X 40ft Quadrupole loop

Presence Loop Detection

OR

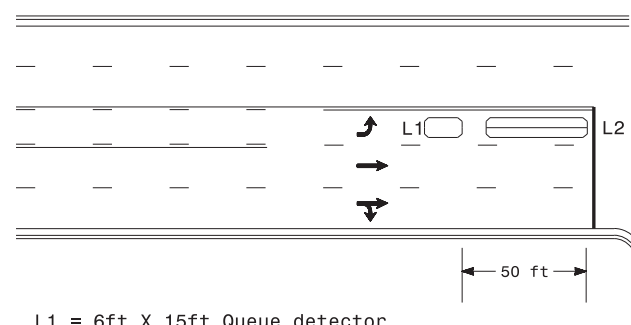

L1 = 6ft X 15ft Queue detector  
L2 = 6ft X 40ft Quadrupole loop

Queue Loop Detection

### Right Turn Lane Detection

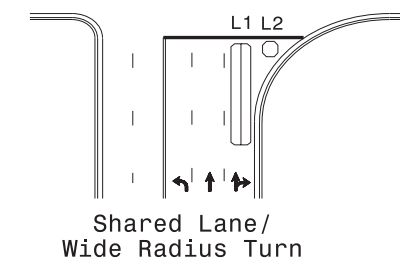

L1 = 6ft X 40ft Quadrupole loop  
L2 = 6ft X 6ft [Minimum] Presence loop  
Wired separately

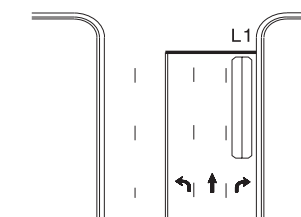

Standard Turn

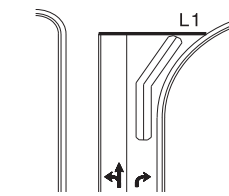

Wide Radius Turn

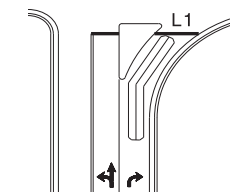

Channelized Turn

### Side Street Detection

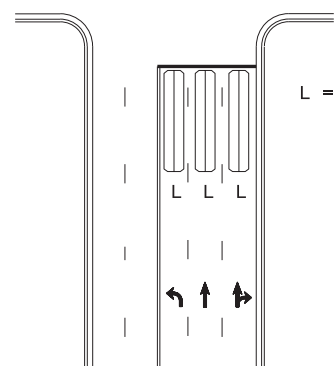

L = 6ft X 40ft  
Quadrupole loop  
Wired to separate  
detectors/channels

### Presence Loop Placement at Stop Lines

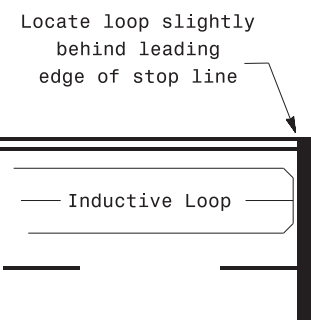

Note:  
Loop may be located in advance of stop line under any of the following conditions:  
1) stop line is greater than 15' from edge of intersecting roadway  
2) loop detects a permissive or protected/permissive left turn  
3) for an exclusive right turn lane

### Recommended Number of Turns

Single 6' X 6' loop  
(when wired separately):

Length of Lead-in ft	Number of Turns
< 250	3
250-375	4
375-525	5
> 525	6

Quadrupole loops: Use 2-4-2 turns

6' X 15' Loops:  
Lead-in < 150', use 2 turns  
Lead-in > 150', use 3 turns

750 N. Greenfield Pkwy, Garner, NC 27529

Prepared in the Offices of:

Typical Signal Loop Locations	
PLAN DATE: September 2020	REVIEWED BY: JPG
PREPARED BY: PLA	REVIEWED BY:
REVISIONS	INIT. DATE

9/8/2020  
DATE  
SIG. INVENTORY NO.

- NOTES:
- 1) DETAIL DOES NOT APPLY TO OGAFB AND ULTRA-THIN BONDED WEARING COURSE.
  - 2) BACKFILL SHOULDER WITH APPROVED MATERIAL.
  - 3) THE SHOULDER WEDGE DEVICE MAY BE DISENGAGED AT PAVED DRIVEWAYS, SIDE STREETS, HIGH SHOULDERS, AND OTHER LOCATIONS NOT FEASIBLE TO CONSTRUCT AS APPROVED BY THE ENGINEER.

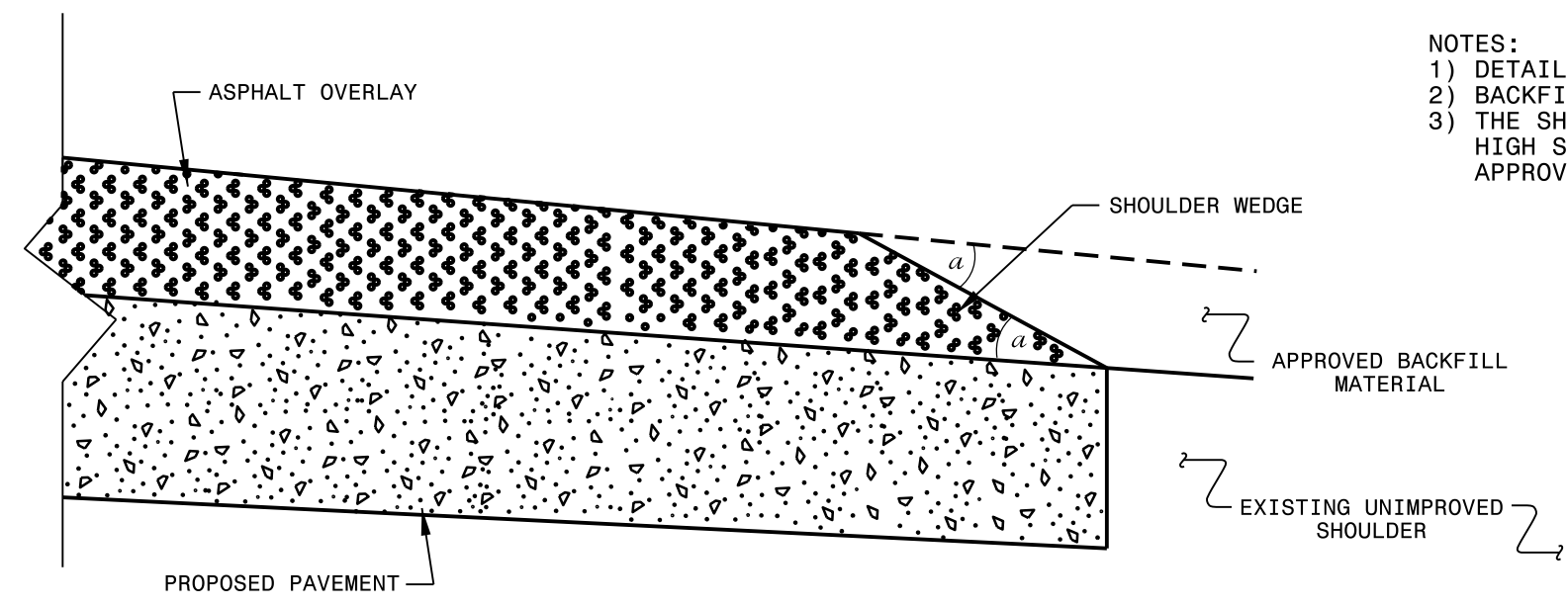

**SHOULDER WEDGE DETAIL**  
 (Resurfacing Projects w/ Widening or  
 with Existing Paved Shoulder having no dropoffs)

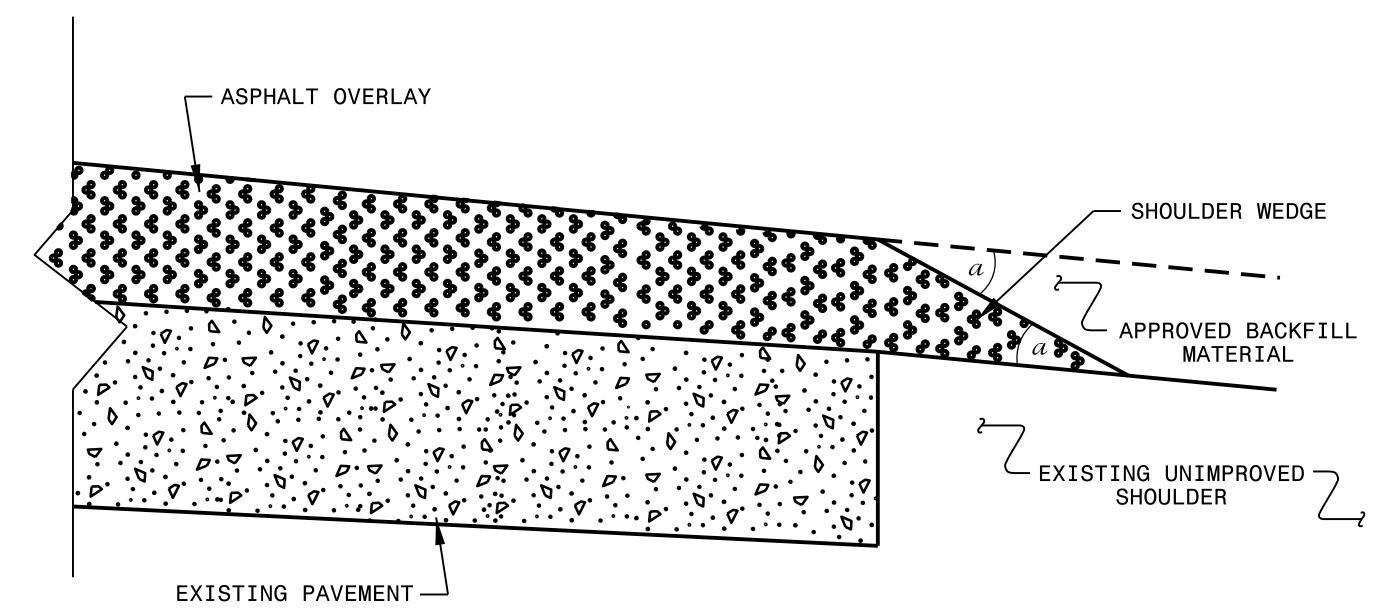

**SHOULDER WEDGE DETAIL**  
 (Resurfacing Projects w/ NO Widening)

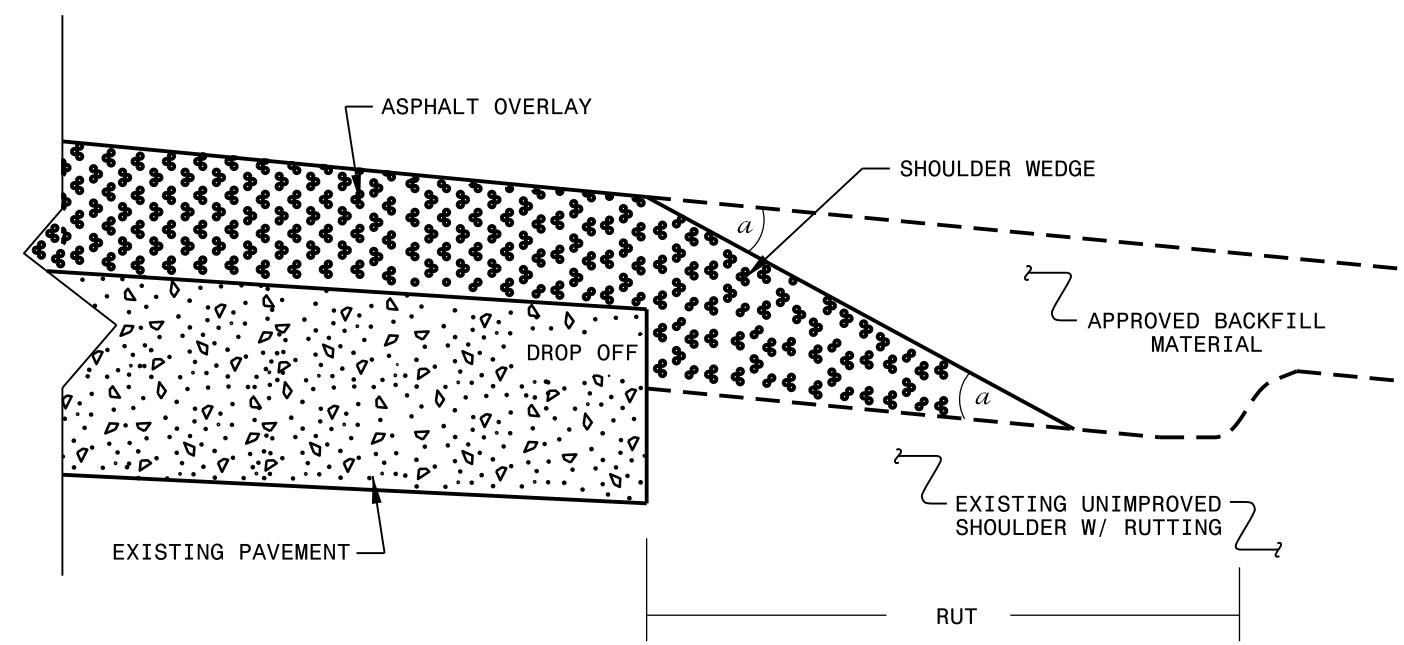

**SHOULDER WEDGE DETAIL**  
 (Resurfacing Adjacent to  
 Rutted Shoulder)

- SHOULDER WEDGE ANGLE = 30°

\$\$\$\$SYTIME\$\$\$\$  
 \$\$\$USERNAME\$\$\$

<b>CONTRACT STANDARDS AND DEVELOPMENT UNIT</b>	
Office 919-707-6950 FAX 919-250-4119	
<b>SHOULDER WEDGE DETAILS</b>	
ORIGINAL BY: T.SPELL	DATE: 7-19-11
MODIFIED BY:	DATE: 2/2/16
CHECKED BY:	DATE:
FILE SPEC.: s:\usr\detatl1\stand\shoulderwedgedeta11.dgn	

DOCUMENT NOT CONSIDERED FINAL  
UNLESS ALL SIGNATURES COMPLETED















				SUMMARY OF QUANTITIES													PROJECT NO.		SHEET NO.	TOTAL NO.						
PROJECT NO.	COUNTY	MAP NO.	ROUTE	DESCRIPTION	TYPICAL SECTION NO.	1503000000-E ASPHALT CONC INTERMEDIATE COURSE, TYPE I19.0C TON	1524200000-E ASPHALT CONC SURFACE COURSE, TYPE S9.5D TON	1575000000-E ASPHALT BINDER FOR PLANT MIX TON	1577000000-E POLYMER MODIFIED ASPHALT BINDER FOR PLANT MIX TON	1662000000-E OPEN-GRADED ASPHALT FRICTION COURSE, TYPE FC-1 MODIFIED TON	1820000000-E ASPHALT SURFACE TREATMENT, FOG SEAL SY	1840000000-E MILLED RUMBLE STRIPS (ASPHALT CONCRETE) LF	3030000000-E STEEL BEAM GUARDRAIL LF	3150000000-N ADDITIONAL GUARDRAIL POSTS EA	3210000000-N GUARDRAIL ANCHOR UNITS, TYPE CAT-1 EA	3287000000-N GUARDRAIL END UNITS, TYPE TL-3 EA	3360000000-E REMOVE EXISTING GUARDRAIL LF	4400000000-E WORK ZONE SIGNS (STATIONARY) SF	4420000000-N PORTABLE CHANGEABLE MESSAGE SIGN EA	4423000000-N WORK ZONE DIGITAL SPEED LIMIT SIGNS EA	4510000000-N LAW ENFORCEMENT HR	4600000000-N SINGLE LANE CLOSURE EA	4600000000-N RAMP/LOOP CLOSURE EA	4600000000-N RAMP/LOOP TRAFFIC CONTROL EA		
I-6046 47995.3.1	NASH AND EDGEcombe	3		US-64 (RAMP GORE) TO SR-1613	5		350		30									16				20	2			
			TOTAL FOR MAP 3				350		30											16				20	2	
		4		US-64 (LOOP GORE) TO SR-1613	6			300		20										8				40	2	2
			TOTAL FOR MAP 4				300		20											8				40	2	2
		5		US-64 (RAMP GORE) TO SR-1613	6			350		30				50			1	100		8				40	2	2
			TOTAL FOR MAP 5				350		30				50			1	100		8					40	2	2
		6		US-64 (RAMP GORE) TO SR-1613	5			550		40										16				40	2	2
			TOTAL FOR MAP 6				550		40											16				40	2	2
		7			US-64 (RAMP GORE) TO BRIDGE	5			650		40									72				40	2	2
					BRIDGE TO BRIDGE	BRIDGE																		20		2
					BRIDGE TO RESURFACE JOINT(US-64 BUS)	5			350		30				100			2	200					40	2	2
			TOTAL FOR MAP 7					1,000		70				100			2	200		72				100	4	6
		8			US-64 (RAMP GORE) TO END C&G	6			150		10									8				20	2	
					END C&G TO BRIDGE	5			200		20				100			2	200					10	1	
					BRIDGE TO BRIDGE	BRIDGE																				
			TOTAL FOR MAP 8					700		60				100			2	200		8				30	3	
		9			US-64 (RAMP GORE) TO RESURFACE JOINT(US-64 BUS)	5			400		30									8				20	2	
			TOTAL FOR MAP 9					400		30										8				20	2	
		10			US-64 (RAMP GORE) TO RESURFACE JOINT(US-64 BUS)	5			250		20			50			1	100		16				20	2	
			TOTAL FOR MAP 10					250		20			50			1	100		16					20	2	
		11			US-64 (RAMP GORE) TO RESURFACE JOINT FOR PROJECT U-3330 (US-301)	5			250		20			50			1	100		16				20	2	
			TOTAL FOR MAP 11					250		20			50			1	100		16					20	2	
		12			US-64 (LOOP GORE) TO RESURFACE JOINT FOR PROJECT U-3330 (US-301)	6			100		10									8				20	2	
			TOTAL FOR MAP 12					100		10										8				20	2	
		13			US-64 (RAMP GORE) TO RESURFACE JOINT FOR PROJECT U-3330 (US-301)	5			300		20									8				20	2	
			TOTAL FOR MAP 13					300		20										8				20	2	
		14			US-64 (RAMP GORE) TO RESURFACE JOINT FOR PROJECT U-3330 (US-301)	5			200		20									16				20	2	
			TOTAL FOR MAP 14					200		20										16				20	2	
		15			US-64 (RAMP GORE) TO NC-43	5			200		20									8				20	2	
			TOTAL FOR MAP 15					200		20										8				20	2	
		16			US-64 (LOOP GORE) TO NC-43	6			150		10									16				20	2	
			TOTAL FOR MAP 16					150		10										16				20	2	
		17			US-64 (LOOP GORE) TO NC-43	6			150		10									16				20	2	
			TOTAL FOR MAP 17					150		10										16				20	2	
		18			US-64 (RAMP GORE) TO NC-43	5			250		20									8				20	2	
			TOTAL FOR MAP 18					250		20										8				20	2	
		19			US-64 (RAMP GORE) TO US-301 BUS	5			300		20			50			1	100		16				20	2	
			TOTAL FOR MAP 19					300		20			50			1	100		16					20	2	
		20			US-64 (LOOP GORE) TO US-301 BUS	6			200		20									8				20	2	
			TOTAL FOR MAP 20					200		20										8				20	2	
		21			US-64 (RAMP GORE) TO US-301 BUS	5			400		30			50			1	100		8				20	2	
			TOTAL FOR MAP 21					400		30			50			1	100		8					20	2	
		22			US-64 (RAMP GORE) TO US-301 BUS	6			200		20									16				20	2	
			TOTAL FOR MAP 22					200		20										16				20	2	
		23			US-64 (RAMP GORE) TO NC-97	6			150		10									8				20	2	
			TOTAL FOR MAP 23					150		10										8				20	2	
		24			US-64 (LOOP GORE) TO NC-97	5			200		20									16				20	2	
			TOTAL FOR MAP 24					200		20										16				20	2	
		25			US-64 (LOOP GORE) TO NC-97	6			200		20									8				20	2	
			TOTAL FOR MAP 25					200		20										8				20	2	
		26			US-64 (RAMP GORE) TO NC-97	5			250		20			50			1	100		16				20	2	
			TOTAL FOR MAP 26					250		20			50			1	100		16					20	2	
		27			US-64 (RAMP GORE) TO US-64 A	5			300		20									16				20	2	
			TOTAL FOR MAP 27					300		20										16				20	2	
		28			US-64 (RAMP GORE) TO US-64 A	5			250		20									8				20	2	
			TOTAL FOR MAP 28					250		20										8				20	2	

## SUMMARY OF QUANTITIES

PROJECT NO.	COUNTY	MAP NO.	ROUTE	DESCRIPTION	TYPICAL SECTION NO.	PROJECT NO.																SHEET NO.	TOTAL NO.							
						I-6046 47995.3.1																18	32							
						1503000000-E ASPHALT CONC INTERMEDIATE COURSE, TYPE I19.0C TON	1524200000-E ASPHALT CONC SURFACE COURSE, TYPE S9.5D TON	1575000000-E ASPHALT BINDER FOR PLANT MIX TON	1577000000-E POLYMER MODIFIED ASPHALT BINDER FOR PLANT MIX TON	1662000000-E OPEN-GRADED ASPHALT FRICTION COURSE, TYPE FC-1 MODIFIED TON	1820000000-E ASPHALT SURFACE TREATMENT, FOG SEAL SY	1840000000-E MILLED RUMBLE STRIPS (ASPHALT CONCRETE) LF	3030000000-E STEEL BEAM GUARDRAIL LF	3150000000-N ADDITIONAL GUARDRAIL POSTS EA	3210000000-N GUARDRAIL ANCHOR UNITS, TYPE CAT-1 EA	3287000000-N GUARDRAIL END UNITS, TYPE TL-3 EA	3360000000-E REMOVE EXISTING GUARDRAIL LF	4400000000-E WORK ZONE SIGNS (STATIONARY) SF	4420000000-N PORTABLE CHANGEABLE MESSAGE SIGN EA	4423000000-N WORK ZONE DIGITAL SPEED LIMIT SIGNS EA	4510000000-N LAW ENFORCEMENT HR	4600000000-N SINGLE LANE CLOSURE EA	4600000000-N RAMP/LOOP CLOSURE EA	4600000000-N RAMP/LOOP TRAFFIC CONTROL EA						
I-6046 47995.3.1 NASH AND EDGEcombe	COUNTY	MAP NO.	ROUTE	US-64 (RAMP GORE) TO US-64 A	5		250		20									8			20			2						
				TOTAL FOR MAP 29			250		20											8			20			2				
				US-64 (RAMP GORE) TO US-64 A	5		300		20												16			20			2			
				TOTAL FOR MAP 30			300		20												16			20			2			
				US-64 (RAMP GORE) TO SR-1225	5		250		20													8			20			2		
				TOTAL FOR MAP 31			250		20													8			20			2		
				US-64 (RAMP GORE) TO SR-1225	5		350		30					100					2	200		16			20			2		
				TOTAL FOR MAP 32			350		30				100					2	200		16				20			2		
				US-64 (RAMP GORE) TO SR-1225	5		400		30					50					1	100		8			20			2		
				TOTAL FOR MAP 33			400		30				50					1	100		8				20			2		
				US-64 (RAMP GORE) TO SR-1225	5		250		20													16			20			2		
				TOTAL FOR MAP 34			250		20													16			20			2		
				<b>TOTAL</b>						5,550	66,800	780	6,210	27,050	23,050	296,410	5,125		5	77	9,000	584			3,430	231	67	12		
				<b>TOTAL FROM SUMMARY OF QUANTITIES - DRAINAGE</b>																										
				<b>GRAND TOTAL</b>						5,550	66,800	780	6,210	27,050	23,050	296,410	5,125	10	5	77	9,000	584	4	10	3,430	231	67	12		
				<b>PAY ITEM TOTAL</b>						5,550	66,800	780	6,210	27,050	23,050	296,410	5,125	10	5	77	9,000	584	4	10	3,430	231	67	12		



**SUMMARY OF QUANTITIES**

PROJECT NO.	COUNTY	MAP NO.	ROUTE	DESCRIPTION	TYPICAL SECTION NO.	PROJECT NO.															SHEET NO.	TOTAL NO.																				
						I-6046 47995.3.1															20	32																				
						4600000000-N CONNECTED LANE CLOSURE DEVICE	EA	4600000000-N DOUBLE LANE CLOSURE	EA	4688000000-E THERMOPLASTIC PAVEMENT MARKING LINES (6", 90 MILS) WHITE	LF	4688000000-E THERMOPLASTIC PAVEMENT MARKING LINES (6", 90 MILS) YELLOW	LF	4700000000-E THERMOPLASTIC PAVEMENT MARKING LINES (12", 90 MILS) WHITE	LF	4700000000-E THERMOPLASTIC PAVEMENT MARKING LINES (12", 90 MILS) YELLOW	LF	4720000000-E THERMOPLASTIC PAVEMENT MARKING CHARACTER (90 MILS) "ONLY"	EA	4725000000-E THERMOPLASTIC PAVEMENT MARKING SYMBOL (90 MILS) MERGE ARROW	EA	4725000000-E THERMOPLASTIC PAVEMENT MARKING SYMBOL (90 MILS) WRONG-WAY RAMP ARROW	EA	4725000000-E THERMOPLASTIC PAVEMENT MARKING SYMBOL (90 MILS) LEFT TURN ARROW	EA	4725000000-E THERMOPLASTIC PAVEMENT MARKING SYMBOL (90 MILS) RIGHT TURN ARROW	EA	4725000000-E THERMOPLASTIC PAVEMENT MARKING SYMBOL (90 MILS) STRAIGHT & LEFT TURN ARROW	EA	4775000000-E COLD APPLIED PLASTIC PAVEMENT MARKING LINES, TYPE 2 (6") WHITE	LF	4775000000-E COLD APPLIED PLASTIC PAVEMENT MARKING LINES, TYPE 2 (6") YELLOW	LF	4785000000-E COLD APPLIED PLASTIC PAVEMENT MARKING LINES, TYPE 2 (12") WHITE	LF	4815000000-E PAINT PAVEMENT MARKING LINES (6") WHITE	LF	4815000000-E PAINT PAVEMENT MARKING LINES (6") YELLOW	LF	4825000000-E PAINT PAVEMENT MARKING LINES (12") WHITE	LF	
				END RESURFACING ON PROJECT U-5996 TO BEGIN TAPER FOR CD LANE	1		1	2,000	1,340				4								2															2,000	1,340					
				BEGIN TAPER FOR CD LANE TO CD LANE & BEGIN PAVED DITCH	4			1,140	890	1,530																										1,140	890	1,530				
				CD LANE & BEGIN PAVED DITCH TO BEGIN BRIDGE OVER I-95	3			4,770	4,140	1,870																											4,770	4,140	1,870			
				BEGIN BRIDGE OVER I-95 TO END BRIDGE OVER I-95	BRIDGE																						670	390														
				END BRIDGE OVER I-95 TO CD LANE & END PAVED DITCH	3			6,290	5,530	1,690				3																						6,290	5,530	1,690				
				CD LANE & END PAVED DITCH TO END TAPER FOR CD LANE	4			2,340	1,540	970				3																						2,340	1,540	970				
				END TAPER FOR CD LANE TO BEGIN SR-1613 EXIT RAMP	1			4,190	3,350																											4,190	3,350					
				BEGIN SR-1613 EXIT RAMP TO GORE	2			840	630	820																										840	630	820				
				GORE TO GORE	1			2,320	1,850																											2,320	1,850					
				GORE TO END SR-1613 ENTRANCE RAMP	2			380	310	610																										380	310	610				
				END SR-1613 ENTRANCE RAMP TO BEGIN US64 BUS EXIT RAMP	1		1	2,210	1,470				8								4															2,210	1,470					
				BEGIN US64 BUS EXIT RAMP TO GORE	2			1,100	880	1,750																										1,100	880	1,750				
				GORE TO GORE	1			2,130	1,700																											2,130	1,700					
				GORE TO END US-64BUS ENTRANCE RAMP	2			1,720	1,260	570				3																						1,720	1,260	570				
				END US-64BUS ENTRANCE RAMP TO BEGIN BRIDGE OVER SR-1616	1			700	560																											700	560					
				BEGIN BRIDGE OVER SR-1616 TO END BRIDGE OVER SR-1616	BRIDGE																						200	160														
				END BRIDGE OVER SR-1616 TO BEGIN US-301BYP EXIT RAMP	1			760	610																											760	610					
				BEGIN US-301BYP EXIT RAMP TO GORE	2			780	590	860																										780	590	860				
				GORE TO BEGIN BRIDGE OVER US-301BYP	1			1,440	1,150																											1,440	1,150					
				BEGIN BRIDGE OVER US-301BYP TO BEGIN BRIDGE OVER US-301BYP	BRIDGE																																					
				BEGIN BRIDGE OVER US-301BYP TO GORE	1			1,000	800																											1,000	800					
				GORE TO END US-301BYP ENTRANCE RAMP	2			470	340	370																										470	340	370				
				END US-301BYP ENTRANCE RAMP TO BEGIN NC-43BUS EXIT RAMP	1		1	1,630	1,090				4								2															1,630	1,090					
				BEGIN NC-43BUS EXIT RAMP TO GORE	2			430	340	680																										430	340	680				
				GORE TO GORE	1			770	620																											770	620					
				GORE TO BEGIN BRIDGE OVER NC-43BUS	2			340	250	330																										340	250	330				
				BEGIN BRIDGE OVER NC-43BUS TO END BRIDGE OVER NC-43BUS	BRIDGE																																					
				END BRIDGE OVER NC-43BUS TO BEGIN NC-43BUS ENTRANCE RAMP	2			1,550	1,030					3																						1,550	1,030					
				BEGIN NC-43BUS ENTRANCE RAMP TO BEGIN US-301BUS EXIT RAMP	1			1,940	1,550																											1,940	1,550					
				BEGIN US-301BUS EXIT RAMP TO GORE	2			800	590	740																										800	590	740				
				GORE TO GORE	1			1,670	1,330																											1,670	1,330					
				GORE TO BEGIN BRIDGE OVER US-301BUS & END ENTRANCE LOOP	2			330	290	420																										330	290	420				
				BEGIN BRIDGE OVER US-301BUS & END ENTRANCE LOOP TO END BRIDGE OVER US-301BUS	BRIDGE			2																																		
				END BRIDGE OVER US-301BUS TO BEGIN BRIDGE OVER RAILROAD	1			510	340				4								2															510	340					
				BEGIN BRIDGE OVER RAILROAD TO END BRIDGE OVER RAILROAD	BRIDGE																																					
				END BRIDGE OVER RAILROAD TO BEGIN BRIDGE OVER NC-97	1			900	600				4								2															900	600					
				BEGIN BRIDGE OVER NC-97 TO END BRIDGE OVER NC-97 & BEGIN EXIT LOOP	BRIDGE			2																																		
				END BRIDGE OVER NC-97 & BEGIN EXIT LOOP TO GORE	2			250	270	400																											250	270	400			
				GORE TO BEGIN BRIDGE OVER TAR RIVER	1			800	640																											800	640					
				BEGIN BRIDGE OVER TAR RIVER TO END BRIDGE OVER TAR RIVER	BRIDGE			2																																		
				END BRIDGE OVER TAR RIVER TO END NC-97 ENTRANCE RAMP	2			1,750	1,100					3																						1,750	1,100					
				END NC-97 ENTRANCE RAMP TO BEGIN BRIDGE OVER SR-1243	1			1,720	1,380																											1,720	1,380					
				BEGIN BRIDGE OVER SR-1243 TO END BRIDGE OVER SR-1243	BRIDGE																																					
				END BRIDGE OVER SR-1243 TO BEGIN US-64BUS EXIT RAMP	1			5,900	4,720</																																	

SUMMARY OF QUANTITIES

PROJECT NO. I-6046 47995.3.1 SHEET NO. 21 TOTAL NO. 32

Table with 23 columns: PROJECT NO, COUNTY, MAP NO, ROUTE, DESCRIPTION, TYPICAL SECTION NO., 4600000000-N CONNECTED LANE CLOSURE DEVICE, 4600000000-N DOUBLE LANE CLOSURE, 4688000000-E THERMOPLASTIC PAVEMENT MARKING LINES (6", 90 MILS) WHITE, 4688000000-E THERMOPLASTIC PAVEMENT MARKING LINES (6", 90 MILS) YELLOW, 4700000000-E THERMOPLASTIC PAVEMENT MARKING LINES (12", 90 MILS) WHITE, 4700000000-E THERMOPLASTIC PAVEMENT MARKING LINES (12", 90 MILS) YELLOW, 4720000000-E THERMOPLASTIC PAVEMENT MARKING CHARACTER (90 MILS) "ONLY", 4725000000-E THERMOPLASTIC PAVEMENT MARKING SYMBOL (90 MILS) MERGE ARROW, 4725000000-E THERMOPLASTIC PAVEMENT MARKING SYMBOL (90 MILS) WRONG-WAY RAMP ARROW, 4725000000-E THERMOPLASTIC PAVEMENT MARKING SYMBOL (90 MILS) LEFT TURN ARROW, 4725000000-E THERMOPLASTIC PAVEMENT MARKING SYMBOL (90 MILS) RIGHT TURN ARROW, 4725000000-E THERMOPLASTIC PAVEMENT MARKING SYMBOL (90 MILS) STRAIGHT & LEFT TURN ARROW, 4725000000-E THERMOPLASTIC PAVEMENT MARKING SYMBOL (90 MILS) STRAIGHT ARROW, 4775000000-E COLD APPLIED PLASTIC PAVEMENT MARKING LINES, TYPE 2 (6") WHITE, 4775000000-E COLD APPLIED PLASTIC PAVEMENT MARKING LINES, TYPE 2 (6") YELLOW, 4815000000-E PAINT PAVEMENT MARKING LINES (6") WHITE, 4815000000-E PAINT PAVEMENT MARKING LINES (6") YELLOW, 4825000000-E PAINT PAVEMENT MARKING LINES (12") WHITE.

I-6046 47995.3.1 NASH AND EDGEcombe

## SUMMARY OF QUANTITIES

PROJECT NO.  
I-6046 47995.3.1

SHEET NO.  
22

TOTAL NO.  
32

PROJECT NO.	COUNTY	MAP NO.	ROUTE	DESCRIPTION	TYPICAL SECTION NO.	4600000000-N	4600000000-N	4688000000-E	4688000000-E	4700000000-E	4700000000-E	4720000000-E	4720000000-E	4725000000-E	4725000000-E	4725000000-E	4725000000-E	4725000000-E	4725000000-E	4725000000-E	4725000000-E	4725000000-E	4775000000-E	4775000000-E	4815000000-E	4815000000-E	4825000000-E					
						CONNECTED LANE CLOSURE DEVICE EA	DOUBLE LANE CLOSURE EA	THERMOPLASTIC PAVEMENT MARKING LINES (6", 90 MILS) WHITE LF	THERMOPLASTIC PAVEMENT MARKING LINES (6", 90 MILS) YELLOW LF	THERMOPLASTIC PAVEMENT MARKING LINES (12", 90 MILS) WHITE LF	THERMOPLASTIC PAVEMENT MARKING LINES (12", 90 MILS) YELLOW LF	THERMOPLASTIC PAVEMENT MARKING CHARACTER (90 MILS) "ONLY" EA	THERMOPLASTIC PAVEMENT MARKING SYMBOL (90 MILS) MERGE ARROW EA	THERMOPLASTIC PAVEMENT MARKING SYMBOL (90 MILS) WRONG-WAY RAMP ARROW EA	THERMOPLASTIC PAVEMENT MARKING SYMBOL (90 MILS) LEFT TURN ARROW EA	THERMOPLASTIC PAVEMENT MARKING SYMBOL (90 MILS) RIGHT TURN ARROW EA	THERMOPLASTIC PAVEMENT MARKING STRAIGHT & LEFT TURN ARROW EA	THERMOPLASTIC PAVEMENT MARKING STRAIGHT ARROW EA	COLD APPLIED PLASTIC PAVEMENT MARKING LINES, TYPE 2 (6") WHITE LF	COLD APPLIED PLASTIC PAVEMENT MARKING LINES, TYPE 2 (6") YELLOW LF	COLD APPLIED PLASTIC PAVEMENT MARKING LINES, TYPE 2 (12") WHITE LF	PAINT PAVEMENT MARKING LINES (6") WHITE LF	PAINT PAVEMENT MARKING LINES (6") YELLOW LF	PAINT PAVEMENT MARKING LINES (12") WHITE LF								
I-6046 47995.3.1 NASH AND EDGE COMBE		29		US-64 (RAMP GORE) TO US-64 A	5			1,060	1,000					1	1	1											1,060	1,000				
				TOTAL FOR MAP 29						1,060	1,000						1	1	1										1,060	1,000		
		30		US-64 (RAMP GORE) TO US-64 A	5				1,400	1,400																				1,400	1,400	
				TOTAL FOR MAP 30						1,400	1,400																			1,400	1,400	
		31		US-64 (RAMP GORE) TO SR-1225	5				1,230	1,230																				1,230	1,230	
				TOTAL FOR MAP 31						1,230	1,230																			1,230	1,230	
		32		US-64 (RAMP GORE) TO SR-1225	5				1,710	1,710						1														1,710	1,710	
				TOTAL FOR MAP 32						1,710	1,710						1													1,710	1,710	
		33		US-64 (RAMP GORE) TO SR-1225	5				1,890	1,890						1														1,890	1,890	
				TOTAL FOR MAP 33						1,890	1,890						1													1,890	1,890	
34		US-64 (RAMP GORE) TO SR-1225	5				1,170	1,170																				1,170	1,170			
		TOTAL FOR MAP 34						1,170	1,170																			1,170	1,170			
<b>TOTAL</b>								<b>33</b>	<b>219,200</b>	<b>192,390</b>	<b>24,720</b>	<b>410</b>	<b>44</b>	<b>45</b>	<b>10</b>	<b>20</b>	<b>47</b>	<b>4</b>	<b>2</b>	<b>5,660</b>	<b>3,590</b>	<b>400</b>	<b>219,200</b>	<b>192,390</b>	<b>24,720</b>							
<b>TOTAL FROM SUMMARY OF QUANTITIES - DRAINAGE</b>																																
<b>GRAND TOTAL</b>								<b>4</b>	<b>33</b>	<b>219,200</b>	<b>192,390</b>	<b>24,720</b>	<b>410</b>	<b>44</b>	<b>45</b>	<b>10</b>	<b>20</b>	<b>47</b>	<b>4</b>	<b>2</b>	<b>5,660</b>	<b>3,590</b>	<b>400</b>	<b>219,200</b>	<b>192,390</b>	<b>24,720</b>						
<b>PAY ITEM TOTAL</b>								<b>4</b>	<b>33</b>	<b>411,590</b>	<b>25,130</b>	<b>44</b>	<b>128</b>							<b>9,250</b>	<b>400</b>	<b>411,590</b>	<b>25,130</b>									

### SUMMARY OF QUANTITIES

																PROJECT NO.		SHEET NO.	TOTAL NO.						
																I-6046 47995.3.1		23	32						
PROJECT NO	COUNTY	MAP NO	ROUTE	DESCRIPTION	TYPICAL SECTION NO.	4825000000-E PAINT PAVEMENT MARKING LINES (12") YELLOW LF	4835000000-E PAINT PAVEMENT MARKING LINES (24") WHITE LF	4840000000-N PAINT PAVEMENT MARKING CHARACTER "ONLY" EA	4845000000-N PAINT PAVEMENT MARKING SYMBOL MERGE ARROW EA	4845000000-N PAINT PAVEMENT MARKING SYMBOL WRONG-WAY RAMP ARROW EA	4845000000-N PAINT PAVEMENT MARKING SYMBOL LEFT TURN ARROW EA	4845000000-N PAINT PAVEMENT MARKING SYMBOL RIGHT TURN ARROW EA	4845000000-N PAINT PAVEMENT MARKING STRAIGHT & LEFT TURN ARROW EA	4845000000-N PAINT PAVEMENT MARKING STRAIGHT ARROW EA	4855000000-E REMOVAL OF PAVEMENT MARKING LINES (6") LF	4865000000-E REMOVAL OF PAVEMENT MARKING LINES (12") LF	4891000000-E THERMOPLASTIC PAVEMENT MARKING LINES (24", 90 MILS) WHITE LF	4895000000-N NON-CAST IRON SNOWPLOWABLE PAVEMENT MARKER (CRYSTAL/RED) EA	4895000000-N NON-CAST IRON SNOWPLOWABLE PAVEMENT MARKER (YELLOW) EA	4935000000-N FLEXIBLE DELINEATORS (CRYSTAL) EA	6000000000-E TEMPORARY SILT FENCE LF	7444000000-E INDUCTIVE LOOP SAWCUT LF	8867000000-E SILICON JOINT REPLACEMENT (LESS THAN 1" WIDE) LF	8867000000-E SILICON JOINT REPLACEMENT (1" TO 2" WIDE) LF	
				BEGIN SR-1225 EXIT RAMP TO GORE	2													10							
				GORE TO GORE	7													40				2,920			
				GORE TO END SR-1225 EXIT RAMP	2				3									20							
				END SR-1225 EXIT RAMP TO SR-1233 (THOMAS ROAD)	7													175				13,800			
				SR-1233 (THOMAS ROAD) TO BEGIN US64A EXIT RAMP	1													105							
				BEGIN US64A EXIT RAMP TO GORE	2													10							
				GORE TO GORE	1													35							
				GORE TO END US64A ENTRANCE RAMP	2				3									20							
				END US64A ENTRANCE RAMP TO BEGIN BRIDGE OVER SR-1243	1													55							
				BEGIN BRIDGE OVER SR-1243 TO END BRIDGE OVER SR-1243	BRIDGE										580									120	40
				END BRIDGE OVER SR-1243 TO BEGIN NC97 EXIT RAMP	1													30							
				BEGIN NC97 EXIT RAMP TO BEGIN BRIDGE OVER TAR RIVER	2													5							
				BEGIN BRIDGE OVER TAR RIVER TO END BRIDGE OVER TAR RIVER (GORE)	BRIDGE																			188	63
				END BRIDGE OVER TAR RIVER (GORE) TO GORE	1													10							
				GORE TO BEGIN BRIDGE OVER NC-97 & END EXIT LOOP	2													5							
				BEGIN BRIDGE OVER NC-97 & END EXIT LOOP TO END BRIDGE OVER NC-97	BRIDGE										520									116	39
				END BRIDGE OVER NC-97 TO BEGIN BRIDGE OVER RAILROAD	1			4			2							20							
				BEGIN BRIDGE OVER RAILROAD TO END BRIDGE OVER RAILROAD	BRIDGE										380									116	39
				END BRIDGE OVER RAILROAD TO BEGIN BRIDGE OVER US-301BUS	1			4			2							10							
				BEGIN BRIDGE OVER US-301BUS TO END BRIDGE OVER US-301BUS	BRIDGE										450									116	39
				END BRIDGE OVER US-301BUS TO BEGIN US-301BUS EXIT LOOP	1													5							
				BEGIN US-301BUS EXIT LOOP TO GORE	2													5							
				GORE TO GORE	1													15							
				GORE TO END US-301BUS ENTRANCE RAMP	2													15							
				END US-301BUS ENTRANCE RAMP TO BEGIN NC-43BUS EXIT RAMP	1			4			2							30							
				BEGIN NC-43BUS EXIT RAMP TO GORE	2													10							
				GORE TO GORE	1													10							
				GORE TO BEGIN BRIDGE OVER NC-43BUS	2													5							
				BEGIN BRIDGE OVER NC-43BUS TO END BRIDGE OVER NC-43BUS	BRIDGE										620									116	39
				END BRIDGE OVER NC-43BUS TO END NC-43BUS ENTRANCE RAMP	2				3									15							
				END NC-43BUS ENTRANCE RAMP TO BEGIN US-301BYP EXIT LOOP	1													30							
				BEGIN US-301BYP EXIT LOOP TO BEGIN BRIDGE OVER US-301BYP	2													5							
				BEGIN BRIDGE OVER US-301BYP TO END BRIDGE OVER US-301BYP	BRIDGE										620									116	39
				END BRIDGE OVER US-301BYP TO GORE	2													5							
				GORE TO GORE	1													15							
				GORE TO BEGIN BRIDGE OVER SR-1616	2				2									15							
				BEGIN BRIDGE OVER SR-1616 TO END BRIDGE OVER SR-1616	BRIDGE																			50	17
				END BRIDGE OVER SR-1616 TO END US-301BYP ENTRANCE RAMP	2													5							
				END US-301BYP ENTRANCE RAMP TO BEGIN US-64BUS EXIT LOOP	1													40							
				BEGIN US-64BUS EXIT LOOP TO GORE	2													10							
				GORE TO GORE	1													15							
				GORE TO END US-64BUS ENTRANCE RAMP	2				1									5							
				END US-64BUS ENTRANCE RAMP TO BEGIN TAPER 3-4 LANES	1				2									20							
				BEGIN TAPER 3-4 LANES TO END TAPER 3-4 LANES	1													20							
				END TAPER 3-4 LANES TO BEGIN SR-1613 EXIT LOOP	1			4			2							30							
				BEGIN SR-1613 EXIT LOOP TO GORE	2													5							
				GORE TO GORE	1													15							
				GORE TO END SR-1613 ENTRANCE RAMP	2				3									20							
				END SR-1613 ENTRANCE RAMP TO BEGIN TAPER FOR CD LANE	1													45							
				BEGIN TAPER FOR CD LANE TO CD LANE & BEGIN PAVED DITCH	4													15							
				CD LANE & BEGIN PAVED DITCH TO BEGIN BRIDGE OVER I-95	3													30							
				BEGIN BRIDGE OVER I-95 TO END BRIDGE OVER I-95	BRIDGE										1,060									279	93
				END BRIDGE OVER I-95 TO CD LANE & END PAVED DITCH	3				3									35							
				CD LANE & END PAVED DITCH TO END TAPER FOR PAVED DITCH @ CD LANE	4													15							
				END TAPER FOR PAVED DITCH @ CD LANE TO END RESURFACING ON PROJECT U-5996	1			4			2							25							
				<b>TOTAL FOR MAP 1</b>				<b>20</b>	<b>20</b>		<b>10</b>				<b>4,230</b>			<b>1,080</b>			<b>16,720</b>		<b>1,217</b>	<b>408</b>	



PROJECT NO. COUNTY MAP NO		SUMMARY OF QUANTITIES																	PROJECT NO.	SHEET NO.	TOTAL NO.	
		DESCRIPTION																	I-6046 47995.3.1	24	32	
		TYPICAL SECTION NO.	4825000000-E PAINT PAVEMENT MARKING LINES (12") YELLOW  LF	4835000000-E PAINT PAVEMENT MARKING LINES (24") WHITE  LF	4840000000-N PAINT PAVEMENT MARKING CHARACTER "ONLY"  EA	4845000000-N PAINT PAVEMENT MARKING SYMBOL MERGE ARROW  EA	4845000000-N PAINT PAVEMENT MARKING SYMBOL WRONG- WAY RAMP ARROW  EA	4845000000-N PAINT PAVEMENT MARKING SYMBOL LEFT TURN ARROW  EA	4845000000-N PAINT PAVEMENT MARKING SYMBOL RIGHT TURN ARROW  EA	4845000000-N PAINT PAVEMENT MARKING SYMBOL STRAIGHT & LEFT TURN ARROW  EA	4845000000-N PAINT PAVEMENT MARKING SYMBOL STRAIGHT ARROW  EA	4855000000-E REMOVAL OF PAVEMENT MARKING LINES (6")  LF	4865000000-E REMOVAL OF PAVEMENT MARKING LINES (12")  LF	4891000000-E THERMOPLASTIC PAVEMENT MARKING LINES (24", 90 MILS) WHITE  LF	4895000000-N NON-CAST IRON SNOWPLOWABLE PAVEMENT MARKER (CRYSTAL/RED)  EA	4895000000-N NON-CAST IRON SNOWPLOWABLE PAVEMENT MARKER (YELLOW)  EA	4935000000-N FLEXIBLE DELINEATORS (CRYSTAL)  EA	6000000000-E TEMPORARY SILT FENCE  LF	7444000000-E INDUCTIVE LOOP SAWCUT  LF	8867000000-E SILICON JOINT REPLACEMENT (LESS THAN 1" WIDE)  LF	8867000000-E SILICON JOINT REPLACEMENT (1" TO 2" WIDE)  LF	
I-6046 47995.3.1 NASH AND EDGEcombe	US-64 EBL 2	END RESURFACING ON PROJECT U-5996 TO BEGIN TAPER FOR CD LANE	1			4			2					35								
		BEGIN TAPER FOR CD LANE TO CD LANE & BEGIN PAVED DITCH	4											15								
		CD LANE & BEGIN PAVED DITCH TO BEGIN BRIDGE OVER I-95	3											30								
		BEGIN BRIDGE OVER I-95 TO END BRIDGE OVER I-95	BRIDGE								1,060									279	93	
		END BRIDGE OVER I-95 TO CD LANE & END PAVED DITCH	3			3									35							
		CD LANE & END PAVED DITCH TO END TAPER FOR CD LANE	4			3									20							
		END TAPER FOR CD LANE TO BEGIN SR-1613 EXIT RAMP	1												45							
		BEGIN SR-1613 EXIT RAMP TO GORE	2												10							
		GORE TO GORE	1												25							
		GORE TO END SR-1613 ENTRANCE RAMP	2												5							
		END SR-1613 ENTRANCE RAMP TO BEGIN US64 BUS EXIT RAMP	1			8				4					40							
		BEGIN US64 BUS EXIT RAMP TO GORE	2												15							
		GORE TO GORE	1												25							
		GORE TO END US-64BUS ENTRANCE RAMP	2			3									20							
		END US-64BUS ENTRANCE RAMP TO BEGIN BRIDGE OVER SR-1616	1												10							
		BEGIN BRIDGE OVER SR-1616 TO END BRIDGE OVER SR-1616	BRIDGE									360									48	16
		END BRIDGE OVER SR-1616 TO BEGIN US-301BYP EXIT RAMP	1												10							
		BEGIN US-301BYP EXIT RAMP TO GORE	2												10							
		GORE TO BEGIN BRIDGE OVER US-301BYP	1												15							
		BEGIN BRIDGE OVER US-301BYP TO BEGIN BRIDGE OVER US-301BYP	BRIDGE									540									96	32
		BEGIN BRIDGE OVER US-301BYP TO GORE	1												10							
		GORE TO END US-301BYP ENTRANCE RAMP	2												5							
		END US-301BYP ENTRANCE RAMP TO BEGIN NC-43BUS EXIT RAMP	1			4				2					30							
		BEGIN NC-43BUS EXIT RAMP TO GORE	2												5							
		GORE TO GORE	1												10							
		GORE TO BEGIN BRIDGE OVER NC-43BUS	2												5							
		BEGIN BRIDGE OVER NC-43BUS TO END BRIDGE OVER NC-43BUS	BRIDGE									620									116	39
		END BRIDGE OVER NC-43BUS TO BEGIN NC-43BUS ENTRANCE RAMP	2				3								15							
		BEGIN NC-43BUS ENTRANCE RAMP TO BEGIN US-301BUS EXIT RAMP	1												20							
		BEGIN US-301BUS EXIT RAMP TO GORE	2												10							
		GORE TO GORE	1												20							
		GORE TO BEGIN BRIDGE OVER US-301BUS & END ENTRANCE LOOP	2												5							
		BEGIN BRIDGE OVER US-301BUS & END ENTRANCE LOOP TO END BRIDGE OVER US-301BUS	BRIDGE									520									116	39
		END BRIDGE OVER US-301BUS TO BEGIN BRIDGE OVER RAILROAD	1			4				2					10							
		BEGIN BRIDGE OVER RAILROAD TO END BRIDGE OVER RAILROAD	BRIDGE									420									116	39
		END BRIDGE OVER RAILROAD TO BEGIN BRIDGE OVER NC-97	1			4				2					15							
		BEGIN BRIDGE OVER NC-97 TO END BRIDGE OVER NC-97 & BEGIN EXIT LOOP	BRIDGE									540									116	39
		END BRIDGE OVER NC-97 & BEGIN EXIT LOOP TO GORE	2												5							
		GORE TO BEGIN BRIDGE OVER TAR RIVER	1												10							
		BEGIN BRIDGE OVER TAR RIVER TO END BRIDGE OVER TAR RIVER	BRIDGE									380	400								227	76
		END BRIDGE OVER TAR RIVER TO END NC-97 ENTRANCE RAMP	2				3								15							
END NC-97 ENTRANCE RAMP TO BEGIN BRIDGE OVER SR-1243	1												20									
BEGIN BRIDGE OVER SR-1243 TO END BRIDGE OVER SR-1243	BRIDGE									580									120	40		
END BRIDGE OVER SR-1243 TO BEGIN US-64BUS EXIT RAMP	1												60									
BEGIN US-64BUS EXIT RAMP TO GORE	2												10									
GORE TO GORE	1												30									
GORE TO END US-64BUS ENTRANCE RAMP	2				3								20									
END US-64BUS ENTRANCE RAMP TO SR-1233 (THOMAS ROAD)	1												100									
SR-1233 (THOMAS ROAD) TO BEGIN SR-1225 EXIT RAMP	7												185			14,540						
BEGIN SR-1225 EXIT RAMP TO GORE	2												10									
GORE TO GORE	7												40			2,960						
GORE TO END SR-1225 ENTRANCE RAMP	2				3								20									
TOTAL FOR MAP 2					24	21			12				5,020	400		1,050			17,500	1,234	413	



## SUMMARY OF QUANTITIES

PROJECT NO.	COUNTY	MAP NO.	ROUTE	DESCRIPTION	TYPICAL SECTION NO.	PROJECT NO.												SHEET NO.	TOTAL NO.					
						I-6046 47995.3.1												26	32					
						4825000000-E PAINT PAVEMENT MARKING LINES (12") YELLOW LF	4835000000-E PAINT PAVEMENT MARKING LINES (24") WHITE LF	4840000000-N PAINT PAVEMENT MARKING CHARACTER "ONLY" EA	4845000000-N PAINT PAVEMENT MARKING SYMBOL MERGE ARROW EA	4845000000-N PAINT PAVEMENT MARKING SYMBOL WRONG-WAY RAMP ARROW EA	4845000000-N PAINT PAVEMENT MARKING SYMBOL LEFT TURN ARROW EA	4845000000-N PAINT PAVEMENT MARKING SYMBOL RIGHT TURN ARROW EA	4845000000-N PAINT PAVEMENT MARKING SYMBOL STRAIGHT & LEFT TURN ARROW EA	4845000000-N PAINT PAVEMENT MARKING SYMBOL STRAIGHT ARROW EA	4855000000-E REMOVAL OF PAVEMENT MARKING LINES (6") LF	4865000000-E REMOVAL OF PAVEMENT MARKING LINES (12") LF	4891000000-E THERMOPLASTIC PAVEMENT MARKING LINES (24", 90 MILS) WHITE LF	4895000000-N NON-CAST IRON SNOWPLOWABLE PAVEMENT MARKER (CRYSTAL/RED) EA	4895000000-N NON-CAST IRON SNOWPLOWABLE PAVEMENT MARKER (YELLOW) EA	4935000000-N FLEXIBLE DELINEATORS (CRYSTAL) EA	6000000000-E TEMPORARY SILT FENCE LF	7444000000-E INDUCTIVE LOOP SAWCUT LF	8867000000-E SILICON JOINT REPLACEMENT (LESS THAN 1" WIDE) LF	8867000000-E SILICON JOINT REPLACEMENT (1" TO 2" WIDE) LF
		29		US-64 (RAMP GORE) TO US-64 A	5		60			1	1	1					60	25				500		
				TOTAL FOR MAP 29			60			1	1	1					60	25				500		
		30		US-64 (RAMP GORE) TO US-64 A	5																			
				TOTAL FOR MAP 30																				
		31		US-64 (RAMP GORE) TO SR-1225	5																			
				TOTAL FOR MAP 31																				
		32		US-64 (RAMP GORE) TO SR-1225	5		90			1							90	15						
				TOTAL FOR MAP 32			90			1							90	15						
		33		US-64 (RAMP GORE) TO SR-1225	5		90			1							90	15						
				TOTAL FOR MAP 33			90			1							90	15						
		34		US-64 (RAMP GORE) TO SR-1225	5																			
				TOTAL FOR MAP 34																				
<b>TOTAL</b>						410	610	44	45	10	20	47	4	2	9,250	400	610	2,480	55	25	34,220	3,000	2,712	908
<b>TOTAL FROM SUMMARY OF QUANTITIES - DRAINAGE</b>																								
<b>GRAND TOTAL</b>						410	610	44	45	10	20	47	4	2	9,250	400	610	2,480	55	25	34,220	3,000	2,712	908
<b>PAY ITEM TOTAL</b>							610	44	128						9,250	400	610	2,535		25	34,220	3,000	2,712	908

I-6046 47995.3.1  
NASH AND EDGEcombe

### SUMMARY OF QUANTITIES

PROJECT NO.	SHEET NO.	TOTAL NO.
I-6046 47995.3.1	27	32

PROJECT NO	COUNTY	MAP NO	ROUTE	DESCRIPTION	TYPICAL SECTION NO.	886700000-E	888100000-E	888100000-E	889300000-E																																		
						SILICON JOINT REPLACEMENT (GREATER THAN 2" WIDE)	JOINT REPAIR USING ELASTOMETIC CONCRETE	ASPHALT JOINT REPAIR/REPLACEMENT (18"-24" WIDE, WITH PLATE)	CONCRETE DECK REPAIR (CLASS II) USING ELASTOMETIC CONCRETE																			LF	CY	CY	SY												
				BEGIN SR-1225 EXIT RAMP TO GORE	2																																						
				GORE TO GORE	7																																						
				GORE TO END SR-1225 EXIT RAMP	2																																						
				END SR-1225 EXIT RAMP TO SR-1233 (THOMAS ROAD)	7																																						
				SR-1233 (THOMAS ROAD) TO BEGIN US64A EXIT RAMP	1																																						
				BEGIN US64A EXIT RAMP TO GORE	2																																						
				GORE TO GORE	1																																						
				GORE TO END US64A ENTRANCE RAMP	2																																						
				END US64A ENTRANCE RAMP TO BEGIN BRIDGE OVER SR-1243	1																																						
				BEGIN BRIDGE OVER SR-1243 TO END BRIDGE OVER SR-1243	BRIDGE	40	1.2																																				
				END BRIDGE OVER SR-1243 TO BEGIN NC97 EXIT RAMP	1																																						
				BEGIN NC97 EXIT RAMP TO BEGIN BRIDGE OVER TAR RIVER	2																																						
				BEGIN BRIDGE OVER TAR RIVER TO END BRIDGE OVER TAR RIVER (GORE)	BRIDGE	63	1.5																																				
				END BRIDGE OVER TAR RIVER (GORE) TO GORE	1																																						
				GORE TO BEGIN BRIDGE OVER NC-97 & END EXIT LOOP	2																																						
				BEGIN BRIDGE OVER NC-97 & END EXIT LOOP TO END BRIDGE OVER NC-97	BRIDGE	39	1.4																																				
				END BRIDGE OVER NC-97 TO BEGIN BRIDGE OVER RAILROAD	1																																						
				BEGIN BRIDGE OVER RAILROAD TO END BRIDGE OVER RAILROAD	BRIDGE	39	1.4																																				
				END BRIDGE OVER RAILROAD TO BEGIN BRIDGE OVER US-301BUS	1																																						
				BEGIN BRIDGE OVER US-301BUS TO END BRIDGE OVER US-301BUS	BRIDGE	39	1.4																																				
				END BRIDGE OVER US-301BUS TO BEGIN US-301BUS EXIT LOOP	1																																						
				BEGIN US-301BUS EXIT LOOP TO GORE	2																																						
				GORE TO GORE	1																																						
				GORE TO END US-301BUS ENTRANCE RAMP	2																																						
				END US-301BUS ENTRANCE RAMP TO BEGIN NC-43BUS EXIT RAMP	1																																						
				BEGIN NC-43BUS EXIT RAMP TO GORE	2																																						
				GORE TO GORE	1																																						
				GORE TO BEGIN BRIDGE OVER NC-43BUS	2																																						
				BEGIN BRIDGE OVER NC-43BUS TO END BRIDGE OVER NC-43BUS	BRIDGE	39	1.4																																				
				END BRIDGE OVER NC-43BUS TO END NC-43BUS ENTRANCE RAMP	2																																						
				END NC-43BUS ENTRANCE RAMP TO BEGIN US-301BYP EXIT LOOP	1																																						
				BEGIN US-301BYP EXIT LOOP TO BEGIN BRIDGE OVER US-301BYP	2																																						
				BEGIN BRIDGE OVER US-301BYP TO END BRIDGE OVER US-301BYP	BRIDGE	39	1.4																																				
				END BRIDGE OVER US-301BYP TO GORE	2																																						
				GORE TO GORE	1																																						
				GORE TO BEGIN BRIDGE OVER SR-1616	2																																						
				BEGIN BRIDGE OVER SR-1616 TO END BRIDGE OVER SR-1616	BRIDGE	17	1.2																																				
				END BRIDGE OVER SR-1616 TO END US-301BYP ENTRANCE RAMP	2																																						
				END US-301BYP ENTRANCE RAMP TO BEGIN US-64BUS EXIT LOOP	1																																						
				BEGIN US-64BUS EXIT LOOP TO GORE	2																																						
				GORE TO GORE	1																																						
				GORE TO END US-64BUS ENTRANCE RAMP	2																																						
				END US-64BUS ENTRANCE RAMP TO BEGIN TAPER 3-4 LANES	1																																						
				BEGIN TAPER 3-4 LANES TO END TAPER 3-4 LANES	1																																						
				END TAPER 3-4 LANES TO BEGIN SR-1613 EXIT LOOP	1																																						
				BEGIN SR-1613 EXIT LOOP TO GORE	2																																						
				GORE TO GORE	1																																						
				GORE TO END SR-1613 ENTRANCE RAMP	2																																						
				END SR-1613 ENTRANCE RAMP TO BEGIN TAPER FOR CD LANE	1					6																																	
				BEGIN TAPER FOR CD LANE TO CD LANE & BEGIN PAVED DITCH	4																																						
				CD LANE & BEGIN PAVED DITCH TO BEGIN BRIDGE OVER I-95	3																																						
				BEGIN BRIDGE OVER I-95 TO END BRIDGE OVER I-95	BRIDGE	93	2.7																																				
				END BRIDGE OVER I-95 TO CD LANE & END PAVED DITCH	3																																						
				CD LANE & END PAVED DITCH TO END TAPER FOR PAVED DITCH @ CD LANE	4																																						
				END TAPER FOR PAVED DITCH @ CD LANE TO END RESURFACING ON PROJECT U-5996	1																																						
				TOTAL FOR MAP 1		408	13.6	6																																			

I-6046 47995.3.1  
 NASH AND EDGECOMBE  
 1





## SUMMARY OF QUANTITIES

		PROJECT NO.																SHEET NO.	TOTAL NO.
		I-6046 47995.3.1																30	32
PROJECT NO.	COUNTY	MAP NO.	ROUTE	DESCRIPTION	TYPICAL SECTION NO.	8867000000-E SILICON JOINT REPLACEMENT (GREATER THAN 2" WIDE)  LF	8881000000-E JOINT REPAIR USING ELASTOMETIC CONCRETE  CY	8881000000-E ASPHALT JOINT REPAIR/REPLACE MENT (18"-24" WIDE, WITH PLATE)  CY	8893000000-E CONCRETE DECK REPAIR (CLASS II) USING ELASTOMETIC CONCRETE  SY										
		29		US-64 (RAMP GORE) TO US-64 A	5														
				TOTAL FOR MAP 29															
		30		US-64 (RAMP GORE) TO US-64 A	5														
				TOTAL FOR MAP 30															
		31		US-64 (RAMP GORE) TO SR-1225	5														
				TOTAL FOR MAP 31															
		32		US-64 (RAMP GORE) TO SR-1225	5														
				TOTAL FOR MAP 32															
		33		US-64 (RAMP GORE) TO SR-1225	5														
				TOTAL FOR MAP 33															
		34		US-64 (RAMP GORE) TO SR-1225	5														
				TOTAL FOR MAP 34															
<b>TOTAL</b>						908	29.3	12											
TOTAL FROM SUMMARY OF QUANTITIES - DRAINAGE																			
<b>GRAND TOTAL</b>						908	29.3	12	100										
<b>PAY ITEM TOTAL</b>						908	29.3	12	100										

I-6046 47995.3.1  
NASH AND EDGEcombe

SUMMARY OF QUANTITIES - DRAINAGE

PROJECT NUMBER	COUNTY	BOX NUMBER	ROUTE	LONG	LAT	DESCRIPTION	PROJECT NO.											SHEET NO.	TOTAL NO.					
							I-6046											31	32					
							0106000000-E BORROW EXCAVATION	0318000000-E FOUNDATION CONDITIONING MATERIAL, MINOR STRUCTURES	0320000000-E FOUNDATION CONDITIONING GEOTEXTILE	0360000000-E 12" RC PIPE CULVERTS, CLASS III	0366000000-E 15" RC PIPE CULVERTS, CLASS III	0372000000-E 18" RC PIPE CULVERTS, CLASS III	0378000000-E 24" RC PIPE CULVERTS, CLASS III	0384000000-E 30" RC PIPE CULVERTS, CLASS III	0390000000-E 36" RC PIPE CULVERTS, CLASS III	0995000000-E PIPE REMOVAL	2099000000-E SHOULDER DRAIN	2110000000-E 4" SHOULDER DRAIN PIPE	2121000000-E 4" OUTLET PIPE FOR SHOULDER DRAINS	2132000000-N CONCRETE PAD FOR SHOULDER DRAIN PIPE OUTLET	2253000000-E PIPE COLLARS	2275000000-E FLOWABLE FILL	2365000000-N FRAME WITH TWO GRATES, STD 840.22	
CY	TON	SY	LF	LF	LF	LF	LF	LF	LF	LF	LF	EA	CY	CY	EA									
		1	US-64 median	-77.686157	35.927947	REMOVE & REPLACE DAMAGED PIPES & APRON	6	2	6				16		16				1.312	3				
		2	US-64 median	-77.690267	35.928784	REMOVE & REPLACE DAMAGED PIPES & APRON	6	1	3	8					8				0.353	3				
		3	US-64 median	-77.698084	35.930366	EXCAVATE AND FILL AROUND PIPES, REPLACE APRON	4														2			
		4	US-64 median	-77.713873	35.933566	REMOVE & REPLACE DAMAGED PIPES & APRON	4	1	3	8					8				0.353	2				
		5	US-64 median	-77.717312	35.934260	REMOVE & REPLACE DAMAGED PIPES & APRON	4	1	3						8				0.399	2				
		6	US-64 median	-77.740603	35.936040	REMOVE & REPLACE DAMAGED PIPES & APRON	20	2	6				16		16				1.312	10				
		7	US-64 median	-77.726891	35.935375	REMOVE & REPLACE DAMAGED PIPES & APRON	4	2	6				16		16				1.312	2				
		8	US-64 median	-77.718463	35.934493	REMOVE & REPLACE DAMAGED PIPES & APRON	10	1	3	8					8				0.353	5				
		9	US-64 median	-77.739007	35.935964	REMOVE & REPLACE DAMAGED PIPES & APRON	6	2	6				16		16				1.105	3				
		10	US-64 median	-77.743036	35.936164	REMOVE & REPLACE DAMAGED PIPES & APRON	4	2	6				16		16				1.312	2				
		11	US-64 median	-77.730773	35.935562	REMOVE & REPLACE DAMAGED PIPES & APRON	10	2	6				16		16				1.312	5				
		12	US-64 median	-77.724289	35.935241	EXCAVATE AND FILL AROUND PIPES	4														2			
		13	US-64 median	-77.720112	35.934782	REMOVE & REPLACE DAMAGED PIPES & APRON	6	1	3	8					8				0.353	3				
		14	US-64 median	-77.716003	35.933999	EXCAVATE AND FILL AROUND PIPES	4														2			
		15	US-64 median	-77.758652	35.944231	REMOVE & REPLACE DAMAGED PIPES & APRON	6	3	8				16		24				1.351	3				
		16	US-64 shoulder	-77.866591	35.980800	REMOVE & REPLACE DAMAGED PIPES	4	1	3				8		8				0.399	2				
		17	US-64 shoulder	-77.869336	35.980995	REMOVE & REPLACE DAMAGED PIPES & APRON	20	1	3				8		8				0.447	10				
		18	US-64 median	-77.767531	35.957872	REMOVE & REPLACE DAMAGED PIPES, APRON & PAVED DITCH	6	2	6				16		16				0.798	3				
		19	US-64 median	-77.765278	35.955739	REMOVE & REPLACE DAMAGED PIPES & APRON	4	1	3				8		8				0.399	2				
		20	US-64 median	-77.761048	35.948322	EXCAVATE AND FILL AROUND PIPES	4														2			
		21	US-64 median	-77.760344	35.947086	EXCAVATE AND FILL AROUND PIPES	4														2			
		22	US-64 median	-77.759694	35.945949	REMOVE & REPLACE DAMAGED PIPES & APRON	6	4	11				16		32				1.903	3				
		23	US-64 median	-77.861978	35.980785	EXCAVATE AND FILL AROUND PIPES, REPLACE APRON	4														2			
		24	US-64 median	-77.860449	35.980674	EXCAVATE AND FILL AROUND PIPES, REPLACE APRON	4														2			
		25	US-64 shoulder	-77.845007	35.973992	REMOVE & REPLACE DAMAGED PIPES, APRON & PAVED DITCH	6	2	6				16		16				1.105	3				
		26	US-64 median	-77.844838	35.974177	REMOVE & REPLACE DAMAGED PIPES, APRON & PAVED DITCH	6	2	6				8		8				0.999	3				
		27	US-64 median	-77.830993	35.970601	REMOVE & REPLACE DAMAGED PIPES, APRON & PAVED DITCH	6	4	11				24		8				1.644	3				
		28	US-64 median	-77.828965	35.970257	REMOVE & REPLACE DAMAGED PIPES, APRON & PAVED DITCH	6	4	11				24		8				1.644	3				
		29	US-64 shoulder	-77.848118	35.976119	REMOVE & REPLACE DAMAGED PIPES, APRON & PAVED DITCH	6	2	6				8		8				0.846	3				
		30	US-64 shoulder	-77.675594	35.926003	REMOVE & REPLACE DAMAGED PIPES & APRON	6	1	3	8					8				0.353	3				
		31	US-64 shoulder	-77.758319	35.944271	REMOVE & REPLACE DAMAGED PIPES & APRON	16	1	3				8		8				0.399	8				
		32	US-64 shoulder	-77.758434	35.945221	REMOVE & REPLACE DAMAGED PIPES & APRON	6	2	6				16		16				0.893	3				
		33	US-64 shoulder	-77.760100	35.947168	REMOVE & REPLACE DAMAGED PIPES & APRON	16	1	3				8		8				0.553	8				
		34	US-64 shoulder	-77.798910	35.963730	EXCAVATE AND FILL AROUND PIPES, REPLACE APRON	4														2			
		35	US-64 shoulder	-77.802508	35.964677	REMOVE & REPLACE DAMAGED PIPES, APRON & PAVED DITCH	10	2	6				16		16				0.893	5				
		36	US-64 shoulder	-77.808031	35.964595	REMOVE & REPLACE DAMAGED PIPES, APRON & PAVED DITCH	6	2	6				16		16				0.893	3				
		37	US-64 shoulder	-77.814121	35.964865	EXCAVATE AND FILL AROUND PIPES, REPLACE APRON	4														2			
		38	US-64 median	-77.889373	35.982641	EXCAVATE AND FILL AROUND PIPES, REPLACE APRON & PAVED DITCH	16														8			
		39	US-64 shoulder	-77.835831	35.971706	REMOVE & REPLACE DAMAGED PIPES, APRON & PAVED DITCH	6	2	6				16		16				0.798	3				
		40	US-64 shoulder	-77.847486	35.976322	REMOVE & REPLACE DAMAGED PIPES & APRON	6	3	8				8		16				1.552	3				
		41	US-64 shoulder	-77.848031	35.976872	REPLACE FRAME AND GRATES & APRON							8		16						1			
		42	US-64 shoulder	-77.846883	35.977184	EXCAVATE AND FILL AROUND PIPES, REPLACE APRON	4														2			
		43	US-64 shoulder	-77.849342	35.977602	REMOVE & REPLACE DAMAGED PIPES, APRON & PAVED DITCH	16	2	6				16		16				0.893	8				
		44	US-64 shoulder	-77.857796	35.980723	EXCAVATE AND FILL AROUND PIPES, REPLACE APRON	4														2			
		45	US-64 shoulder	-77.864742	35.981217	EXCAVATE AND FILL AROUND PIPES	4														2			
		46	US-64 shoulder	-77.800814	35.963942	REMOVE & REPLACE DAMAGED PIPES & APRON	6	2	6				16		16				0.893	3				
		47	US-64 shoulder	-77.869008	35.981600	REMOVE & REPLACE DAMAGED PIPES & APRON	10	2	6				8		8				0.999	5				
		48	US-64 shoulder	-77.875600	35.983131	REMOVE & REPLACE DAMAGED PIPES & PAVED DITCH	6	1	3				8		8				0.553	3				
		49	US-64 shoulder	-77.873079	35.981995	EXCAVATE AND FILL AROUND PIPES, REPLACE APRON	4														2			
		50	US-64 shoulder	-77.877187	35.983270	REMOVE & REPLACE DAMAGED PIPES & APRON	6	2	6				8		8				1.209	3				
		51	US-64 shoulder	-77.878683	35.983096	REPLACE FRAME AND GRATES															1			
		52	US-64 shoulder	-77.792235	35.958859	EXCAVATE AND FILL AROUND PIPES	4														2			
		53	US-64 gore area	-77.872950	35.981370	REPLACE FRAME AND GRATES															1			
		54	US-64 shoulder	-77.758890	35.944069	REMOVE & REPLACE DAMAGED PIPES & APRON	16	1	3	8					8				0.399	8				
		55	US-64 shoulder	-77.759762	35.945392	REMOVE & REPLACE DAMAGED PIPES & APRON	6	4	11				8		24				2.057	3				
		56	US-64 shoulder	-77.759604	35.945336	REMOVE & REPLACE DAMAGED PIPES & APRON	6	2	6				16		16				1.105	3				
		57	US-64 shoulder	-77.760570	35.947013	REMOVE & REPLACE DAMAGED PIPES, APRON & PAVED DITCH	20	1	3				8		8				0.553	10				
		58	US-64 shoulder	-77.878695	35.980564	REMOVE & REPLACE DAMAGED PIPES & APRON	6	2	6				16		16				1.528	3				
		59	US-64 shoulder	-77.876059	35.979990	REMOVE & REPLACE DAMAGED PIPES & APRON	10	2	6				8		8				0.999	5				
		60	US-64 median	-77.692096	35.929150	REMOVE & REPLACE DAMAGED PIPES & APRON	20	1	3				8		8				0.399	10				
		61	US-64 shoulder	-77.838585	35.971271	REMOVE & REPLACE DAMAGED PIPES & APRON	10	3	8				8		16				1.975	5				
		62	US-64 median	-77.736504	35.935839	REMOVE & REPLACE DAMAGED PIPES & APRON	10	2	6				16		16				1.312	5				
		63	US-64 median	-77.699936	35.930742	REMOVE & REPLACE DAMAGED PIPES & APRON	10	1	3	8					8				0.353	5				
		64	US-64 median	-77.847681	35.976115	REMOVE & REPLACE DAMAGED PIPES & APRON	6	2	6				16		16				0.893	3				
		65	US-64 median	-77.849979	35.977687	REMOVE & REPLACE DAMAGED PIPES & APRON	10	2	6				16		16				0.893	5				
		TOTAL						474	89	260	48	176	184	168	104	32	712	100	100	100	5	44.3529	237	3
		SAY						500	90	260	48	176	184	168	104	32	712	100	100	100	5	45	250	3



# SUMMARY OF QUANTITIES - DRAINAGE

														PROJECT NO.	SHEET NO.	TOTAL NO.		
														I-6046	32	32		
PROJECT NUMBER	COUNTY	BOX NUMBER	ROUTE	LONG	LAT	DESCRIPTION	247300000-N	261900000-E	334500000-E	334700000-E	601200000-E	604200000-E	607101000-E	608400000-E				
							GENERIC DRAINAGE ITEM- CONCRETE APRON	4" CONCRETE PAVED DITCH	REMOVE & RESET EXISTING GUARD-RAIL	REMOVE & RESET EXISTING GUIDE-RAIL	SEDIMENT CONTROL STONE	1/4" HARDWARE CLOTH	WATTLE	SEEDING & MULCHING	EA	SY	LF	LF
1			US-64 median	-77.686157	35.927947	REMOVE & REPLACE DAMAGED PIPES & APRON	1			50	5	40	40	0.1				
2			US-64 median	-77.690267	35.928784	REMOVE & REPLACE DAMAGED PIPES & APRON	1			50	5	40	40	0.1				
3			US-64 median	-77.698084	35.930366	EXCAVATE AND FILL AROUND PIPES, REPLACE APRON	1				5	40	40	0.1				
4			US-64 median	-77.713873	35.933566	REMOVE & REPLACE DAMAGED PIPES & APRON	1			50	5	40	40	0.1				
5			US-64 median	-77.717312	35.934260	REMOVE & REPLACE DAMAGED PIPES & APRON	1			50	5	40	40	0.1				
6			US-64 median	-77.740603	35.936040	REMOVE & REPLACE DAMAGED PIPES & APRON	1			50	5	40	40	0.1				
7			US-64 median	-77.726891	35.935375	REMOVE & REPLACE DAMAGED PIPES & APRON	1			50	5	40	40	0.1				
8			US-64 median	-77.718463	35.934493	REMOVE & REPLACE DAMAGED PIPES & APRON	1			50	5	40	40	0.1				
9			US-64 median	-77.739007	35.935964	REMOVE & REPLACE DAMAGED PIPES & APRON	1			50	5	40	40	0.1				
10			US-64 median	-77.743036	35.936164	REMOVE & REPLACE DAMAGED PIPES & APRON	1			50	5	40	40	0.1				
11			US-64 median	-77.730773	35.935562	REMOVE & REPLACE DAMAGED PIPES & APRON	1			50	5	40	40	0.1				
12			US-64 median	-77.724289	35.935241	EXCAVATE AND FILL AROUND PIPES					5	40	40	0.1				
13			US-64 median	-77.720112	35.934782	REMOVE & REPLACE DAMAGED PIPES & APRON	1			50	5	40	40	0.1				
14			US-64 median	-77.716003	35.933999	EXCAVATE AND FILL AROUND PIPES					5	40	40	0.1				
15			US-64 median	-77.758652	35.944231	REMOVE & REPLACE DAMAGED PIPES & APRON	1			50	5	40	40	0.1				
16			US-64 shoulder	-77.866591	35.980800	REMOVE & REPLACE DAMAGED PIPES					5	40	40	0.1				
17			US-64 shoulder	-77.869336	35.980995	REMOVE & REPLACE DAMAGED PIPES & APRON	1				5	40	40	0.1				
18			US-64 median	-77.767531	35.957872	REMOVE & REPLACE DAMAGED PIPES, APRON & PAVED DITCH	1	10		50	5	40	40	0.1				
19			US-64 median	-77.765278	35.955739	REMOVE & REPLACE DAMAGED PIPES & APRON	1				5	40	40	0.1				
20			US-64 median	-77.761048	35.948322	EXCAVATE AND FILL AROUND PIPES					5	40	40	0.1				
21			US-64 median	-77.760344	35.947086	EXCAVATE AND FILL AROUND PIPES					5	40	40	0.1				
22			US-64 median	-77.759694	35.945949	REMOVE & REPLACE DAMAGED PIPES & APRON	1				5	40	40	0.1				
23			US-64 median	-77.861978	35.980785	EXCAVATE AND FILL AROUND PIPES, REPLACE APRON	1				5	40	40	0.1				
24			US-64 median	-77.860449	35.980674	EXCAVATE AND FILL AROUND PIPES, REPLACE APRON	1				5	40	40	0.1				
25			US-64 shoulder	-77.845007	35.973992	REMOVE & REPLACE DAMAGED PIPES, APRON & PAVED DITCH	1	4			5	40	40	0.1				
26			US-64 median	-77.844838	35.974177	REMOVE & REPLACE DAMAGED PIPES, APRON & PAVED DITCH	1	13		50	5	40	40	0.1				
27			US-64 median	-77.830993	35.970601	REMOVE & REPLACE DAMAGED PIPES, APRON & PAVED DITCH	1	12			5	40	40	0.1				
28			US-64 median	-77.828965	35.970257	REMOVE & REPLACE DAMAGED PIPES, APRON & PAVED DITCH	1	8			5	40	40	0.1				
29			US-64 shoulder	-77.848118	35.976119	REMOVE & REPLACE DAMAGED PIPES, APRON & PAVED DITCH	1	8			5	40	40	0.1				
30			US-64 shoulder	-77.675594	35.926003	REMOVE & REPLACE DAMAGED PIPES & APRON	1				5	40	40	0.1				
31			US-64 shoulder	-77.758319	35.944271	REMOVE & REPLACE DAMAGED PIPES & APRON	1				5	40	40	0.1				
32			US-64 shoulder	-77.758434	35.945221	REMOVE & REPLACE DAMAGED PIPES & APRON	1				5	40	40	0.1				
33			US-64 shoulder	-77.760100	35.947168	REMOVE & REPLACE DAMAGED PIPES & APRON	1				5	40	40	0.1				
34			US-64 shoulder	-77.798910	35.963730	EXCAVATE AND FILL AROUND PIPES, REPLACE APRON	1				5	40	40	0.1				
35			US-64 shoulder	-77.802508	35.964677	REMOVE & REPLACE DAMAGED PIPES, APRON & PAVED DITCH	1	8			5	40	40	0.1				
36			US-64 shoulder	-77.808031	35.964595	REMOVE & REPLACE DAMAGED PIPES, APRON & PAVED DITCH	1	4			5	40	40	0.1				
37			US-64 shoulder	-77.814121	35.964865	EXCAVATE AND FILL AROUND PIPES, REPLACE APRON	1				5	40	40	0.1				
38			US-64 median	-77.889373	35.982641	EXCAVATE AND FILL AROUND PIPES, REPLACE APRON & PAVED DITCH	1	8	50		5	40	40	0.1				
39			US-64 shoulder	-77.835831	35.971706	REMOVE & REPLACE DAMAGED PIPES, APRON & PAVED DITCH	1	8			5	40	40	0.1				
40			US-64 shoulder	-77.847486	35.976322	REMOVE & REPLACE DAMAGED PIPES & APRON	1				5	40	40	0.1				
41			US-64 shoulder	-77.848031	35.976872	REPLACE FRAME AND GRATES & APRON	1				5	40	40	0.1				
42			US-64 shoulder	-77.846883	35.977184	EXCAVATE AND FILL AROUND PIPES, REPLACE APRON	1				5	40	40	0.1				
43			US-64 shoulder	-77.849342	35.977602	REMOVE & REPLACE DAMAGED PIPES, APRON & PAVED DITCH	1	12			5	40	40	0.1				
44			US-64 shoulder	-77.857796	35.980723	EXCAVATE AND FILL AROUND PIPES, REPLACE APRON	1				5	40	40	0.1				
45			US-64 shoulder	-77.864742	35.981217	EXCAVATE AND FILL AROUND PIPES					5	40	40	0.1				
46			US-64 shoulder	-77.800814	35.963942	REMOVE & REPLACE DAMAGED PIPES & APRON	1				5	40	40	0.1				
47			US-64 shoulder	-77.869008	35.981600	REMOVE & REPLACE DAMAGED PIPES & APRON	1				5	40	40	0.1				
48			US-64 shoulder	-77.875600	35.983131	REMOVE & REPLACE DAMAGED PIPES & PAVED DITCH		20			5	40	40	0.1				
49			US-64 shoulder	-77.873079	35.981995	EXCAVATE AND FILL AROUND PIPES, REPLACE APRON	1				5	40	40	0.1				
50			US-64 shoulder	-77.877187	35.983270	REMOVE & REPLACE DAMAGED PIPES & APRON	1				5	40	40	0.1				
51			US-64 shoulder	-77.878683	35.983096	REPLACE FRAME AND GRATES	1				5	40	40	0.1				
52			US-64 shoulder	-77.792235	35.958859	EXCAVATE AND FILL AROUND PIPES					5	40	40	0.1				
53			US-64 gore area	-77.872950	35.981370	REPLACE FRAME AND GRATES	1				5	40	40	0.1				
54			US-64 shoulder	-77.758890	35.944069	REMOVE & REPLACE DAMAGED PIPES & APRON	1				5	40	40	0.1				
55			US-64 shoulder	-77.759762	35.945392	REMOVE & REPLACE DAMAGED PIPES & APRON	1				5	40	40	0.1				
56			US-64 shoulder	-77.759604	35.945336	REMOVE & REPLACE DAMAGED PIPES & APRON	1				5	40	40	0.1				
57			US-64 shoulder	-77.760570	35.947013	REMOVE & REPLACE DAMAGED PIPES, APRON & PAVED DITCH	1	4			5	40	40	0.1				
58			US-64 shoulder	-77.878695	35.980564	REMOVE & REPLACE DAMAGED PIPES & APRON	1				5	40	40	0.1				
59			US-64 shoulder	-77.876059	35.979990	REMOVE & REPLACE DAMAGED PIPES & APRON	1				5	40	40	0.1				
60			US-64 median	-77.692096	35.929150	REMOVE & REPLACE DAMAGED PIPES & APRON	1			50	5	40	40	0.1				
61			US-64 shoulder	-77.838585	35.971271	REMOVE & REPLACE DAMAGED PIPES & APRON	1				5	40	40	0.1				
62			US-64 median	-77.736504	35.935839	REMOVE & REPLACE DAMAGED PIPES & APRON	1			50	5	40	40	0.1				
63			US-64 median	-77.699936	35.930742	REMOVE & REPLACE DAMAGED PIPES & APRON	1			50	5	40	40	0.1				
64			US-64 median	-77.847681	35.976115	REMOVE & REPLACE DAMAGED PIPES & APRON	1				5	40	40	0.1				
65			US-64 median	-77.849979	35.977687	REMOVE & REPLACE DAMAGED PIPES & APRON	1			50	5	40	40	0.1				
TOTAL							57	119	50	900	325	2600	2600	6.5				
SAY							57	120	50	900	325	2600	2600	7				

STATE OF NORTH CAROLINA  
DEPT. OF TRANSPORTATION  
DIVISION OF HIGHWAYS  
RALEIGH, N.C.

ROADWAY DETAIL DRAWING FOR  
**GUARDRAIL INSTALLATION**

SHEET 6 OF 8  
**862D02**

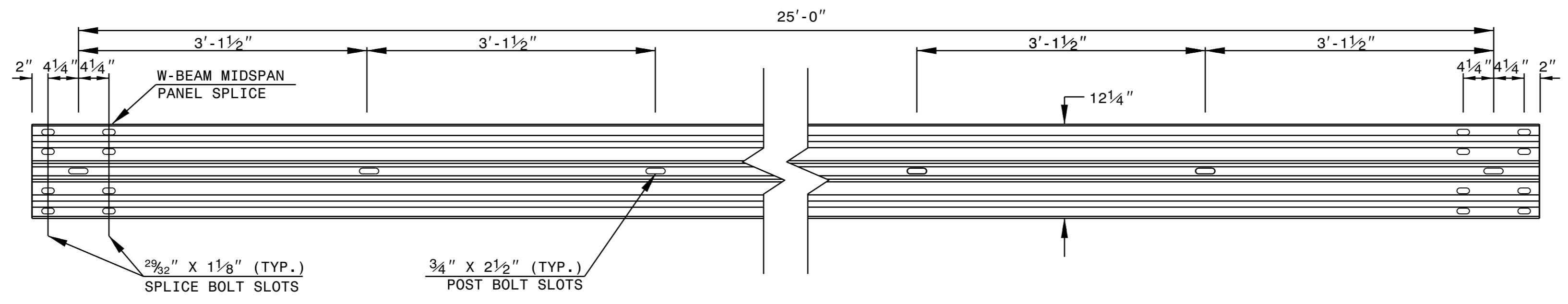

**STANDARD W-BEAM GUARDRAIL**

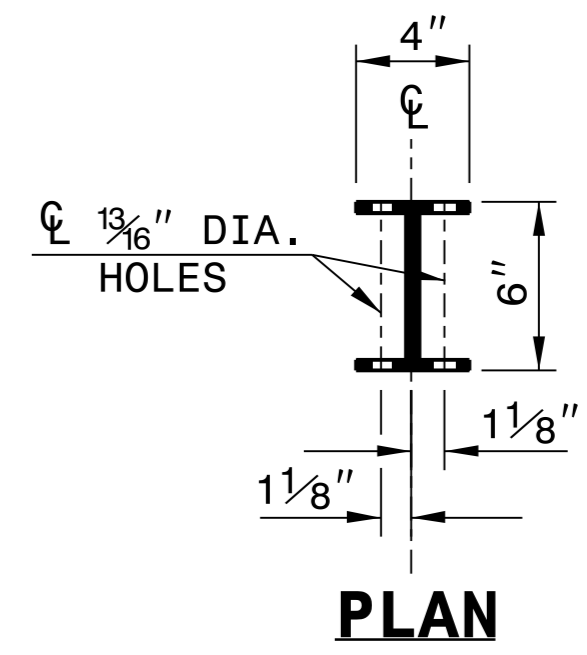

**PLAN**

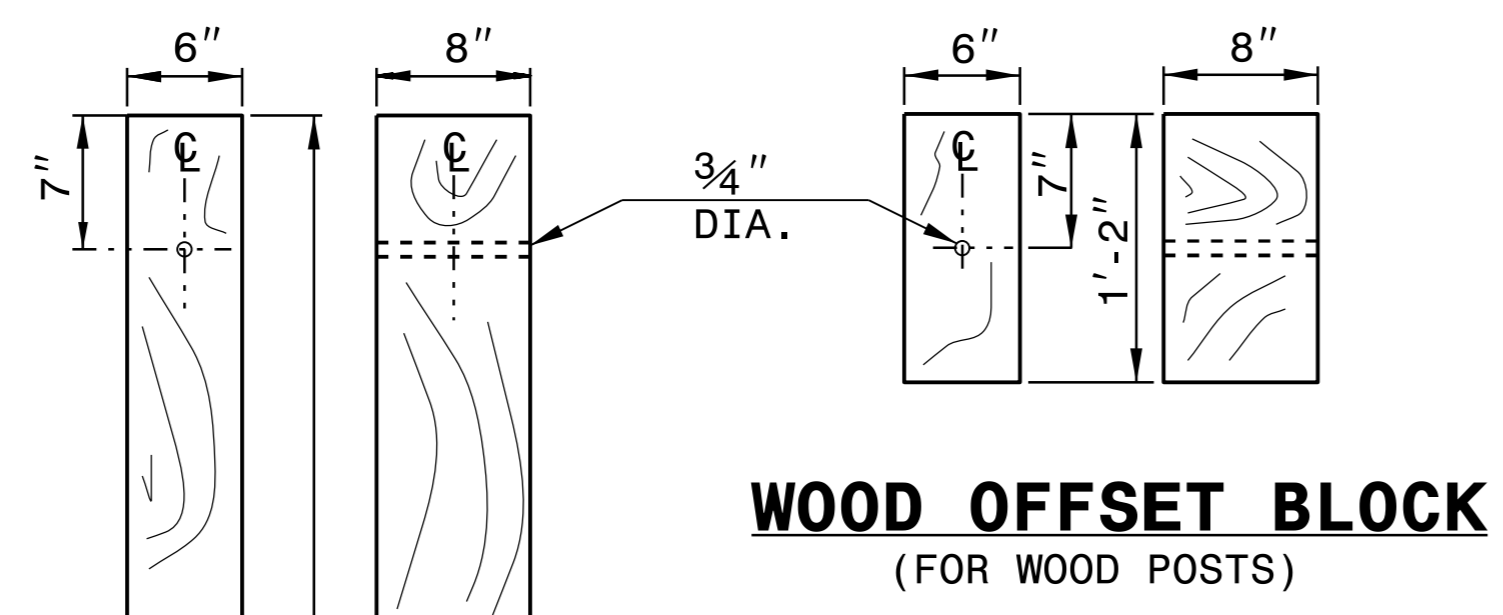

**WOOD OFFSET BLOCK  
(FOR WOOD POSTS)**

**STANDARD  
LINE POST**

**SHORT WOOD  
BREAKAWAY POST**

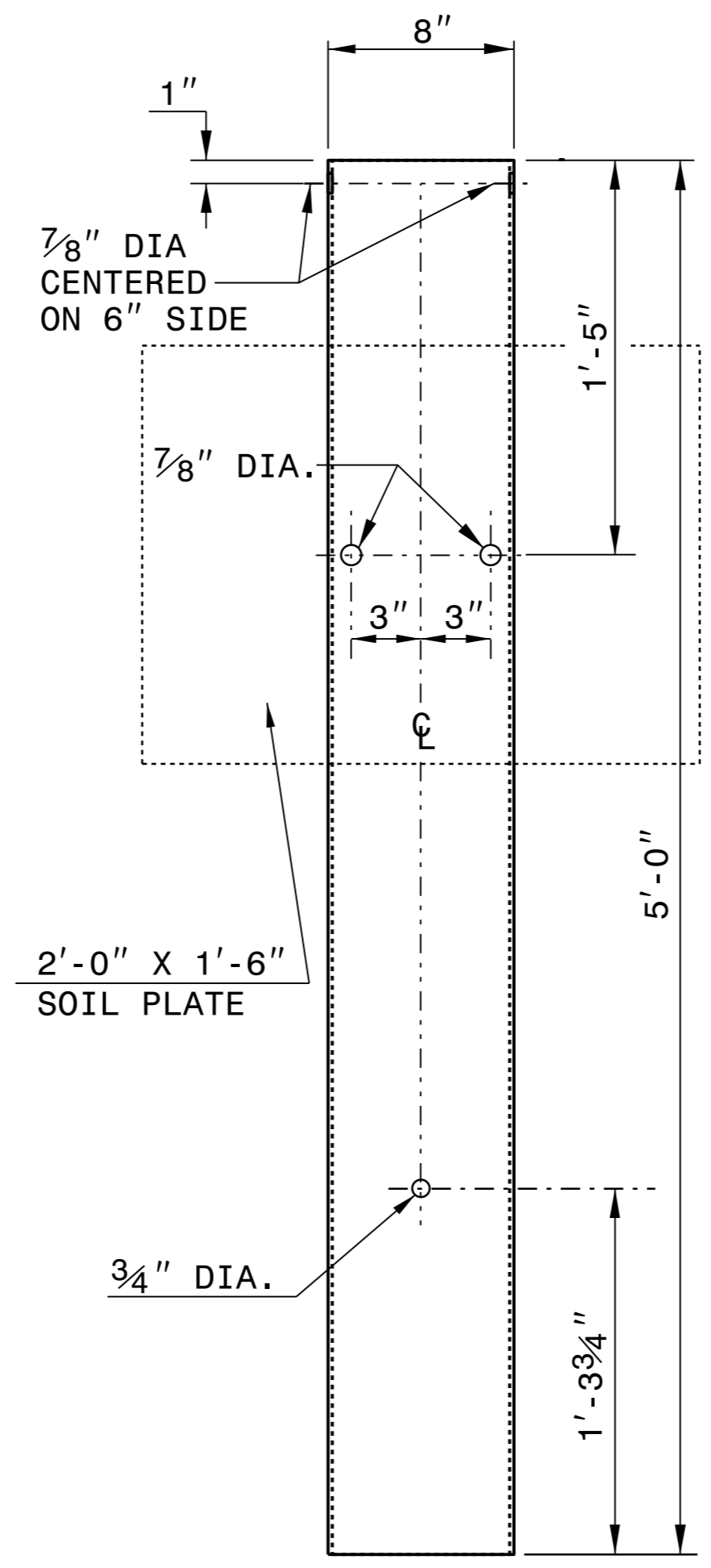

**STEEL TUBE  
TS 6"x8"x0.1875"**

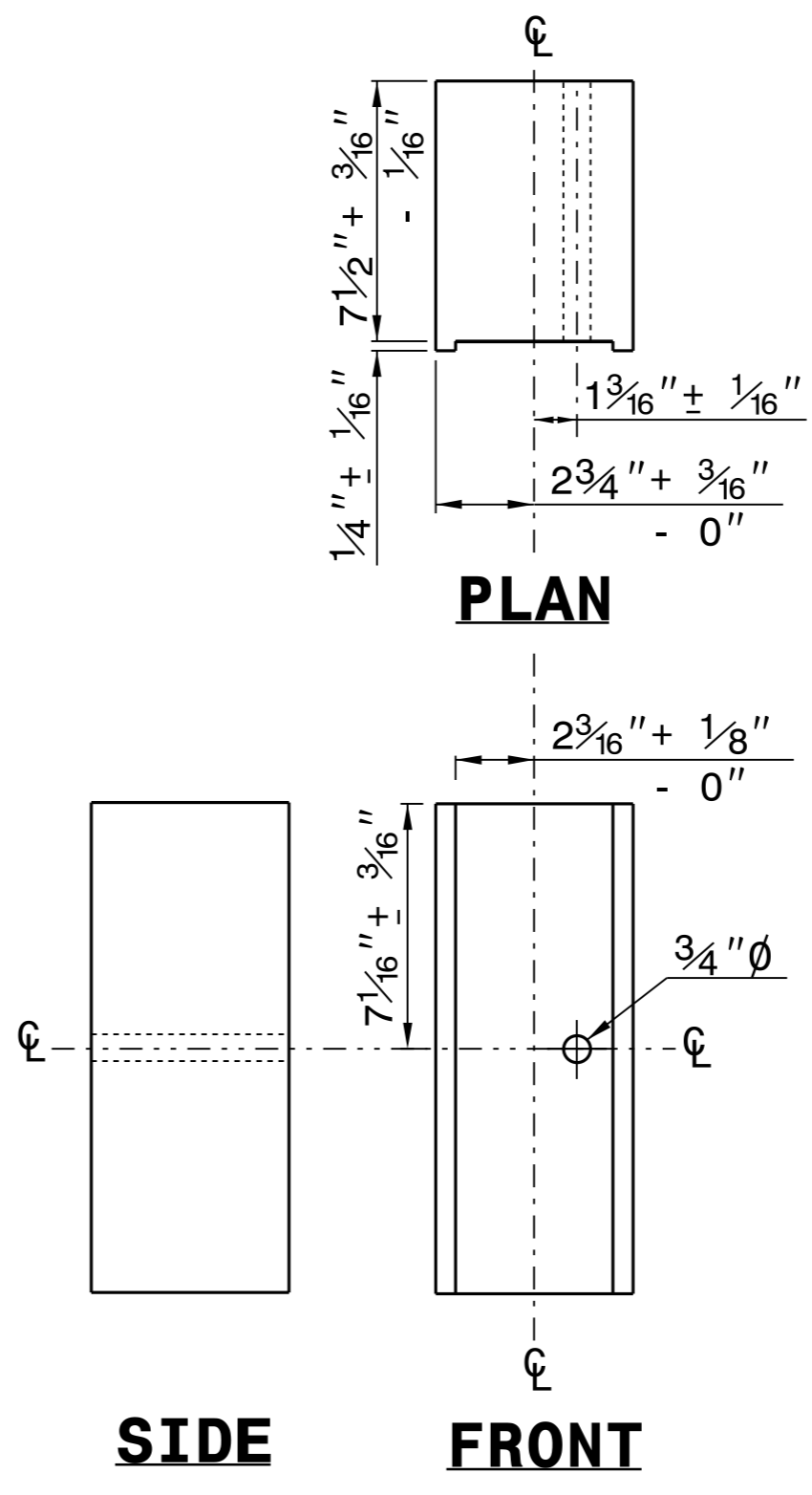

**PLAN**

**SIDE**

**FRONT**

**ROUTED  
OFFSET BLOCK**

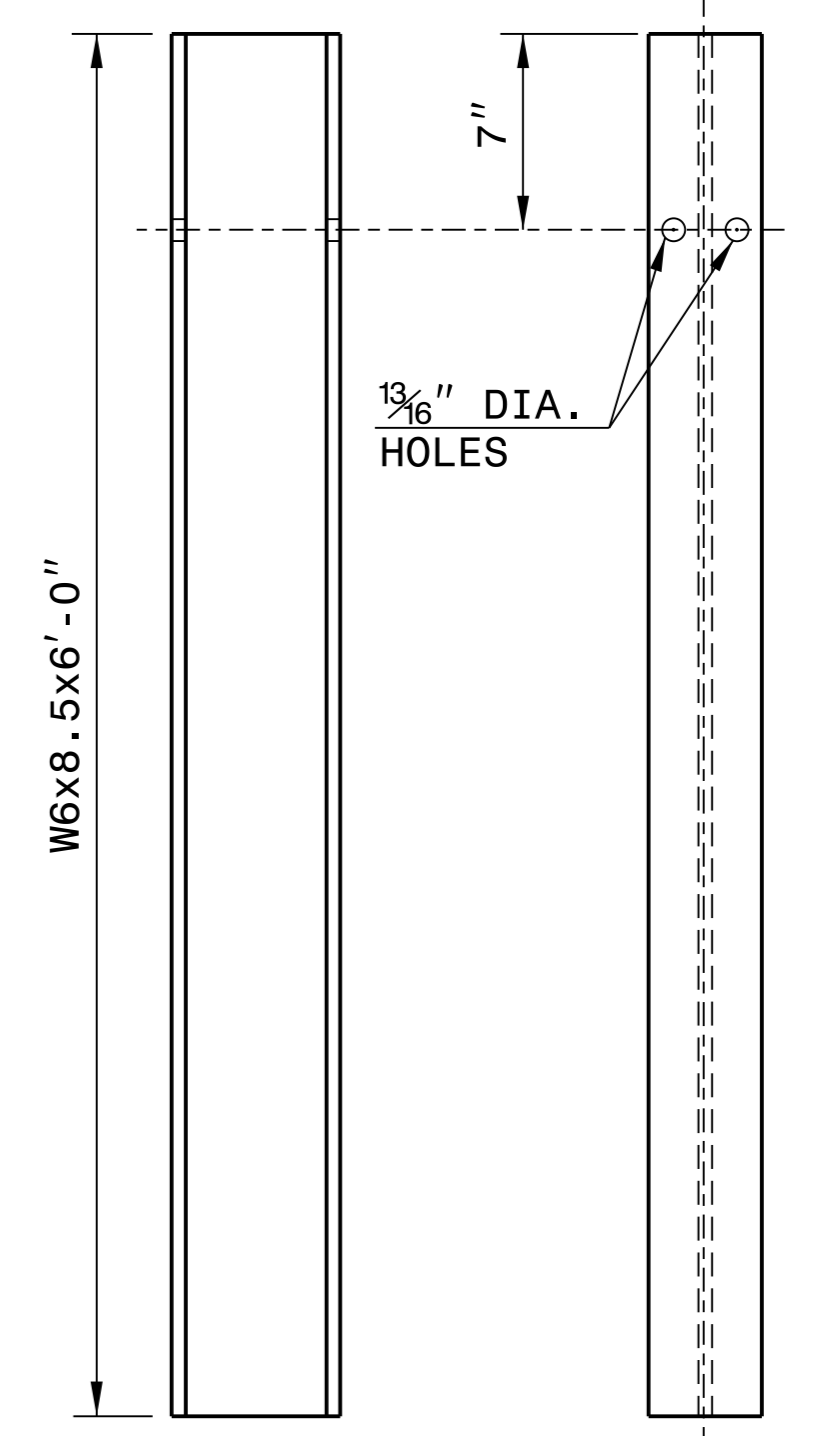

**SIDE**

**FRONT**

**"W6" STEEL POST**

**SYSTEM PARTS**

STATE OF NORTH CAROLINA  
DEPT. OF TRANSPORTATION  
DIVISION OF HIGHWAYS  
RALEIGH, N.C.

ROADWAY DETAIL DRAWING FOR  
**GUARDRAIL INSTALLATION**

SHEET 6 OF 8  
**862D02**

04/08/2022



DocuSigned by:  
Ren Davenport  
F81B8038A47A442

**CONTRACTS STANDARDS  
AND DEVELOPMENT UNIT**  
Office 919-707-6950 FAX 919-250-4119

**SEE TITLE BLOCK**

ORIGINAL BY: J. HOWERTON	DATE: 3-7-2018
MODIFIED BY:	DATE:
CHECKED BY:	DATE:
FILE SPEC.:	