

**This electronic collection of documents is provided
for the convenience of the user
and is Not a Certified Document –**

**The documents contained herein were originally issued
and sealed by the individuals whose names and license
numbers appear on each page, on the dates appearing
with their signature on that page.**

**This file or an individual page
shall not be considered a certified document.**

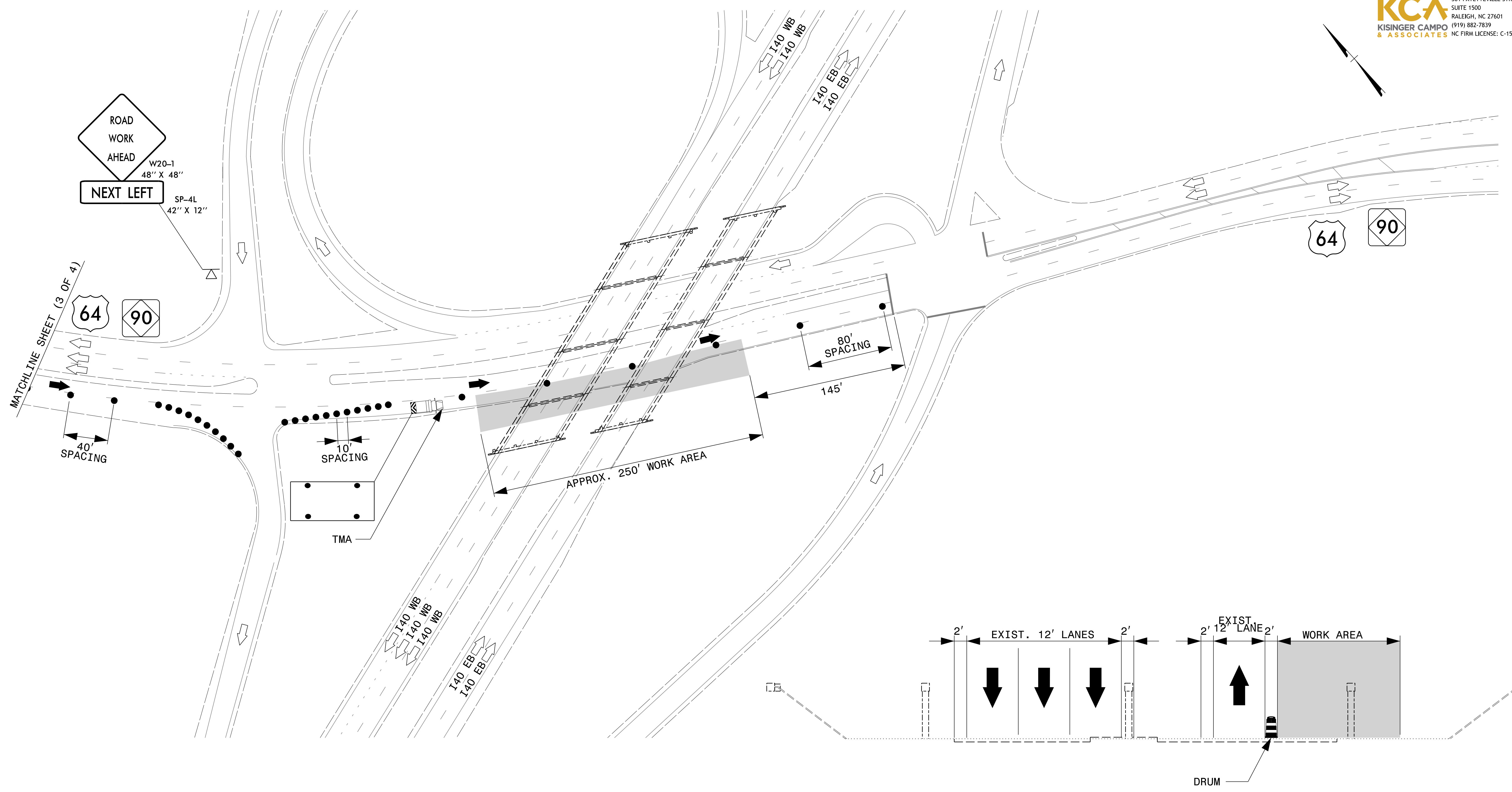

NOTES:

1. TRAFFIC CONTROL DEVICES SHALL BE INSTALLED PER ENGINEER'S INSTRUCTIONS.
2. USE THIS DRAWING IN CONJUNCTION WITH TMP-56.

4/21/2022 15915B.TC.TMP_US_64_SB_OUTSIDE_LANE_CLOSURE_DETAILS (4 OF 4).dgn User: jdebone

APPROVED: *Jacob Duke*
 DATE: 4/26/2022

SEAL

PROFESSIONAL SEAL
 043777
 ENGINEER
 JACOB H. DUKE

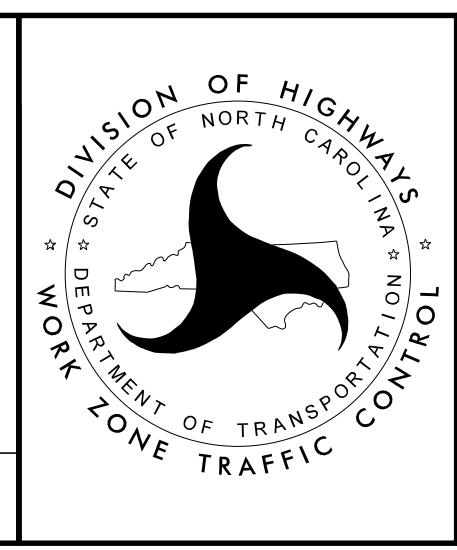

US 64 SB OUTSIDE
 LANE CLOSURE
 DETAILS (4 OF 4)

DOCUMENT NOT CONSIDERED FINAL UNLESS ALL SIGNATURES COMPLETED

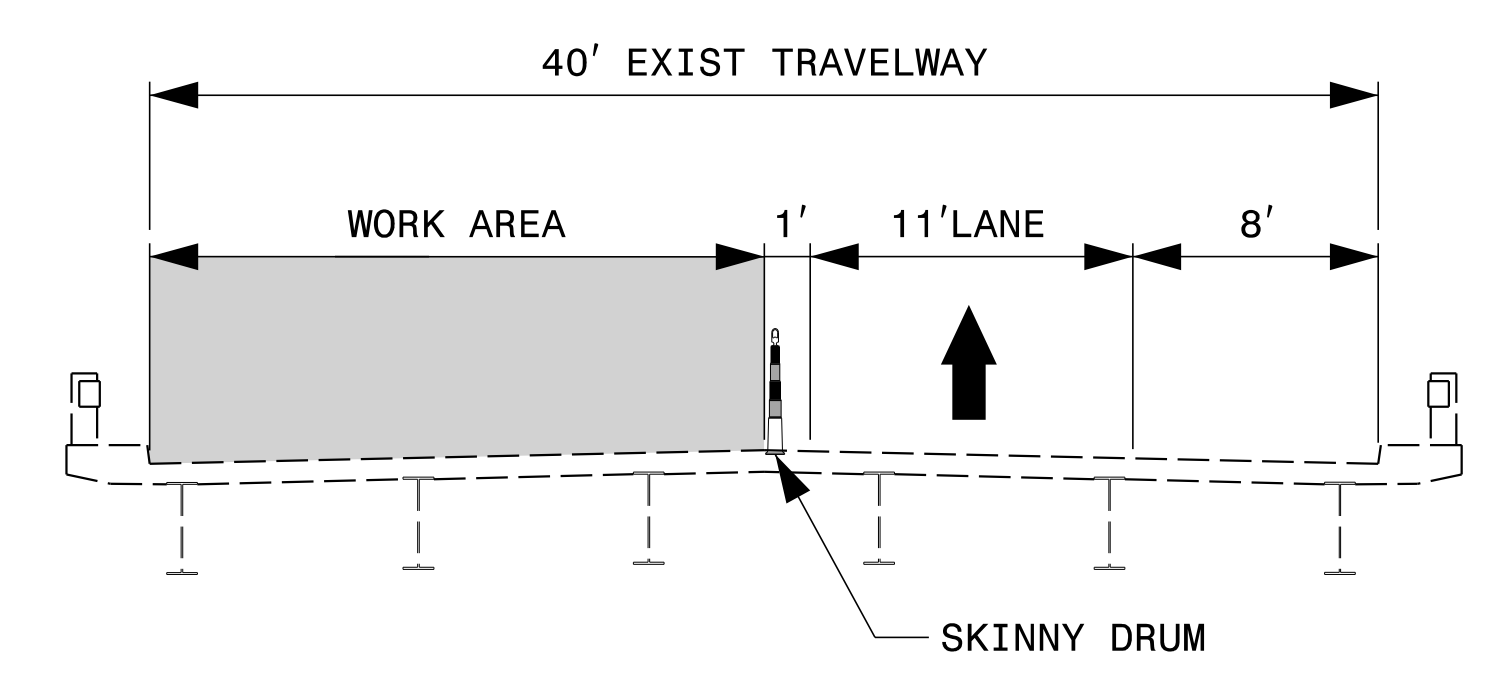
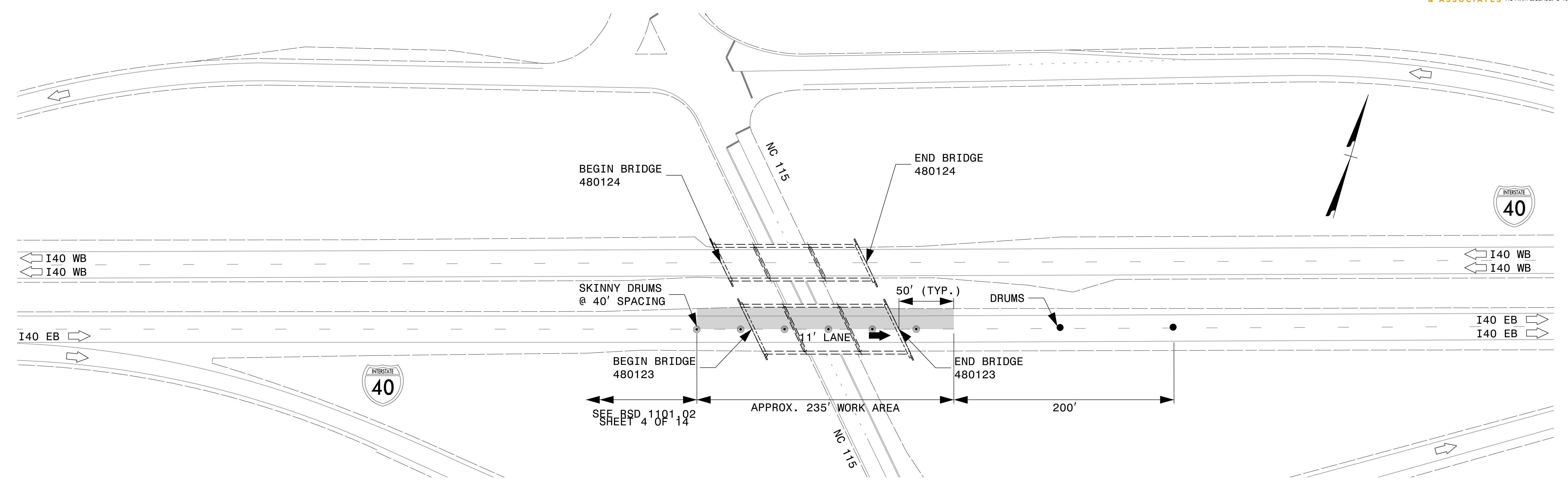

NOTES:

1. USE THIS DRAWING IN CONJUNCTION WITH RSD 1101.02 SHEET 4 OF 14.
2. USE SKINNY DRUMS THROUGH WORK AREA.
3. SEE SHEET TMP-1D FOR "ROAD NARROWS" SIGN PLACEMENT.

4/21/2022 15915B_TC_TMP_I40_EB_STRUCTURE_123_INSIDE_LANE_CLOSURE_DETAILS.dgn User: jdebone

APPROVED: *Jacob Duke*
DocuSigned by: Jacob Duke 2953903094E9409

DATE: 4/26/2022

SEAL

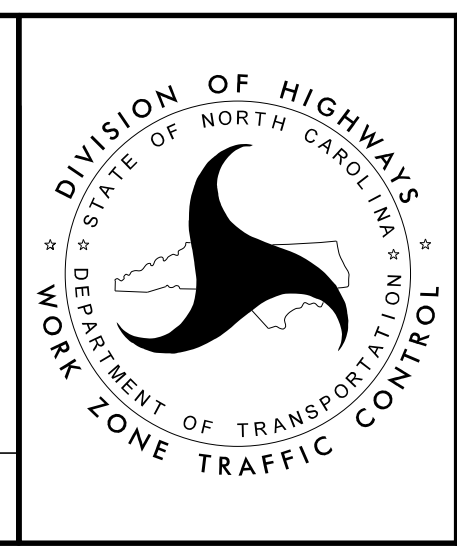

**I40 EB STRUCTURE
 480123 INSIDE LANE
 CLOSURE DETAILS**

**DOCUMENT NOT CONSIDERED FINAL
 UNLESS ALL SIGNATURES COMPLETED**

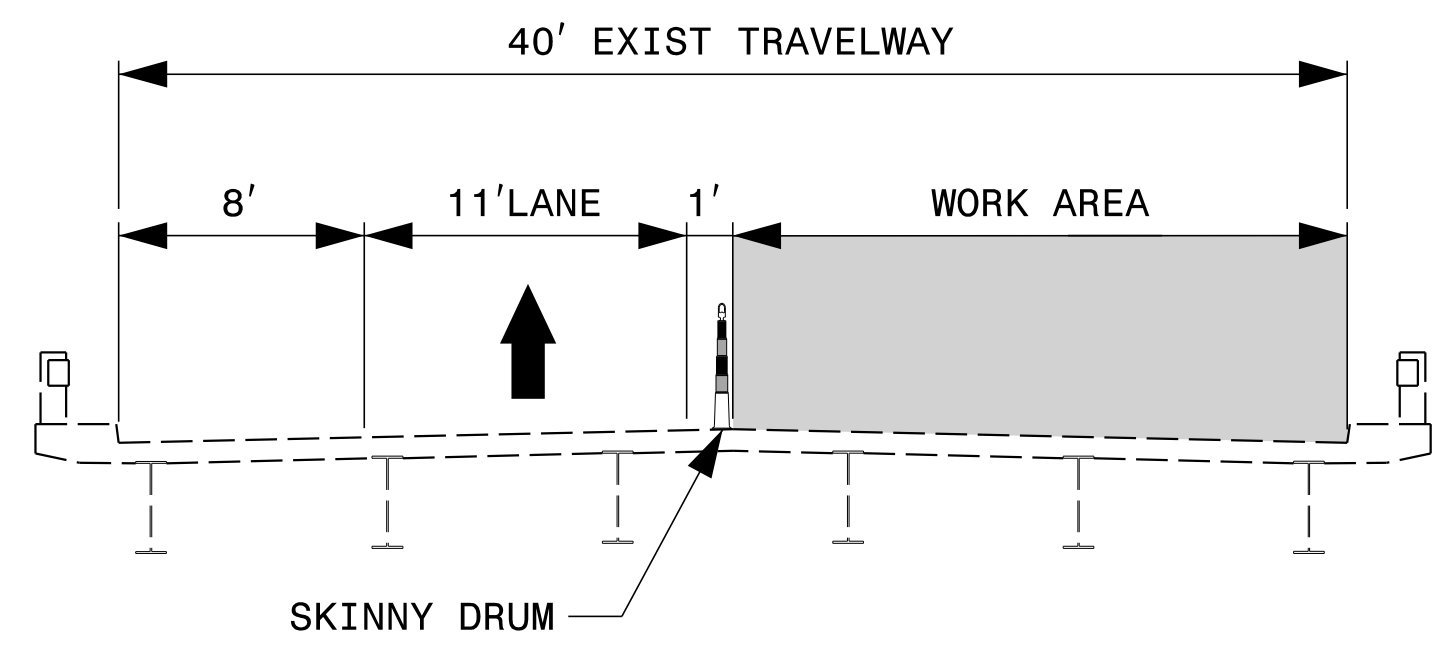
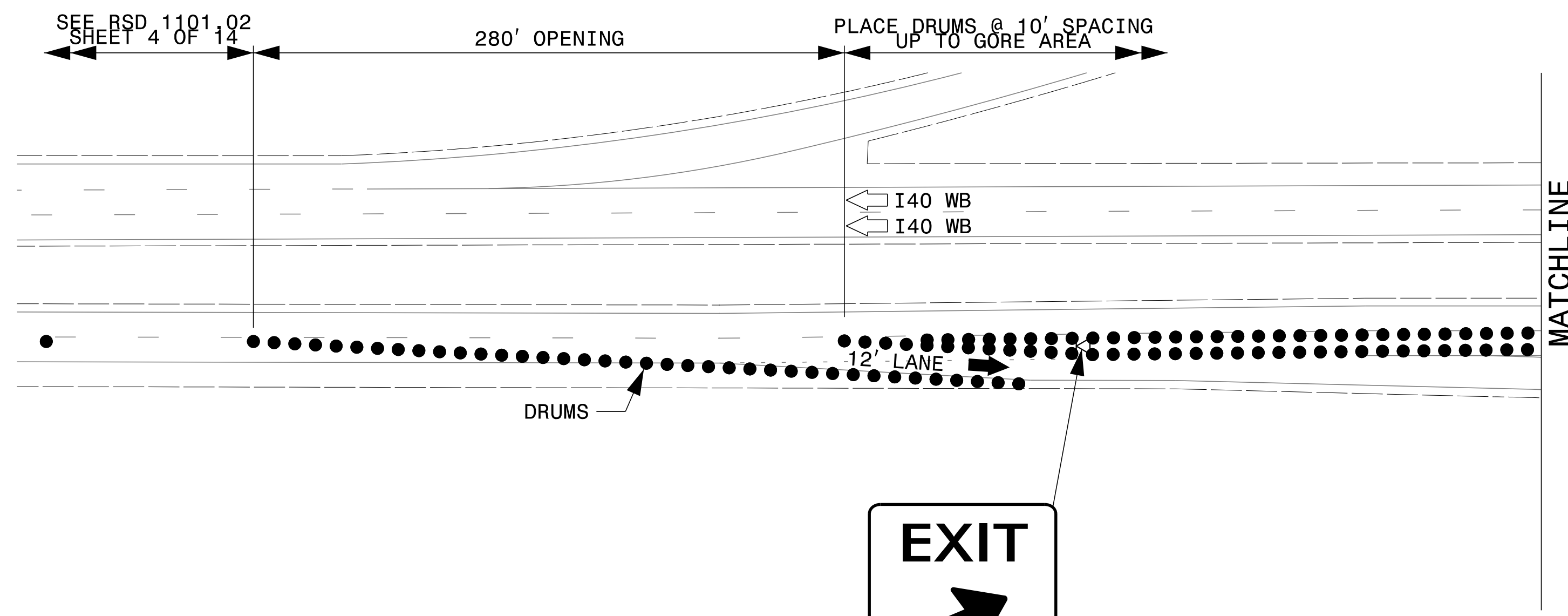
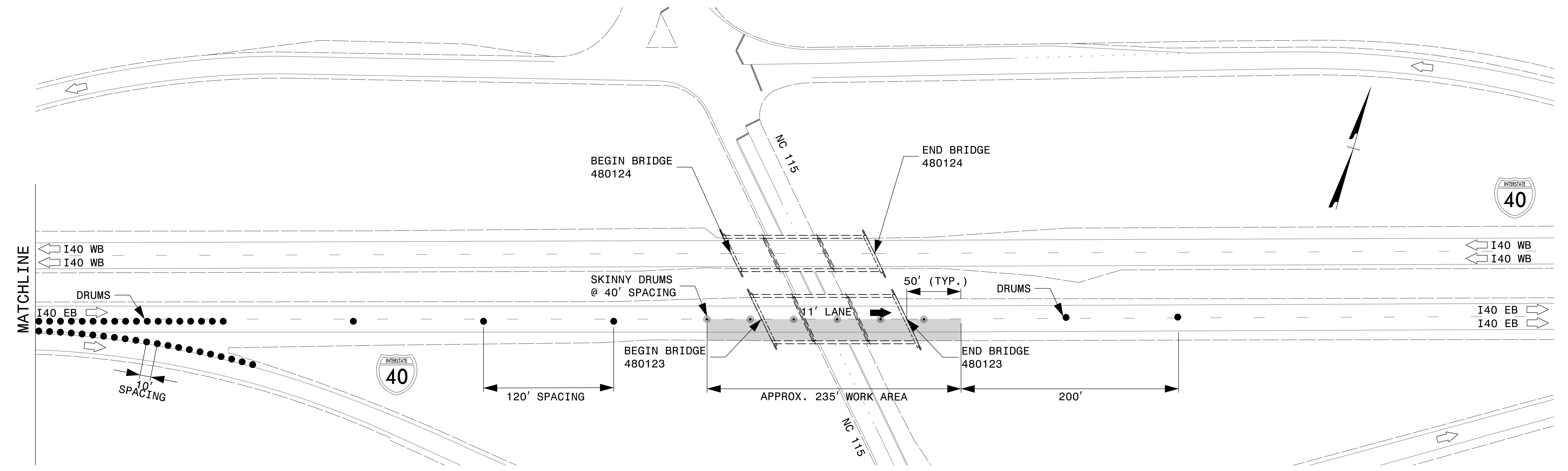

- NOTES:**
1. USE THIS DRAWING IN CONJUNCTION WITH RSD 1101.02 SHEET 4 OF 14.
 2. USE SKINNY DRUMS THROUGH WORK AREA.
 3. SEE SHEET TMP-1D FOR "ROAD NARROWS" SIGN PLACEMENT.

4/21/2022 15915B.TC.TMP_I40_EB_STRUCTURE_123_OUTSIDE_LANE_CLOSURE_DETAILS.dgn User: jdebone

APPROVED: *Jacob Duke*
 DATE: 4/26/2022

SEAL

PROFESSIONAL SEAL
 043777
 ENGINEER
 JACOB H. DUKE

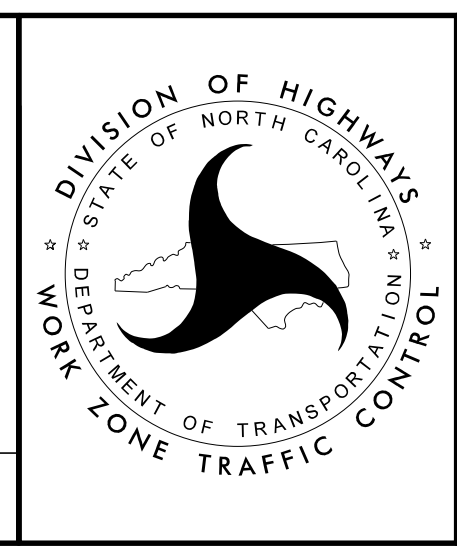

**I40 EB STRUCTURE
 480123 OUTSIDE LANE
 CLOSURE DETAILS**

**DOCUMENT NOT CONSIDERED FINAL
 UNLESS ALL SIGNATURES COMPLETED**

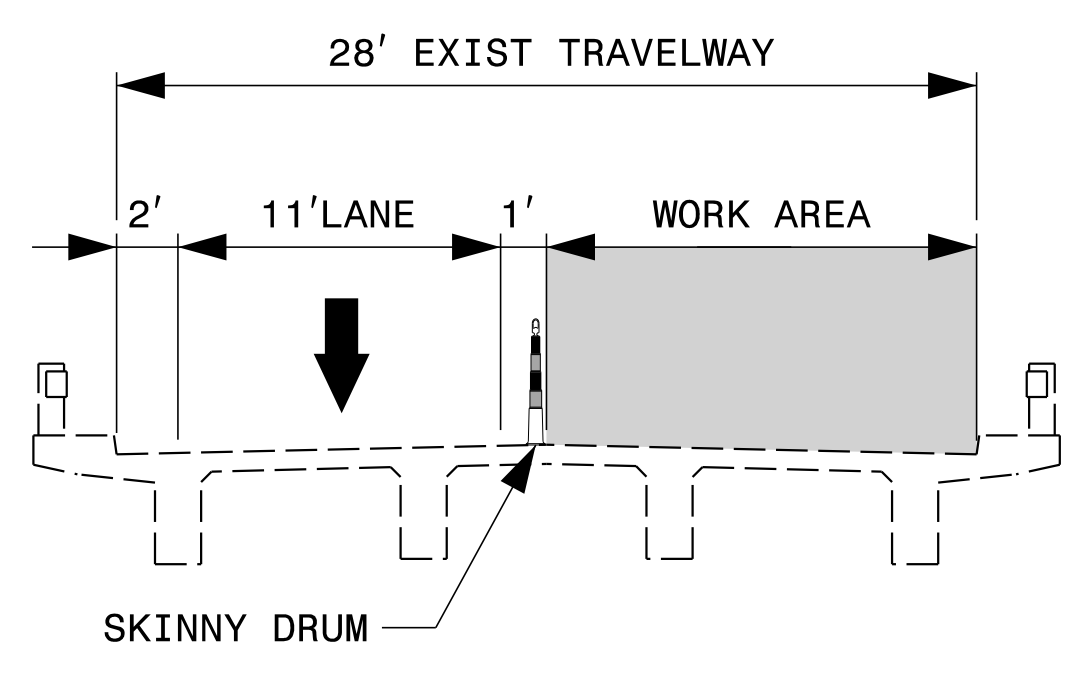
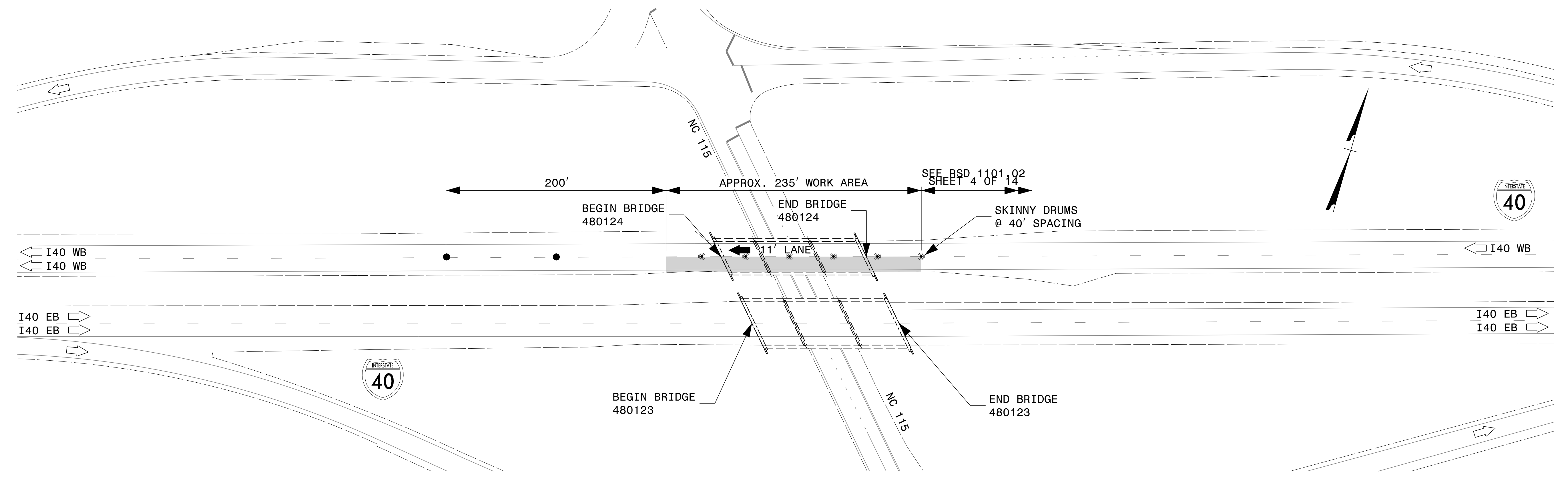

- NOTES:**
1. USE THIS DRAWING IN CONJUNCTION WITH RSD 1101.02 SHEET 4 OF 14.
 2. USE SKINNY DRUMS THROUGH WORK AREA.
 3. SEE SHEET TMP-1D FOR "ROAD NARROWS" SIGN PLACEMENT.

4/21/2022
 I5915B.TC.TMP_I40_WB_STRUCTURE_I24_INSIDE_LANE_CLOSURE_DETAILS.dgn
 User: jdebone

APPROVED: *Jacob Duke*
DocuSigned by: Jacob Duke 2953903094E9409

DATE: 4/26/2022

SEAL

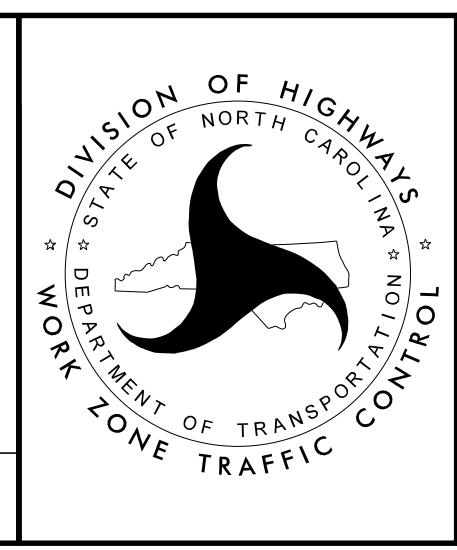

**I40 WB STRUCTURE
 480124 INSIDE LANE
 CLOSURE DETAILS**

**DOCUMENT NOT CONSIDERED FINAL
 UNLESS ALL SIGNATURES COMPLETED**

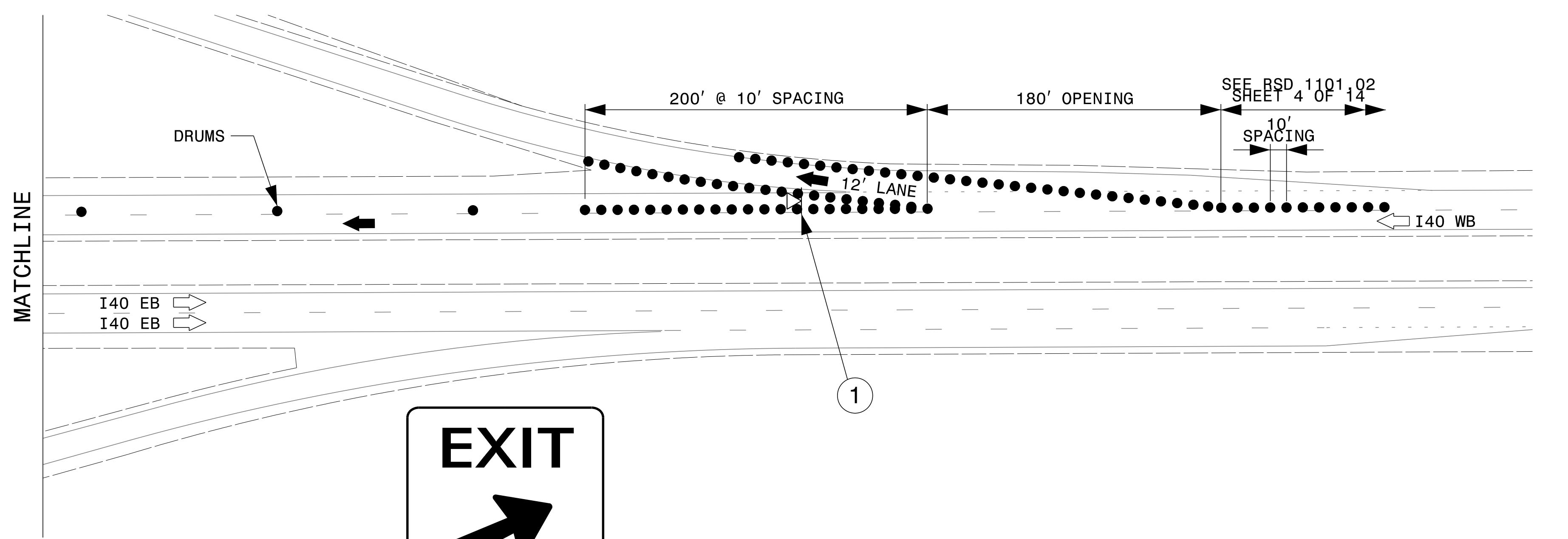
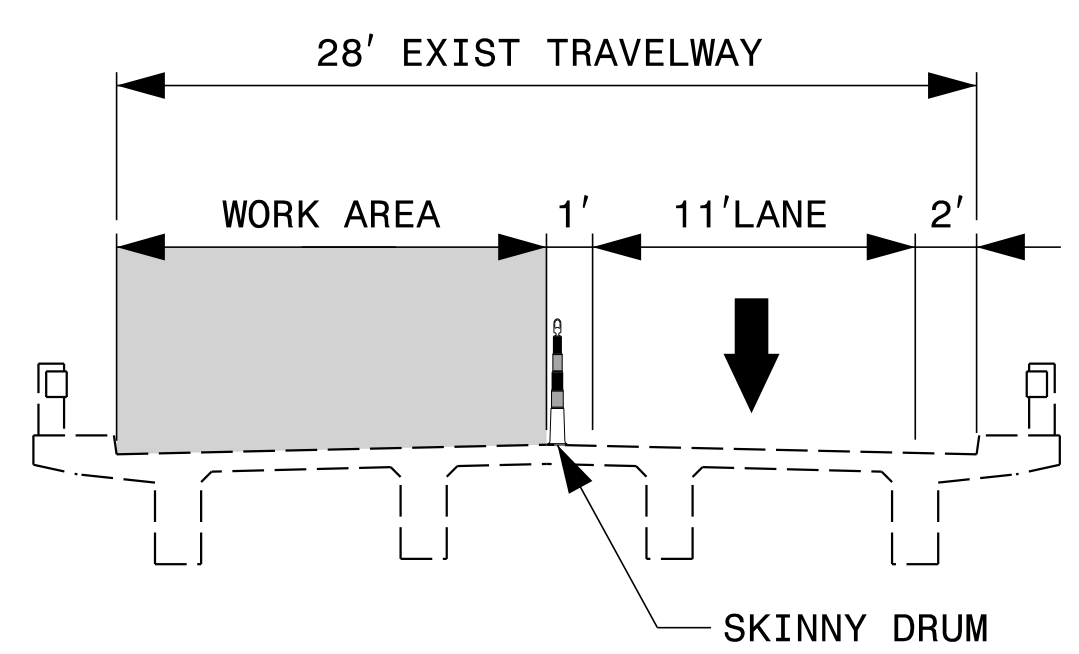
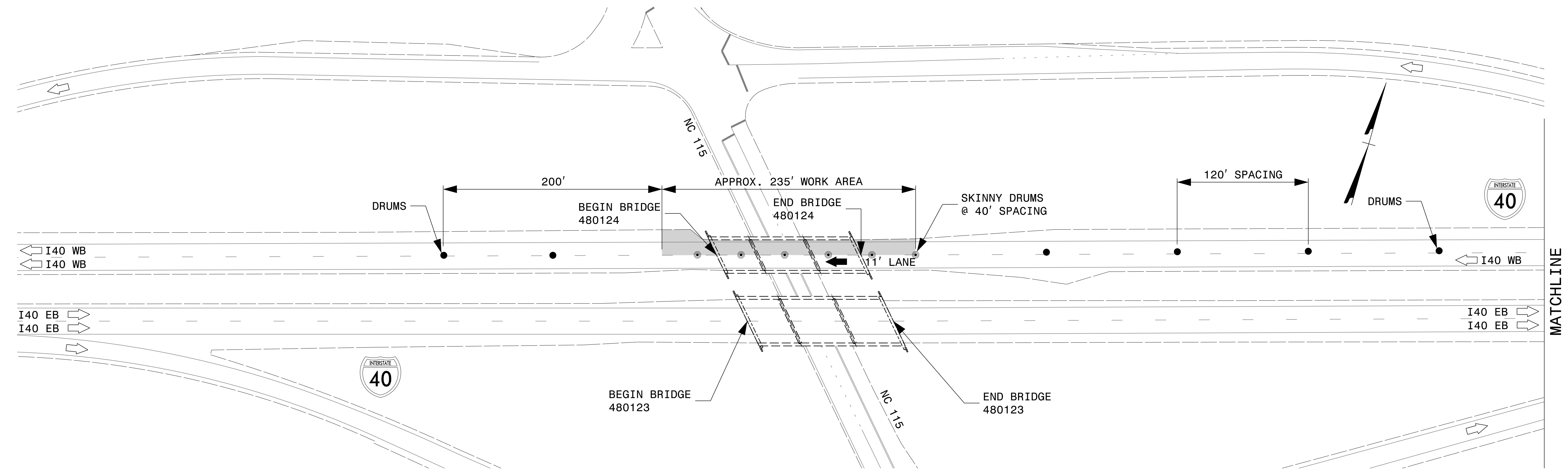

E5-1
48" X 42"

NOTES:

1. USE THIS DRAWING IN CONJUNCTION WITH RSD 1101.02 SHEET 4 OF 14.
2. USE SKINNY DRUMS THROUGH WORK AREA.
3. SEE SHEET TMP-1D FOR "ROAD NARROWS" SIGN PLACEMENT.

4/21/2022 15915B.TC.TMP_I40_WB_STRUCTURE_I24_OUTSIDE_LANE_CLOSURE_DETAILS.dgn User: jdebone

APPROVED: *Jacob Duke*
 DATE: 4/26/2022

SEAL

DocuSigned by:
Jacob Duke
2953030304E409

PROFESSIONAL SEAL
 043777
 ENGINEER
 JACOB H. DUKE

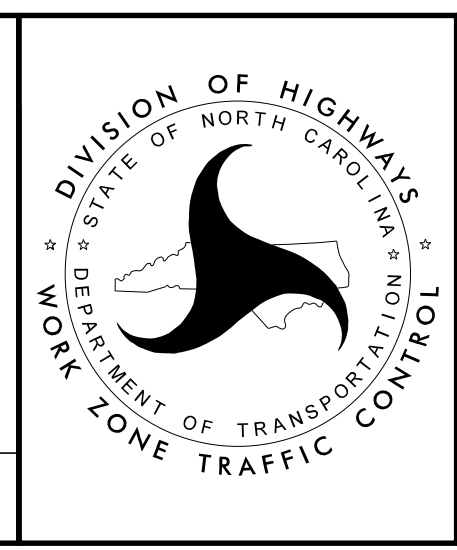

**I40 WB STRUCTURE
 480124 OUTSIDE LANE
 CLOSURE DETAILS**

**DOCUMENT NOT CONSIDERED FINAL
 UNLESS ALL SIGNATURES COMPLETED**

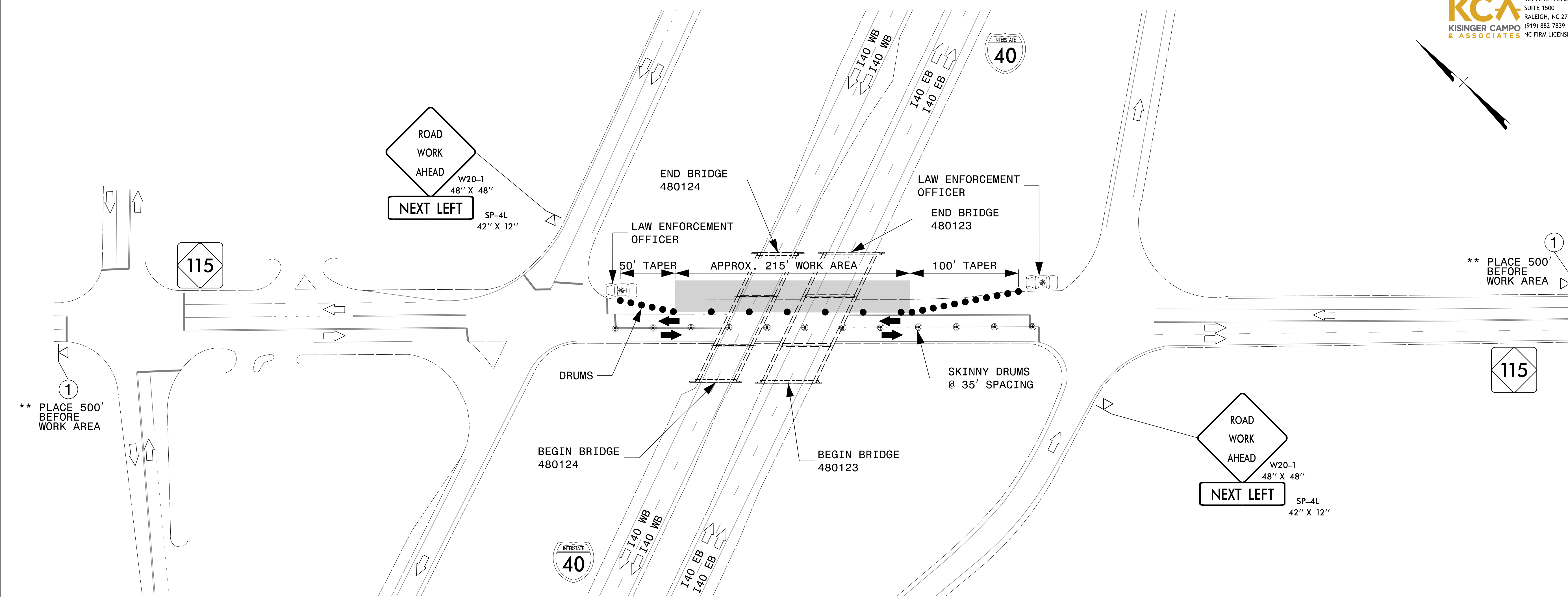

** PLACE 500' BEFORE WORK AREA

** PLACE 500' BEFORE WORK AREA

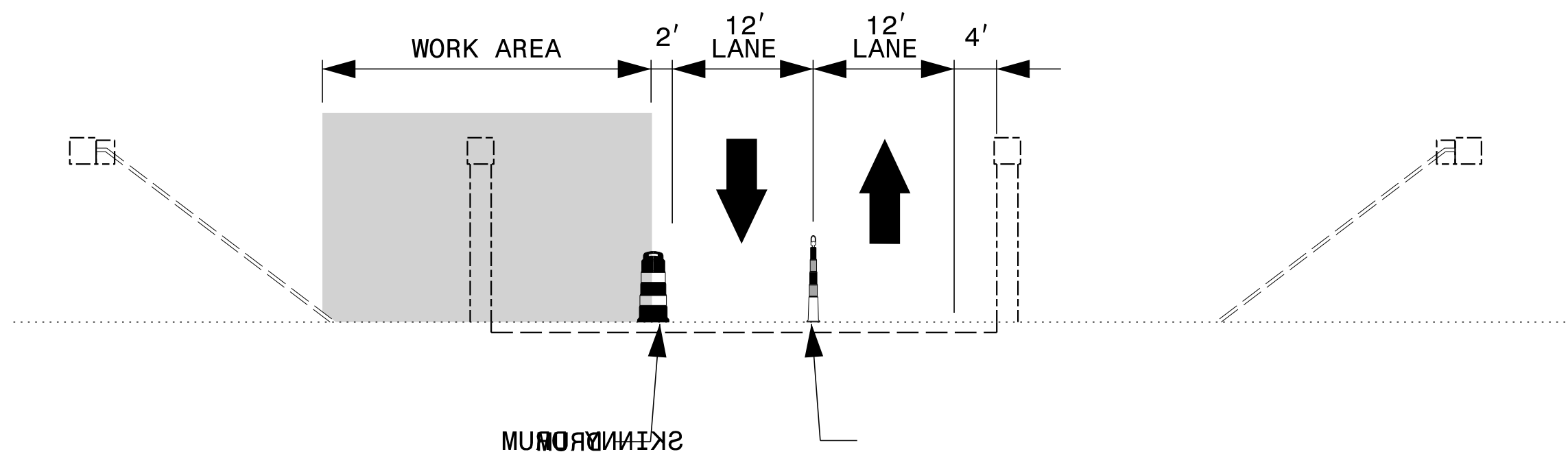

- NOTES:**
1. TRAFFIC CONTROL DEVICES SHALL BE INSTALLED PER ENGINEER'S INSTRUCTIONS.
 2. USE SKINNY DRUMS TO DIVIDE TRAFFIC.

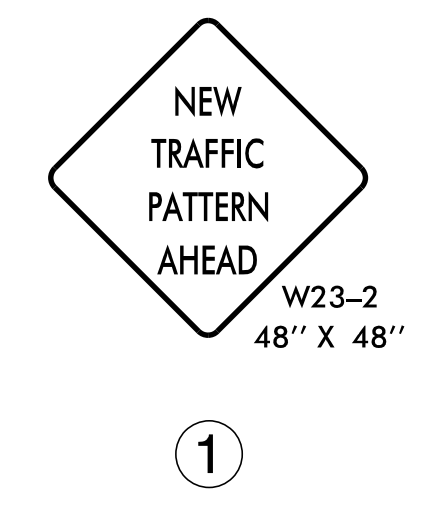

4/21/2022 15915B_TC_TMP_NC_115_NB_OUTSIDE_LANE_CLOSURE_DETAILS.dgn User: jdebone

APPROVED: *Jacob Duke*
DATE: 4/26/2022

SEAL

DOCUMENT NOT CONSIDERED FINAL UNLESS ALL SIGNATURES COMPLETED

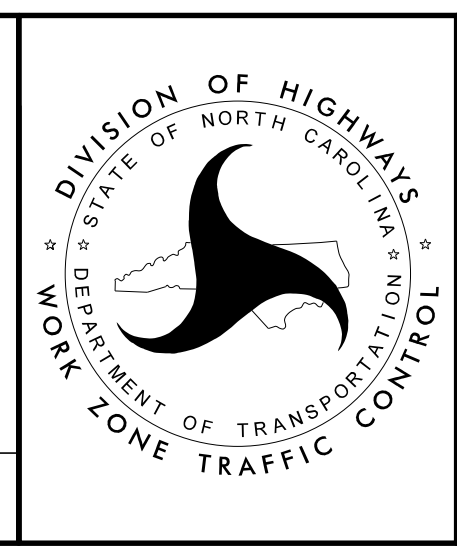

DIVISION OF HIGHWAYS
STATE OF NORTH CAROLINA
DEPARTMENT OF TRANSPORTATION
WORK ZONE TRAFFIC CONTROL

NC 115 NB OUTSIDE LANE CLOSURE DETAILS

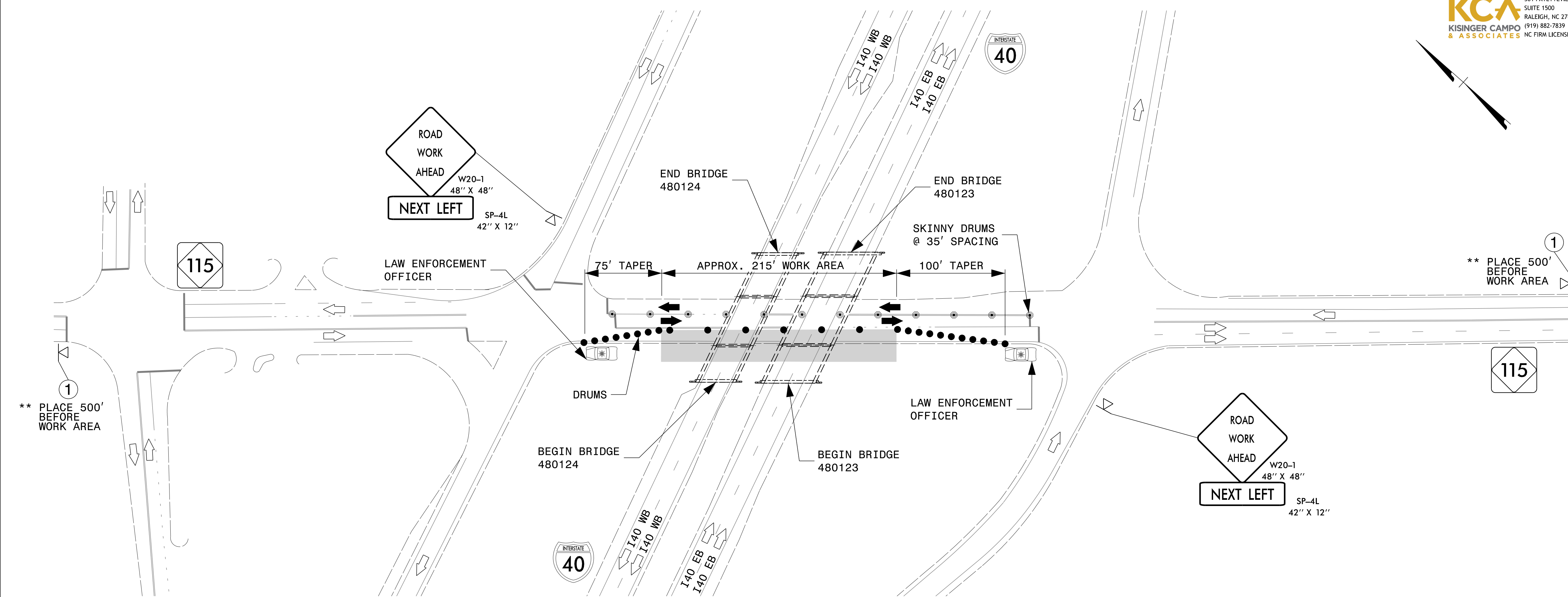

** PLACE 500' BEFORE WORK AREA

** PLACE 500' BEFORE WORK AREA

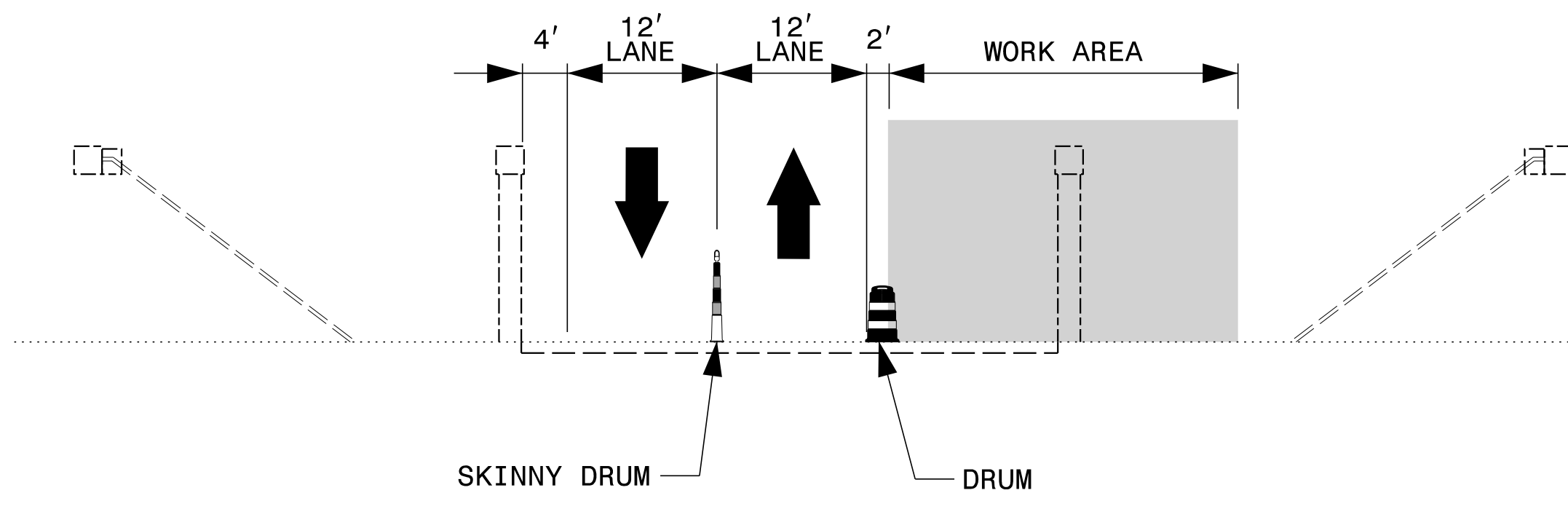

NOTES:

1. TRAFFIC CONTROL DEVICES SHALL BE INSTALLED PER ENGINEER'S INSTRUCTIONS.
2. USE SKINNY DRUMS TO DIVIDE TRAFFIC.

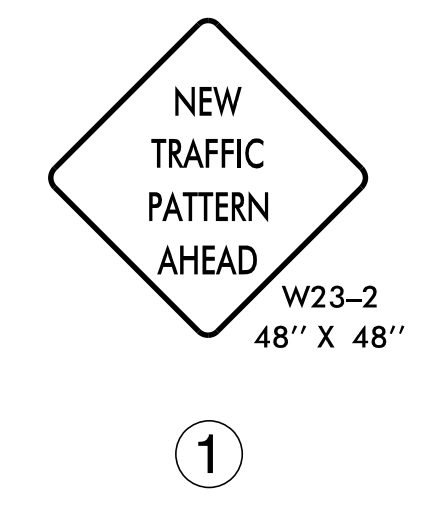

4/21/2022
15915B_TC_TMP_NC_115_SB_OUTSIDE_LANE_CLOSURE_DETAILS.dgn
User: jdebone

APPROVED: *Jacob Duke*
 DATE: 4/26/2022

SEAL

PROFESSIONAL ENGINEER
 JACOB H. DUKE
 043777

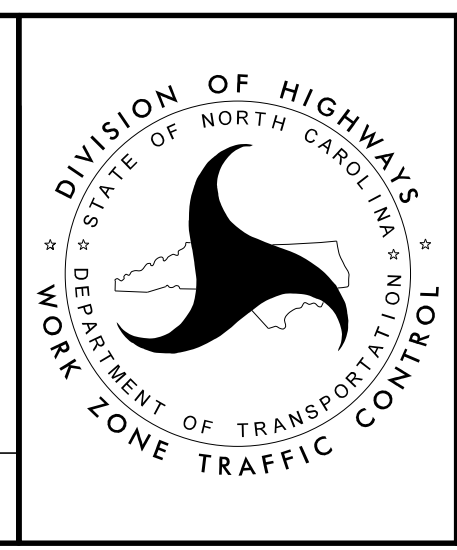

NC 115 SB OUTSIDE
 LANE CLOSURE DETAILS

DOCUMENT NOT CONSIDERED FINAL UNLESS ALL SIGNATURES COMPLETED