

CLASS II (PARTIAL DEPTH) REPAIR

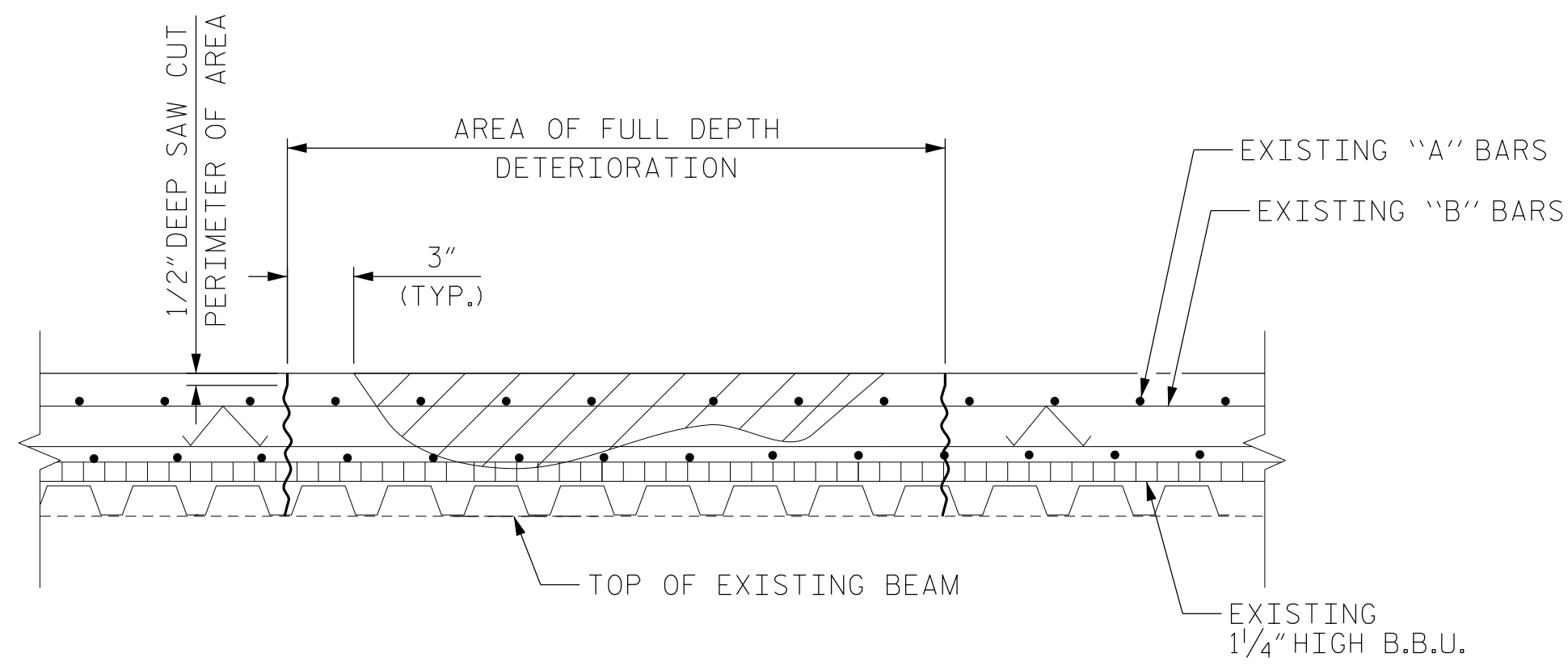

CLASS III (FULL DEPTH) REPAIR

NOTES

- FOR AREAS TO BE REPAIRED, SEE "PLAN OF SPANS" SHEETS.
- ALL DECK REPAIRS SHALL BE COMPLETED PRIOR TO PLACEMENT OF OVERLAY.
- FOR CLASS II AND CLASS III SURFACE PREPARATION, SEE OVERLAY SURFACE PREPARATIONS SPECIAL PROVISION.
- FOR CONCRETE FOR DECK REPAIR, SEE SPECIAL PROVISIONS.
- FOR SHOTCRETE REPAIR, SEE SPECIAL PROVISIONS.
- THE CONTRACTOR SHALL SUBMIT WORKING DRAWINGS TO THE ENGINEER FOR APPROVAL PRIOR TO STARTING WORK FOR TEMPORARY FORMWORK. FOR SUBMITTALS OF WORKING DRAWINGS, SEE SPECIAL PROVISIONS.
- UPON REMOVAL OF TEMPORARY FORMWORK, ALL VOIDS AND HONEYCOMBS ON THE UNDERSIDE OF DECK SURFACE SHALL BE FILLED WITH THE SAME MATERIAL AS USED FOR THE PATCH, AND FINISHED TO CONFORM TO THE SURROUNDING CONCRETE SURFACE.
- NO FORMWORK SHALL BE LEFT IN PLACE.
- FOR ADDITIONAL "CONCRETE REPAIR NOTES", SEE "CONCRETE RESTORATION DETAILS" SHEET.

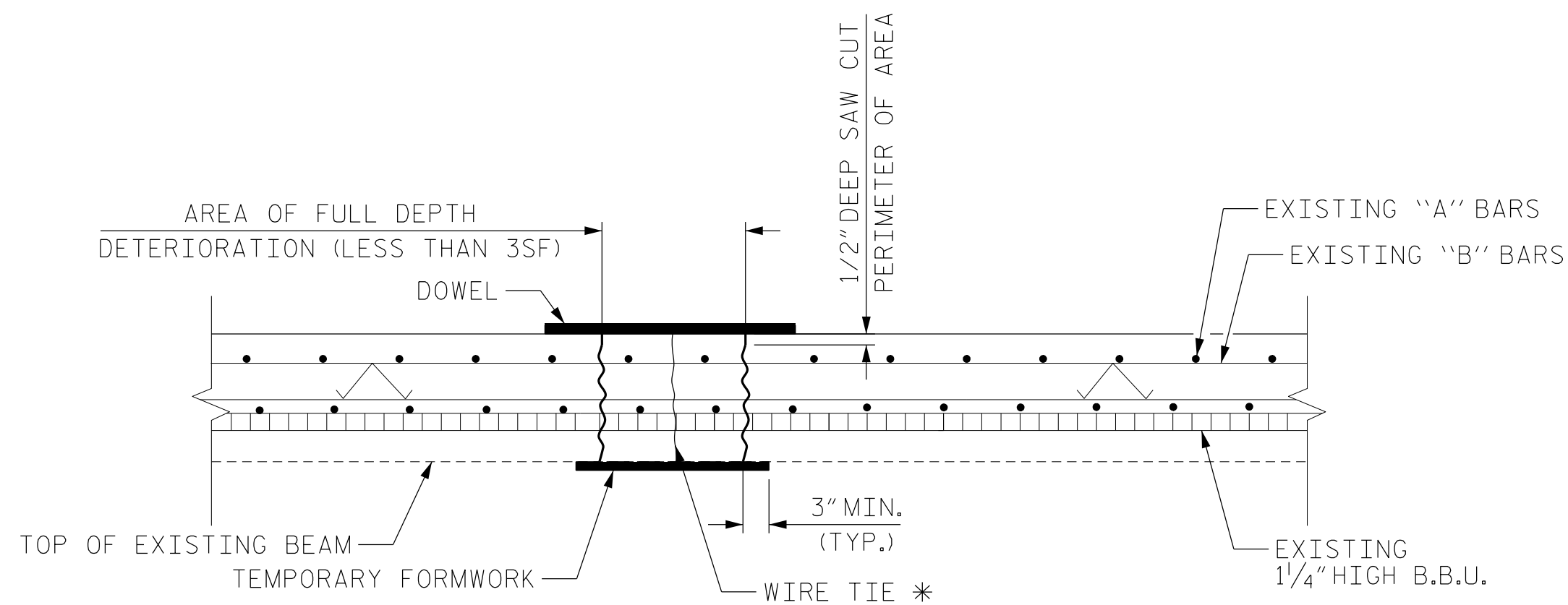

FULL DEPTH REPAIR WITH TEMPORARY FORMWORK

(FOR AREAS OF DETERIORATION EQUAL TO OR LESS THAN 3SF)

* WIRE TIE TO BE KNOTTED BELOW TEMPORARY FORMWORK AND ATTACHED TO DOWEL THAT IS WIDER THAN FORMED FULL DEPTH HOLE. ROTATE DOWEL TO TIGHTEN FORMWORK AGAINST BOTTOM OF DECK.

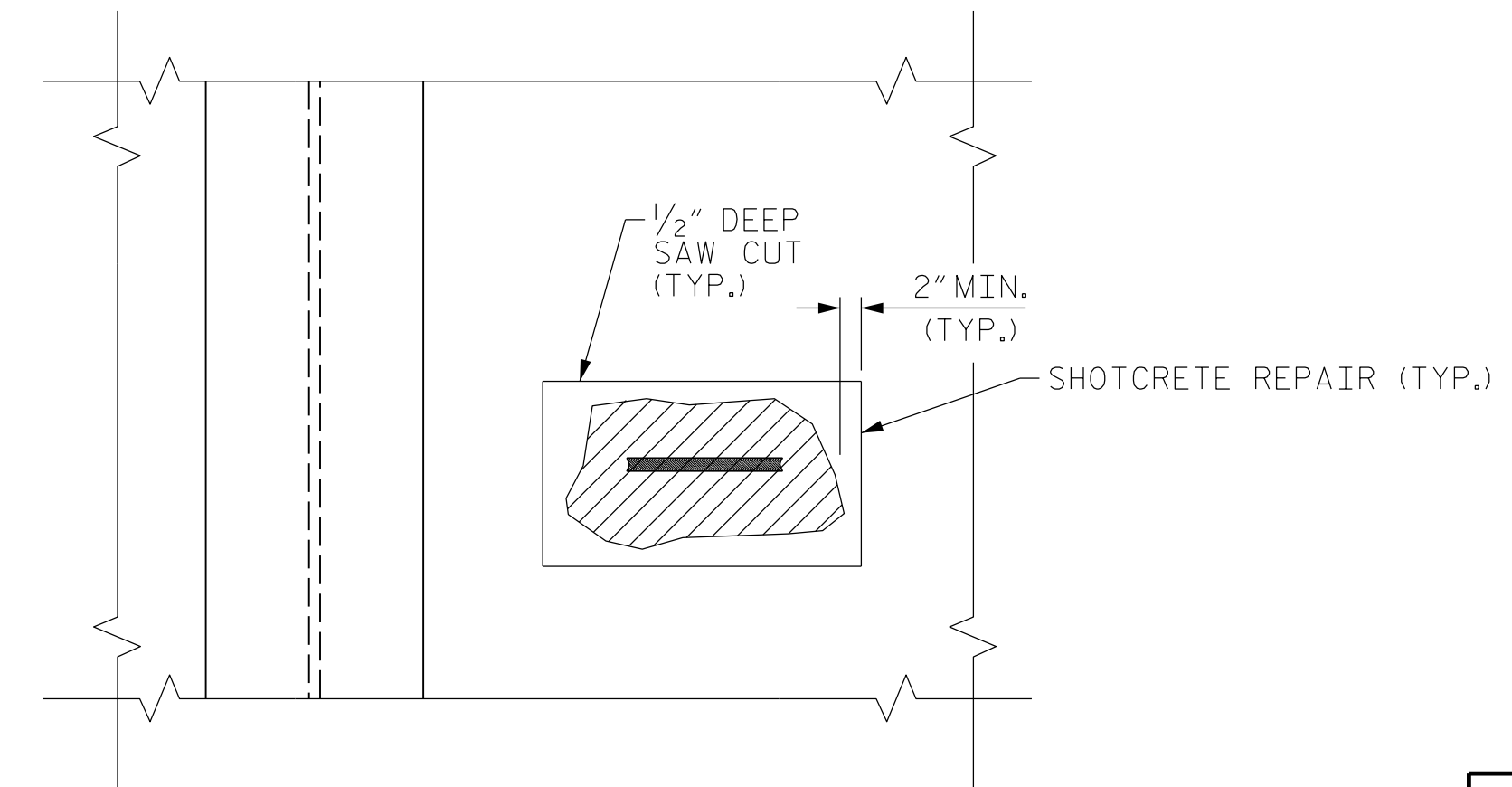

SECTION D-D

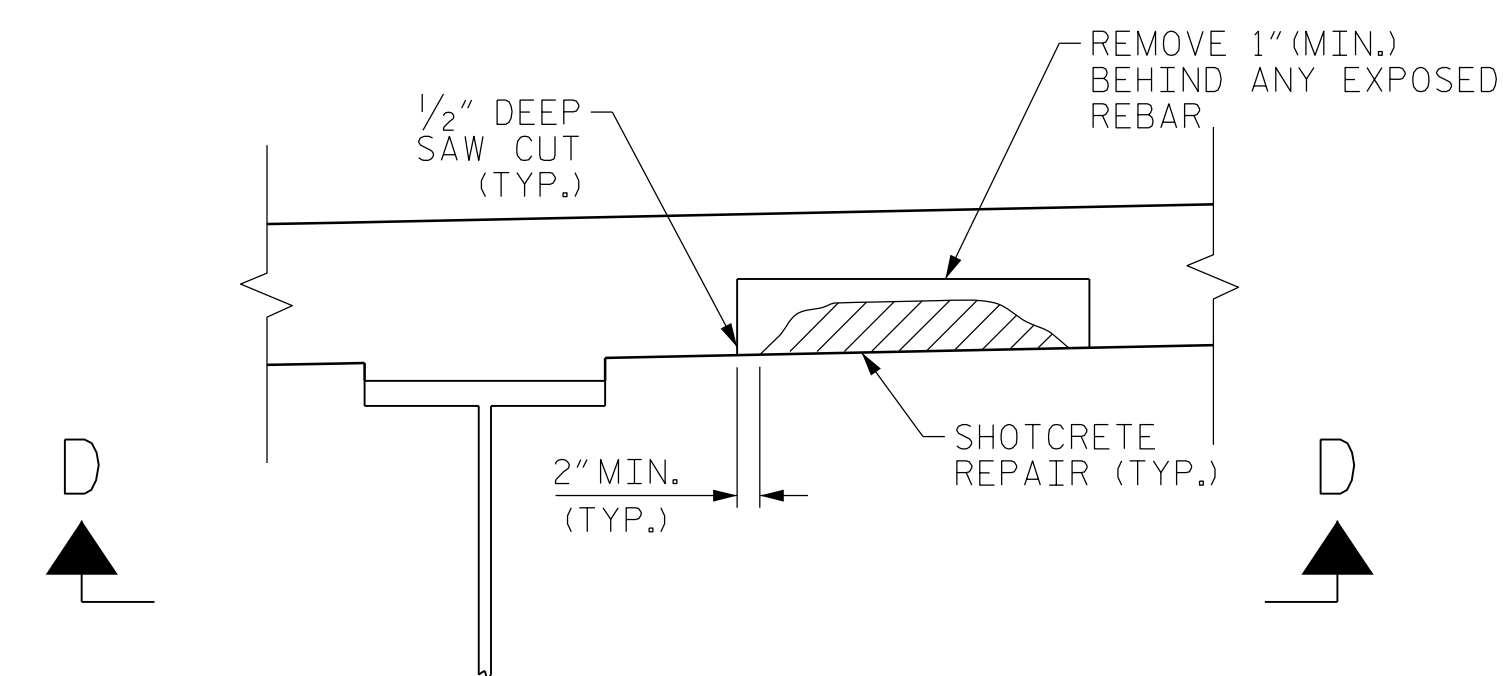

TYPICAL SECTION

BAR SIZE	SUPERSTRUCTURE REINFORCING STEEL LENGTHS ARE BASED ON THE FOLLOWING MINIMUM SPLICE LENGTHS				
	SUPERSTRUCTURE EXCEPT APPROACH SLABS, PARAPET, AND BARRIER RAIL		APPROACH SLABS		PARAPET AND BARRIER RAIL
	EPOXY COATED	UNCOATED	EPOXY COATED	UNCOATED	
#4	2'-0"	1'-9"	2'-0"	1'-9"	2'-9"
#5	2'-6"	2'-2"	2'-6"	2'-2"	3'-5"
#6	3'-0"	2'-7"	3'-10"	2'-7"	4'-4"
#7	5'-3"	3'-6"			
#8	6'-10"	4'-7"			

BRIDGES: 170171, 170172, 170177, 170178
 480006, 480007, 480051, 480054
 480065, 480066, 480072, 480073
 480096, 480102, 480104, 480109
 480123, 480124

PROJECT NO. I-5915B
 _____ COUNTY
 BRIDGE NO. MULTIPLE

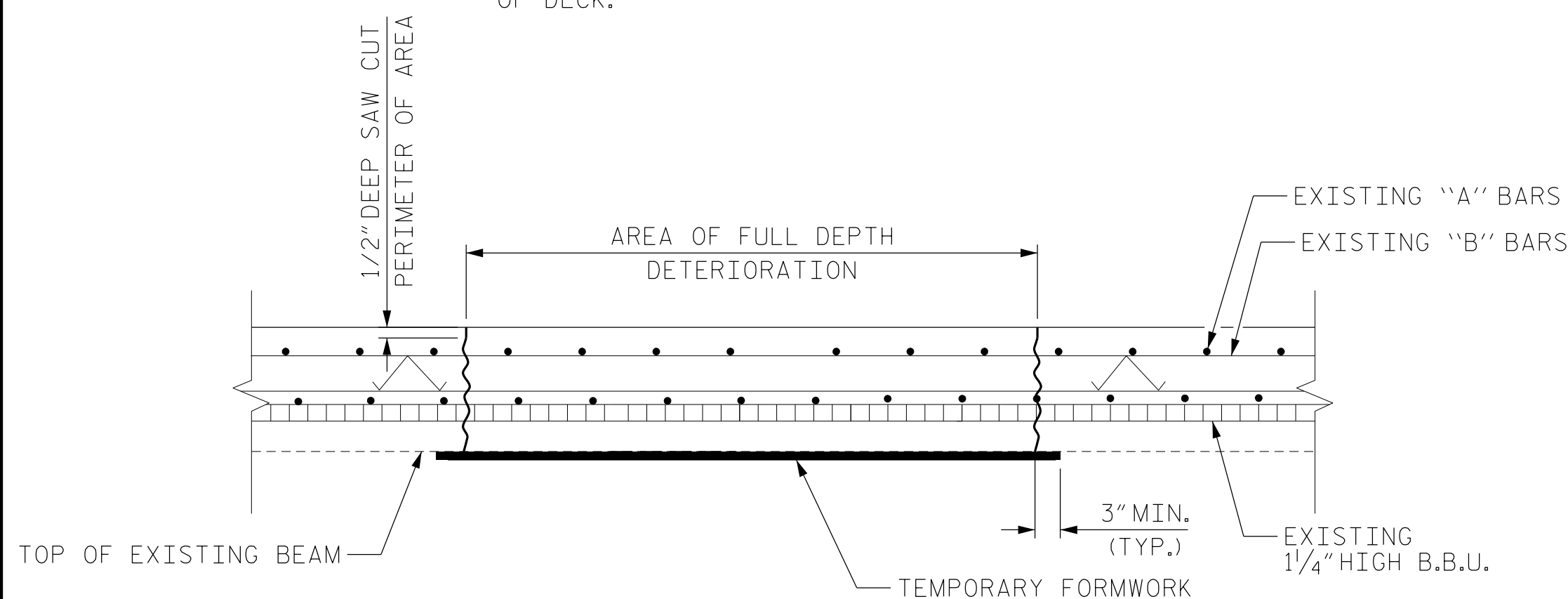

FULL DEPTH REPAIR WITH TEMPORARY FORMWORK

(FOR AREAS OF DETERIORATION GREATER THAN 3SF)

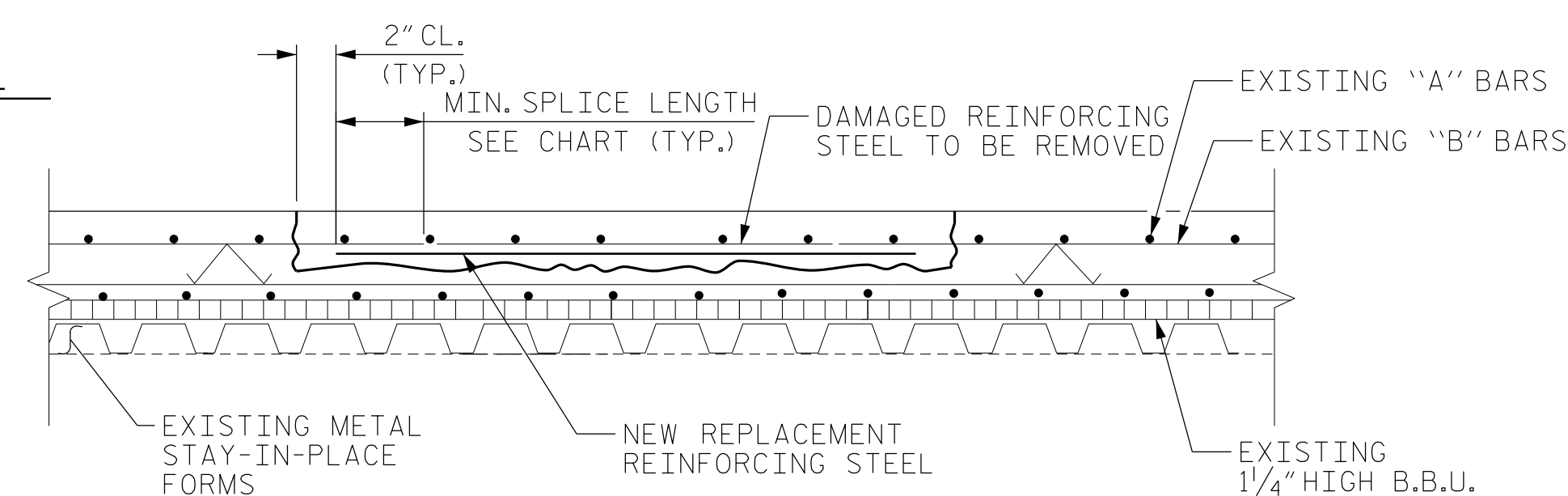

REINFORCING STEEL REPAIR

UNDERSIDE OF DECK REPAIR

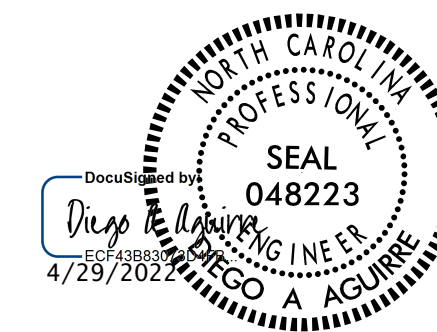

DRAWN BY : DIEGO A. AGUIRRE DATE : 01/2022
 CHECKED BY : FIDEL L. FLORES DATE : 01/2022
 DESIGN ENGINEER OF RECORD: DIEGO A. AGUIRRE DATE : 01/2022

4/29/2022
 I5915B.SMU_DRD01.dgn
 daquirre

DOCUMENT NOT CONSIDERED
 FINAL UNLESS ALL
 SIGNATURES COMPLETED

STATE OF NORTH CAROLINA DEPARTMENT OF TRANSPORTATION RALEIGH STANDARD						SHEET NO. S5
DECK REPAIR DETAILS						
REVISIONS						TOTAL SHEETS 9
NO.	BY:	DATE:	NO.	BY:	DATE:	
1			3			
2			4			