

SEE RSD 1101.02
 SHEET 4 OF 14

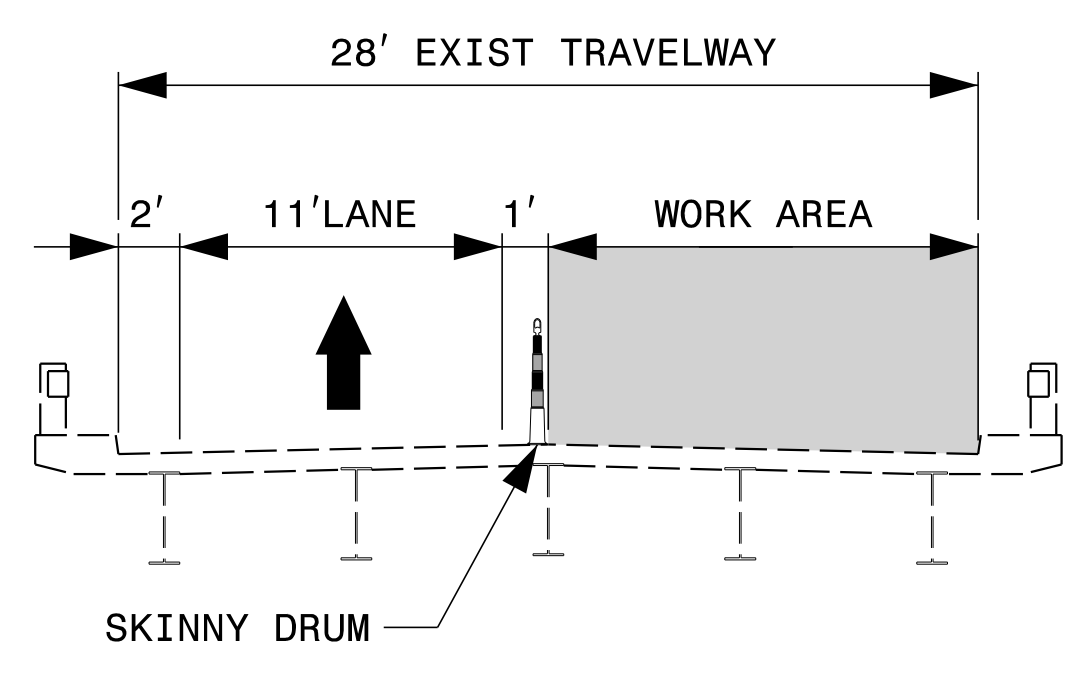

NOTES:

1. USE THIS DRAWING IN CONJUNCTION WITH RSD 1101.02 SHEET 4 OF 14.
2. USE SKINNY DRUMS THROUGH WORK AREA.
3. SEE SHEET TMP-1D FOR "ROAD NARROWS" SIGN PLACEMENT.

APPROVED: *Jacob Duke*
DocuSigned by: Jacob Duke 2953903034E94D9

DATE: 4/26/2022

SEAL

SEAL
 NORTH CAROLINA
 PROFESSIONAL
 ENGINEER
 043777
 JACOB H. DUKE

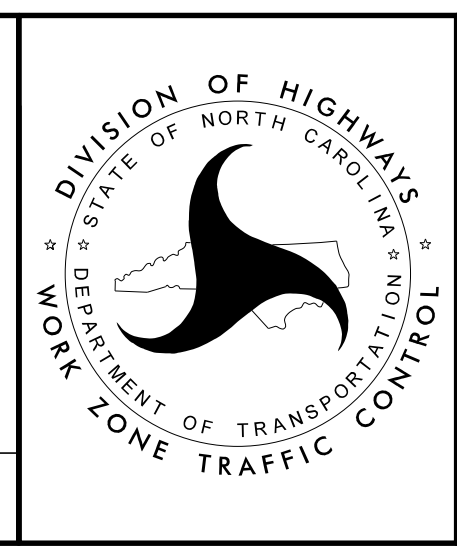

**I40 EB STRUCTURE 480006
 OUTSIDE LANE
 CLOSURE DETAILS**

4/21/2022
 I5915B_TC_TMP_I40_EB_STRUCTURE_006_OUTSIDE_LANE_CLOSURE_DETAILS.dgn
 User: jdebone