

-L-

PIs Sta 16+80.16 θs = 2° 51' 53.2" Ls = 200.00' LT = 133.35' ST = 66.68'	PIs Sta 24+44.47 Δ = 1° 35' 19.6" (LT) D = 0° 34' 22.6" L = 277.29' T = 138.65' R = 10,000.00' e = NC	PIs Sta 26+49.78 θs = 0° 34' 22.6" Ls = 200.00' LT = 133.33' ST = 66.67'	PIs Sta 29+71.34 Δ = 1° 32' 43.3" (RT) D = 3° 36' 53.6" L = 374.71' T = 188.23' R = 1,585.00'
--	---	--	--

-YI-

PIs Sta 11+40.76 Δ = 9° 57' 38.2" (RT) D = 60° 18' 40.8" L = 152.48' T = 98.31' R = 95.00' e = 0.04 FT/FT

Place Matting for Erosion Control on Slope as Work Allows.
Sta. 17+00 to Sta. 20+30 LT
Sta. 22+75 to Sta. 25+00 LT
Sta. 17+00 to Sta. 19+50 RT

NOTE: UTILIZE TEMPORARY SEDIMENT BASIN OR SPECIAL STILLING BASIN(S) AS STILLING BASIN WHERE APPLICABLE.

36' x 18' x 3'
1.5 inch Skimmer
with 0.625 inch
Orifice Diameter
4 ft. weir
ID 5.1

32' x 16' x 3'
1.5 inch Skimmer
with 0.50 inch
Orifice Diameter
4 ft. weir
ID 5.2

MATCHLINE -L- 17+00
SEE SHEET EC-06

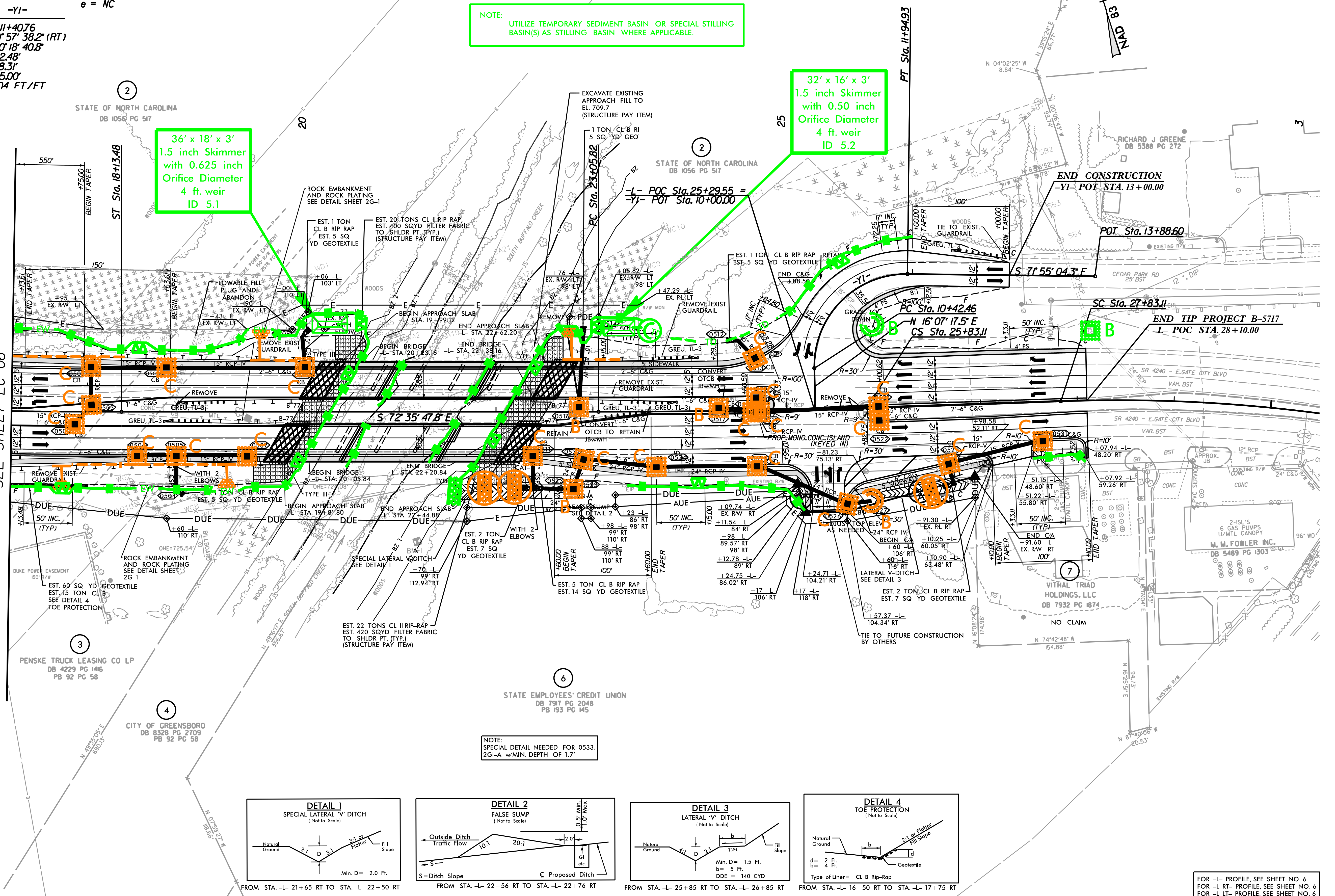

NOTE: SPECIAL DETAIL NEEDED FOR 0533. 2GI-A w/MIN. DEPTH OF 1.7'

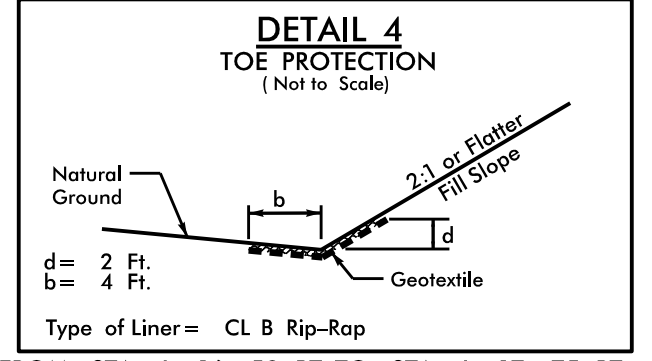
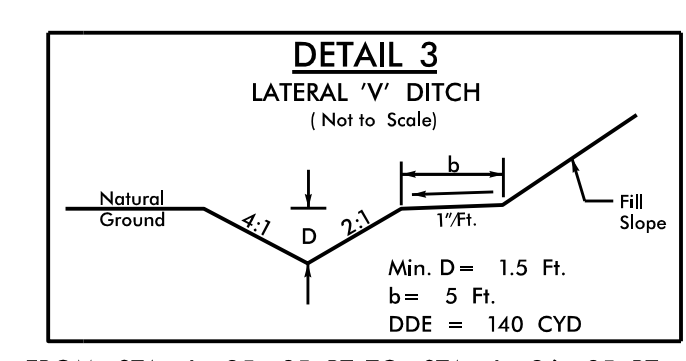
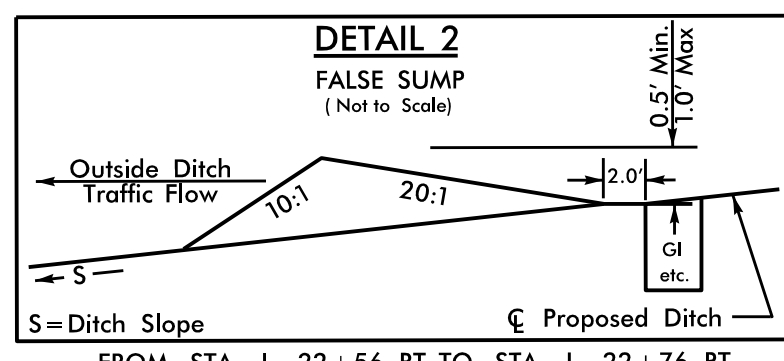
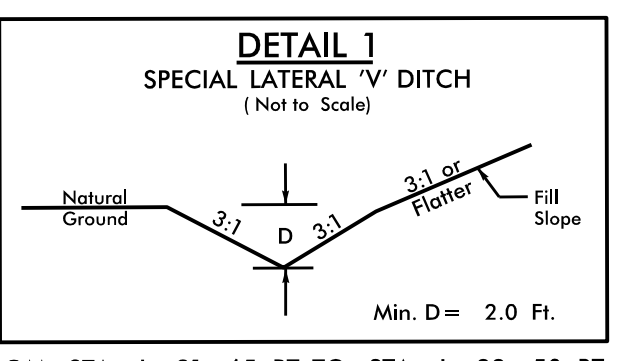

FOR -L- PROFILE, SEE SHEET NO. 6
FOR -L- RT- PROFILE, SEE SHEET NO. 6
FOR -L- LT- PROFILE, SEE SHEET NO. 6

5/14/2019 10:57:57 PM \\S:\AU-B-5717\900-CAD\GIS\910-CAD\70-900-CAD\TIP\Erosion_Control\Design\230-B5717_EC_PSH07_FG.dgn