

+

+

3/27/2022 5:56:35 PM G:\Project\204\2040652\28\CLIENT\Structures\U2519BB\SMU\_BRI\_250452.dgn

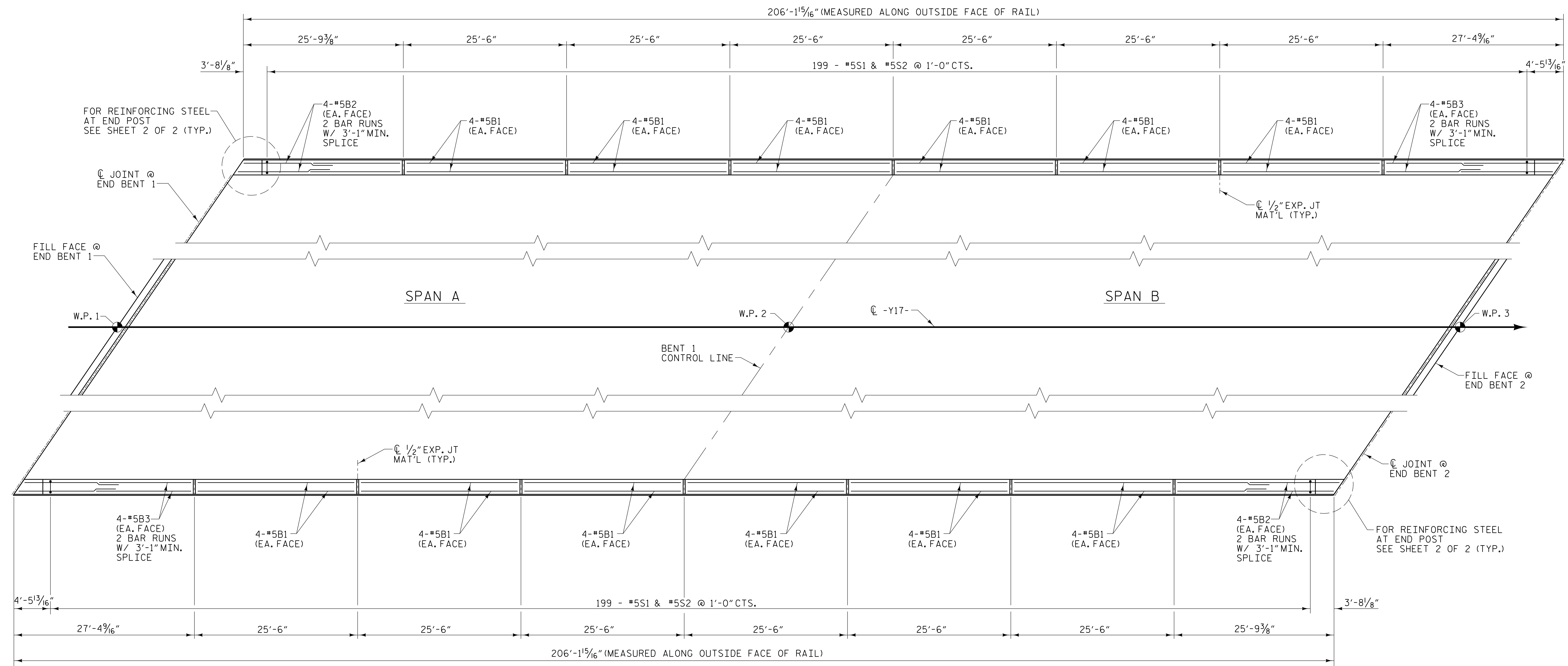

**PLAN OF PARAPET**  
 ALL DIMENSIONS ARE MEASURED ALONG OUTSIDE FACE OF PARAPET

PROJECT NO. U-2519BB  
CUMBERLAND COUNTY  
 STATION: 80+65.32 -Y17- POT

SHEET 1 OF 2

STATE OF NORTH CAROLINA  
 DEPARTMENT OF TRANSPORTATION  
 RALEIGH

SUPERSTRUCTURE  
 1'-2" x 2'-6"  
 CONCRETE PARAPET

DRAWN BY: M. D. METZGER DATE: 2/22  
 CHECKED BY: L. K. AUSTIN DATE: 2/22  
 DESIGN ENGINEER OF RECORD: L. K. AUSTIN DATE: 2/22

PLANS PREPARED BY:

**NV5**

NV5 ENGINEERS & CONSULTANTS, INC.  
 3300 REGENCY PARKWAY, SUITE 100  
 CARY, NC 27518  
 P: 919.851.1912 www.nv5.com  
 NC License # F-1333  
 Formerly CAVI Engineers & Consultants

**DOCUMENT NOT CONSIDERED FINAL  
 UNLESS ALL SIGNATURES COMPLETED**



REVISIONS						SHEET NO.
NO.	BY:	DATE:	NO.	BY:	DATE:	S-18
1			3			TOTAL SHEETS
2			4			41