

- UTILIZE -Y16DET- AND TEMP. TIE FOR -Y15- TRAFFIC ACCESS TO -Y16REV- (SHOWN)
- UPON COMPLETION OF -Y15- TIE TO -Y16REV- SHIFT TRAFFIC AND REMOVE -Y16DET- (NOT SHOWN)

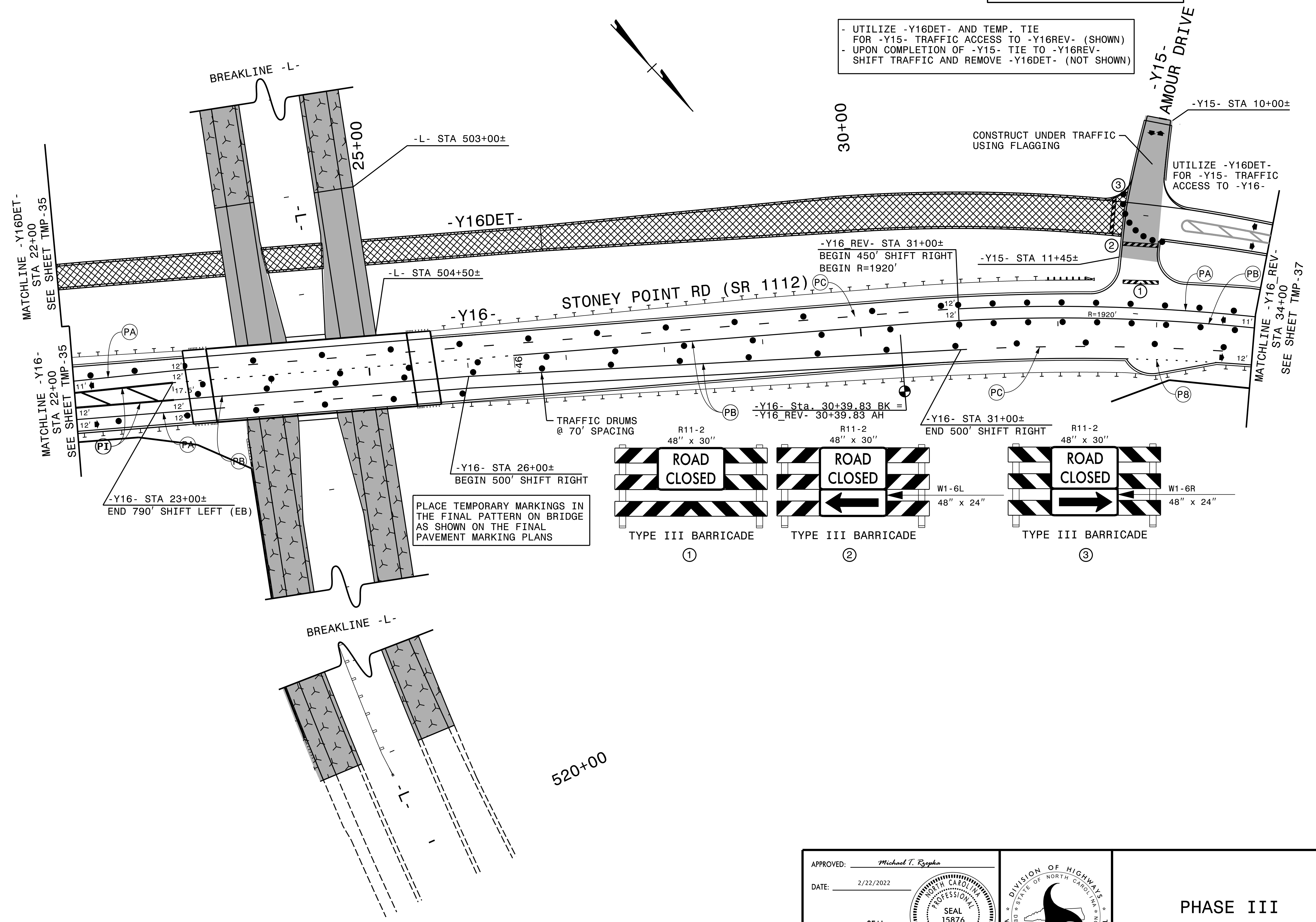

PLACE TEMPORARY MARKINGS IN THE FINAL PATTERN ON BRIDGE AS SHOWN ON THE FINAL PAVEMENT MARKING PLANS

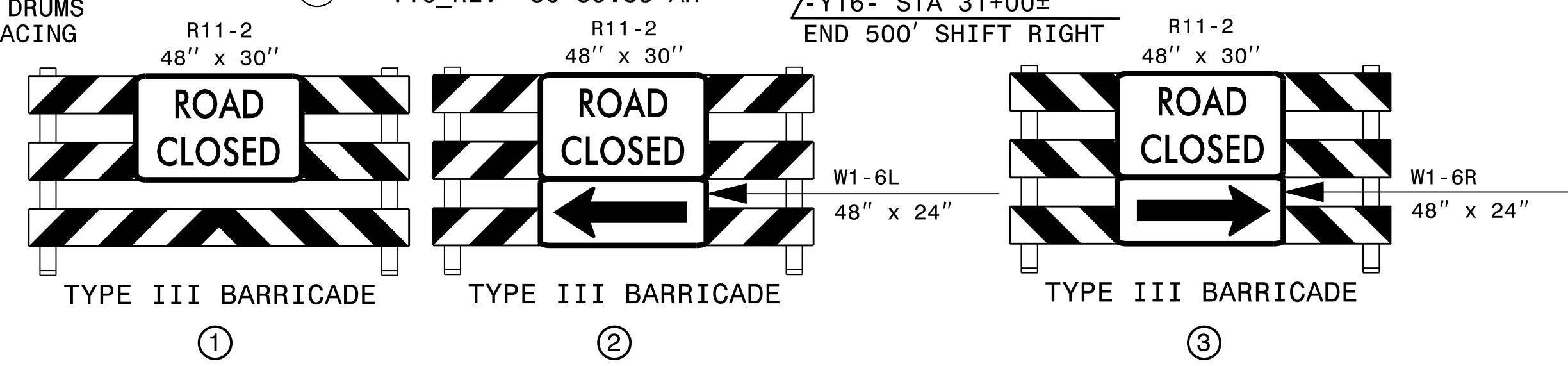

REVISIONS

PLOT DRIVER: NCDOT_pdr_mono_eng_50.plt
PENTABLE: NCDOT_tcp.tbl
USER: MRZEPKA
DATE: 2/22/2022
TIME: 3:17:26 PM
FILE: pwa\pwhdr\uses01\HDR_US_East_01\Documents\3322\10000297\10049989\6.0\CAD\BIM\6.2\Work_In_Progress\U-2519BA\TrafficControl\TCP\U2519ba_tcp_psh_36.dgn

APPROVED: *Michael T. Reepke*
DATE: 2/22/2022
SEAL

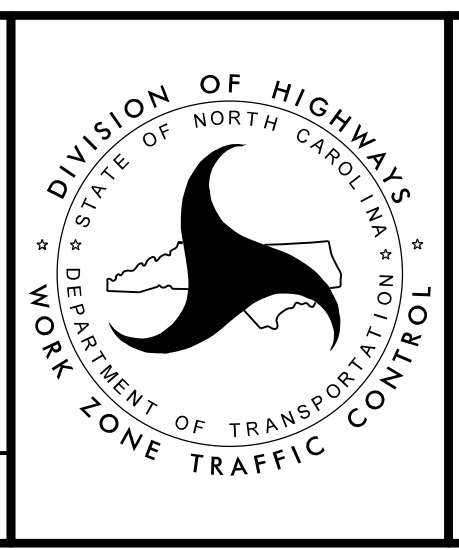

PHASE III
DETAIL

DOCUMENT NOT CONSIDERED FINAL
UNLESS ALL SIGNATURES COMPLETED