

| | |
|-------------------------|---------------------|
| PROJECT REFERENCE NO. | SHEET NO. |
| R-5819 /R-5820 | EC-55/CONST.9 |
| RW SHEET NO. | |
| ROADWAY DESIGN ENGINEER | HYDRAULICS ENGINEER |

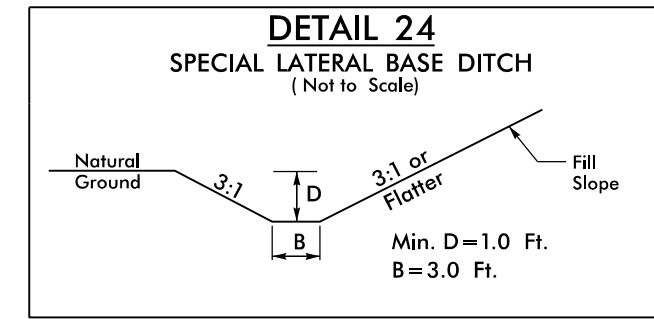
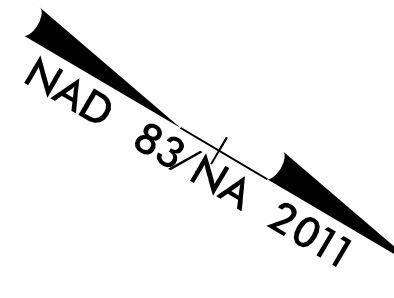

FROM STA. 67+00 TO STA. 73+50 -Y2- LT
FROM STA. 73+50 TO STA. 73+81 -Y2- RT
FROM STA. 84+36 TO STA. 93+50 -Y7- RT

| -Y7- | |
|-------------------------------------|-------------------------------------|
| PI Sta 75+47.67 | PI Sta 90+98.48 |
| $\Delta = 22^\circ 53' 23.1''$ (RT) | $\Delta = 22^\circ 52' 08.1''$ (LT) |
| D = 1,398.26' | D = 2,297.280' |
| L = 1,398.26' | L = 918.02' |
| T = 708.58' | T = 465.20' |
| R = 3,500.00' | R = 2,300.00' |
| SE = 03 | SE = 04 |

MATCH LINE -Y7- STA 80+00.00
SEE SHEET 24

MATCH LINE -Y2- STA 70+00.00
SEE SHEET 18

MATCH LINE -Y7- STA 87+00.00
SEE SHEET 25

8/17/99

REVISIONS

3/14/2022
R-5819-R-5820_REU_EC_PSH19_FINAL.dgn
RUS/ETC/MLH

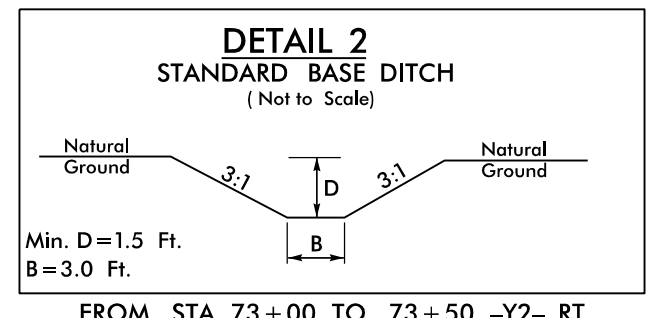
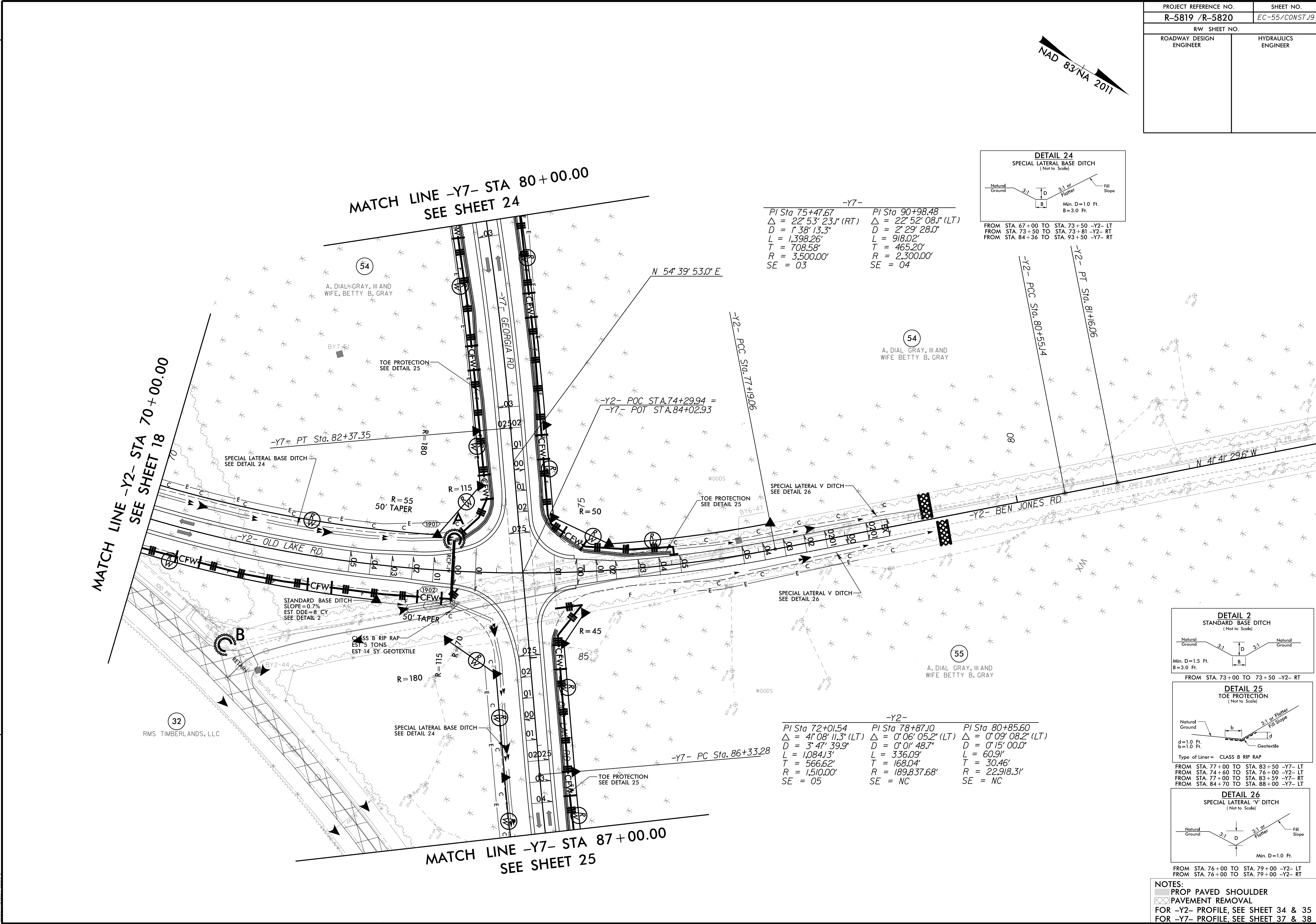

FROM STA. 73+00 TO 73+50 -Y2- RT

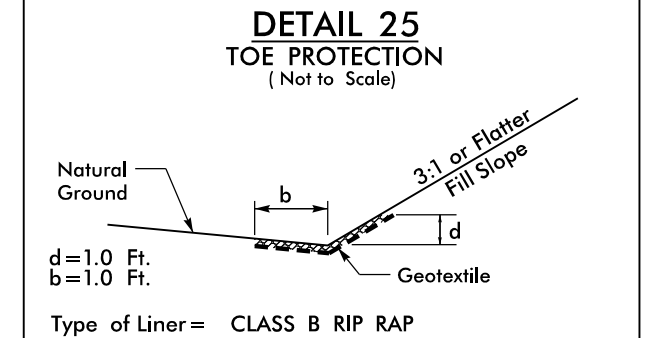

FROM STA. 77+00 TO STA. 83+50 -Y7- LT
FROM STA. 74+60 TO STA. 76+00 -Y2- LT
FROM STA. 77+00 TO STA. 83+59 -Y7- RT
FROM STA. 84+70 TO STA. 88+00 -Y7- LT

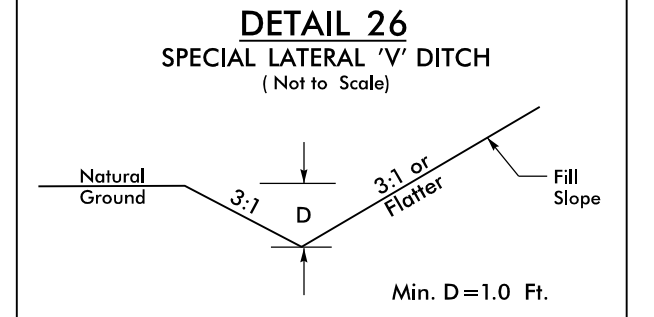

FROM STA. 76+00 TO STA. 79+00 -Y2- LT
FROM STA. 76+00 TO STA. 79+00 -Y2- RT

NOTES:
 PROP PAVED SHOULDER
 PAVEMENT REMOVAL
 FOR -Y2- PROFILE, SEE SHEET 34 & 35
 FOR -Y7- PROFILE, SEE SHEET 37 & 38