

PROJECT REFERENCE NO. R-5819 /R-5820	SHEET NO. EC-52/CONST J6
R/W SHEET NO.	
ROADWAY DESIGN ENGINEER	HYDRAULICS ENGINEER

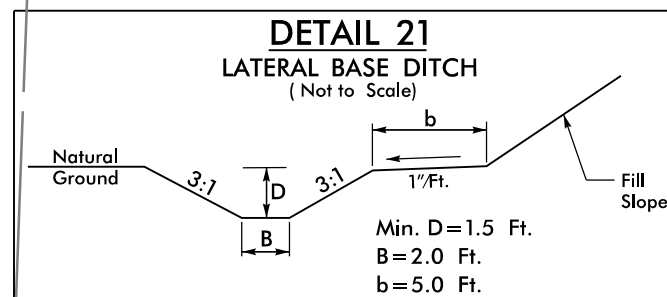
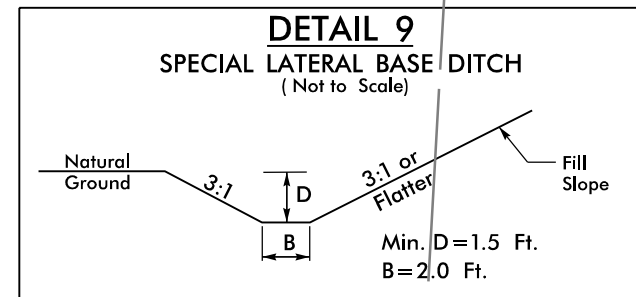
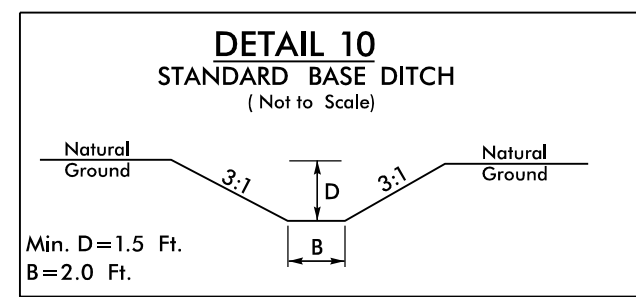

FROM STA. 29+17 TO 29+50 -Y2- RT
DDE = 8 CY

FROM STA. 29+23 TO STA. 31+00 -Y2- LT
FROM STA. 29+50 TO STA. 32+00 -Y2- RT

FROM STA. 31+00 TO STA. 38+50 -Y2- LT
DDE = 807 CY
FROM STA. 32+00 TO STA. 38+50 -Y2- RT
DDE = 677 CY

Place Matting for Erosion Control
on Slope as Work Allows.
Sta. 33+00 to Sta. 34+50 -Y2- LT
Sta. 33+00 to Sta. 34+50 -Y2- RT

NAD 83/NA 2011

HALLSBORO CONSTRUCTION COMPANY, INC.

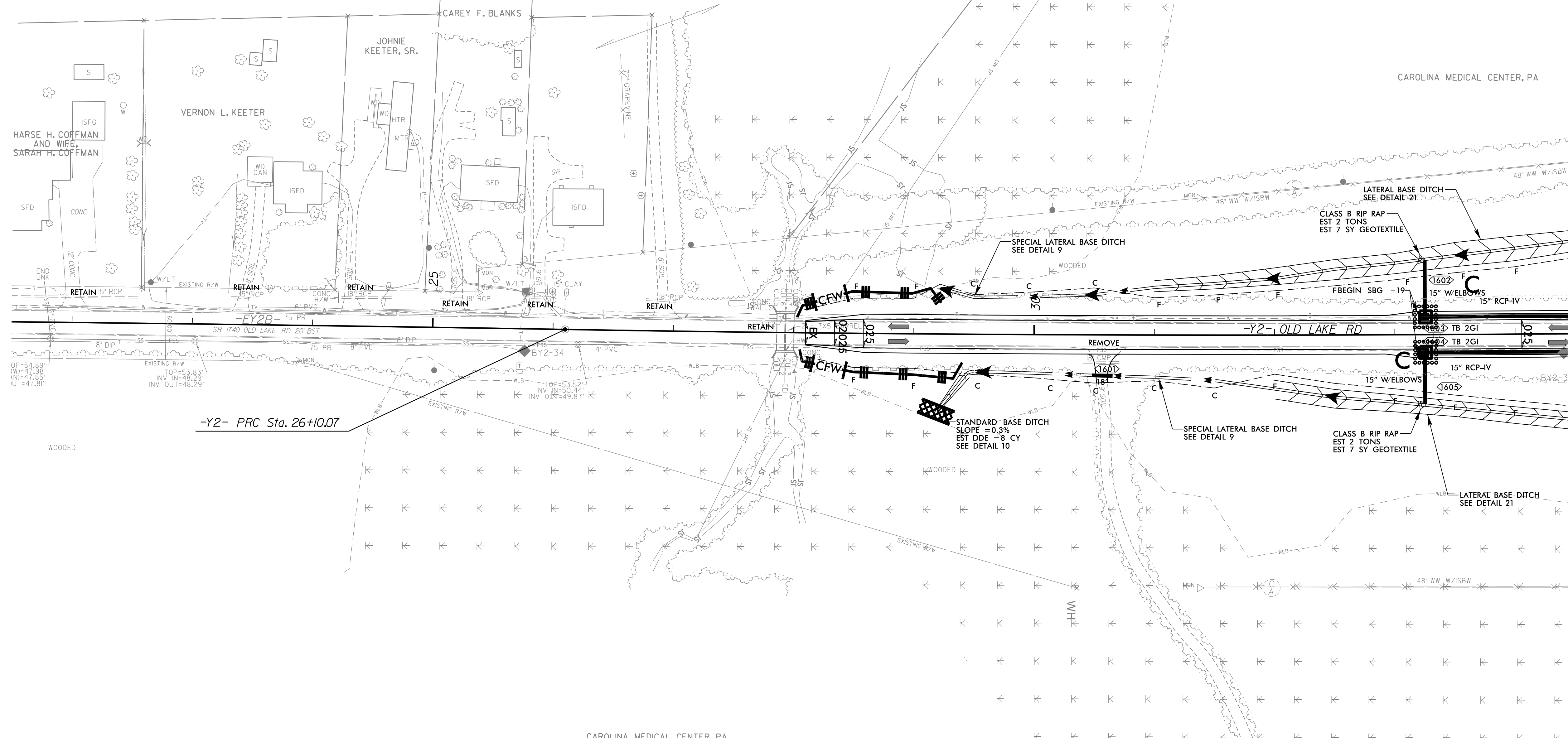

-Y2-

Δ Sta 22+53.62	PI Sta 30+35.83
Δ = 0' 32' 51.9" (RT)	Δ = 1' 29' 17.3" (LT)
Δ = 0' 04' 36.6"	Δ = 0' 10' 29.2"
Δ = 712.90'	Δ = 851.49'
Δ = 356.45'	Δ = 425.77'
Δ = 74,571.88'	Δ = 32,783.83'
Δ = NC	Δ = NC

MATCHLINE -Y2- STA. 34+50.00
SEE SHEET 11

NOTES:
ALL DRIVEWAY RADII ARE 5' UNLESS OTHERWISE NOTED
PROP PAVED SHOULDER
FOR -Y2- PROFILE, SEE SHEET 33

REVISIONS

3/14/2022
R5819_R5820_REU_EC_PSH16_FINAL.dgn
JUS:R5819