

PROJECT REFERENCE NO. R-5819/R-5820		SHEET NO. EC-49/CONST.13	
RW SHEET NO.		HYDRAULICS ENGINEER	
ROADWAY DESIGN ENGINEER		HYDRAULICS ENGINEER	

CALYX
ENGINEERS + CONSULTANTS
6750 TRYON ROAD
CARY, NC 27518
PHONE: 919.851.1912
CALYXengineers.com
NC License # F-1333

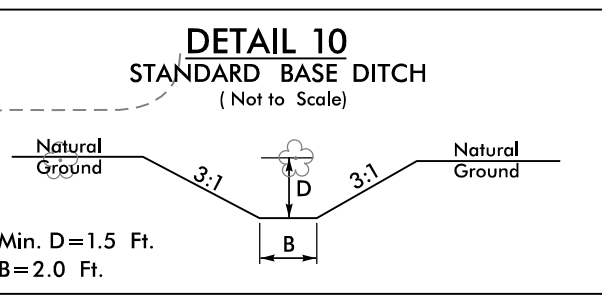

UTILIZE FABRIC INSERT INLET PROTECTION DEVICES IN LIEU OF ROCK INLET SEDIMENT TRAPS, TYPE - C AS DIRECTED TO AVOID IMPOUNDMENT OF RUNOFF IN ROADWAY OPEN TO TRAFFIC

FROM STA. 12+41 TO 14+15 -Y3- LT
AT STA. 13+65 -Y1- LT
DDE = 20 CY

NAD 83/NA 2011

MATCHLINE -Y1- STA. 16+00.00
SEE SHEET 14

NOTES:
ALL DRIVEWAY RADII ARE 5' UNLESS OTHERWISE NOTED
 PROP CONC. ISLAND
 PROP PAVED SHOULDER
 PROP CONC. MOUNTABLE ISLAND
 FOR -Y1- PROFILE, SEE SHEET 23
 FOR -Y1A- PROFILE, SEE SHEET 31
 FOR -Y3- PROFILE, SEE SHEET 31

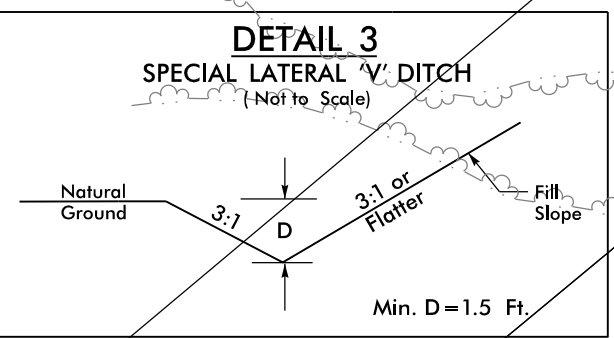
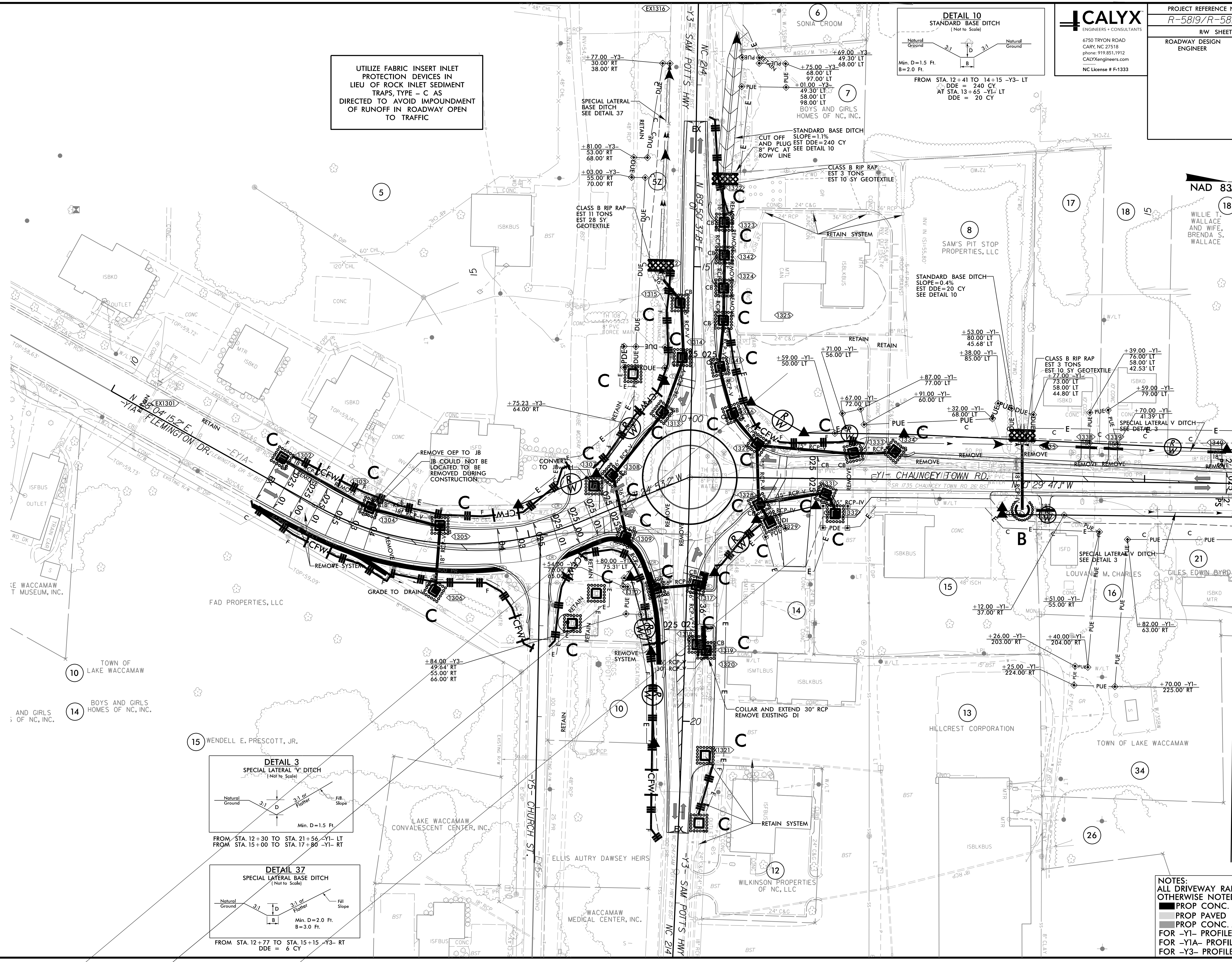

FROM STA. 12+30 TO STA. 21+56 -Y1- LT
FROM STA. 15+00 TO STA. 17+80 -Y1- RT

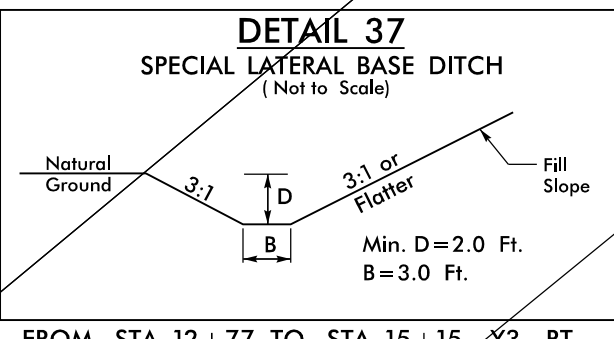

FROM STA. 12+77 TO STA. 15+15 -Y3- RT
DDE = 6 CY

REVISIONS

8/17/99

4/7/2022
R-5819-R-5820-REV-EC-FSH13-FINAL.dgn
IS:Eric.Cant