

PROJECT REFERENCE NO. <i>R-5819/R-5820</i>	SHEET NO. <i>EC-43/CONST.07</i>
RW SHEET NO.	
ROADWAY DESIGN ENGINEER	HYDRAULICS ENGINEER

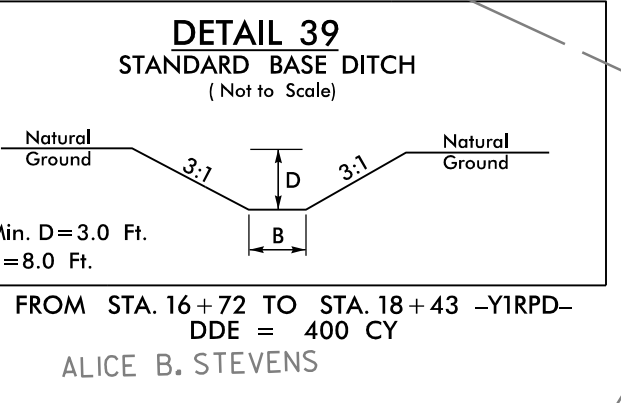
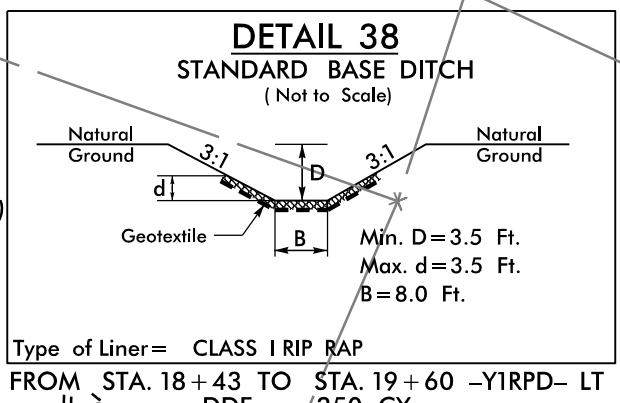
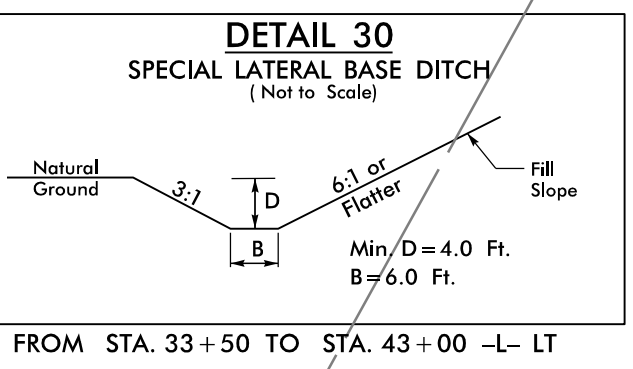
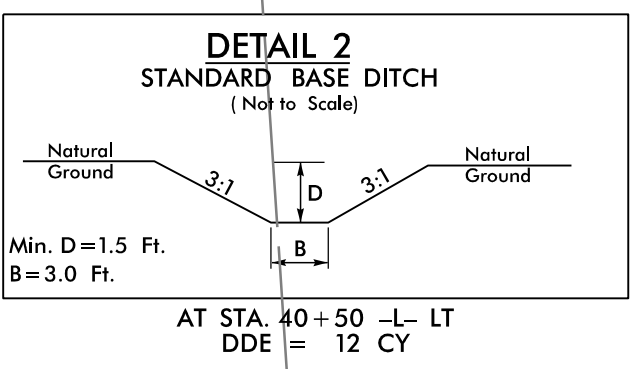
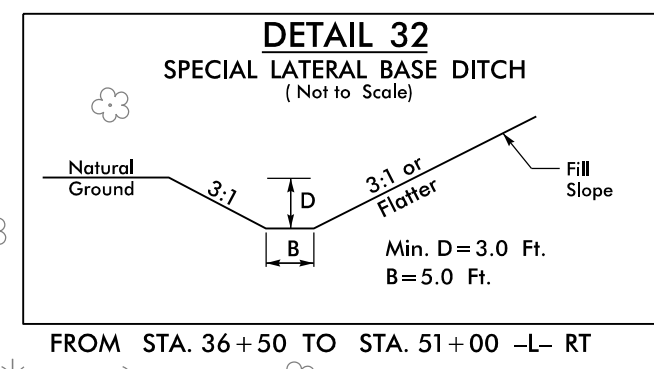

-YIRPA-
 $PI\ Sta\ 14+57.80$ $PI\ Sta\ 18+23.77$
 $\Theta s = 4^{\circ}24'26.5''$ $\Delta = 20^{\circ}46'44.5'' (RT)$
 $Ls = 240.00'$ $D = 3^{\circ}40'22.1''$
 $LT = 160.05'$ $L = 565.75'$
 $ST = 80.05'$ $T = 286.02'$
 $R = 1,560.00'$
 $SE = 08$

MATCHLINE -L- STA. 34 + 00.00
SEE SHEET 6

MATCHLINE -L- STA. 45 + 00.00
SEE SHEET 8

NAD 83/NA 2011

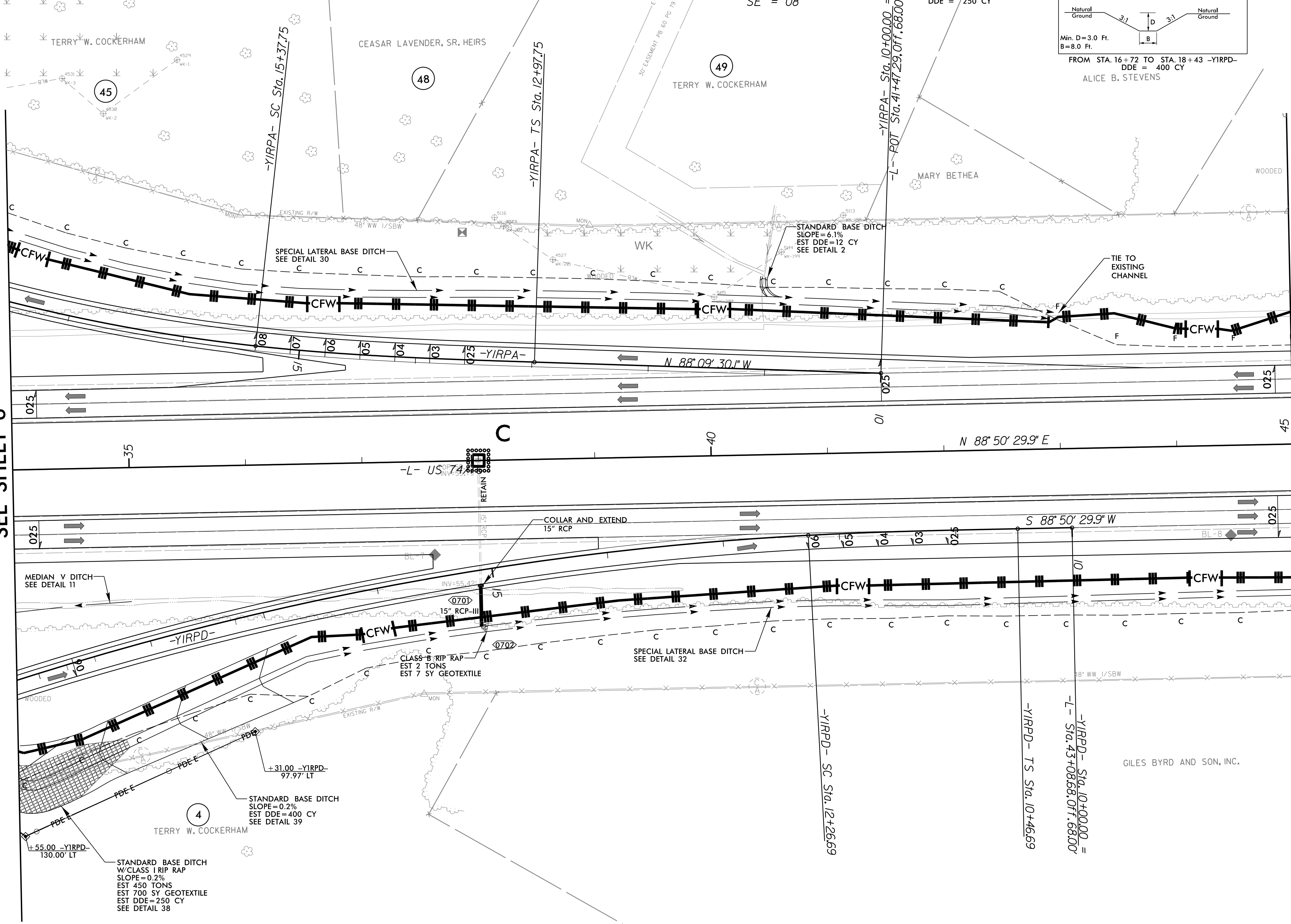

-YIRPD-
 $PI\ Sta\ 11+66.69$ $PI\ Sta\ 16+04.63$
 $\Theta s = 1^{\circ}54'10.1''$ $\Delta = 15^{\circ}52'44.1'' (LT)$
 $Ls = 180.00'$ $D = 2^{\circ}06'51.2''$
 $LT = 120.01'$ $L = 751.05'$
 $ST = 60.01'$ $T = 377.95'$
 $R = 2,710.00'$
 $SE = 08$

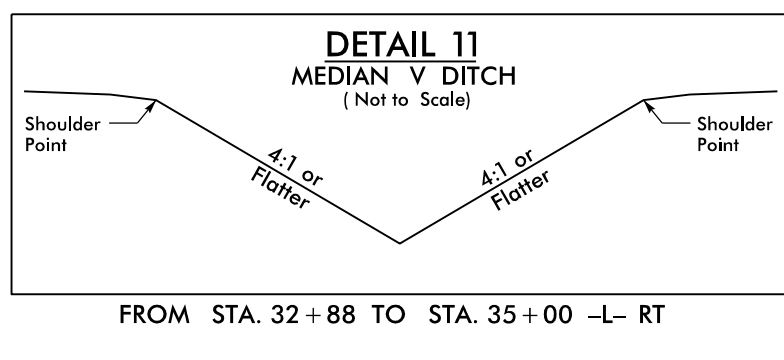

NOTES:
 ■ PROP PAVED SHOULDER
 FOR -L- PROFILE, SEE SHEET 20 & 21
 FOR -YIRPA- PROFILE, SEE SHEET 27
 FOR -YIRPD- PROFILE, SEE SHEET 30

REVISIONS

3/14/2022, R5819-R5820-REV-EC-FSH7_FINAL.dgn
 8/17/99