

PROJECT REFERENCE NO. R-5819 /R-5820	SHEET NO. EC-35/CONST.21
RW SHEET NO.	
ROADWAY DESIGN ENGINEER	HYDRAULICS ENGINEER

CLEARING AND GRUBBING
EROSION CONTROL FOR
CONSTRUCTION SHEET 21

-Y7-
 PI Sta 27+72.88 PI Sta 32+11.93
 $\Delta = 0^{\circ} 52' 06.7" (LT)$ $\Delta = 1^{\circ} 18' 44.8" (RT)$
 $D = 0^{\circ} 43' 40.9"$ $D = 0^{\circ} 43' 40.9"$
 $L = 119.30'$ $L = 180.27'$
 $T = 59.65'$ $T = 90.14'$
 $R = 7,870.00'$ $R = 7,870.00'$
 $SE = NC$ $SE = NC$

NAD 83/NA 2011

MATCH LINE -Y7- STA 28+00.00
SEE SHEET 20

MATCH LINE -Y7- STA 42+00.00
SEE SHEET 22

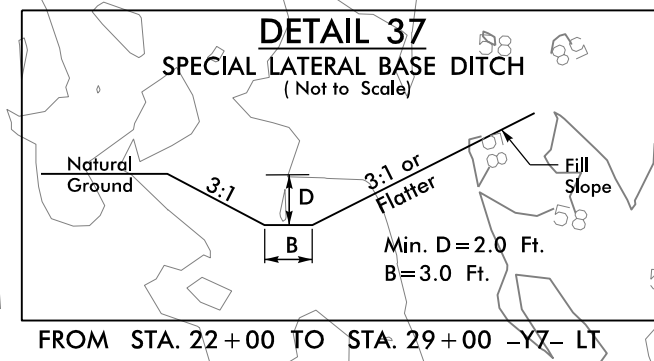
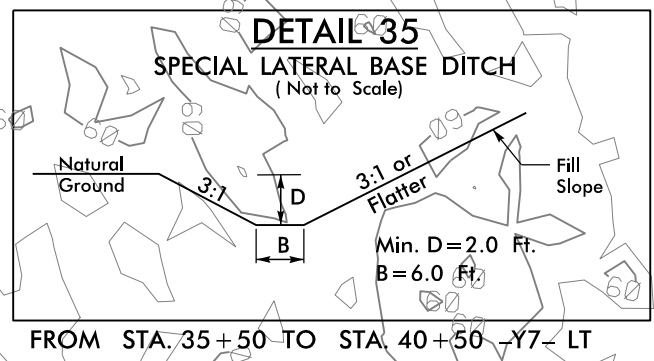
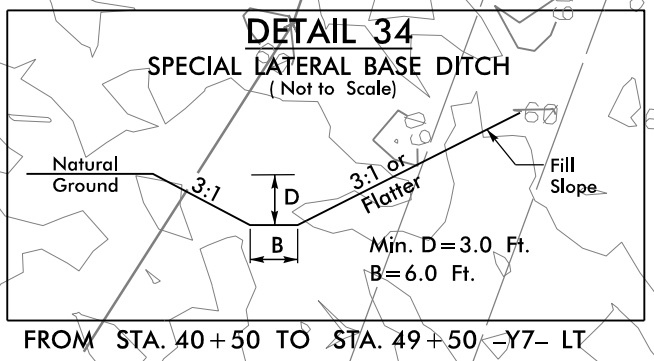
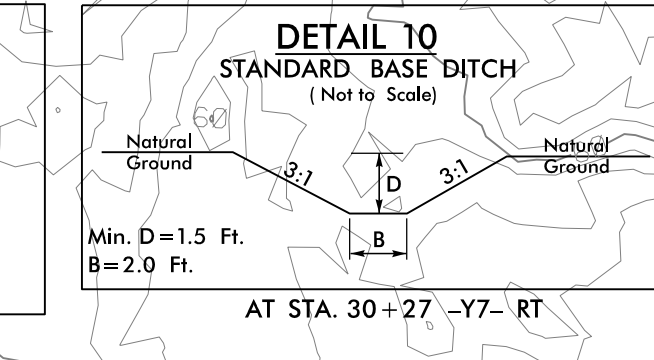
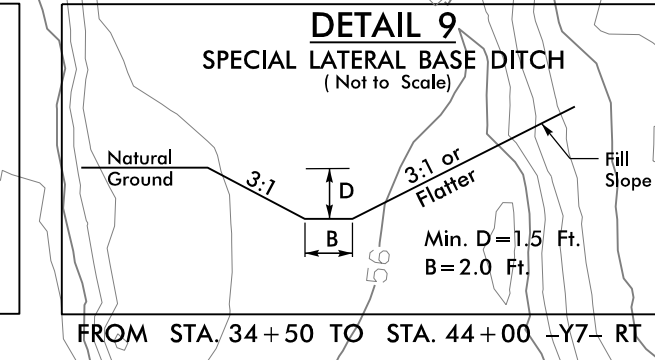
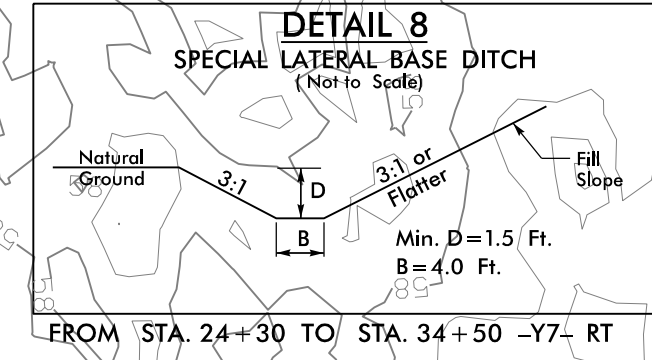
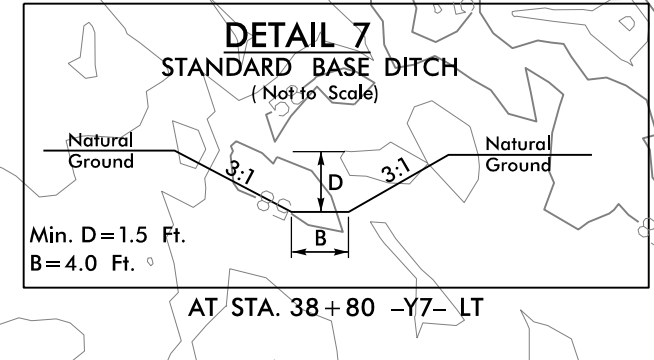
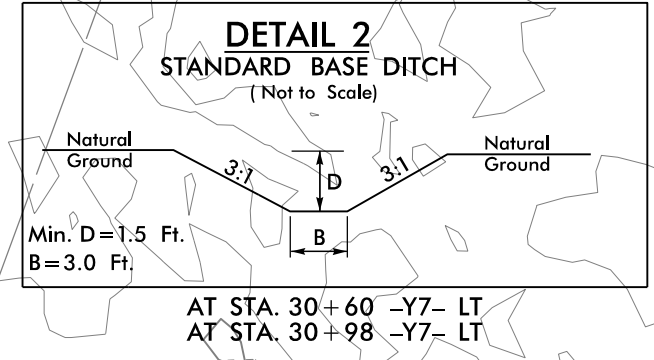
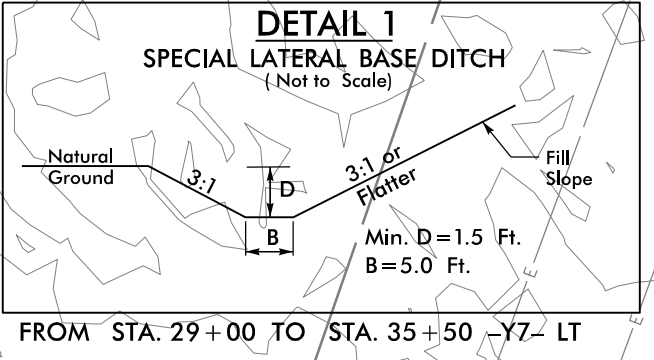
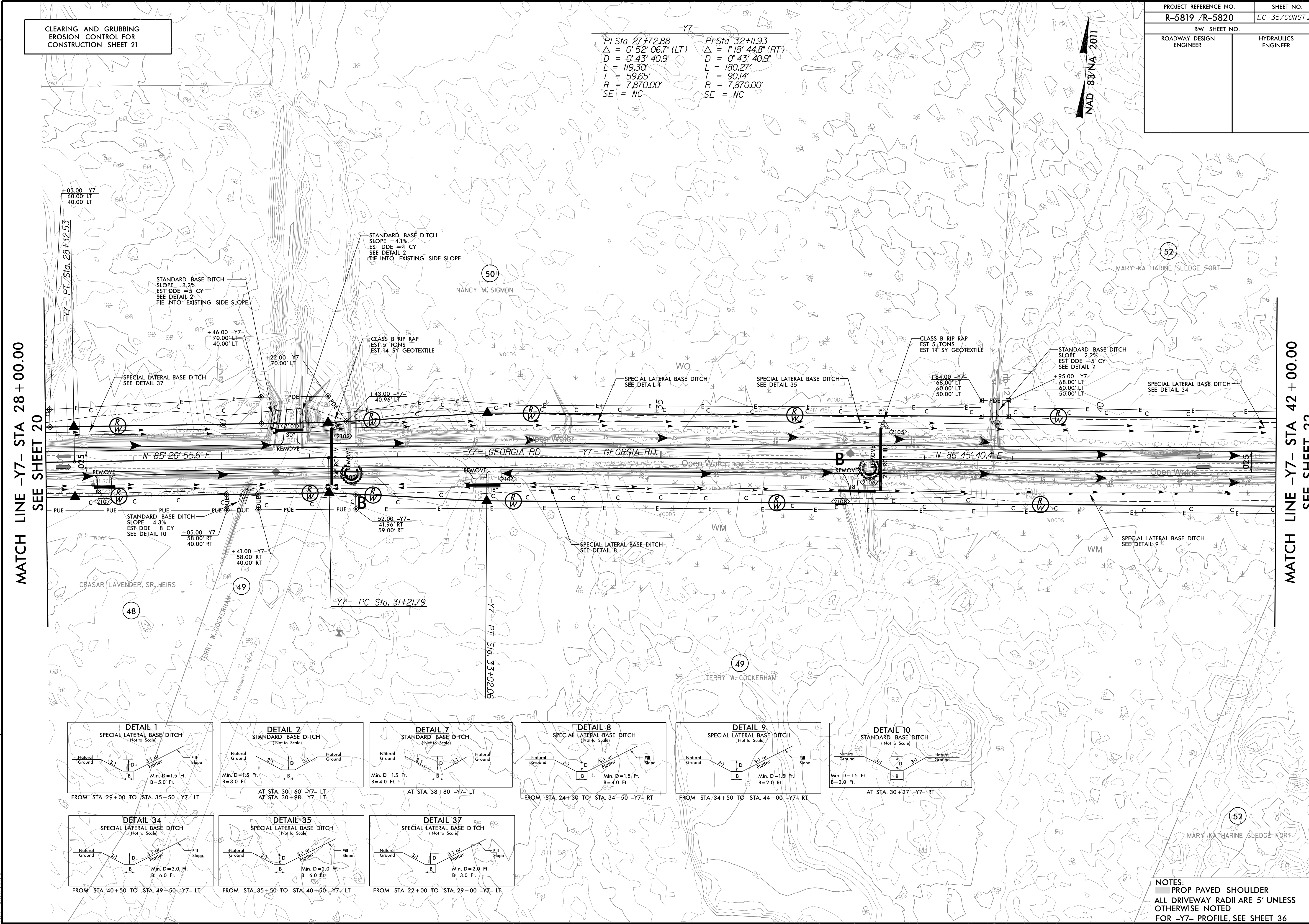

NOTES:
 PROP PAVED SHOULDER
 ALL DRIVEWAY RADI ARE 5' UNLESS OTHERWISE NOTED
 FOR -Y7- PROFILE, SEE SHEET 36

REVISIONS

8/17/99
 3/14/2022
 R5819-R5820-REV-EC-FSH21-CG.dgn
 TSE/ETC/MLT