

8/17/99

-Y2- DETOUR

NV5

NV5 ENGINEERS & CONSULTANTS, INC.
3300 REGENCY PARKWAY, SUITE 100
CARY, NC 27518
P: 919.851.1912 www.NV5.com
NC License # F-1333
Formerly CALW Engineers & Consultants

PROJECT REFERENCE NO. <i>R-5819/R-5820</i>	SHEET NO. <i>EC-16/CONST.2B-6</i>
RW SHEET NO.	
ROADWAY DESIGN ENGINEER	HYDRAULICS ENGINEER

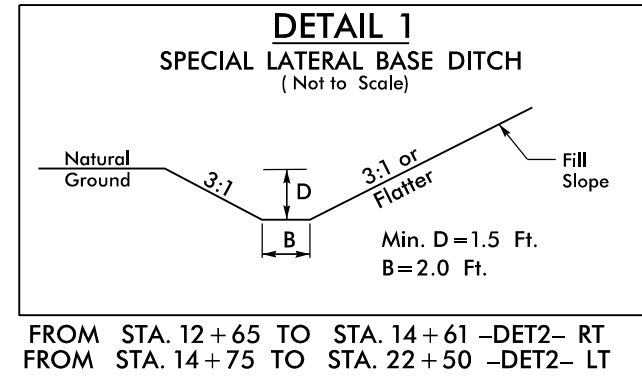

HALLSBORO CONSTRUCTION COMPANY, INC.

CAREY F. BLANKS

JOHNNIE KEETER, SR.

VERNON L. KEETER

CAROLINA MEDICAL CENTER, PA

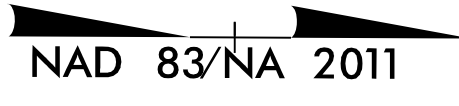

REVISIONS

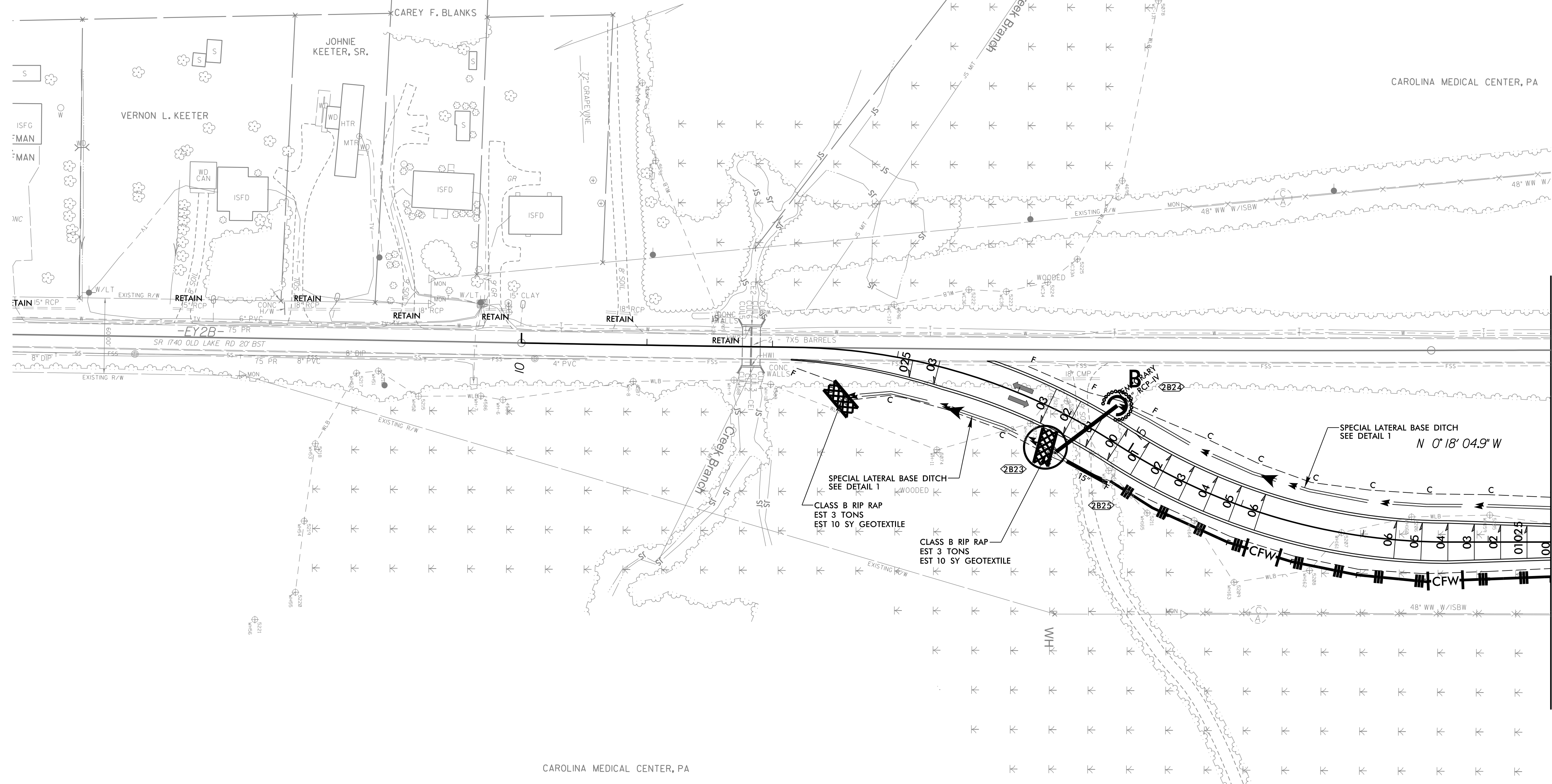

MATCHLINE -DET2- STA. 18 + 50.00
SEE SHEET 2B-7

CAROLINA MEDICAL CENTER, PA

-DET2-

PI Sta 11+08.88	PI Sta 13+57.48	PI Sta 16+32.86
$\Delta = 0^\circ 22' 50.1''$ (LT)	$\Delta = 32^\circ 08' 21.9''$ (RT)	$\Delta = 32^\circ 51' 46.3''$ (LT)
D = 0' 10' 29.2"	D = 1' 48' 48.8"	D = 1' 48' 48.8"
L = 217.76'	L = 272.06'	L = 278.18'
T = 108.88'	T = 139.71'	T = 143.03'
R = 32,783.83'	R = 485.00'	R = 485.00'
SE = EX	SE = 03	SE = 06

NOTES:
■ PROP PAVED SHOULDER
FOR -DET2- PROFILE, SEE SHEET 45

3/14/2022
R5819-R5820-REV-EC-FSH2B-6-FINAL.dgn
R5819-R5820-REV-EC-FSH2B-6-FINAL.dgn