

8/17/99

-Y1- DETOUR

NIV5

NIV5 ENGINEERS & CONSULTANTS, INC.
3300 REGENCY PARKWAY, SUITE 100
CARY, NC 27513
P: 919.851.1912 www.NIV5.com
NC License # F-1333
formerly GALN Engineers & Consultants

PROJECT REFERENCE NO. R-5819/R-5820	SHEET NO. EC-14/CONST.2B-4
RW SHEET NO.	
ROADWAY DESIGN ENGINEER	HYDRAULICS ENGINEER

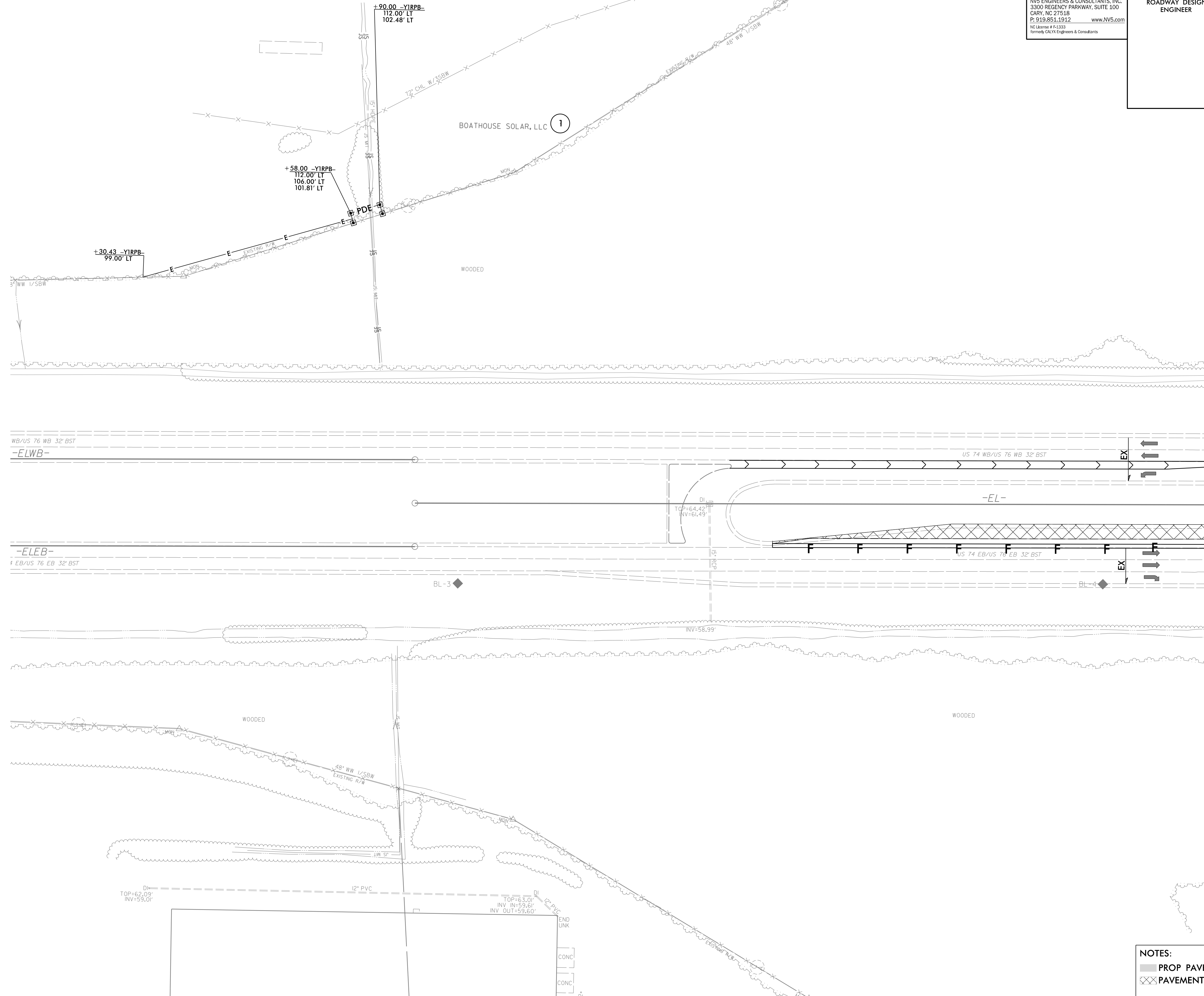

NAD 83/NA 2011

REVISIONS

MATCHLINE -L- STA. 18+00.00
SEE SHEET 2B-2

- NOTES:
- ▬ PROP PAVED SHOULDER
 - ▨ PAVEMENT REMOVAL

3/14/2022
R-5819-R5820-REU-EC-FSH2B-4-FINAL.dgn
USER:rlm