

MATCHLINE -L- STA. 85 + 50.00  
SEE SHEET 2B-9

-Y2- DETOUR

NV5

PROJECT REFERENCE NO. R-5819/R-5820	SHEET NO. EC-10/CONST-2B-7
RW SHEET NO.	
ROADWAY DESIGN ENGINEER	HYDRAULICS ENGINEER

CLEARING AND GRUBBING  
EROSION CONTROL FOR  
CONSTRUCTION SHEET 2B-7

NV5 ENGINEERS & CONSULTANTS, INC.  
3300 REGENCY PARKWAY, SUITE 100  
CARY, NC 27518  
P: 919.851.1912 www.NV5.com  
NC License # F-1333  
Formerly CALVA Engineers & Consultants

NAD 83/NA 2011

MATCHLINE -DET2- STA. 18 + 50.00  
SEE SHEET 2B-6

MATCHLINE -DET2- STA. 31 + 00.00  
SEE SHEET 2B-8

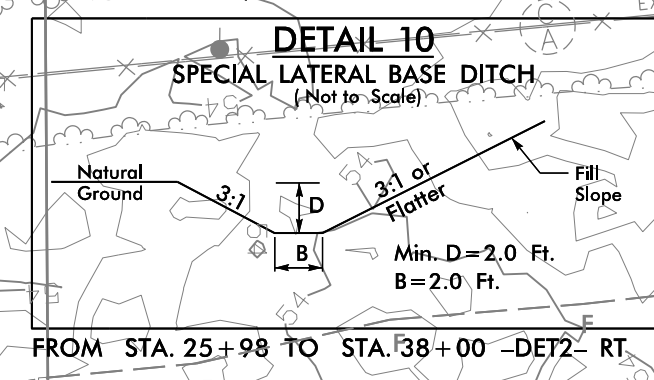
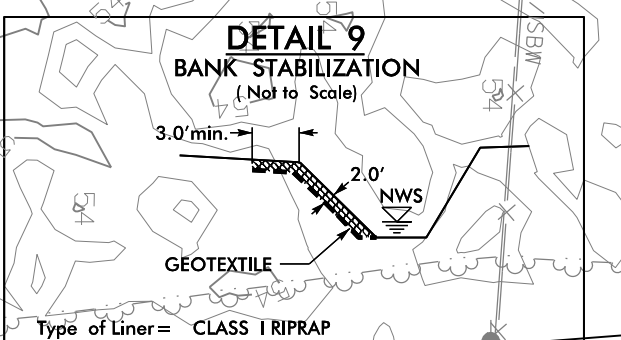
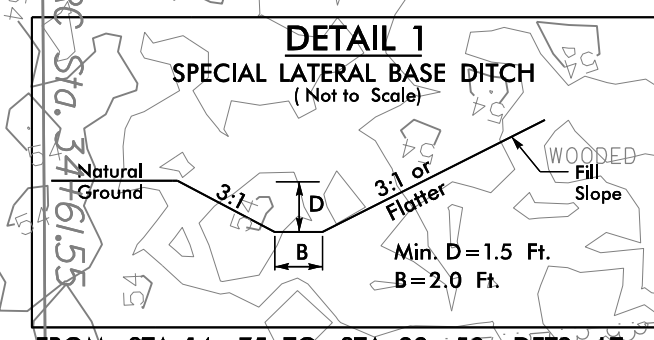
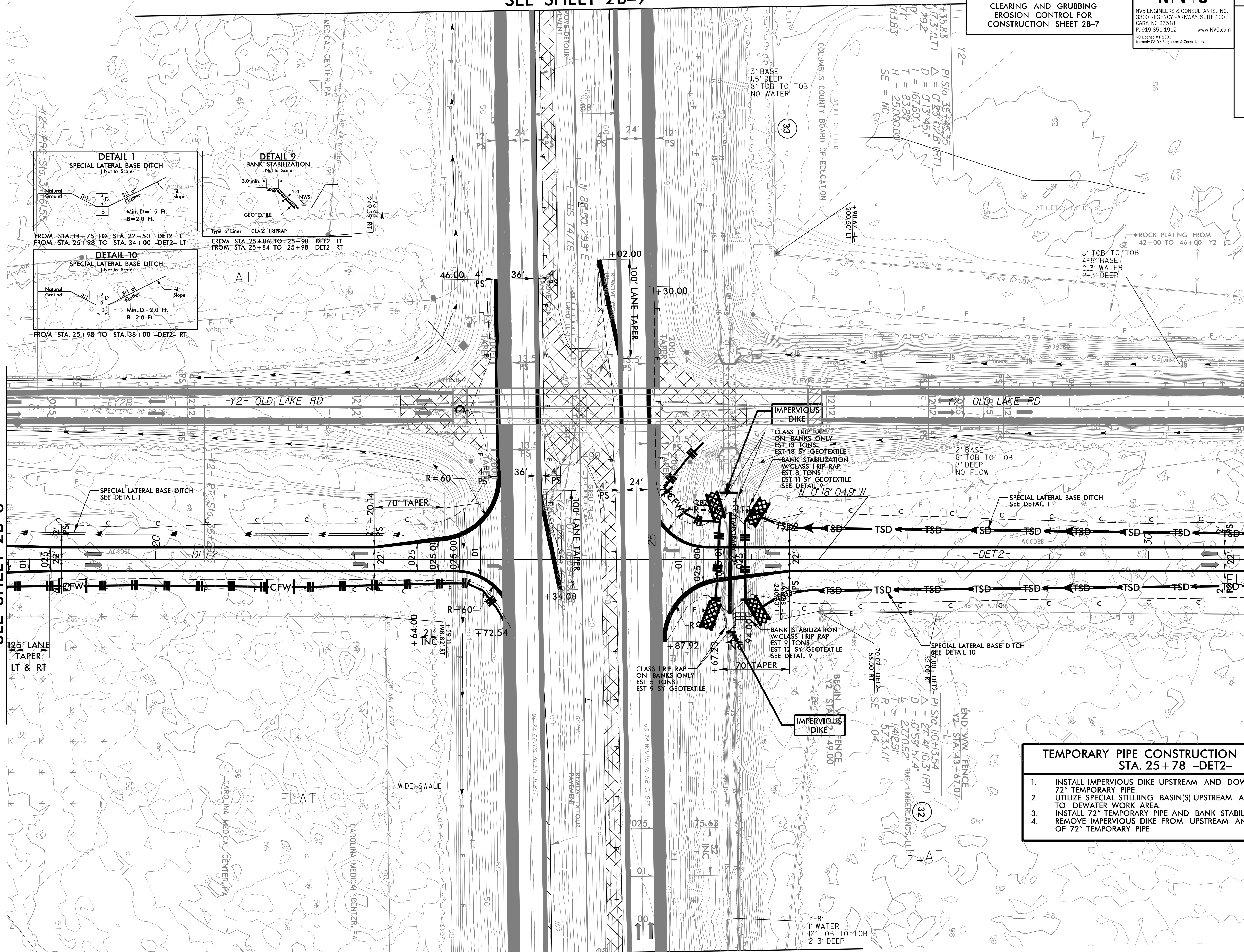

- TEMPORARY PIPE CONSTRUCTION SEQUENCE  
STA. 25+78 -DET2-**
1. INSTALL IMPERVIOUS DIKE UPSTREAM AND DOWNSTREAM OF 72" TEMPORARY PIPE.
  2. UTILIZE SPECIAL STILLING BASIN(S) UPSTREAM AND DOWNSTREAM TO DEWATER WORK AREA.
  3. INSTALL 72" TEMPORARY PIPE AND BANK STABILIZATION.
  4. REMOVE IMPERVIOUS DIKE FROM UPSTREAM AND DOWNSTREAM OF 72" TEMPORARY PIPE.

NOTES:  
 PROP PAVED SHOULDER  
 PAVEMENT REMOVAL  
 FOR -DET2- PROFILE, SEE SHEET 45

MATCHLINE -L- STA. 95 + 00.00  
SEE SHEET 2B-10

REVISIONS

8/17/99  
3/14/2022  
R5819\_R5820\_REU\_EC\_PSH2B-7\_CG.dgn  
R5819.dwg