

CLEARING AND GRUBBING  
EROSION CONTROL FOR  
CONSTRUCTION SHEET 2B-5

8/17/99

-Y1- DETOUR

NIV5

PROJECT REFERENCE NO. SHEET NO.

R-5819/R-5820 EC-08/CONST-2B-5

R/W SHEET NO.

ROADWAY DESIGN  
ENGINEER

HYDRAULICS  
ENGINEER

NIV5 ENGINEERS & CONSULTANTS, INC.  
3300 REGENCY PARKWAY, SUITE 100  
CARY, NC 27518  
P: 919.851.1912 www.NIV5.com  
NC License # F-1333  
Formerly CUY Engineers & Consultants

MATCHLINE -L- STA. 27 + 50.00  
SEE SHEET 2B-2

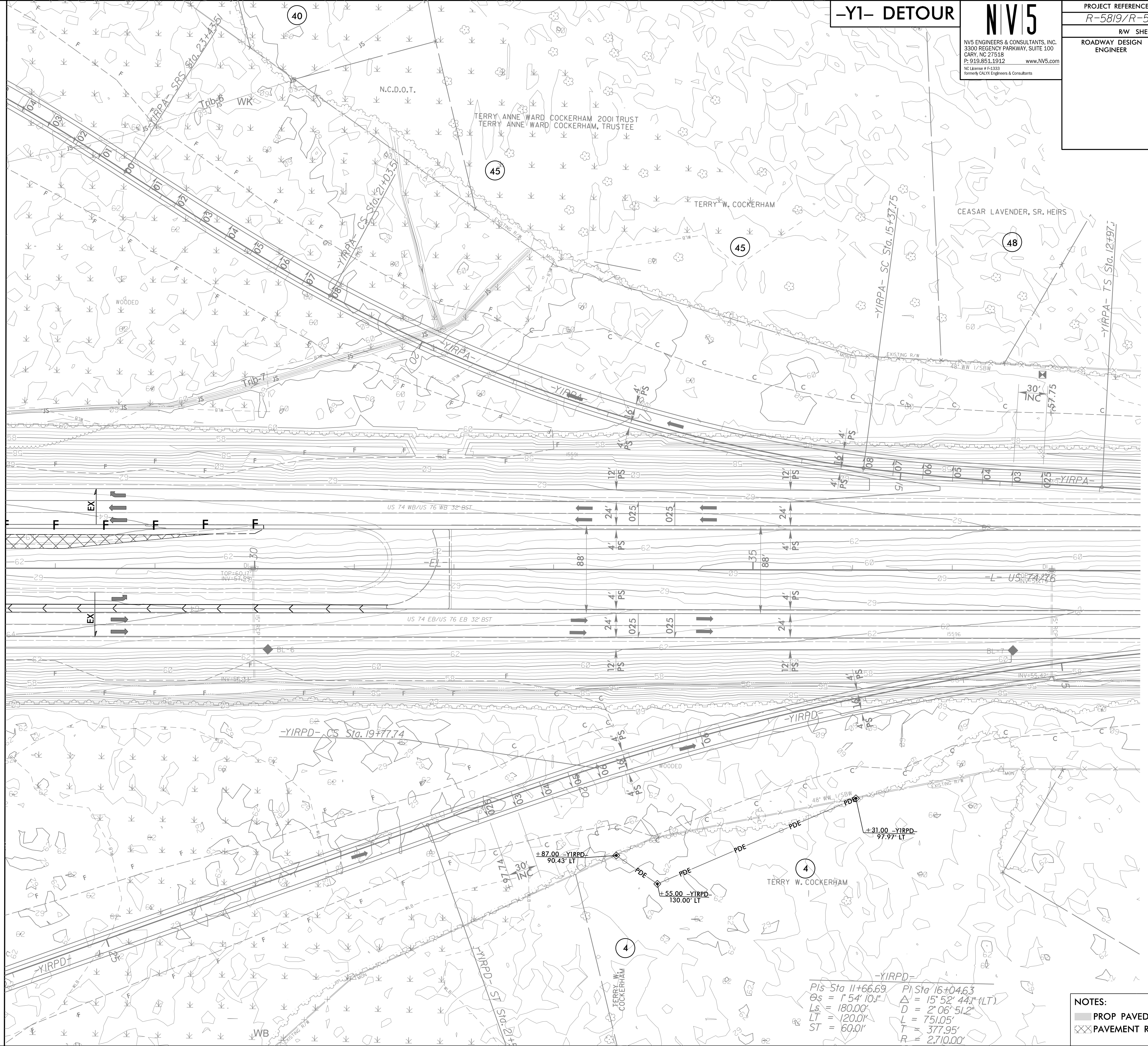

NAD 83/NA 2011

REVISIONS

3/14/2022  
R-5819-R5820-REV-EC-FSH2B-5-CG.dgn  
US:Eric.Cant

PIs - Sta 11+66.69 PI Sta 16+04.63  
θs = 1° 54' 10.1" Δ = 15° 52' 44.3" (LT)  
Ls = 180.00' D = 2' 06" 51.2"  
LT = 120.01' L = 751.05'  
ST = 60.01' T = 377.95'  
R = 2,710.00'

NOTES:  
■ PROP PAVED SHOULDER  
XX PAVEMENT REMOVAL